

# APPLICATION

PERCOLATION TESTING

A 516084

P \_\_\_\_\_

HOWARD COUNTY HEALTH DEPARTMENT  
BUREAU OF ENVIRONMENTAL HEALTH  
3525-H ELLICOTT MILLS DRIVE/ELLICOTT CITY, MARYLAND 21043  
TELEPHONE: 313-2640

DISTRICT \_\_\_\_\_

DATE \_\_\_\_\_

TO: THE COUNTY HEALTH OFFICER  
ELLICOTT CITY, MARYLAND

I HEREBY APPLY FOR THE NECESSARY TEST PRIOR TO APPLICATION FOR PERMIT TO CONSTRUCT (OR RECONSTRUCT) A SEWAGE DISPOSAL SYSTEM.

PROPERTY OWNER SECURITY DEVELOPMENT, L.L.C.  
P.O. BOX 417  
ADDRESS ELLICOTT CITY, MD 21041 PHONE 410-465-4244

AGENT OR PROSPECTIVE BUYER \_\_\_\_\_  
ADDRESS \_\_\_\_\_ PHONE \_\_\_\_\_

PROPERTY LOCATION:  
SUBDIVISION HOMEWOOD LOT NO. 4  
ROAD AND DESCRIPTION HOMEWOOD ROAD

TAX MAP 23 & 29 PARCEL # 20 & 86  
SIZE OF LOT 1 ACRE ± TYPE BLDG. SINGLE FAMILY DETACHED  
(SINGLE FAMILY DWELLING OR COMMERCIAL)

THE SYSTEM INSTALLED UNDER THIS APPLICATION IS ACCEPTABLE ONLY UNTIL PUBLIC FACILITIES BECOME AVAILABLE. I FULLY UNDERSTAND THE FEE CONNECTED WITH THE FILING OF THIS PERC TEST APPLICATION IS NON-REFUNDABLE UNDER ANY CIRCUMSTANCES. I ALSO AGREE TO COMPLY WITH ALL M.O.S.H.A. REQUIREMENTS IN TESTING THIS LOT.

SECURITY DEVELOPMENT LLC  
BY: [Signature] MEMBER  
(SIGNATURE OF APPLICANT) STEVEN K. BIRSBORN

APPROVED BY \_\_\_\_\_ FOR \_\_\_\_\_ DATE \_\_\_\_\_

DISAPPROVED BY \_\_\_\_\_ FOR \_\_\_\_\_ DATE \_\_\_\_\_

HOLD PENDING FURTHER TESTS \_\_\_\_\_

REASONS FOR REJECTION OR HOLDING \_\_\_\_\_

PERCOLATION TEST PLAT/PRELIMINARY PLAT - TITLE OR I.D. # \_\_\_\_\_ DATE \_\_\_\_\_

SITE DEVELOPMENT PLAN/FINAL PLAT - TITLE OR I.D. # \_\_\_\_\_ DATE \_\_\_\_\_

# THIS IS NOT A PERMIT

516084

COUNTY #

SOIL PROFILE

(4C)

Micaceous  
hvy Loam

2'3"

org brn  
y brn  
micaceous  
Loam  
Rx < 5%

5'

lt brn  
white  
fine  
SAND  
Rx < 5%

Bottom

14'

(4B)

DK RD  
RD BRN  
DK BRN  
Micaceous  
Loam

6'

Beige  
lt brn  
fine  
SAND  
Rx < 5%

Bottom

15'

(4A)

Str. brn  
micaceous  
CL Lm

22'±

yellow  
strong org  
brn  
Lm  
micaceous  
15-20%  
Frag

7 1/2'

S-SLm  
med &  
fine  
grains  
35-40%  
Frag  
Bottom

14'

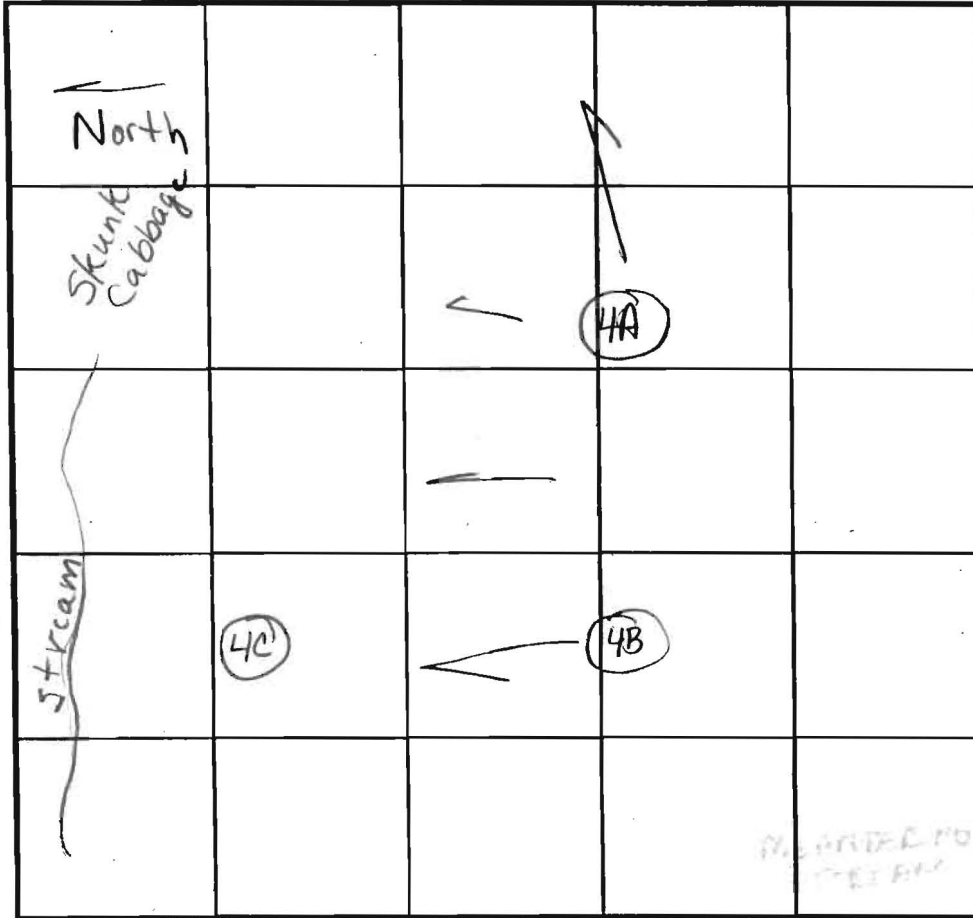

SOIL PROFILE

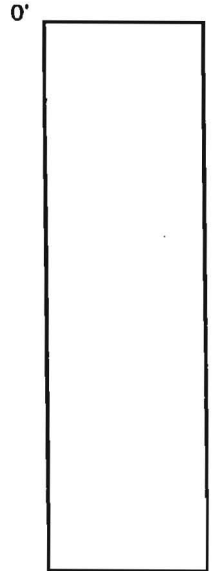

INDICATE NORTH - NAME ADJOINING ROADWAY AS BASE LINE.

DATE	TEST NO.	DEPTH	PRE-WET		TEST - 1" DROP		TIME
			START	STOP	START	STOP	
4/15/23	4B	6' / 15' V	2:31	2:36		2:43	7 OK
		5.5'	2:32:50	2:35:02	2:35:02	2:38	3
	4C	6.5' / 14' V	2:40:47	2:41:25	2:41:25	2:43:28	2 OK
	4A	4' / 14' V	2:45:33	2:46:49	2:46:49	2:48:46	2 (F)
Excessive Rock - DIG 25' AWAY							

REMARKS: Holes dug per plan 4D = 4E WET SEASON TESTING RQD

TYPE OF SOIL \_\_\_\_\_

TESTED BY: Brian & Kacie ALSO PRESENT: Hat fields

TRENCH DESIGN DATA: AVERAGE PERCOLATION TIME \_\_\_\_\_ TRENCH WIDTH \_\_\_\_\_

INLET DEPTH \_\_\_\_\_ MAXIMUM BOTTOM DEPTH \_\_\_\_\_ SQ. FT./BEDROOM \_\_\_\_\_

S.E. 50% Rx

platy structure

AP 902

Lot 44

brown / sbs / 1 wpt roots  
 brown / rocky fine gravel 2 1/2  
 red brown sl med coarse gravels 5-10%  
 weak yellow brown sl / 1s

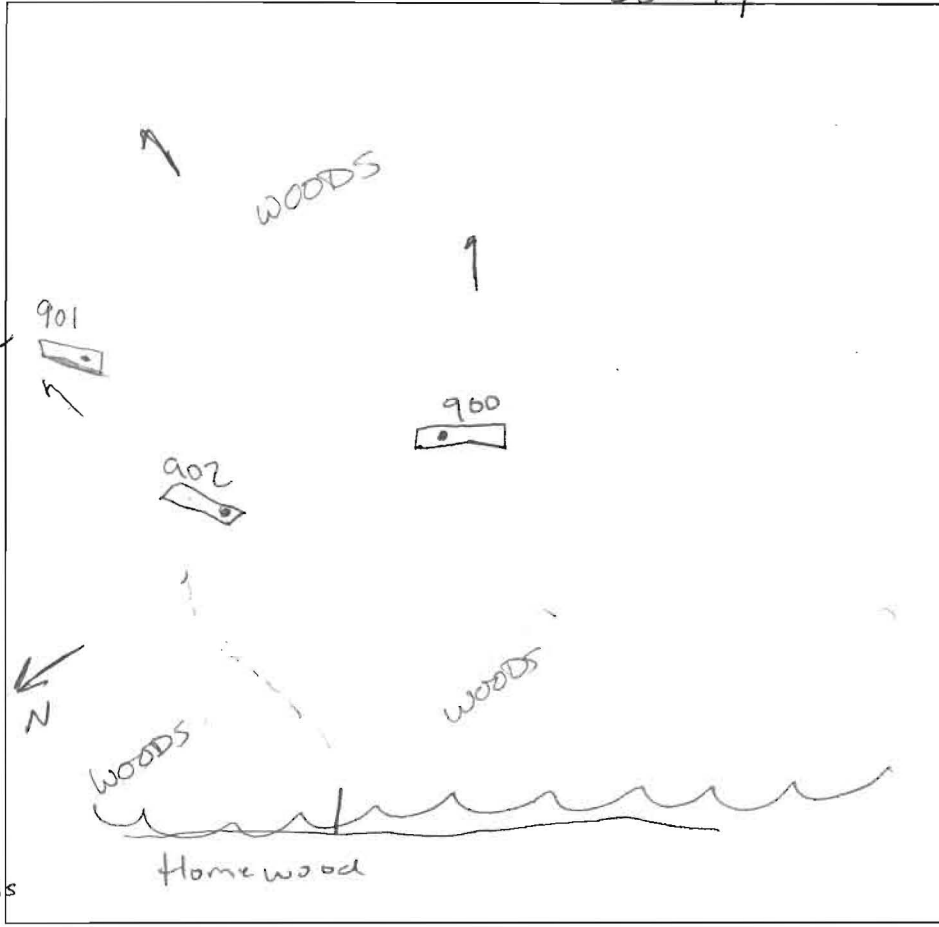

900 / 901  
 brown / roots  
 Brn lw sbk  
 40% mica sl 5% med/coarse gravels  
 light yellow tan brown sl / 1s  
 micaous 5% bottom

901  
 higher gravel & cobbles 15-20%  
 wk y brn sl / 1s  
 15-20% coarse gravels & cobbles  
 Bottom

DATE	TEST #	DEPTH	START	BREAK 1" DROP	STOP 2" DROP	TIME OF 2nd INCH	P/F/H
9/22	902	6 / 13	10:13	10:16	10:21	5	P
9/22	900	6 / 14	10:25	10:27	10:38	3	P
	901	6' / 12 1/2	10:36	10:38	10:40 <sup>50</sup>	2'	P

REMARKS Holes Staked & dug per plan

SANITARIAN py / KN BACKHOE HATFIELD'S (100) OTHERS C. Sperry

TEST HOLES USED IN SDA \_\_\_\_\_ AVG. PERC TIME \_\_\_\_\_ SQ. FT/BR \_\_\_\_\_

TRENCH WIDTH \_\_\_\_\_ INLET DEPTH \_\_\_\_\_ MAX. BOT DEPTH \_\_\_\_\_ EFFECTIVE SW \_\_\_\_\_

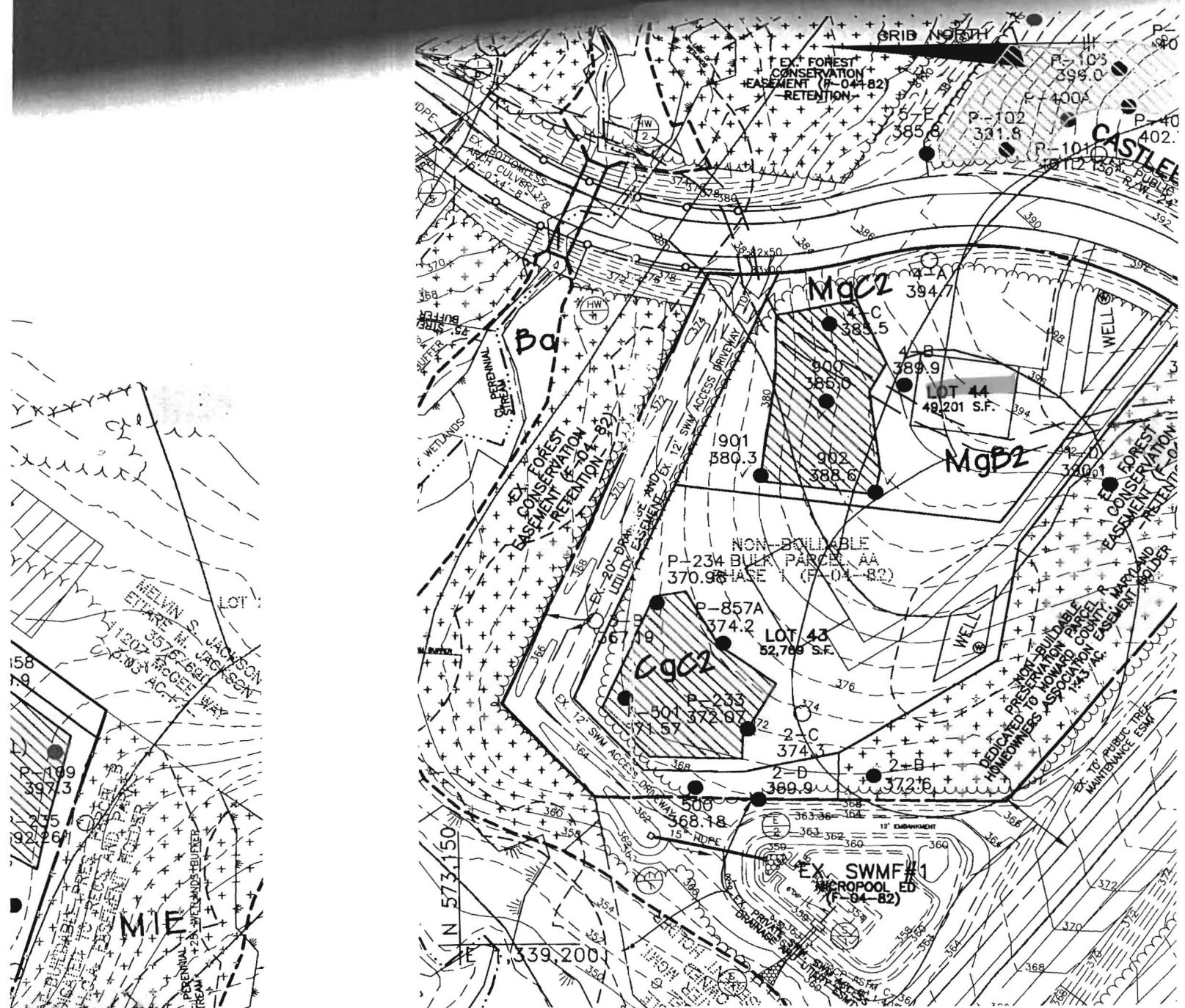

# RESUBDIVISION OF PA

SCALE: 1" = 100'

*Signed perc cert  
1/22/07*