

Building Address: 10424 Breezewood Circle  
Woodstock, MD

Suite/Apt. # \_\_\_\_\_ SDP/NP/BA #: \_\_\_\_\_

Census Tract: \_\_\_\_\_ Subdivision: \_\_\_\_\_

Section: \_\_\_\_\_ Area: \_\_\_\_\_ Lot: 28

Tax Map: \_\_\_\_\_ Parcel: \_\_\_\_\_ Grid: \_\_\_\_\_

Zoning: Residential Map Coordinates: \_\_\_\_\_ Lot Size: \_\_\_\_\_

Property Owner's Name: Daniel Weber

Address: 10424 Breezewood Circle

City: Woodstock State: MD Zip Code: 21

Home Phone: 410-465-1217 Work Phone: \_\_\_\_\_

Applicant's Name & Mailing Address, (If other than stated herein):  
William Shaffer  
1591 Cross Country Drive/Westminster, MD

Phone: 410-806-8465 Fax: \_\_\_\_\_

Email: \_\_\_\_\_

Existing Use: Single family with deck

Proposed Use: Single family with deck

Estimated Construction Cost: \$ 15,000

Description of Work: Replace existing deck and rebuilding same size 10x23

Occupant or Tenant: \_\_\_\_\_

Was tenant space previously occupied?  Yes  No

Contact Name: \_\_\_\_\_

Address: \_\_\_\_\_

City: \_\_\_\_\_ State: \_\_\_\_\_ Zip Code: \_\_\_\_\_

Phone: \_\_\_\_\_ Fax: \_\_\_\_\_

Email: \_\_\_\_\_

Contractor Company: Decks Unlimited, LLC

Contact Person: Bill Shaffer

Address: 1591 Cross Country Drive

City: Westminster State: MD Zip Code: 21155

License No.: 94607

Phone: 410-206-8465 Fax: \_\_\_\_\_

Email: \_\_\_\_\_

Engineer/Architect Company: \_\_\_\_\_

Responsible Design Prof.: \_\_\_\_\_

Address: \_\_\_\_\_

City: \_\_\_\_\_ State: \_\_\_\_\_ Zip Code: \_\_\_\_\_

Phone: \_\_\_\_\_ Fax: \_\_\_\_\_

Email: \_\_\_\_\_

BUILDING DESCRIPTION - COMMERCIAL	
Building Characteristics	Utilities
Height:	<u>Water Supply</u>
No. of stories:	<input type="checkbox"/> Public
Gross area, sq. ft./floor:	<input type="checkbox"/> Private
	<u>Sewage Disposal</u>
Area of construction (sq. ft.):	<input type="checkbox"/> Public
	<input type="checkbox"/> Private
Use group:	Electric: <input type="checkbox"/> Yes <input type="checkbox"/> No
	Gas: <input type="checkbox"/> Yes <input type="checkbox"/> No
<u>Construction type:</u>	<u>Heating System</u>
<input type="checkbox"/> Reinforced Concrete	<input type="checkbox"/> Electric <input type="checkbox"/> Oil
<input type="checkbox"/> Structural Steel	<input type="checkbox"/> Natural Gas <input type="checkbox"/> Propane Gas
<input type="checkbox"/> Masonry	<u>Sprinkler System:</u>
<input type="checkbox"/> Wood Frame	<input type="checkbox"/> N/A
<input type="checkbox"/> State Certified Modular	<input type="checkbox"/> Full
<input checked="" type="checkbox"/> <u>Roadside Tree Project Permit</u>	<input type="checkbox"/> Partial
<input type="checkbox"/> Yes <input type="checkbox"/> No	<input type="checkbox"/> Other Suppression
<u>Roadside Tree Project Permit #</u>	No. of Heads:

BUILDING DESCRIPTION - RESIDENTIAL	
Building Characteristics	Utilities
<input checked="" type="checkbox"/> SF Dwelling <input type="checkbox"/> SF Townhouse	<u>Water Supply</u>
<u>Depth</u> <u>Width</u>	<input type="checkbox"/> Public
1 <sup>st</sup> floor:	<input checked="" type="checkbox"/> Private
2 <sup>nd</sup> floor:	<u>Sewage Disposal</u>
Basement:	<input type="checkbox"/> Public
<input type="checkbox"/> Finished Basement	<input checked="" type="checkbox"/> Private
<input type="checkbox"/> Unfinished Basement	Electric: <input type="checkbox"/> Yes <input type="checkbox"/> No
<input type="checkbox"/> Crawl Space	Gas: <input type="checkbox"/> Yes <input type="checkbox"/> No
<input type="checkbox"/> Slab on Grade	<u>Heating System</u>
No. of Bedrooms:	<input type="checkbox"/> Electric
<u>Multi-family Dwelling</u>	<input type="checkbox"/> Oil
No. of efficiency units:	<input type="checkbox"/> Natural Gas
No. of 1 BR units:	<input type="checkbox"/> Propane Gas
No. of 2 BR units:	
No. of 3 BR units:	
Other Structure:	
Dimensions:	
Footings: <u>30" Deep</u>	<input checked="" type="checkbox"/> <u>Roadside Tree Project Permit</u>
Roof:	<input type="checkbox"/> Yes <input checked="" type="checkbox"/> No
<input type="checkbox"/> State Certified Modular	<u>Roadside Tree Project Permit #</u>
<input type="checkbox"/> Manufactured Home	

THE UNDERSIGNED HEREBY CERTIFIES AND AGREES AS FOLLOWS: (1) THAT HE/SHE IS AUTHORIZED TO MAKE THIS APPLICATION; (2) THAT THE INFORMATION IS CORRECT; (3) THAT HE/SHE WILL COMPLY WITH ALL REGULATIONS OF HOWARD COUNTY WHICH ARE APPLICABLE THERETO; (4) THAT HE/SHE WILL PERFORM NO WORK ON THE ABOVE REFERENCED PROPERTY NOT SPECIFICALLY DESCRIBED IN THIS APPLICATION; (5) THAT HE/SHE GRANTS COUNTY OFFICIALS THE RIGHT TO ENTER ONTO THIS PROPERTY FOR THE PURPOSE OF INSPECTING THE WORK PERMITTED AND POSTING NOTICES.

William Shaffer  
 Applicant's Signature

William Shaffer  
 Print Name

bfs227@yahoo.com  
 Email Address

10/17/11  
 Date

Owner Decks Unlimited  
 Title/Company

Checks Payable to: DIRECTOR OF FINANCE OF HOWARD COUNTY  
 \*\*PLEASE WRITE NEATLY & LEGIBLY\*\*  
 -FOR OFFICE USE ONLY-

AGENCY	DATE	SIGNATURE OF APPROVAL
State Highways		
Building Officials		
PSZA (Zoning)		
PSZA (Engineering)		
Health		<u>10/17/11 R. Buehler</u>
Fire Protection		

Is Sediment Control approval required for issuance?  Yes  No  
 CONTINGENCY CONSTRUCTION START  
 ONE STOP SHOP

DPZ SETBACK INFORMATION

Front: \_\_\_\_\_

Rear: \_\_\_\_\_

Side: \_\_\_\_\_

Side St.: \_\_\_\_\_

All minimum setbacks met?  Yes  No

Is Entrance Permit Required?  Yes  No

Historic District?  Yes  No

Lot Coverage for New Town Zone: \_\_\_\_\_

SDP/Red-line approval date: \_\_\_\_\_

Filing Fee	\$
Permit Fee	\$
Tech Fee	\$
Excise Tax	\$
PSFS	\$
Guaranty Fund	\$
Add'l per Fee	\$
Total Fees	\$
Sub- Total Paid	\$
Balance Due	\$

APPROVED

WALK-THRU BUILDING PERMIT

BP# \_\_\_\_\_ A# \_\_\_\_\_  
APP. SAN *R. B. Webb* DATE: *10/19/2011*  
DESC. OF WORK: *BREEZEWOOD Deck*

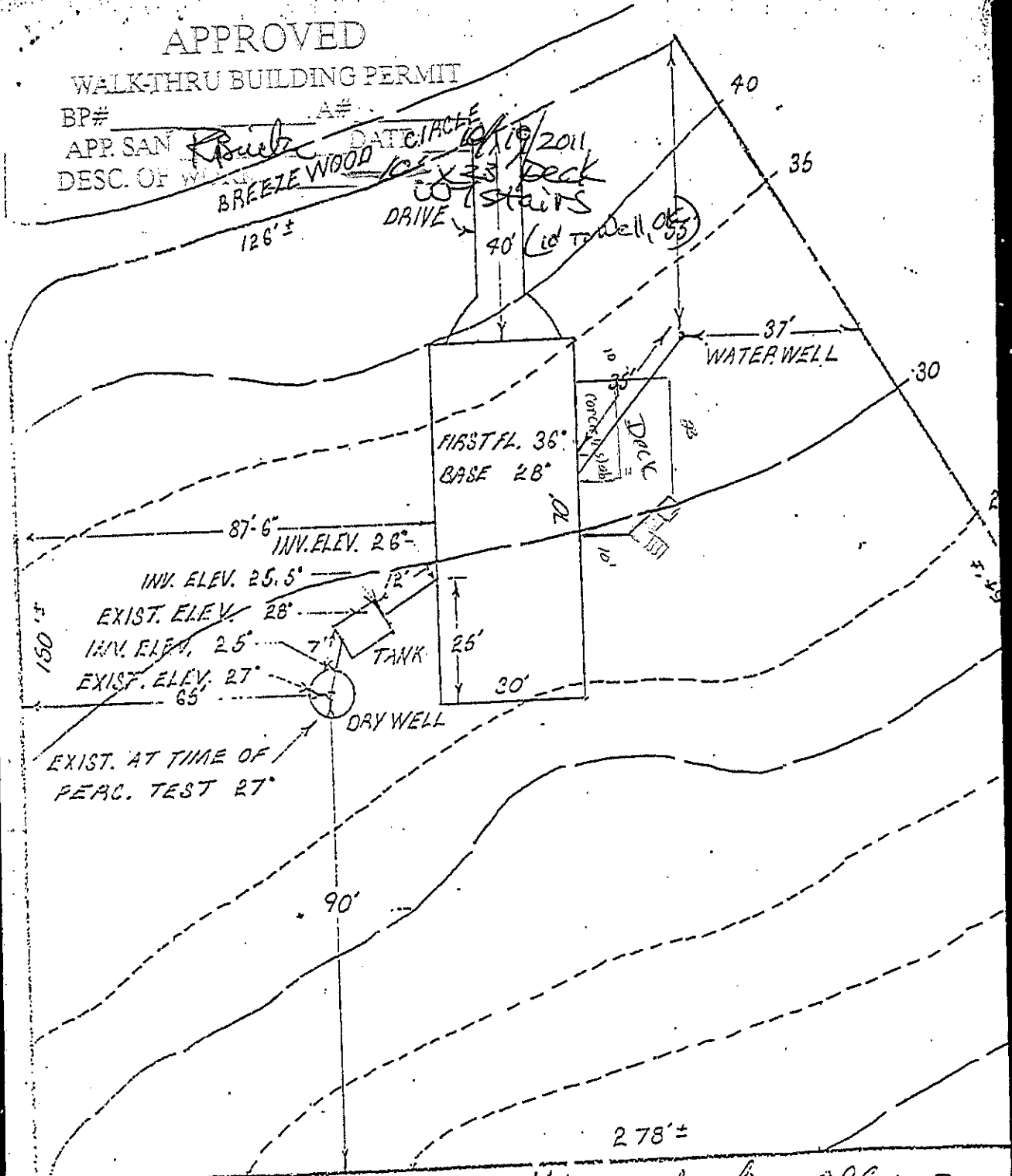

*BreezeWood Farms Harvey Jenkins, B. Alger 328*  
*lot 28. bid?*  
*Plans OK R17*  
*9/22/73*  
*17. Webb owner*  
 BREEZEWOOD  
 BUILDER: *HARVEY JENKINS*  
 OWNER: *DAVID ALGER*