

INDEXED

# PERMIT

## SEWAGE DISPOSAL SYSTEM

### DEPARTMENT OF HEALTH AND MENTAL HYGIENE

P \_\_\_\_\_

A \_\_\_\_\_

DISTRICT \_\_\_\_\_

DATE \_\_\_\_\_

DATE SYSTEM APPROVED \_\_\_\_\_

INSPECTOR \_\_\_\_\_

**HOWARD COUNTY HEALTH DEPARTMENT**  
**BUREAU OF ENVIRONMENTAL HEALTH**

461-9333

\_\_\_\_\_ IS PERMITTED TO INSTALL \_\_\_\_\_ ALTER \_\_\_\_\_

ADDRESS \_\_\_\_\_ PHONE \_\_\_\_\_

SUBDIVISION \_\_\_\_\_ LOT \_\_\_\_\_ ROAD 13881 Forsythe Rd

PROPERTY OWNER \_\_\_\_\_

ADDRESS \_\_\_\_\_

PLANS APPROVED BY \_\_\_\_\_ DATE \_\_\_\_\_

COVER NO WORK UNTIL INSPECTED AND APPROVED

NEITHER THE HOWARD COUNTY COUNCIL NOR THE HEALTH DEPARTMENT IS RESPONSIBLE FOR THE SUCCESSFUL OPERATION OF ANY SYSTEM

NOTE: CLEANOUT REQUIRED EVERY 70 FEET OF SEWER LINE AND/OR AT 90° SWEEPS IN LINES FROM HOUSE TO DRAIN FIELDS. 90° ELBOWS NOT ACCEPTABLE.

NOTE: ALL PARTS OF SEPTIC SYSTEMS (I.E. TANK, DISTRIBUTION BOX TRENCHES) TO BE 100 FEET FROM WELL (UNLESS OTHERWISE SPECIFICALLY AUTHORIZED)

NOTE: IF DEEP TRENCH(ES) ARE USED CALL FOR INSPECTION BEFORE AND AFTER PLACING GRAVEL IN TRENCH(ES)

NOTE: NO DRY WELL SHALL EXCEED 15 FOOT IN DIAMETER NO ABSORPTION TRENCH TO EXCEED 100 FEET IN LENGTH

NOTE: ALL PIPE FROM HOUSE TO SEPTIC TANK MUST BE CAST IRON OR SCHEDULE 35/40 PVC OR ABS

PERMIT VOID AFTER TWO YEARS

NOTE: INSTALL STAND PIPE ON SEPTIC TANK AND DRY WELL STAND PIPES MUST BE 6 INCHES IN DIAMETER CAST IRON, CONCRETE OR TERRA COTTA OF PVA OR ABS ACCEPTED. IF TOP OF SEPTIC TANK IS DEEPER THAN 3 FEET, MANHOLE TO GRADE REQUIRED.

NOTE: DISTRIBUTION BOXES MUST HAVE BAFFLES

INSTALLER IS RESPONSIBLE FOR OBTAINING FINAL APPROVAL ON THIS PERMIT

514733B



C1 2832 SEQUENCE NO. (MDE USE ONLY)

STATE OF MARYLAND WELL COMPLETION REPORT

THIS REPORT MUST BE SUBMITTED WITHIN 45 DAYS AFTER WELL IS COMPLETED.

(THIS NUMBER IS TO BE PUNCHED IN COLS. 3-6 ON ALL CARDS)

FILL IN THIS FORM COMPLETELY PLEASE PRINT OR TYPE

COUNTY NUMBER ON DUS 10/13/95 SRW

ST/CO USE ONLY DATE RECEIVED

DATE WELL COMPLETED 09/13/95

Depth of Well 185

PERMIT NO. FROM "PERMIT TO DRILL WELL" H0-94-0674

OWNER Hudson, Richard STREET OR RFD Forsythe Road Tax Map 12116 TOWN Glenwood SUBDIVISION N/A SECTION LOT

WELL LOG table with columns: DESCRIPTION, FEET (FROM, TO), check if water bearing. Includes entries for Brown Shale and Blue Rock.

GROUTING RECORD form including fields for material type (CM, BC), number of bags (26), and gallons of water (156).

CASING RECORD form including fields for casing type (ST, PL, CO, OT) and nominal diameter (6 inches).

MAIN CASING TYPE form including fields for nominal diameter (6 inches) and total depth (81 feet).

OTHER CASING (if used) form with fields for diameter and depth.

SCREEN RECORD form including fields for screen type (ST, BR, HO, PL, OT) and slot size.

WELL HYDROFRACTURED form with 'yes' (Y) and 'no' (N) options.

Circle appropriate letter (A, E, P) for well status: abandoned, electric log, or production.

I HEREBY CERTIFY THAT THIS WELL HAS BEEN CONSTRUCTED IN ACCORDANCE WITH COMAR 26.04.04 "WELL CONSTRUCTION" AND...

TYPE: MWD/MSD/MGD DRILLERS LIC. NO. 24

DRILLERS SIGNATURE Joseph E. Mayoral

LIC. NO. 27 DRILLERS SIGNATURE Larry M. [Signature]

SITE SUPERVISOR (sign. of driller or journeyman responsible for sitework if different from permittee)

DEPTH (nearest ft.) form with grid for recording depth intervals (1-51 feet).

GRAVEL PACK IF WELL DRILLED WAS FLOWING WELL INSERT F IN BOX 68

MDE USE ONLY (NOT TO BE FILLED IN BY DRILLER) form with fields for telescope casing, log indicator, and other data.

PUMPING TEST form including fields for hours pumped (3), pumping rate (007.5), and pump type (submersible).

PUMP INSTALLED form including fields for pump type (S), capacity (gallons per minute), and pump column length.

LOCATION OF WELL ON LOT SHOW PERMANENT STRUCTURE SUCH AS BUILDING, SEPTIC TANKS, AND/OR LANDMARKS AND INDICATE NOT LESS THAN TWO DISTANCES (MEASUREMENTS TO WELL). See attached location Forsythe Rd.





September 6, 1995

Howard County Environmental Health

Attn: Amy

The well we are drilling on our 20-acre lot will be used for agriculture use; for watering cattle and watering our garden area. The greenhouses will be left on the old well.

Yours truly,



Richard C. Hudson

SITE INSPECTION SHEET

OWNER: Hudson

DATE REQUESTED: 8-29-95

ADDRESS: 13881 Forsythe Rd.

DRILLER: \_\_\_\_\_

Sykesville

WELL TAG # \_\_\_\_\_

COUNTY # \_\_\_\_\_

PROPOSAL: wants to drill well for agriculture use only

LOCATION DIAGRAM

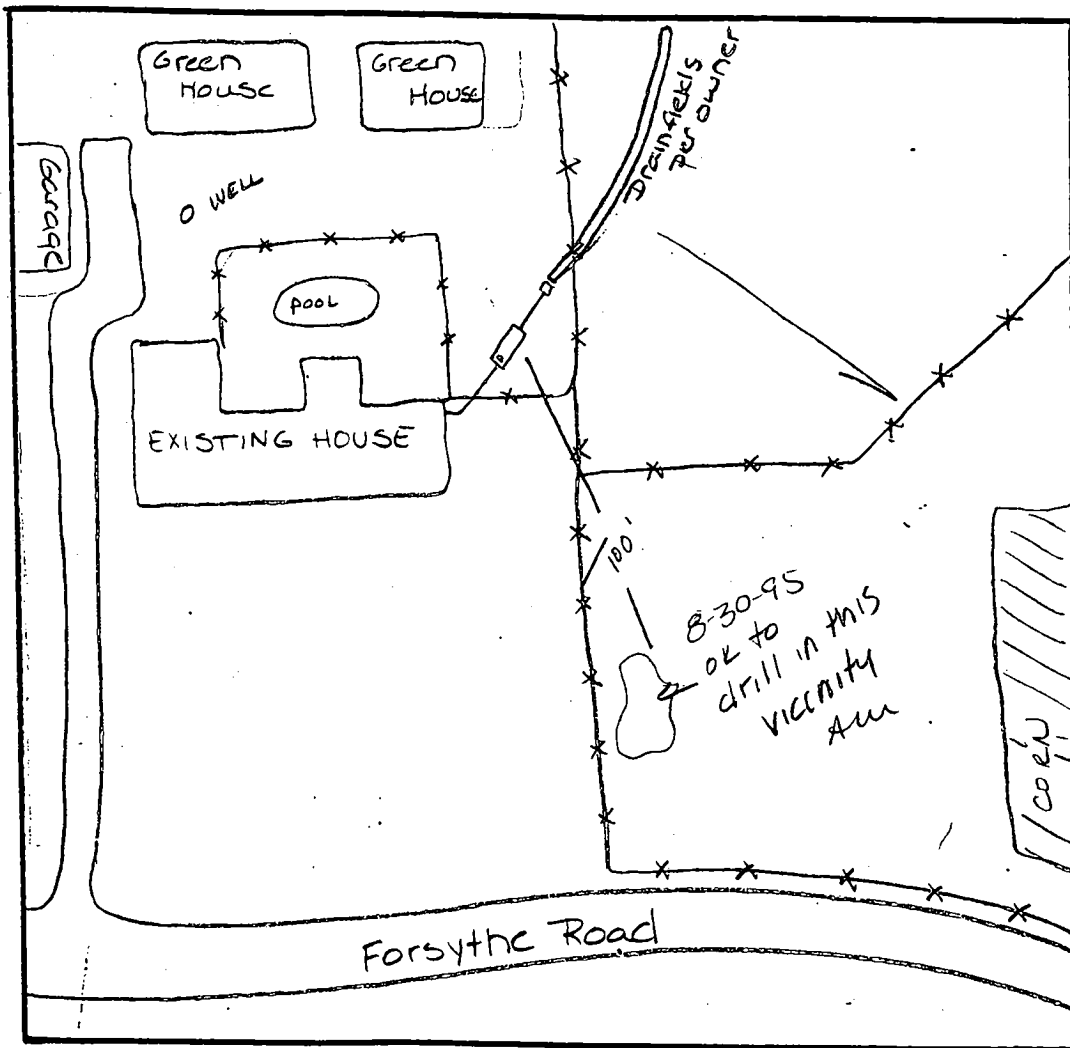

COMMENTS: 8-30-95 OK to drill where shown - Well is on an approved lot - (recorded SOA) so well to be drilled as a new well, not agriculture use

DATE: 8-30-95

INSPECTOR: Amy McMiller