

12/27/00 1/4/01 Co.  
10:00 10 + later  
1/5/01 Co. in progress

# PERMIT

SEWAGE DISPOSAL SYSTEM  
HOWARD COUNTY HEALTH DEPARTMENT  
BUREAU OF ENVIRONMENTAL HEALTH  
410-313-2640

P 514638

A REPAIR

ISSUE DATE 11/9/2000

APPROVAL DATE 1/5/2001

RPS# 263300

INDEXED

Scardina Plumbing & Heating IS PERMITTED TO INSTALL          ALTER         

ADDRESS 8082 Veterans Hwy, Millersville, MD 21108 PHONE 410-761-6900

SUBDIVISION Patapsco Park ~~SEWERS~~ LOT NUMBER 22 ADDRESS 9080 Furrow Avenue

PROPERTY OWNER Keith <sup>MILLER</sup> ~~Miller~~ PROPERTY OWNER'S ADDRESS Same

SEPTIC TANK CAPACITY 1000 GALLONS (existing) (check out Baffle + replace if necessary)

PUMP CHAMBER CAPACITY NA GALLONS

NUMBER OF BEDROOMS 3

SQUARE FEET PER BEDROOM 240 sqft

LINEAR FEET OF TRENCH REQUIRED 240 Lin. Ft.

TRENCHES: Trenches to be 3 feet wide. Inlet 3 feet below original grade. Bottom maximum depth 5 feet below original grade. 2 feet of stone below distribution box.

LOCATION:

REPAIR - PURPOSE - Existing septic system has failed.  
Call for inspection when ground is opened so sanitarian can recommend repair.

11/9/2000

OK to install several short trenches (day/ps 50' long if possible) in higher part of SDB. Can make trenches longer

once past driveway retaining wall. OK to use 30' section of existing dry trench + lengthen it if possible.

Install a dist box + disconnect front vent fan to trench (48" one). Maintain 10ft from retaining walls + leaks.

PLANS APPROVED APB/MLC DATE 12/27/00

PERMIT VOID AFTER 2 YEARS

NOTE: CONTRACTOR RESPONSIBLE FOR SCHEDULING A PRE-CONSTRUCTION INSPECTION FOR ALL INSTALLATIONS

NOTE: TOP OF SEPTIC TANKS ARE TO BE NO DEEPER THAN 3.0 FEET BELOW FINISH GRADE

NOTE: WATERTIGHT SEPTIC TANKS REQUIRED

NOTE: CLEANOUT REQUIRED EVERY 70 FEET OF SEWER LINE AND/OR AT 90° SWEEPS IN LINES FROM HOUSE TO DRAIN FIELDS, 90° ELBOWS ARE NOT ACCEPTABLE

NOTE: ALL PARTS OF SEPTIC SYSTEMS (I.E. TANK, DISTRIBUTION BOX, DRAINFIELDS) TO BE 100 FEET FROM ANY WATER WELL UNLESS OTHERWISE SPECIFICALLY AUTHORIZED

NOTE: NO ABSORPTION TRENCH TO EXCEED 100 FEET IN LENGTH UNLESS SPECIFICALLY AUTHORIZED

NOTE: ALL PIPE FROM HOUSE TO SEPTIC TANK MUST BE CAST IRON OR SCHEDULE 35/40 PVC OR ABS

NOTE: MANHOLE RISERS REQUIRED ON ALL SEPTIC TANKS AND PUMP CHAMBERS

NOTE: DISTRIBUTION BOXES MUST HAVE BAFFLES

NOTE: IF PUMPED SEPTIC SYSTEM REQUIRED, (1) SEPTIC PUMP DETAIL TO BE PROVIDED BY INSTALLER PRIOR TO ISSUANCE OF SEPTIC PERMIT (2) PUMP PERFORMANCE TEST IS NECESSARY PRIOR TO HEALTH DEPARTMENT APPROVAL OF SEPTIC PERMIT

NEITHER THE HOWARD COUNTY COUNCIL NOR THE HEALTH DEPARTMENT IS RESPONSIBLE FOR THE SUCCESSFUL OPERATION OF ANY SYSTEM

PERMITTEE RESPONSIBLE FOR OBTAINING FINAL APPROVAL ON THIS PERMIT

CALL 410-313-2640 FOR INSPECTION OF SEPTIC SYSTEM

P514638

Per @ 5

10:48 start

10:58 2nd Unit

11:14 3rd Unit

16 mps = 2400 ft / Blom

3' x 3 Blom = 240 LF trench needed

- 6' Red - top soil (organic)
- 8' Brn - yellow
- 3' CL
- Red - yellow (Mace)
- Medium Loam
- 6' grey PSL (massive)
- 4' Red - top soil (organic)

NOT TO SCALE

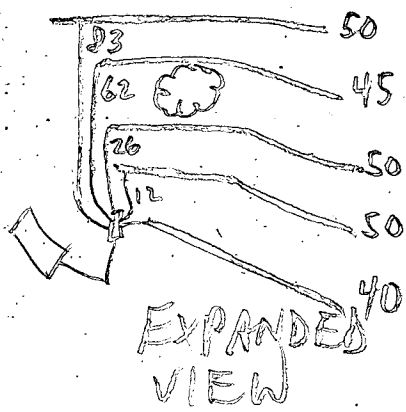

EXPANDED VIEW

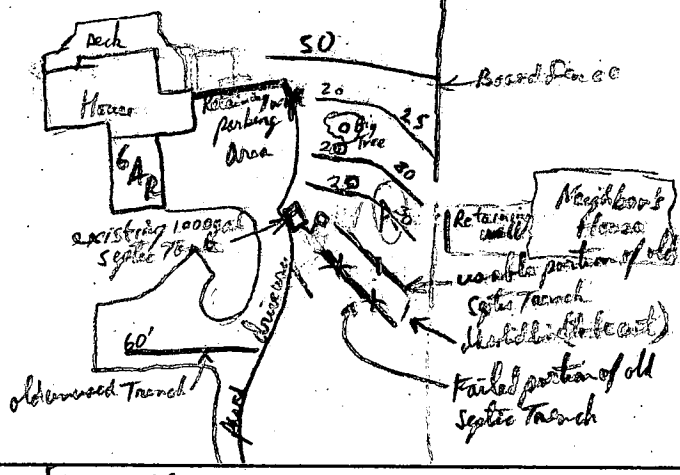

TRENCH DATA

TRENCH WIDTH 3'  
 TRENCH INLET DEPTH 3'  
 TRENCH BOTTOM DEPTH 5'  
 DEPTH OF STONE 2'  
 NUMBER OF TRENCHES 5  
 TOTAL TRENCH LENGTH 240±  
 (1-40' x 2, 2-3) + 50' each,  
 ABSORBENT AREA 720  
 DISTRIBUTION BOX LEVEL   
40 @ Box  
 BAFFLE IN DISTRIBUTION BOX

SEPTIC TANK DATA

SEPTIC TANK existing <sup>1000 Mid Sec</sup> GALLONS  
 MANHOLE RISER New outlet Baffle (PVC) installed  
6 INCH INSPECTION PORT  
(Large Square access Manholes in 5' x 5')  
 PUMP CHAMBER DATA  
 PUMP CHAMBER GALLONS                       
 MANHOLE RISER                       
 ALARM                       
 PUMP PERFORMANCE TEST                     

PRE-CONSTRUCTION INSPECTION: Per @ 3'-5 ft @ 16 mps Test Hole A. Per size for 2400 ft = 80 L.F. / Blom x 3 = 240 L.F.

old replacement system. RP 12/27/00 Failed old trench was disconnected

INSPECTION COMMENTS: Old Trench extended to 40 ft long (OK to cover), db cut, New PVC outlet Baffle installed in S.T.

Started digging second Trench (First New Trench) Reopen digging slow due to Frozen Ground (10" freeze) + Tight Space, OK to proceed. RP 1/4/01 Dirt Box Marked by clean cut pipe, 2nd + 3rd Trenches gravelled, piped, covered, and OK to cover. Call for More Imp. Transducer. 1/4/01 RP

1/5/01 1:00 OK, CONTINUE 1/5/01 3:00 OK, FINISH + COVER

INSPECTOR M. Ripkin DATE SYSTEM APPROVED 1/5/01



Department of Public Works  
BUREAU OF UTILITIES

---

*Robert M. Beringer, Bureau Chief*

December 8, 2000

Mr. Steve Szymanski  
8082 Veterans Highway  
Millersville, MD 21108

Subject: 9080 Furrow Road  
W/S Contract 14-3153-D, Lot 15  
Public Sewer House Connection

Dear Mr. Szymanski:

I reviewed your request for a public sewer connection at the above referenced lot in order to replace a failing septic system. Public sewer is located on Furrow Avenue, but would need to be extended approximately 800 feet in order to front this property. In addition, the sewer main which runs behind the property is not deep enough to cross under the on-site stream which is located along the rear property line.

Therefore, at this time we are unable to provide a standard gravity sewer connection to this property.

If you have any questions or would like to pursue other options, I can be contacted at 410-313-4943.

Sincerely,

A handwritten signature in black ink, appearing to read "John Schaeffer".

John Schaeffer  
Bureau of Utilities