

from 6/2/69 with approval when given in install

6/3/69 after 1st install

6/11/69

PERMIT

SEWAGE DISPOSAL SYSTEM

MARYLAND STATE DEPARTMENT OF HEALTH

HOWARD COUNTY

ELLICOTT CITY

DISTRICT 3

DATE 2/13/69

P 14265

A 08115

app-6-4-69 DWJ

INDEXED

William Schneider IS PERMITTED TO INSTALL ALTER

ADDRESS Rt. 3, Box 167A, Sykenville, Md. PHONE 787-2227

A SEWAGE DISPOSAL SYSTEM LOCATED AT _____

SUBDIVISION _____ ROAD Day Rd. - see LOT _____

PROPERTY OWNER Clarence Baseler -- New Owner Carroll W. Kelly
application for better directions

ADDRESS _____

SPECIFICATIONS - 3 bedrooms

DRAIN FIELD _____ DEPTH _____ FEET, BOTTOM AREA _____ SQ. FT.

SEEPAGE PITS _____ ABSORBENT SIDE-WALL AREA _____ SQ. FT.

SEPTIC TANK CAPACITY 750 GALLONS

FOR GARBAGE GRINDER, INCREASE DISPOSAL AREA 22% & TANK CAPACITY 50%.

OTHER Dry well - 300 sq. ft. absorbent sidewall area below inlet pipe.

Inlet pipe must be 4 ft. below original ground level. Maximum depth 12 ft.

Locate dry well 303 ft. from front lot line and 115 ft. from right side line

as lot is seen facing from Day Road.

PERMIT VOID AFTER THREE YEARS.

PLANS APPROVED BY Donald W. Monaghan DATE 3/17/64

FILL SEPTIC TANK AND DISTRIBUTION BOX WITH WATER BEFORE CALLING FOR AN INSPECTION. COVER NO WORK UNTIL INSPECTED AND APPROVED.

NEITHER THE HOWARD COUNTY COMMISSIONERS NOR THE HEALTH DEPARTMENT IS RESPONSIBLE FOR THE SUCCESSFUL OPERATION OF ANY SYSTEM.

NOTIFY THE HEALTH DEPARTMENT 48 HOURS BEFORE EXCAVATIONS ARE TO BE BACK FILLED.

108115

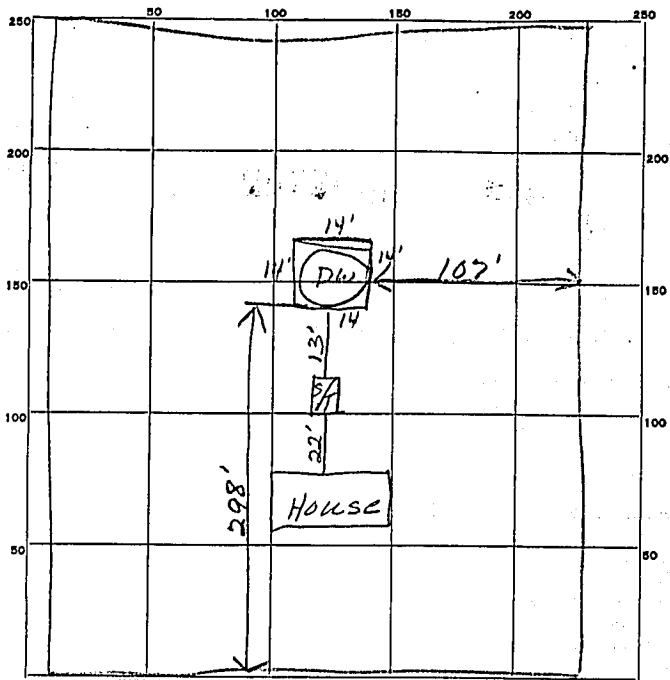

INDICATE NORTH. - NAME ADJOINING ROADWAY AS BASE LINE.

PERMIT CARD OK Day Road

SEPTIC TANK, LEVEL OK CLEANOUTS OK

DISTRIBUTION BOX, LEVEL _____

TILE FIELD, DEPTH _____ FT. TRENCH WIDTH _____ FT.

GRAVEL DEPTH _____ IN. TOTAL LENGTH _____ FT.

NUMBER OF TRENCHES _____ TOTAL BOTTOM AREA _____

SEEPAGE PITS, INSIDE DIAMETER 14x14 x 14x14 12 FT. DEPTH BELOW INLET 8 1/2 FT.

ABSORBENT AREA 476 SQ. FT.

REMARKS time 2:30 pm no gravel in dry well. jro

DATE SYSTEM APPROVED 11/19 INSPECTOR R.W. M...