

PUB. SEWER STATUS VERIFIED BY _____

ISSUE DATE: _____

APPROVAL DATE: _____

PERMIT INDEXED

P _____

A 514623-A

RPS#??

ON-SITE SEWAGE DISPOSAL SYSTEM HOWARD COUNTY HEALTH DEPARTMENT BUREAU OF ENVIRONMENTAL HEALTH

_____ IS PERMITTED TO INSTALL ALTER

ADDRESS: _____ PHONE NUMBER: _____

SUBDIVISION: _____ LOT NUMBER: _____

ADDRESS: 16033 Frederick Road PROPERTY OWNER: Charles Snouffer

SEPTIC TANK CAPACITY (GALLONS): _____

PUMP CHAMBER CAPACITY (GALLONS): _____

NUMBER OF BEDROOMS: _____

SQUARE FEET PER BEDROOM: _____

LINEAR FEET OF TRENCH REQUIRED: _____

TRENCHES:	Trench to be _____ feet wide. Inlet _____ feet below original grade. Bottom maximum depth _____ feet below original grade. Effective area begins at _____ feet below original grade. _____ feet of stone below distribution pipe.
LOCATION:	
PURPOSE:	

PLANS APPROVED: _____ DATE: _____

- NOTE: PERMIT VOID AFTER 2 YEARS
- NOTE: CONTRACTOR RESPONSIBLE FOR SCHEDULING A PRE-CONSTRUCTION INSPECTION FOR ALL INSTALLATIONS
- NOTE: WATERTIGHT SEPTIC TANKS REQUIRED
- NOTE: ALL PARTS OF SEPTIC SYSTEM SHALL BE 100 FEET FROM ANY WATER WELL
- NOTE: MANHOLE RISERS REQUIRED ON ALL SEPTIC TANKS AND PUMP CHAMBERS

NEITHER THE HOWARD COUNTY COUNCIL NOR THE HEALTH DEPARTMENT IS RESPONSIBLE FOR THE SUCCESSFUL OPERATION OF ANY SYSTEM PERMITTEE RESPONSIBLE FOR OBTAINING FINAL APPROVAL ON THIS PERMIT CALL 410-313-2640 FOR INSPECTION OF SEPTIC SYSTEM

4514623-A

A 514623 A



HOWARD COUNTY HEALTH DEPARTMENT

Diane L. Matuszak, M.D., M.P.H., County Health Officer

November 3, 2000

To: Howard County Office of Licenses and Permits

From: Craig Williams (CW)
Sanitarian

Subject: Request for demolition permit – 16033 Frederick Rd., Lisbon, Md.
Owned by Charles and Joan Snouffer of 1660 Route 94, Woodbine, Md.

This is to confirm that the Health Department is satisfied with the plan of protection (as submitted 11/3/00 by Crystal Alexander for Dirty Works Contracting) for the well and septic systems serving the collective buildings at 16033 – 16037 – 16041 Frederick Rd. A copy of that plan is attached.

Accordingly, this office has no objection to issuance of the requested demolition permit.

encl.

cc: Crystal Alexander
Charles Snouffer

A 514623 A

DIRTY WORKS CONTRACTING LLC
 1680 LINZEE DRIVE
 WESTMINSTER, MD 21157
 301-831-7450**410-875-2849
 Fax: 301-831-5314

Fax

To: Water Sewerage Program	From: Crystal Alexander
Attn: Craig Williams	Pages: 2 Including cover
Fax: 1-410-313-2648	Date: 11/3/00
Re:	CC:

Urgent For Review Please Comment Please Reply Please Recycle

● Comments:

Mr. Williams

Attached is another attempt at a sketch of the area, structures, location of well and septic's. Every precaution will be taken to not disturb the existing well and septic sites. Should any water or septic lines be uncovered during demolition of the structure they will be capped. Access to 16033 will be made from the east and south sides of the property as to not disturb the property any more than necessary.

Hope this shows all the details you require to provide a release, if not please feel free to give me a call my mobile number is 301-674-6373.

Please fax permission so we may proceed with the application for a demolition permit.

Thanks

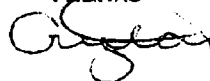

CONFIDENTIALITY NOTICE

The information contained in this telefacsimile message is privileged and confidential, and intended only for the use of the individual(s) and/or entity(ies) named above. If you are not the intended recipient, you are hereby notified that any unauthorized disclosure, copying, distribution or taking of any action in reliance on the contents of the telecopy materials is strictly prohibited and review by any individual other than the intended recipient shall not constitute waiver of the attorney/client privilege. If you have received this transmission in error, please immediately notify us by telephone to arrange for the return of the materials. Thank you.

Dirty Works Contracting LLC

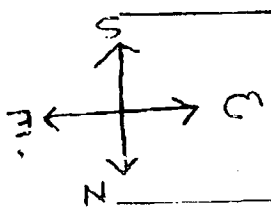

Entrance ↘

Entrance ↙

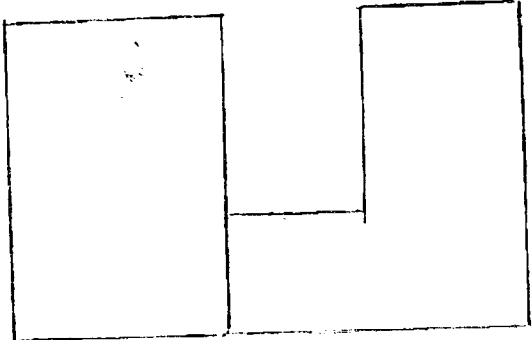

↙ 16033
 Structure to be demolished
 Septic

↘ 16037
 to remain at this time

Well

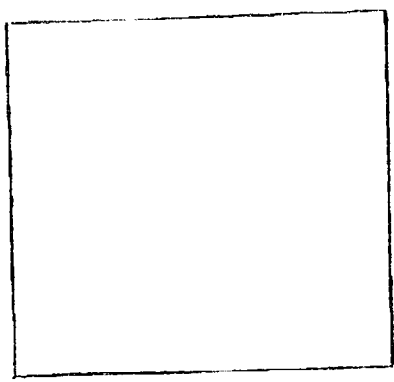

↙ 16041
 to remain at this time
 Septic

Frederick Road

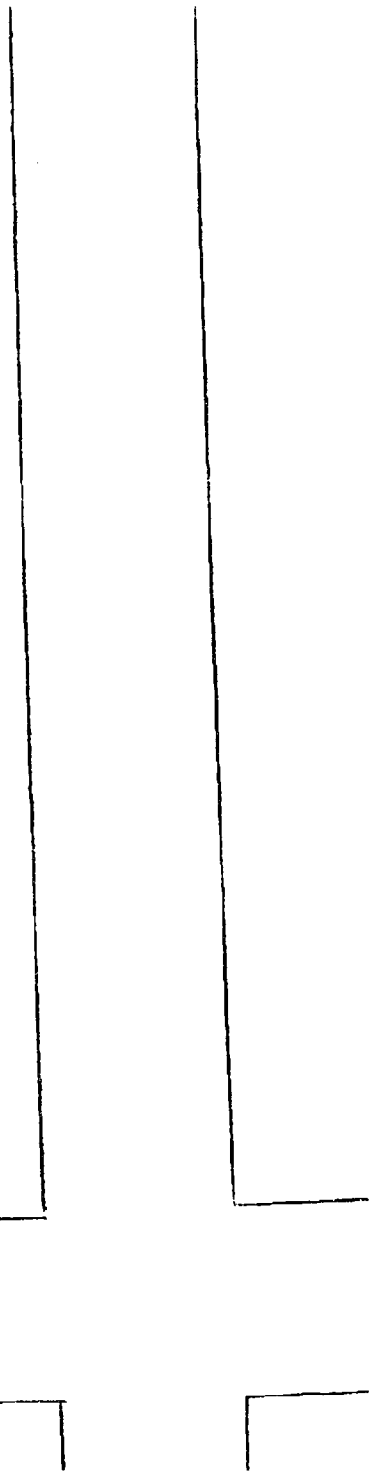



HOWARD COUNTY HEALTH DEPARTMENT

Diane L. Matuszak, M.D., M.P.H., County Health Officer

August 15, 2000

Dirty Works Contracting LLC
4680 Linzee Drive
Westminster, Md 21157

Attention: Crystal Alexander

Crystal,

Thank you for your faxletter of 8/15 requesting permission to abandon the well for Ms. Joan Snouffer, serving 16035, 16037, and 16041 Frederick Road in Lisbon. However, ***permission to abandon the well is not granted at this time.*** There are several issues of potential concern to be addressed before beginning this work.

The first two concerns are technical. The first issue is licensing requirements. Per provisions of the Maryland Well Construction Regulation (COMAR 26.04.04 – copy of relevant portion enclosed), if a licensed well driller is not performing the work, then a member of the Health Department needs to be present to perform the work. The second technical issue is that the proposed amount of sealing material is insufficient. Three or more feet of sealing material are required depending upon the construction of the well as determined from inspection by an appropriately licensed individual. Some wells would be better abandoned using the specialized equipment of a well driller even if a Health Department representative is present; other types of wells, by nature of their construction, may be more effectively abandoned by a general contractor.

The remaining concerns are practical. Your letter suggests the intent of this action is to qualify for a demolition permit, but for which properties? Are any structures intended to remain? If so, what will be their water supply; and what septs are to be abandoned and what are to remain? Or is some new and larger use intended? In order to be certain that future purposes are properly served by this action, it is suggested that the property owner submit a site plan for review to determine that the intended outcome can be accomplished.

Please contact me at this office to resolve these questions so the request to abandon the well can be granted.

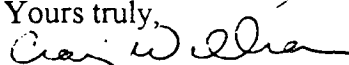
Yours truly,

Craig Williams, Sanitarian

(a) Act as a channel for the interchange of waters of undesirable quality with those whose quality is desirable; or

(b) Present a hazard to the safety and well-being of humans or animals.

(2) The Department or Approving Authority may require the well owner to have a well abandoned and sealed if it:

(a) Is causing or is a potential source of pollution of waters of the State;

(b) Is producing water that is polluted; or

(c) Does not have a certificate of potability, if required.

* (3) Any well abandoned shall be sealed only by a well driller licensed by the Maryland State Board of Well Drillers or under the supervision of a master well driller or a representative of the Department or Approving Authority.

(4) Abandonment Approval. When the Department or Approving Authority has reason to believe on the basis of local conditions that abandonment of a well necessitates close supervision, it may require the submission of sealing plans and specifications for approval before abandonment operations.

(5) Observation Wells. Wells used for the investigation or management of ground water are not considered "abandoned" so long as they are maintained for this purpose. Wells without pumps shall be covered with a secure cap when measurements are not being made.

(6) Reports on the Abandonment of Wells. When a well is abandoned, the person abandoning it, or the owner, shall notify the Approving Authority of this action by completing an Abandoned Well Report form provided by the Approving Authority. This report shall be submitted not later than 30 days after abandonment of the well or test hole.

E. Materials for Filling and Sealing Wells.

(1) Sealing Materials.

(a) Concrete, Portland cement grout, sodium-base bentonite clay, or combinations of these materials may be used to seal a well.

(b) Used drilling muds are not to be used to seal a well.

(c) Concrete. Concrete may be used for filling the upper part of the well or water bearing formation, or plugging short sections of casing and filling large diameter wells.

DIRTY WORKS CONTRACTING LLC

1680 LINZEE DRIVE
WESTMINSTER, MD 21157
301-831-7450**410-875-2849
Fax: 301-831-5314

Fax

To: Water Sewerage Program	From: Crystal Alexander
Attn: Craig Williams	Pages: 1 Including cover
Fax: 1-410-313-2648	Date: 8/15/00
Re:	CC:

Urgent For Review Please Comment Please Reply Please Recycle

Comments:

JOAN SNOUFFER

DIRTY WORKS CONTRACTING requests permission to fill one hand dug well will gravel and cap with 8" of concrete which serviced 16035, 16037 and 16041 Frederick Road, Lisbon, MD. Please fax permission so we may proceed with the fill and apply for a demolition permit.

If you require any additional information, please feel free to give me a call at the above number or on my mobile 301-674-6373.

Thanks



CONFIDENTIALITY NOTICE

The information contained in this telefacsimile message is privileged and confidential, and intended only for the use of the individual(s) and/or entity(ies) named above. If you are not the intended recipient, you are hereby notified that any unauthorized disclosure, copying, distribution or taking of any action in reliance on the contents of the telecopy materials is strictly prohibited and review by any individual other than the intended recipient shall not constitute waiver of the attorney/client privilege. If you have received this transmission in error, please immediately notify us by telephone to arrange for the return of the materials. Thank you.



HOWARD COUNTY HEALTH DEPARTMENT

Diane L. Matuszak, M.D., M.P.H., County Health Officer

September 1, 2000

Dirty Works Contracting LLC
4680 Linzee Drive
Westminster, Md 21157

Attention: Darrel Winkler

This is to confirm the line-of-discussion from our meeting this morning at the properties of Ms. Joan Snouffer, at 16035, 16037, and 16041 Frederick Road in Lisbon. The purpose was to review and septic abandonment procedures to qualify for demolition permit.

A dug well sited between the two principle structures appears to be the only watersupply for the combined properties; there seem to be as many as three septic systems. A site sketch is enclosed for clarification.

If the well is not to be abandoned by a licensed driller, then a Sanitarian from this office needs to be present when the work is done. It is acceptable to remove the well house, "peel back" the at-grade concrete pit, and remove any plumbing prior to the arrival of the inspecting Sanitarian. The Sanitarian needs to inspect the "ready-to-fill" well and the intended fill material before any materials are actually placed in the well.

Topsoil or other surface materials are not suitable as fill because of the amount of contamination that could potentially be present. Subsurface mineral soil or quarried material, such as sand or gravel are appropriate. Near the top of the well, a three foot cap of concrete that extends beyond the edges of the well is needed to seal the well. Again, none of these materials should be placed in the well until inspected and approved by a Sanitarian.

There is a greater range of acceptable fill materials for the septic system, are there is not an inspection or licensing requirement to perform the work. But from a practical point of view it will likely be most efficient to use all the same fill materials and to take advantage of the Sanitarian's presence to document the work.

At the time of abandonment, if you bring a letter (2 copies) to the site, identifying the site, the property owner, attesting to the abandonments, and requesting Health Department recommendation for demolition permit approval, we can sign the letter and expedite the approval process.

Craig Williams, Sanitarian

SITE INSPECTION SHEET

OWNER: JOHN SNOUFFER

DATE REQUESTED: 9/1/00

ADDRESS: _____

~~DRILLER/CONTRACTOR:~~ DIRTY WORKS

WELL TAG NUMBER: _____

TAX & PARCEL: _____

COUNTY: _____

PROPOSAL: P16 WELL & SEPTIC ABANDONMENT INSPECTION TO
QUALIFY FOR DEMOLITION PERMIT. NO HEALTH DEPT RECORDS

LOCATION DIAGRAM OF WELL OR SEPTIC INSTALLATION ARE ON FILE.

BENT NIXON - SUPERVISOR OF CEHS PROGRAM
 CONFIRMS THERE ARE NO LISBON GASOLINE CONTAMINATION
 ISSUES TO BE CONCERNED WITH AT THIS SITE.

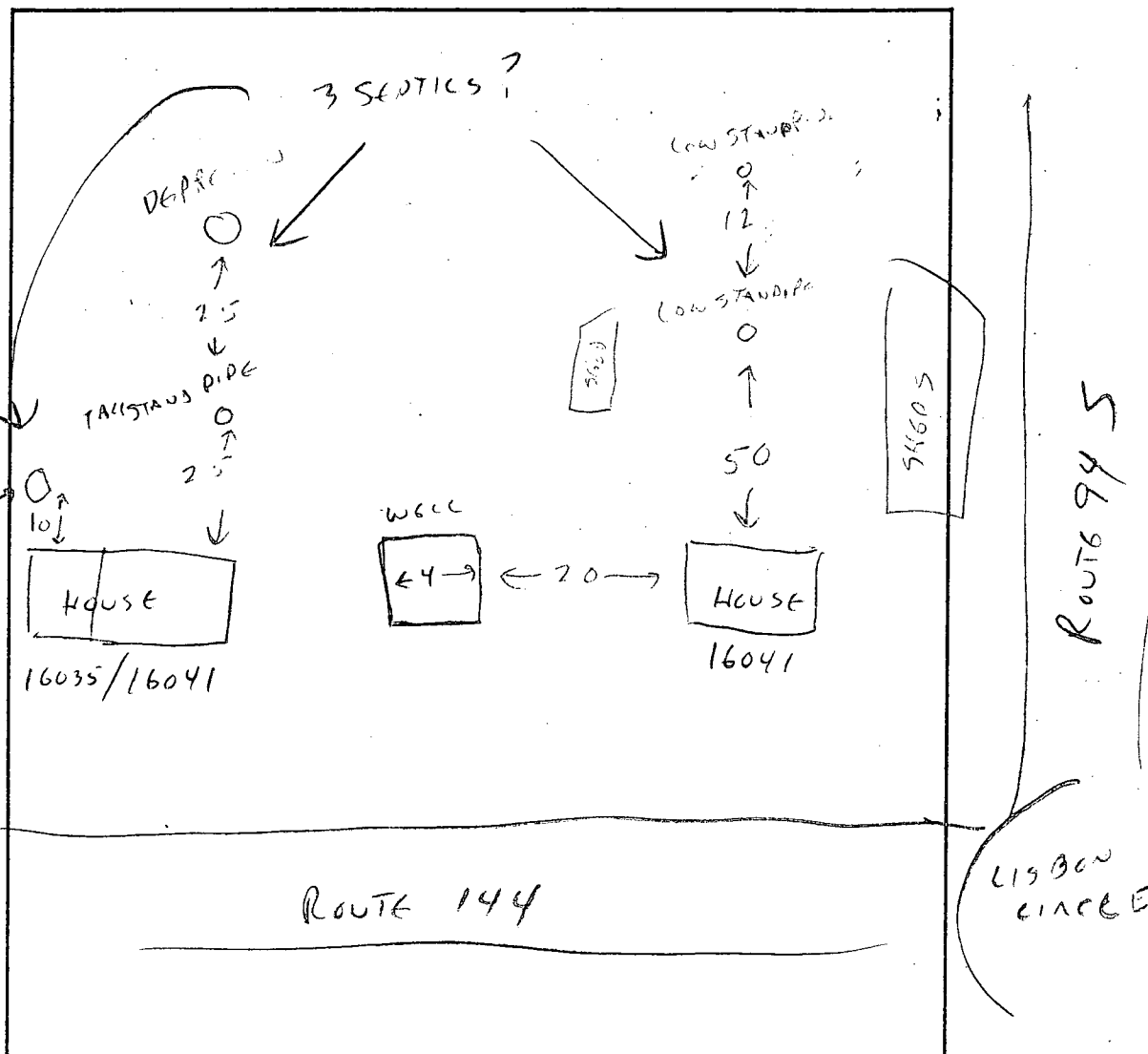

COMMENTS: MET DARRYL WINKLER - OF DIRTY WORK INC WESTMINSTER
TO WALK SET, DISCUSS ABANDONMENT PROCEDURES. SEE
ATTACHED LETTER FOR DETAILS. HE INDICATED THAT CLEARANCE FROM
HISTORICAL COMMISSION MIGHT DELAY START OF WORK FOR A FEW WEEKS.

DATE: 9/1/00

INSPECTOR: CW [Signature]

 WATER WELL ABANDONMENT-SEALING REPORT FORM

SUBMIT COPIES OF COMPLETED FORM TO:

- * COUNTY ENVIRONMENT AGENCY (contact MDE, IWMA if address needed)
- * WELL OWNER
- * MDE, WATER MANAGEMENT ADMINISTRATION, WELL PROGRAM

DATE WELL ABANDONED: September 5, 2002 (month/day/year)

* PERMIT NUMBER OF ABANDONED WELL (if any) _____

* PERMIT NUMBER OF REPLACEMENT WELL _____

* PERSON ABANDONING WELL: Maurice Dixon

WELL DRILLERS LICENSE NUMBER: 0666
 CIRCLE: MWD/MSD/MGD

* OWNER'S NAME: Brantly Development

SITE LOCATION MAP

* WELL LOCATION:
 COUNTY: Howard
 NEAREST TOWN: _____
 TAX MAP _____ BLOCK _____ PARCEL _____
 SUBDIVISION: _____
 SECTION: _____ LOT: _____
 NEAREST ROAD: Frederick Road

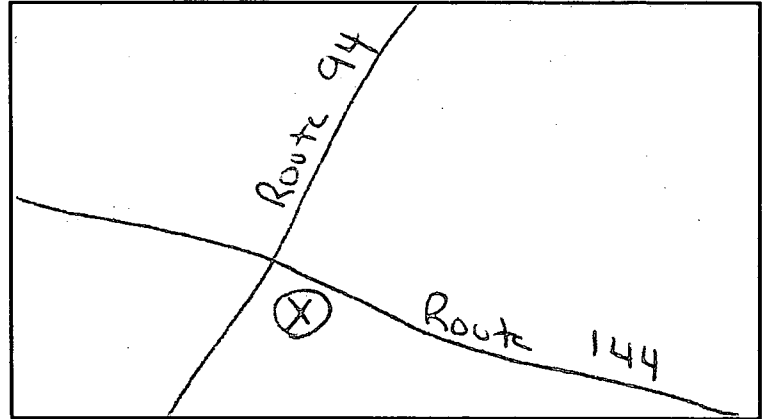

* TYPE OF WELL BEING ABANDONED:

- _____ DRILLED _____ JETTED
- _____ BORED/AUGERED HAND DUG
- _____ OTHER (specify) _____

LOG OF SEALING MATERIAL

* USE CODE:

- DOMESTIC _____ MUNICIPAL/PUBLIC
- _____ IRRIGATION _____ INDUSTRIAL
- _____ TEST/OBSERVATION _____ GEOTHERMAL

MATERIAL	FEET	
	FROM	TO
Crushed Stone	40	5
Portland Cement	5	2
Soil	2	0
VOLUME OF MATERIAL USED		
20 TONS OF STONE		

* TYPE OF CASING:

- _____ STEEL _____ PLASTIC
- _____ CONCRETE OTHER (specify) Stone

* SIZE OF CASING: 42 INCHES IN DIAMETER

* DEPTH OF WELL: 40 FEET DEEP

* WAS ANY CASING REMOVED? _____ YES NO
 if yes, length removed, in feet: _____

* WAS CASING RIPPED OR PERFORATED? _____ YES NO

SIGNATURE - MASTER WELL DRILLER OR SUPERVISING SANITARIAN: Maurice Dixon LICENSE # 0666 MWD/MSD/MGD CIRCLE ONE 9/6/02 DATE



HOWARD COUNTY HEALTH DEPARTMENT

Diane L. Matuszak, M.D., M.P.H., County Health Officer

September 1, 2000

Dirty Works Contracting LLC
4680 Linzee Drive
Westminster, Md 21157

Attention: Darrel Winkler

This is to confirm the line-of-discussion from our meeting this morning at the properties of Ms. Joan Snouffer, at 16035, 16037, and 16041 Frederick Road in Lisbon. The purpose was to review and septic abandonment procedures to qualify for demolition permit.

A dug well sited between the two principle structures appears to be the only watersupply for the combined properties; there seem to be as many as three septic systems. A site sketch is enclosed for clarification.

If the well is not to be abandoned by a licensed driller, then a Sanitarian from this office needs to be present when the work is done. It is acceptable to remove the well house, "peel back" the at-grade concrete pit, and remove any plumbing prior to the arrival of the inspecting Sanitarian. The Sanitarian needs to inspect the "ready-to-fill" well and the intended fill material before any materials are actually placed in the well.

Topsoil or other surface materials are not suitable as fill because of the amount of contamination that could potentially be present. Subsurface mineral soil or quarried material, such as sand or gravel are appropriate. Near the top of the well, a three foot cap of concrete that extends beyond the edges of the well is needed to seal the well. Again, none of these materials should be placed in the well until inspected and approved by a Sanitarian.

There is a greater range of acceptable fill materials for the septic system, are there is not an inspection or licensing requirement to perform the work. But from a practical point of view it will likely be most efficient to use all the same fill materials and to take advantage of the Sanitarian's presence to document the work.

At the time of abandonment, if you bring a letter (2 copies) to the site, identifying the site, the property owner, attesting to the abandonments, and requesting Health Department recommendation for demolition permit approval, we can sign the letter and expedite the approval process.

Craig Williams, Sanitarian

SITE INSPECTION SHEET

OWNER: JOHN SNOUFFER

DATE REQUESTED: 9/1/00

ADDRESS: _____

~~DRILLER/CONTRACTOR:~~ DIRTY WORKS

WELL TAG NUMBER: _____

TAX & PARCEL: _____

COUNTY: _____

PROPOSAL: PAS WELL & SEPTIC ABANDONMENT INSPECTION TO QUALIFY FOR DEMOLITION PERMIT. NO HEALTH DEPT RECORDS

LOCATION DIAGRAM

OF WELL OR SEPTIC INSTALLATION ARE ON FILE.

BEAT NIXON - SUPERVISOR OF CEHS PROGRAM CONFIRMS THERE ARE NO LISBON GASOLINE CONTAMINATION ISSUES TO BE CONCERNED WITH AT THIS SITE.

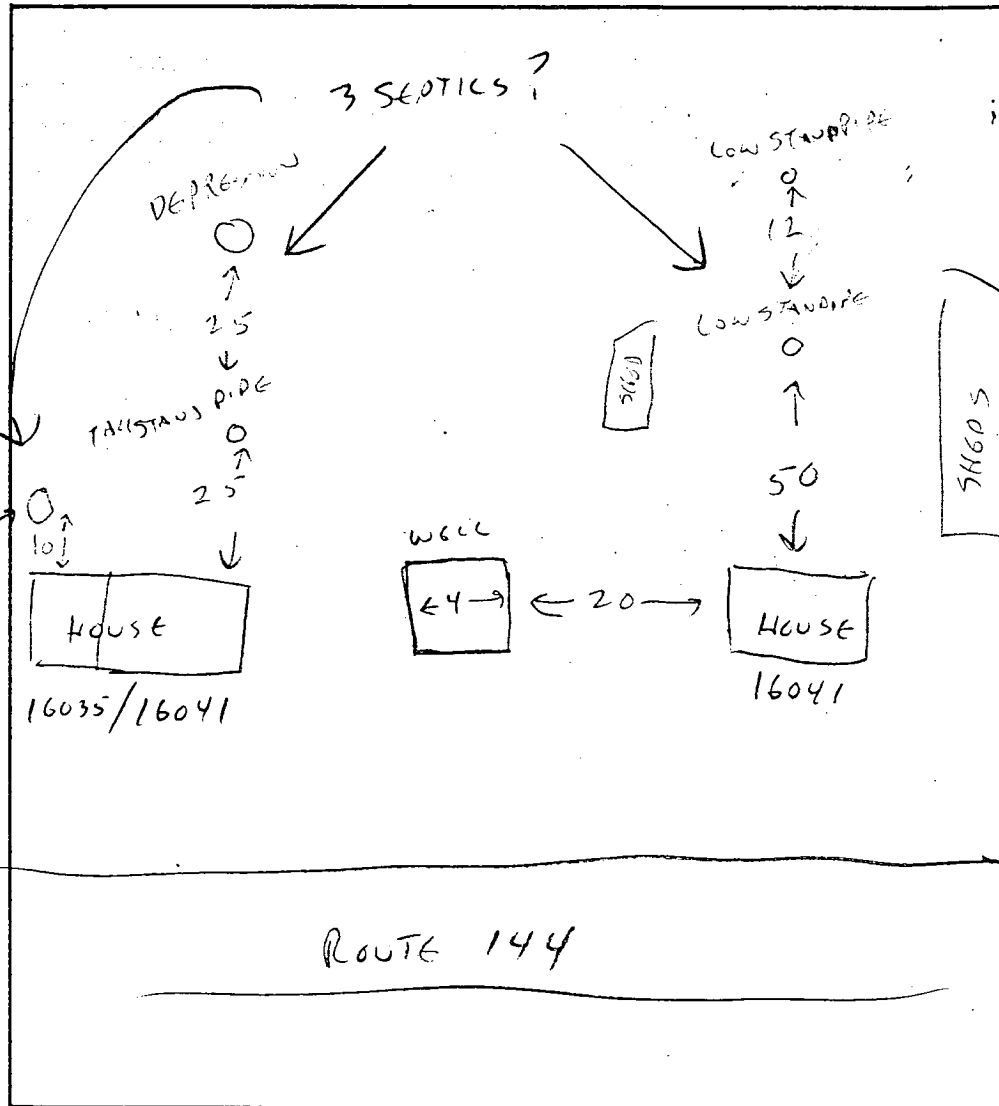

COMMENTS: MET DARRYL WINKLER - OF DIRTY WORK INC WESTMINSTER TO WALK SET, DISCUSS ABANDONMENT PROCEDURES. SEE ATTACHED LETTER FOR DETAILS. HE INDICATED THAT CLEARANCE FROM HISTORICAL COMMISSION MIGHT DELAY START OF WORK FOR A FEW WEEKS.

DATE: 9/1/00

INSPECTOR: [Signature]