

4/3/2000
1PM
4/3/00
10:00
9:10:00

PERMIT
SEWAGE DISPOSAL SYSTEM
HOWARD COUNTY HEALTH DEPARTMENT
BUREAU OF ENVIRONMENTAL HEALTH

P 513318-B

A REPAIR

ISSUE DATE 3-15-2000

410-313-2640
INDEXED

APPROVAL DATE 4/5/00

03-298132

Jack Fyock Septic Service IS PERMITTED TO INSTALL ALTER X

ADDRESS P.O. Box 89, Glenelg, MD 21737 PHONE 410-531-2939

SUBDIVISION Woodmark LOT NUMBER 35 ADDRESS 12217 Fawn Haven Court

PROPERTY OWNER Wise PROPERTY OWNER'S ADDRESS Same

SEPTIC TANK CAPACITY GALLONS

PUMP CHAMBER CAPACITY GALLONS

NUMBER OF BEDROOMS 4

SQUARE FEET PER BEDROOM 125

LINEAR FEET OF TRENCH REQUIRED 72

TRENCHES: Trenches to be 2 feet wide. Inlet 3 feet below original grade. Bottom maximum depth 10 feet below original grade. 7 feet of stone below distribution box.

LOCATION:

REPAIR - PURPOSE - Existing dry well has failed.

Call for inspection when ground is opened so sanitarian can recommend repair. 3-15-2000
Attach D-Box to existing drywell and run trench off of it on contour.

PLANS APPROVED Steven R. Krieger DATE 4/3/00

PERMIT VOID AFTER 2 YEARS

NOTE: CONTRACTOR RESPONSIBLE FOR SCHEDULING A PRE-CONSTRUCTION INSPECTION FOR ALL INSTALLATIONS

NOTE: TOP OF SEPTIC TANKS ARE TO BE NO DEEPER THAN 3.0 FEET BELOW FINISH GRADE

NOTE: WATERTIGHT SEPTIC TANKS REQUIRED

NOTE: CLEANOUT REQUIRED EVERY 70 FEET OF SEWER LINE AND/OR AT 90° SWEEPS IN LINES FROM HOUSE TO DRAIN FIELDS, 90° ELBOWS ARE NOT ACCEPTABLE

NOTE: ALL PARTS OF SEPTIC SYSTEMS (I.E. TANK, DISTRIBUTION BOX, DRAINFIELDS) TO BE 100 FEET FROM ANY WATER WELL UNLESS OTHERWISE SPECIFICALLY AUTHORIZED

NOTE: NO ABSORPTION TRENCH TO EXCEED 100 FEET IN LENGTH UNLESS SPECIFICALLY AUTHORIZED

NOTE: ALL PIPE FROM HOUSE TO SEPTIC TANK MUST BE CAST IRON OR SCHEDULE 35/40 PVC OR ABS

NOTE: MANHOLE RISERS REQUIRED ON ALL SEPTIC TANKS AND PUMP CHAMBERS

NOTE: DISTRIBUTION BOXES MUST HAVE BAFFLES

NOTE: IF PUMPED SEPTIC SYSTEM REQUIRED, (1) SEPTIC PUMP DETAIL TO BE PROVIDED BY INSTALLER PRIOR TO ISSUANCE OF SEPTIC PERMIT (2) PUMP PERFORMANCE TEST IS NECESSARY PRIOR TO HEALTH DEPARTMENT APPROVAL OF SEPTIC PERMIT

NEITHER THE HOWARD COUNTY COUNCIL NOR THE HEALTH DEPARTMENT IS RESPONSIBLE FOR THE SUCCESSFUL OPERATION OF ANY SYSTEM
PERMITTEE RESPONSIBLE FOR OBTAINING FINAL APPROVAL ON THIS PERMIT
CALL 410-313-2640 FOR INSPECTION OF SEPTIC SYSTEM

P 513318-B

NOT TO SCALE

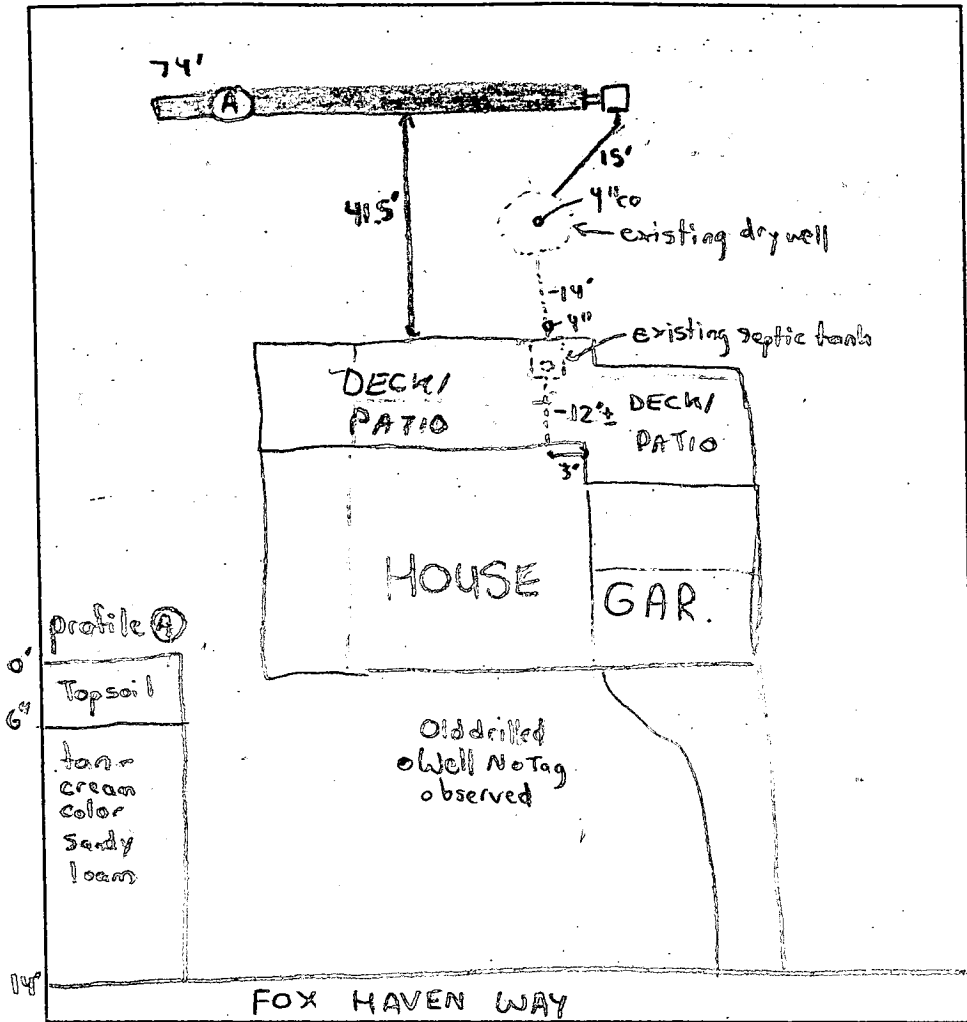

TRENCH DATA

TRENCH WIDTH 2

TRENCH INLET DEPTH 3

TRENCH BOTTOM DEPTH 10

DEPTH OF STONE 7

NUMBER OF TRENCHES 1

TOTAL TRENCH LENGTH 74

ABSORBENT AREA 518

DISTRIBUTION BOX LEVEL Yes

BAFFLE IN DISTRIBUTION BOX No
OK

SEPTIC TANK DATA

SEPTIC TANK existing GALLONS

MANHOLE RISER No

6 INCH INSPECTION PORT Yes under deck

PUMP CHAMBER DATA

PUMP CHAMBER GALLONS N/A

MANHOLE RISER N/A

ALARM N/A

PUMP PERFORMANCE TEST N/A

PRE-CONSTRUCTION INSPECTION: 4/3/00 - DUG PERE HOLE IN LOCATION (A) SOILS GOOD. SEE PROFILE

INSTALL DBOX OFF OF DRYWELL & RUN TRENCH ON CONTOUR TO LEFT SIDE OF LOT (FSR)

INSPECTION COMMENTS: 4/5/00 - OK TO COVER ALL WORK (FSR)

INSPECTOR Steven R. King DATE SYSTEM APPROVED 4/5/00

12217 Fawnhaven Ct

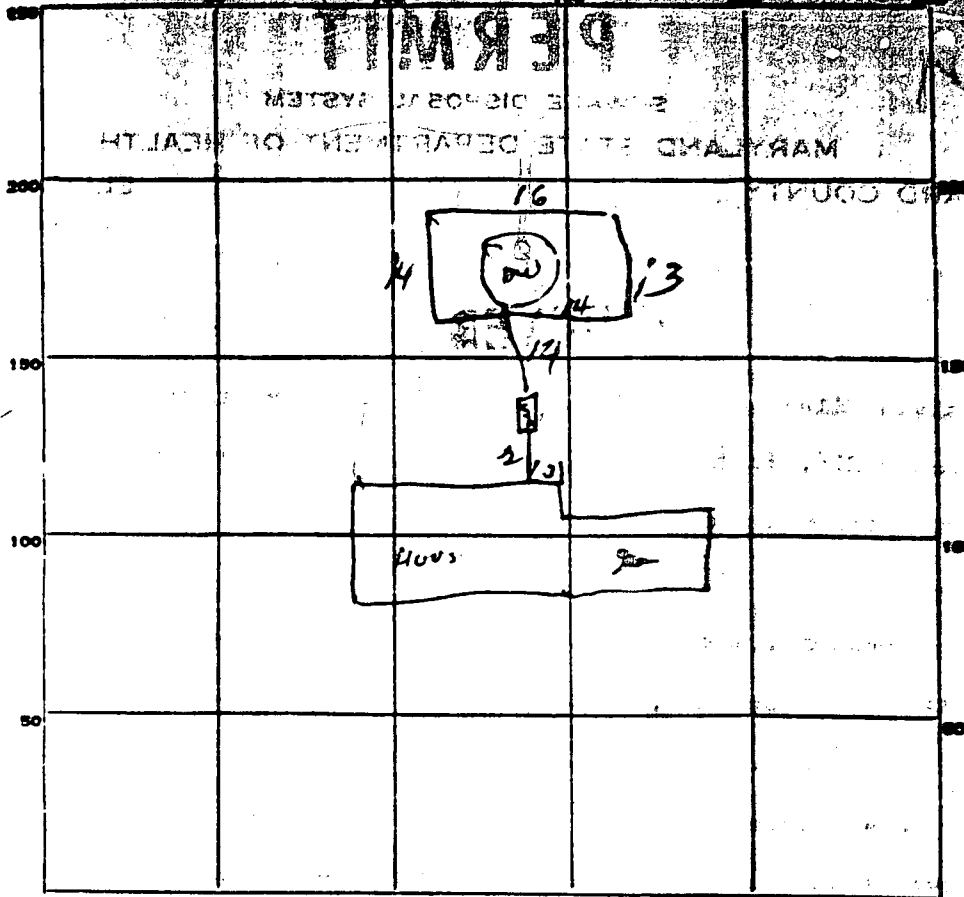

INDICATE NORTH - NAME ADJOINING ROADWAY AS BASE LINE.

Fawnhaven Court

PERMIT CARD OK

SEPTIC TANK, LEVEL OK

CLEANOUTS OK

DISTRIBUTION BOX, LEVEL _____

TILE FIELD, DEPTH _____ FT. TRENCH WIDTH _____ FT.

GRAVEL DEPTH _____ IN. TOTAL LENGTH _____ FT.

NUMBER OF TRENCHES _____ TOTAL BOTTOM AREA _____

SEEPAGE PITS, INSIDE DIAMETER 57 FT. DEPTH BELOW INLET 8 1/2 FT.

ABSORBENT AREA 484 SQ. FT.

REMARKS _____

10
 57
 56
 3
 57 1/2
 4 3/8
 456
 484

6/12/68 D. Monaghan

