

10/4/99  
10/5/99  
10/14/99  
10/15/99  
3100  
Septic pump test

# PERMIT

SEWAGE DISPOSAL SYSTEM

DEPARTMENT OF HEALTH AND MENTAL HYGIENE

03-287009

P 513143

A REPAIR

DISTRICT \_\_\_\_\_

DATE 11-22-99

DATE SYSTEM APPROVED 10/15/99

INSPECTOR S.P.K.

HOWARD COUNTY HEALTH DEPARTMENT  
BUREAU OF ENVIRONMENTAL HEALTH  
~~XXXXXX~~ 410-313-2640

INDEXED

Jenkins Brothers IS PERMITTED TO INSTALL \_\_\_\_\_ ALTER

ADDRESS 7670 Smith's Private Road, Sykesville, MD 21784 PHONE 410-461-9282

SUBDIVISION \_\_\_\_\_ LOT \_\_\_\_\_ ROAD 1506 Grooms Lane

PROPERTY OWNER John Huff

ADDRESS 1506 Grooms Lane

SEPTIC TANK CAPACITY 1000 GALLONS -top scan

NUMBER OF BEDROOMS 3 INLET 2.0' - BOTTOMING 6.0' - 4.0' STONE

180 SQUARE FEET PER BEDROOM

LINEAR FEET OF TRENCH REQUIRED 130 - INSTALL 2 65' TRENCHES AT TOP OF HILL TOWARD THE REAR OF THE LOT (TEST HOLE #4)

REPAIR - PURPOSE - Existing septic system has failed.

Call for inspection when ground is opened so sanitarian can recommend repair. 9-30-99

EX. SYSTEM IS 30 FEET FROM 1506 GROOMS LANE WELL & NEIGHBORS WELL - ALSO

DIRECTLY UPHILL OF NEIGHBORS WELL - OWNER WANTS TO MOVE SYSTEM FOR HEALTH REASONS (PROXIMITY TO WELLS) AND UPGRADE FOR EXPANSION OF EXISTING ONE BEDROOM HOUSE

PLANS APPROVED BY \_\_\_\_\_ DATE \_\_\_\_\_

COVER NO WORK UNTIL INSPECTED AND APPROVED

NEITHER THE HOWARD COUNTY COUNCIL NOR THE HEALTH DEPARTMENT IS RESPONSIBLE FOR THE SUCCESSFUL OPERATION OF ANY SYSTEM

NOTE: CLEANOUT REQUIRED EVERY 70 FEET OF SEWER LINE AND/OR AT 90° SWEEPS IN LINES FROM HOUSE TO DRAIN FIELDS. 90° ELBOWS NOT ACCEPTABLE.

NOTE: ALL PARTS OF SEPTIC SYSTEMS (I.E. TANK, DISTRIBUTION BOX TRENCHES) TO BE 100 FEET FROM WELL (UNLESS OTHERWISE SPECIFICALLY AUTHORIZED)

NOTE: IF DEEP TRENCH(ES) ARE USED CALL FOR INSPECTION BEFORE AND AFTER PLACING GRAVEL IN TRENCH(ES)

NOTE: NO DRY WELL SHALL EXCEED 15 FOOT IN DIAMETER NO ABSORPTION TRENCH TO EXCEED 100 FEET IN LENGTH

NOTE: ALL PIPE FROM HOUSE TO SEPTIC TANK MUST BE CAST IRON OR SCHEDULE 35/40 PVC OR ABS

PERMIT VOID AFTER TWO YEARS

NOTE: INSTALL STAND PIPE ON SEPTIC TANK AND DRY WELL STAND PIPES MUST BE 6 INCHES IN DIAMETER CAST IRON, CONCRETE OR TERRA COTTA OR PVA OR ABS ACCEPTED. IF TOP OF SEPTIC TANK IS DEEPER THAN 3 FEET, MANHOLE TO GRADE REQUIRED.

NOTE: DISTRIBUTION BOXES MUST HAVE BAFFLES

\*INSTALLER IS RESPONSIBLE FOR OBTAINING FINAL APPROVAL ON THIS PERMIT

\*CALL 461-9933 FOR INSPECTION OF SEPTIC SYSTEM.

P 513143

1 & 2 refusal @ 5 & 6

3 refusal @ 8.0' but directly uphill neighbors well

4 Visual to 11.0 lgt tan Salm 100% large (7"-12" dia) rock frags

5 contractor reported good hole (sandy) to 13.0'

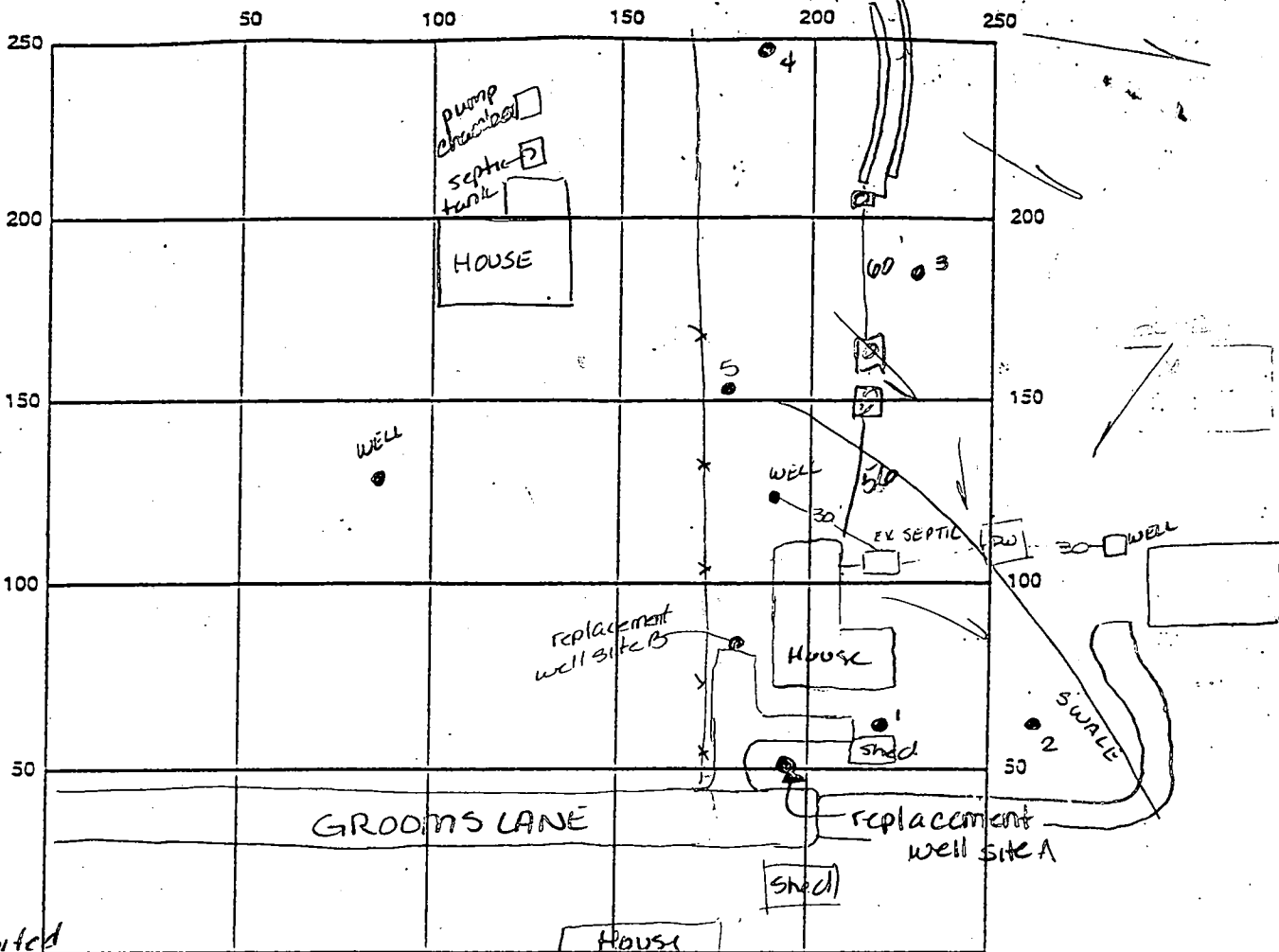

INDICATE NORTH - NAME ADJOINING ROADWAY, AS BASE LINE

SEPTIC TANK LEVEL 1000 top sealed per contractor CLEANOUTS manhole on ST, pump chamber & distribution box

DISTRIBUTION BOX LEVEL OK

DRAIN FIELD/TITLE DEPTH 4.0 per cont TRENCH WIDTH 2.0 FT. INLET DEPTH 2.0 per cont FT.

EFFECTIVE GRAVEL DEPTH 4.0 FT. TOTAL LENGTH 130 per cont FT.

NUMBER OF TRENCHES 2 ONE SIDEWALL/SOTTOM AREA 520 SQ. FT.  $\frac{130}{520}$

DRYWALL INSIDE DIAMETER 1 FT. EFFECTIVE DEPTH BELOW INLET 4.0 FT.

ASSORBENT AREA 1 SQ. FT.

REMARKS: 10/4/99 10:00 AM To avoid pump now - drill new well @ site A or B and replace metal septic tank & terra cotta lines since septic isn't failing now 2:00pm contractor reported good hole @ #5

10/5/99 inspection for potential SDA @ test hole #5 - not possible due to well on neighbors lot - directly downslope - Install pump septic w/ 2 top sealed tanks 75' from existing wells & drainfields @ test #4 - Do not need to replace well @ this time

10/14/99 System covered w/ inspection 10/15/99 - PUMP TEST OPERATIONAL - PUMP OK, ALARM OK

DATE SYSTEM APPROVED 10/15/99 INSPECTOR Steven R. Krieg

7/11/62 *incomplete RH*

# PERMIT

65222  
6265

*File as complete and not of approval*

SEWAGE DISPOSAL SYSTEM

MARYLAND STATE DEPARTMENT OF HEALTH

HOWARD COUNTY

50262  
RH

INDEXED

ELICOTT CITY  
INDEXED  
DATE 6/12/62

*George Herard*

IS PERMITTED TO INSTALL  ALTER

ADDRESS

PHONE

A SEWAGE DISPOSAL SYSTEM LOCATED AT *Shoone Lane in Woodstock - last house on left on Shoone Lane*

SUBDIVISION

ROAD

LOT

PROPERTY OWNER

*Herard, George*

ADDRESS

*St 4 - E.P.*

SPECIFICATIONS

DRAIN FIELD DEPTH FEET, BOTTOM AREA

SEEPAGE PITS  ABSORBENT SIDE WALL *Depth (8' deep - rock)* SQ. FT.

SEPTIC TANK CAPACITY *750* GALLONS

FOR GARBAGE GRINDER, INCREASE DISPOSAL AREA 225-S TANK CAPACITY 50%

OTHER *Place dry well in area that ground*

*penetration test.*

PLANS APPROVED BY

*Oliver J. Weiss*

DATE

*6/12/62*

FILL SEPTIC TANK AND DISTRIBUTION BOX WITH WATER BEFORE CALLING FOR AN INSPECTION. COVER NO WORK UNTIL INSPECTED AND APPROVED.

NEITHER THE HOWARD COUNTY COMMISSIONERS NOR THE HEALTH DEPARTMENT IS RESPONSIBLE FOR THE SUCCESSFUL OPERATION OF ANY SYSTEM.

65265

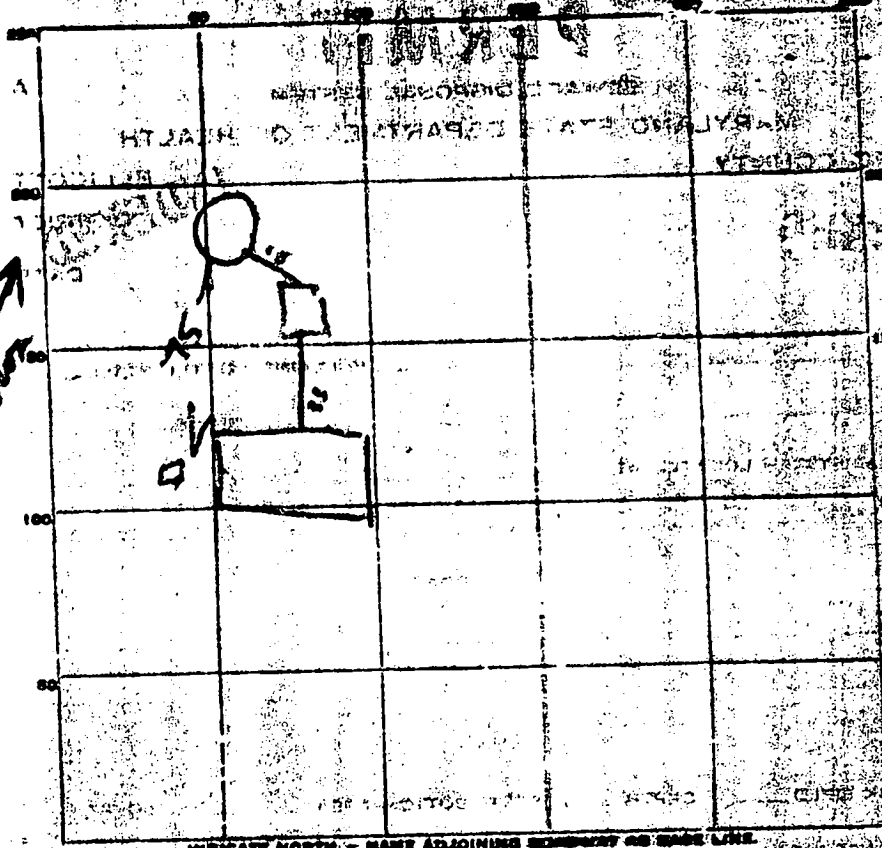

42  
53 8  
6

INDICATE NORTH - NAME ADJOINING BOUNDARY AS BOUNDARY LINE

PERMIT CARD \_\_\_\_\_  
 SEPTIC TANK, LEVEL 5' 3" x 7' CLEARANCE NO  
 DISTRIBUTION BOX, LEVEL \_\_\_\_\_  
 TILE FIELD, DEPTH \_\_\_\_\_ FT. TRENCH WIDTH \_\_\_\_\_ FT.  
 GRAVEL DEPTH \_\_\_\_\_ IN. TOTAL LENGTH \_\_\_\_\_ FT.  
 NUMBER OF TRENCHES \_\_\_\_\_ TOTAL BOTTOM AREA \_\_\_\_\_  
 SEEPAGE PITS, INSIDE DIAMETER 14" FT. DEPTH BELOW INLET 8 FT.

ABSORBENT AREA 340 sq. ft. *not counting stone*

REMARKS 6" to 1 ft stone around outlet of Perimeter  
11 July 67 I completed top of deep well & septic  
Tank must be poured

APPROVED \_\_\_\_\_

INSPECTOR \_\_\_\_\_

# APPLICATION

SEWAGE DISPOSAL TESTING

MARYLAND STATE DEPARTMENT OF HEALTH

HOWARD COUNTY

ELLICOTT CITY

DISTRICT \_\_\_\_\_

DATE 6/4/62

A 15265

P \_\_\_\_\_

750 Tank

9' x 12' dry-well  
in one lot.

TO: THE COUNTY HEALTH OFFICER  
ELLICOTT CITY, MARYLAND

I, HEREBY, APPLY FOR THE NECESSARY TESTS IN ORDER TO CONSTRUCT OR RECONSTRUCT A SEWAGE DISPOSAL SYSTEM.

PROPERTY OWNER George Henard

ADDRESS Rt 4 ETC. PHONE 405-3650

PROPERTY LOCATION:

SUBDIVISION \_\_\_\_\_ LOT NO. \_\_\_\_\_

ROAD AND DESCRIPTION Broome Lane - Woodstock - last house  
on the left on Broome Lane

OCCUPANT \_\_\_\_\_ PHONE \_\_\_\_\_

PERSON TO CONSTRUCT SYSTEM \_\_\_\_\_

ADDRESS \_\_\_\_\_ PHONE \_\_\_\_\_

SIZE OF LOT 1 acre TYPE BLDG. 2  
NUMBER OF BEDROOMS \_\_\_\_\_

IF NOT SINGLE RESIDENCE DESCRIBE \_\_\_\_\_

SIGNATURE OF APPLICANT George Henard

APPROVED BY P. W. FOR dry-well DATE 6/7/62  
(NAME OF SYSTEM)

REJECTED BY \_\_\_\_\_ FOR \_\_\_\_\_ DATE \_\_\_\_\_  
(NAME OF SYSTEM)

HOLD PENDING FURTHER TESTS \_\_\_\_\_ DATE \_\_\_\_\_

REASONS FOR REJECTION OR HOLDING \_\_\_\_\_

## THIS IS NOT A PERMIT

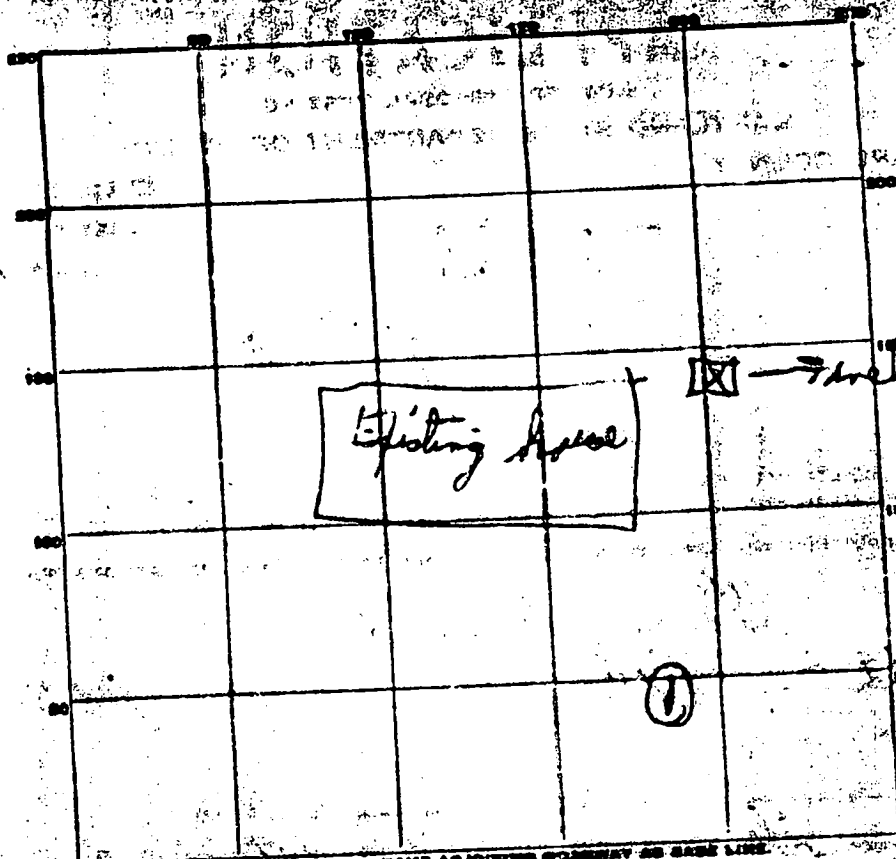

INDICATE NORTH - NAME ADJOINING PROPERTY ON SAME LINE

DATE	TEST NO.	DEPTH	PRELIM		TEST		TIME
			START	STOP	START	STOP	
4/20/22	1#	6'	1:25	1:23	1:23	1:50	27 min

SOIL AUGER FINDING Clay + sand

TESTED BY W. W. W.

REMARKS \_\_\_\_\_

ALSO PRESENT George P. Howard LOT NO. \_\_\_\_\_

SR. W-3  
2-65

State Office Building  
ANNAPOLIS, MARYLAND 21401

STATE OF MARYLAND  
DEPARTMENT OF  
WATER RESOURCES

THIS REPORT  
MAY BE SUBMITTED  
WITHIN 30 DAYS  
AFTER COMPLETION  
OF THE WELL

WELL COMPLETION REPORT **A 05215**

WELL DESCRIPTION **WATER**

<b>WELL LOG</b> State the kind of formations penetrated, their color, their depth, their thickness, and if water-bearing		<b>CASING AND SCREEN RECORD</b> State the kind and size and position of casing, liner, shoe, screen, and other accessories (if no casing used, give diameter of well).		<b>PUMPING TEST</b> Hours Pumped: <u>1</u> Type of Pump Used: <u>Hand</u> Pumping Rate: <u>1</u> Gallons per Minute: <u>1</u>	
Granite	FEET from <u>0</u> to <u>28</u>	Steel	DIAM. (Inches): <u>6 7/8</u>	FEET from <u>0</u> to <u>43</u>	<b>WATER LEVEL</b> Distance from top surface of water: <u>50</u> Before Pumping: <u>50</u> When Pumping: <u>50</u> Ft.
	FEET from <u>0</u> to <u>43</u>		<b>APPEARANCE OF WATER</b> Clear: <u>Yes</u> Cloudy: <u>No</u> Taste: <u>OK</u> Color: <u>OK</u> Height of Casing Above Ground Surface: <u>1</u> Ft.		<b>PUMP INSTALLED</b> Type: <u>X</u> Capacity: <u>X</u> Gallons per Minute: <u>X</u> Gallons per Hour: <u>X</u> Pump Casing Length: <u>X</u> Ft.

LOCATION OF WELL ON LOT  
Show permanent structures such as building(s), septic tank, and/or other landmarks, and indicate not less than 2 distances (measurements) to well.

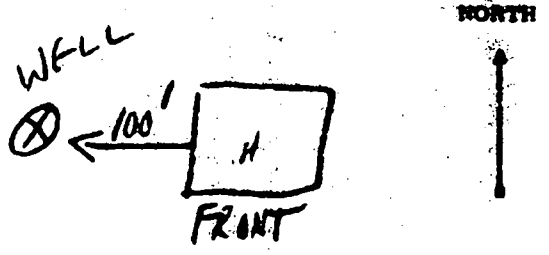

Date Well Was Completed 3/1/66

Well Driller Heggen Well Drilling

Signature Austin M. Heggen