

PERMIT

SEWAGE DISPOSAL SYSTEM

DEPARTMENT OF HEALTH AND MENTAL HYGIENE

P _____

A 513203-Y

DISTRICT _____

DATE _____

HOWARD COUNTY HEALTH DEPARTMENT

BUREAU OF ENVIRONMENTAL HEALTH

~~XXXXXXX~~ 410-313-2640

INDEXED

DATE SYSTEM APPROVED _____

INSPECTOR _____

RPS# 159925

IS PERMITTED TO INSTALL _____ ALTER _____

ADDRESS _____ PHONE _____

SUBDIVISION Harwood Park LOT 565 ROAD 6384 Beechfield Avenue

PROPERTY OWNER Michael Roach

ADDRESS _____

PLANS APPROVED BY _____ DATE _____

COVER NO WORK UNTIL INSPECTED AND APPROVED

NEITHER THE HOWARD COUNTY COUNCIL NOR THE HEALTH DEPARTMENT IS RESPONSIBLE FOR THE SUCCESSFUL OPERATION OF ANY SYSTEM

NOTE: CLEANOUT REQUIRED EVERY 70 FEET OF SEWER LINE AND/OR AT 90° SWEEPS IN LINES FROM HOUSE TO DRAIN FIELDS. 90° ELBOWS NOT ACCEPTABLE.

NOTE: ALL PARTS OF SEPTIC SYSTEMS (I.E. TANK, DISTRIBUTION BOX TRENCHES) TO BE 100 FEET FROM WELL (UNLESS OTHERWISE SPECIFICALLY AUTHORIZED)

NOTE: IF DEEP TRENCH(ES) ARE USED CALL FOR INSPECTION BEFORE AND AFTER PLACING GRAVEL IN TRENCH(ES)

NOTE: NO DRY WELL SHALL EXCEED 15 FOOT IN DIAMETER NO ABSORPTION TRENCH TO EXCEED 100 FEET IN LENGTH

NOTE: ALL PIPE FROM HOUSE TO SEPTIC TANK MUST BE CAST IRON OR SCHEDULE 35/40 PVC OR ABS

PERMIT VOID AFTER TWO YEARS

NOTE: INSTALL STAND PIPE ON SEPTIC TANK AND DRY WELL STAND PIPES MUST BE 6 INCHES IN DIAMETER CAST IRON. CONCRETE OR TERRA COTTA OR PVA OR ABS ACCEPTED. IF TOP OF SEPTIC TANK IS DEEPER THAN 3 FEET. MANHOLE TO GRADE REQUIRED.

NOTE: DISTRIBUTION BOXES MUST HAVE BAFFLES

***INSTALLER IS RESPONSIBLE FOR OBTAINING FINAL APPROVAL ON THIS PERMIT**

***CALL 461-9933 FOR INSPECTION OF SEPTIC SYSTEM.**

A 503203 Y

75'

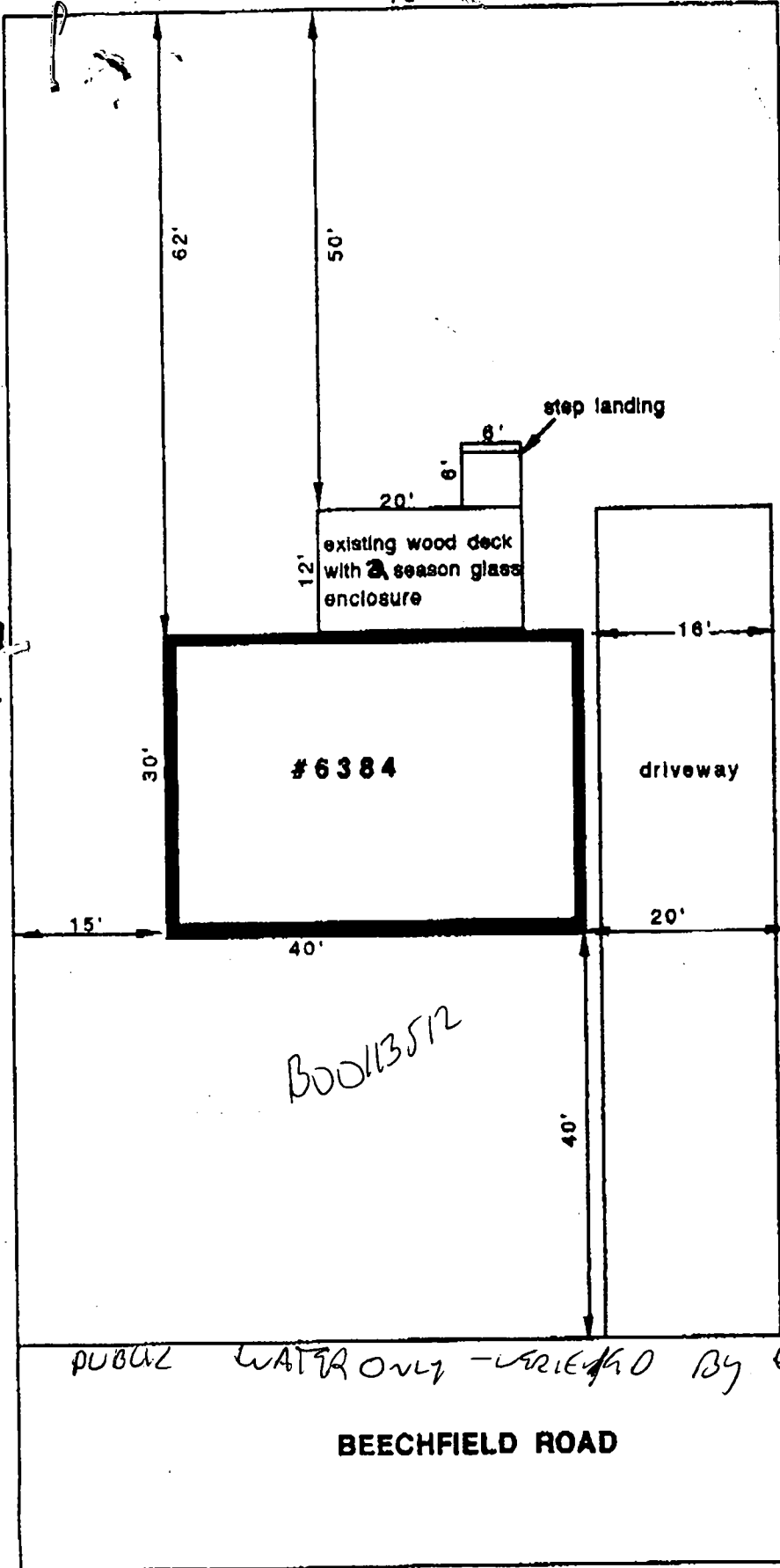

**MICHAEL and MARY
ROACH**
6384 Beechfield Road
Elkridge, Md. 21075

8-12-98
 DISCUSSED w/ PATORLA
 JEAN REED SAID THAT
 THIS PROPERTY HAS
 SEPTIC LOCATION
 TO BE VERIFIED

8-13-98
 SITE INSPECTION
 SEPTIC CLEARANCE NOT VISIBLE
 LIMITED LOT SIZE INDICATES
 THAT A PORTION OF
 THE SEPTIC SYSTEM COULD
 BE UNDER DECK (PROPOSED
 SUNROOM) LOCATION
 REQUIRE TO APPROVE.

9-1-98
 ISSUE RESOLVED
 OK TO SIGN B.P.

SCALE: 1/16" = 1'

PUBLIC WATER ONLY - VERIFIED BY ENGINEER 8/14/98
BEECHFIELD ROAD

MAP G0 P BUILT 73
 38 13 873

8/13/98
 TEL MRS ROACH
 SHE CLAIMS PUBLIC
 USE SEPTIC.

Rec'd 8/12/98
HC HD



Post-It® Fax Note	7671	Date	8/1/98	# of pages	2
To	Bob Valtin	From	Tamara Frank		
Co./Dept.	Premiere Window	Co. #	60 Water & Sewer		
Phone #		Phone #	410 313-2058		
Fax #	410-753-1641	Fax #			

August 27, 1998

Michael Roach
6384 Beechfield Ave
Elkridge, Md 21075

RE: Sewer Service Charges

Dear Mr. Roach,

A recent review of the sewer connection applications disclosed that your property is connected to the sewer system. The Howard County Code, Section 20.305 specifies that a quarterly sewer service charges shall be based on the volume of water usage and bills will be issued on a quarterly basis to the sewer system user. The quarterly bills issued to your property should have reflected both water and sewer usage charges. However, an analysis of the billing records indicate the property has been billed for water usage only.

The enclosed invoice in the amount of \$91.70 is being issued in accordance with Section 20.302 (3) of the Howard County Code and pertains to unbilled sewer charges. This represents charges due for past services. The sewer calculation is based on the actual water usage recorded on the meter from July 9, 1997 to July 15, 1998. Payment of the net amount has been extended for a period of 90 days for your convenience. In the future, quarterly invoices will reflect both water and sewer usage charges.

If you should have any questions, please direct inquires to

Sincerely,

Linda Barrett, Billing Supervisor
Division of Water and Sewer Services

DIANE
NASON ISSUING
PUBLIC SEWER AMAL
8-14-98
CONTRACT 23-5
DRAWING 24
IN FRONT
SILVER G1 WATER SINCE 30401

PREMIER WINDOW & BUILDING INC.

PREMIER WINDOW & BUILDING, INC.

9515 Reisterstown Road
Owings Mills, MD 21117
(410) 654-1711

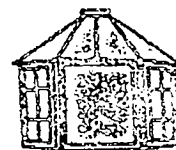

- SIDING
- WINDOWS
- DOORS
- TRIM
- DECKS
- ROOFING
- CLUB ROOMS

FACSIMILE COVER SHEET

Date: 09-01-98

To: MR. GLEN SAVAGE

Company: Hawood Co. Health Dept.

Fax#: 410 313-2648

From: Bob Jervis

Fax#: (410) 753-1640

Total Number Of Pages, Including Cover Sheet: 3

Comments: MR SAVAGE, ATTACHED IS THE
FAKED CORRESPONDENCE FROM TAMARA PRINCE
INDICATING THE PROPERTY IS ATTACHED
TO PUBLIC SEWER.

PLEASE REVIEW AND IF POSSIBLE
CLERK THE PERMIT

Thomas

Please call above sender @ (410) 654-1711 if all pages of this transmission are not received.

WATERSEWER BILLING Fax:1-410-315-5239 Sep 1 '98 10:27
METER SERVICES WORK ORDER ACCOUNT NUMBER 504

Date 8-17 19 98 Phone () Service Number

Name Address 6384 Beechfield Ave

NOTICE OF METER CHANGE

Meter	Make	No.	Size	Reading
Removed				
Installed				
Remarks				

Size	Make	Meter Number	
Meter Located:			
Date	Reading	Difference	Remarks

Office Comments:

Field Report:

Linda THIS House is connected to SEWER
Clean out location - 8' left of water meter vault

Work Done By: T. Beckhardt Date: 8-17-98 AM (T.M.) PM

To Bill Roach Glen
Date 8-17 Time 8-20 AM PM

WHILE YOU WERE OUT

M Ms. Roach

of _____

Phone (410) 796 3249
Area Code Number Extension

TELEPHONED	<input type="checkbox"/>
CALLED TO SEE YOU	<input type="checkbox"/>
WANTS TO SEE YOU	<input type="checkbox"/>

PLEASE CALL	<input checked="" type="checkbox"/>
WILL CALL AGAIN	<input type="checkbox"/>
URGENT	<input type="checkbox"/>

RETURNED YOUR CALL

Message LET ASS. 8/19/98

AM

Operator



AMPAD
EFFICIENCY®

REORDER
#23-000

Howard County Health Department

To: ~~TO~~ G S

T/C FROM BLDG RE=B00113512
6384 Beechfield Ave
explained reliance on county fin.
records; he reports Co. Fin.
bill of \$12/qtr, which is
consistent w/public H₂O only;
I explained only way to
verify s.s. loc/sewer conn
via excavation altho examina-
tion of house plbg. may also
be acceptable MR 8/17

From:

Date:

HD-170

8/19/98 - TELEPHONE CALL(S) WITH APPLICANT
& BUILDER. THEY WERE CONVINCED
THE PROPERTY WAS SERVED BY PUBLIC SEWER
SO THERE SHOULD BE NO CONCERN WITH
POTENTIAL IMPACT TO SEPTIC.

I EXPLAINED THAT THIS OFFICE HAD
NO JURISDICTION TO DETERMINE THAT
THEY WERE SERVED BY SEWER - THAT WAS
UP TO COUNTY AGENCIES RESPONSIBLE FOR
DELIVERY OF THAT SERVICE -

BECAUSE OF THE ALLEGEDLY INCORRECT
DETERMINATION RECEIVED FROM BUREAU OF ENGINEERING,
I SUGGESTED THAT THEY CONTACT A PERMITS
SUPERVISOR COBBIN/MARTIN FOR ADVICE AS TO HOW TO PROCEED. (C)