

PERMIT

SEWAGE DISPOSAL SYSTEM

DEPARTMENT OF HEALTH AND MENTAL HYGIENE

04-321847

P _____

A 513146-B

DISTRICT _____

DATE _____

HOWARD COUNTY HEALTH DEPARTMENT

BUREAU OF ENVIRONMENTAL HEALTH

~~XXXXXXXX~~ 410-313-2640

INDEXED

DATE SYSTEM APPROVED _____

INSPECTOR _____

_____ IS PERMITTED TO INSTALL _____ ALTER _____

ADDRESS _____ PHONE _____

SUBDIVISION _____ LOT _____ ROAD 15282 Roxbury Road

PROPERTY OWNER _____

ADDRESS _____

SEPTIC TANK CAPACITY _____ GALLONS

NUMBER OF BEDROOMS _____

_____ SQUARE FEET PER BEDROOM

LINEAR FEET OF TRENCH REQUIRED _____

PLANS APPROVED BY _____ DATE _____

COVER NO WORK UNTIL INSPECTED AND APPROVED

NEITHER THE HOWARD COUNTY COUNCIL NOR THE HEALTH DEPARTMENT IS RESPONSIBLE FOR THE SUCCESSFUL OPERATION OF ANY SYSTEM

NOTE: CLEANOUT REQUIRED EVERY 70 FEET OF SEWER LINE AND/OR AT 90° SWEEPS IN LINES FROM HOUSE TO DRAIN FIELDS. 90° ELBOWS NOT ACCEPTABLE.

NOTE: ALL PARTS OF SEPTIC SYSTEMS (I.E. TANK, DISTRIBUTION BOX TRENCHES) TO BE 100 FEET FROM WELL (UNLESS OTHERWISE SPECIFICALLY AUTHORIZED)

NOTE: IF DEEP TRENCH(ES) ARE USED CALL FOR INSPECTION BEFORE AND AFTER PLACING GRAVEL IN TRENCH(ES)

NOTE: NO DRY WELL SHALL EXCEED 15 FOOT IN DIAMETER NO ABSORPTION TRENCH TO EXCEED 100 FEET IN LENGTH

NOTE: ALL PIPE FROM HOUSE TO SEPTIC TANK MUST BE CAST IRON OR SCHEDULE 35/40 PVC OR ABS

PERMIT VOID AFTER TWO YEARS

NOTE: INSTALL STAND PIPE ON SEPTIC TANK AND DRY WELL STAND PIPES MUST BE 6 INCHES IN DIAMETER CAST IRON, CONCRETE OR TERRA COTTA OR PVA OR ABS ACCEPTED. IF TOP OF SEPTIC TANK IS DEEPER THAN 3 FEET, MANHOLE TO GRADE REQUIRED.

NOTE: DISTRIBUTION BOXES MUST HAVE BAFFLES

***INSTALLER IS RESPONSIBLE FOR OBTAINING FINAL APPROVAL ON THIS PERMIT**

A 513146B

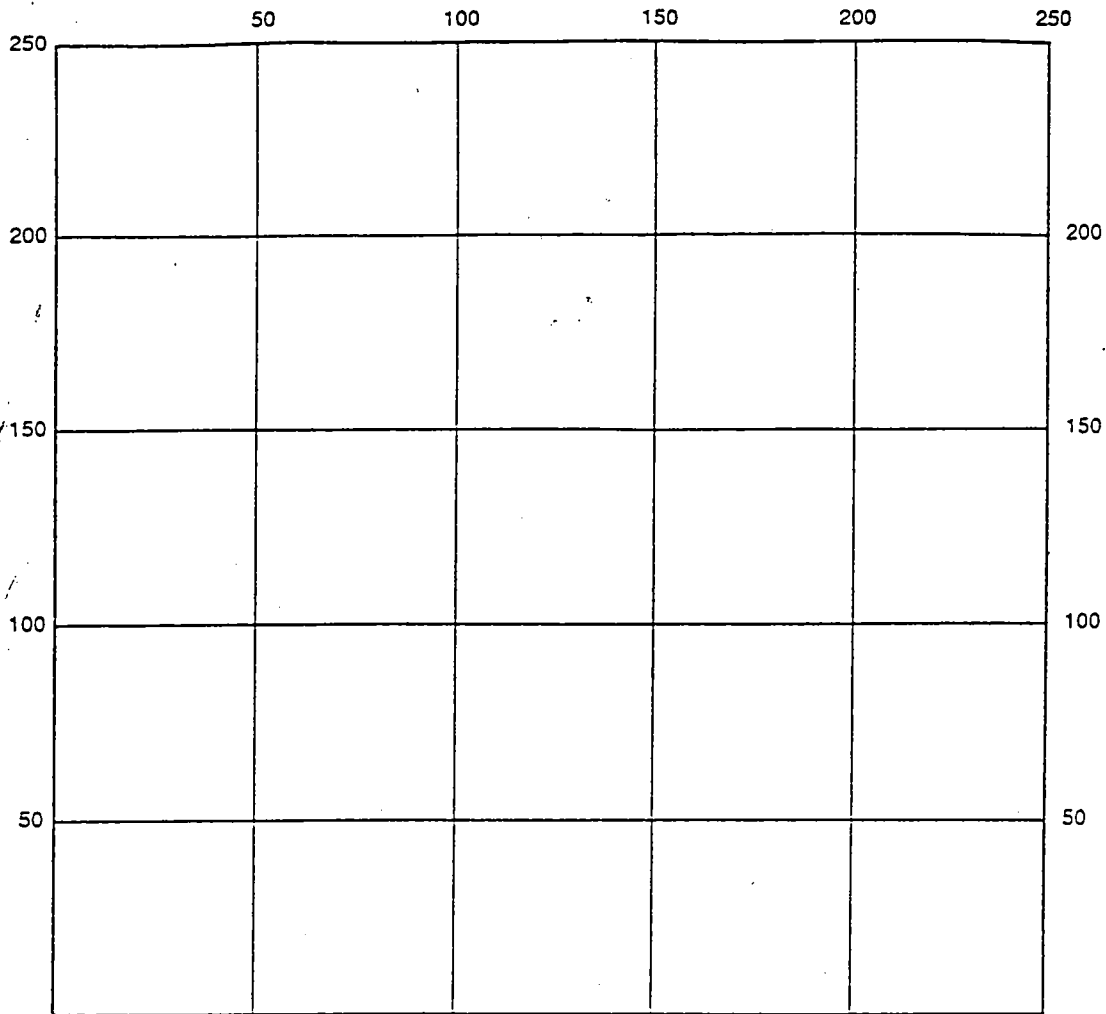

INDICATE NORTH - NAME ADJOINING ROADWAY AS BASE LINE

SEPTIC TANK LEVEL _____ CLEANOUTS _____

DISTRIBUTION BOX LEVEL _____

DRAIN FIELD/TITLE DEPTH _____ FT. TRENCH WIDTH _____ FT. INLET DEPTH _____ FT.

EFFECTIVE GRAVEL DEPTH _____ FT. TOTAL LENGTH _____ FT.

NUMBER OF TRENCHES _____ ONE SIDEWALL/BOTTOM AREA _____ SQ. FT.

DRYWALL INSIDE DIAMETER _____ FT. EFFECTIVE DEPTH BELOW INLET _____ FT.

ABSORBENT AREA _____ SQ. FT.

REMARKS: _____

DATE SYSTEM APPROVED _____ INSPECTOR _____

11/29/99
Replacement Well, 11:00

OWNER: _____

DATE REQUESTED: 11/29/99

ADDRESS: 15282 Roxbury Rd.

DRILLER: Easterday

WELL TAG # _____

COUNTY # _____

PROPOSAL: _____

LOCATION DIAGRAM

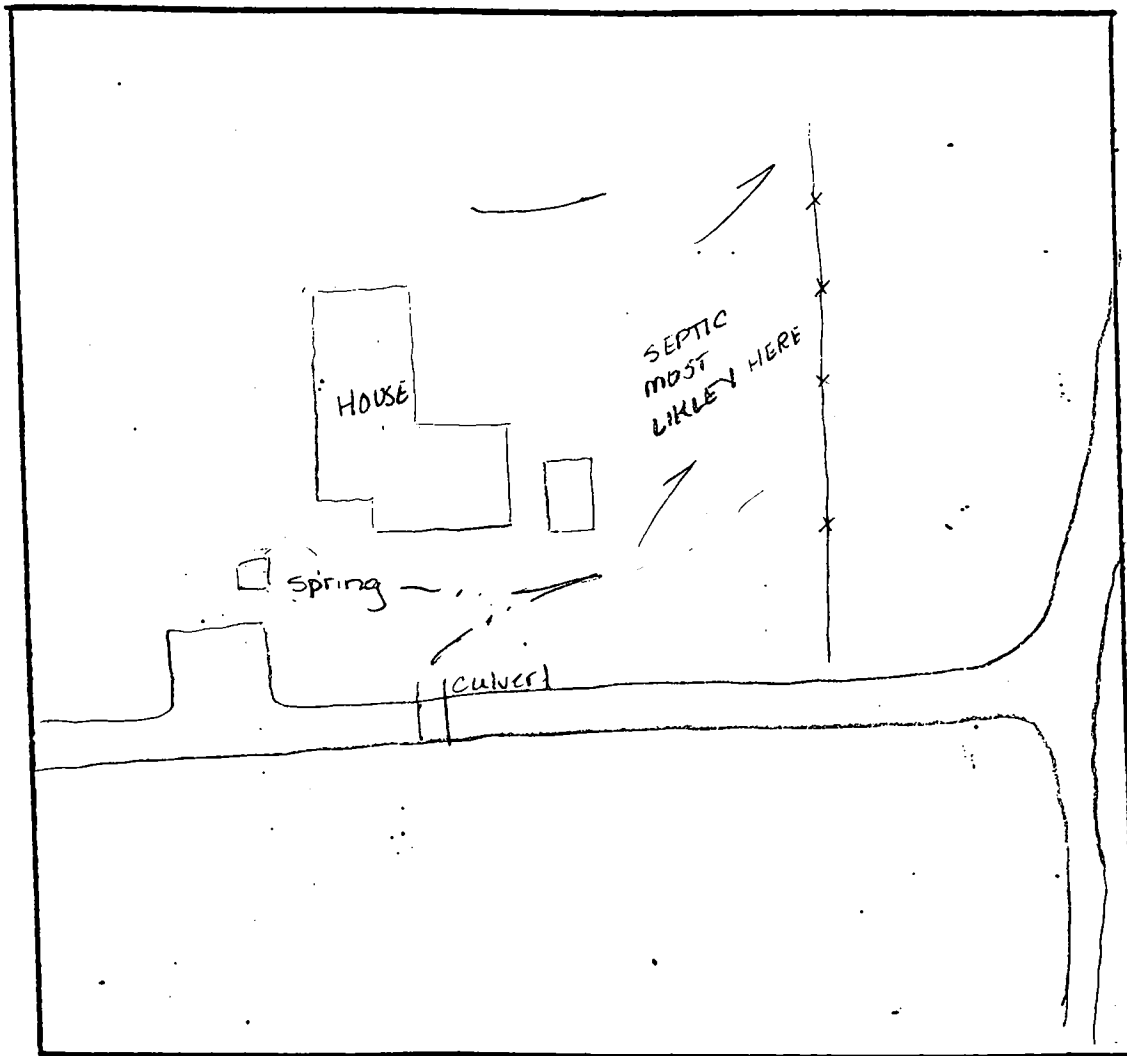

COMMENTS: 11/29/99 Site insp - couldn't locate septic but house H₂O supply
appears to be a spring - no one on site After returning to office
Sara of Easterday reported cancelling request - someone contemplating buying
to build larger home, they changed their mind - perc tests needed for any

DATE: _____ INSPECTOR: _____

replacement hoose or addition in wet season *st*

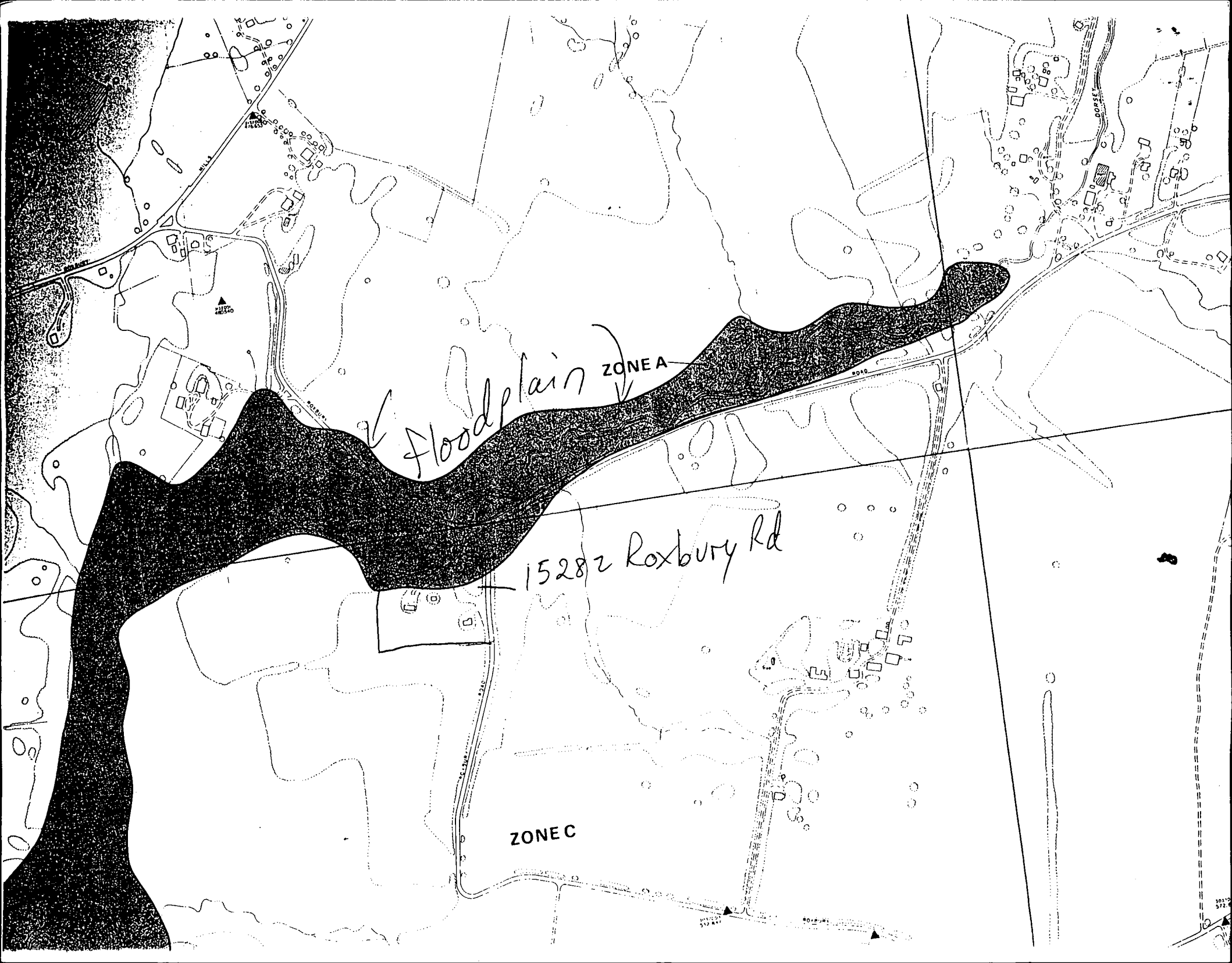

Floodplain ZONE A

15282 Roxbury Rd

ZONE C

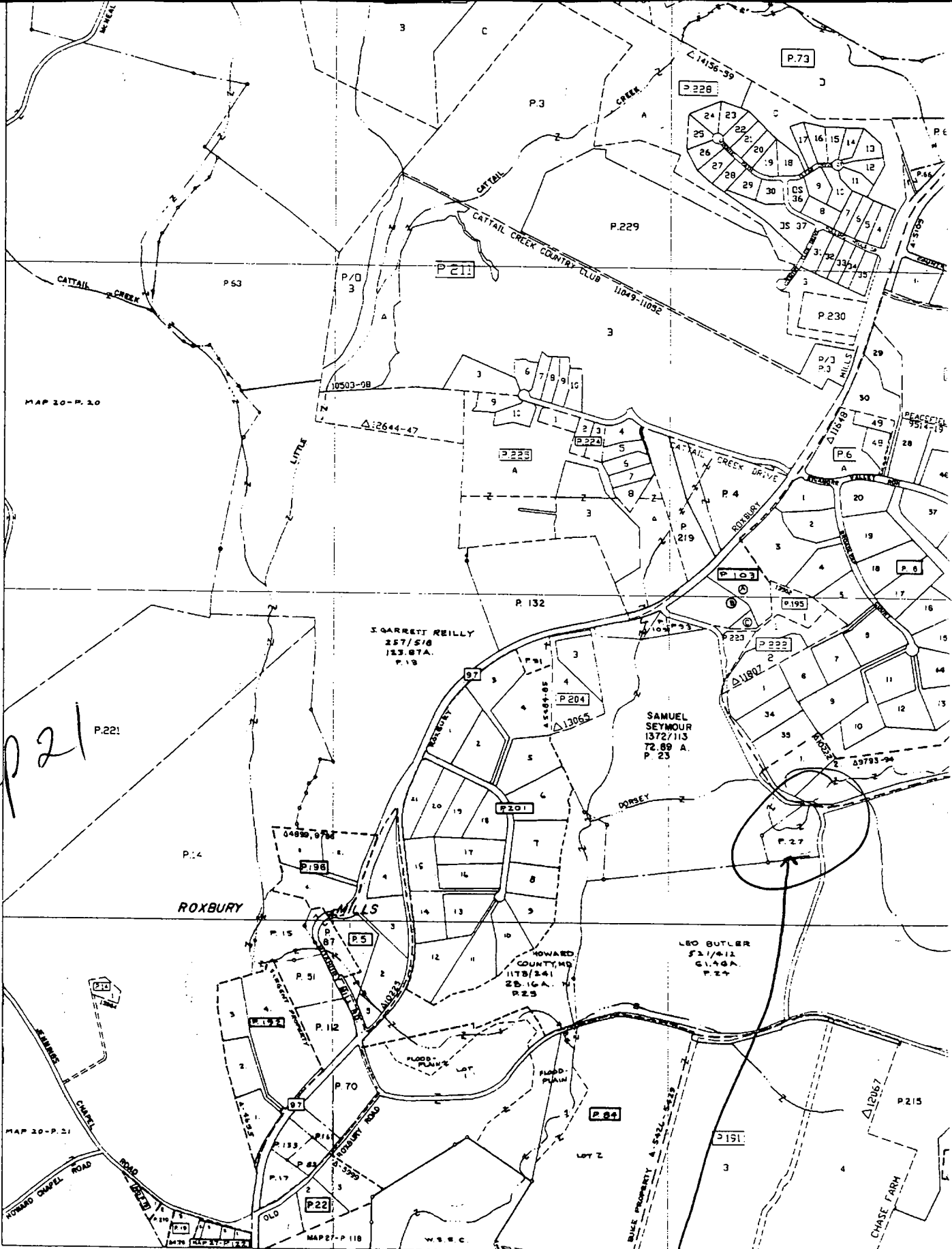

Map 21

20

1757933mN
3846385mE

COPYRIGHT - 1992 BY THE
STATE OF MARYLAND
ALL RIGHTS RESERVED

THESE MAPS ARE PROTECTED BY COPYRIGHT THEY MAY NOT BE COPIED
OR REPRODUCED IN ANY FORM INCLUDING ELECTRONIC MEANS SUCH AS:
DIGITIZING SCANNING VECTORING OR IMAGE PROCESSING OR BY ANY
SYSTEM NOW KNOWN OR TO BE INVENTED WITHOUT PERMISSION IN
WRITING FROM THE MARYLAND OFFICE OF PLANNING.

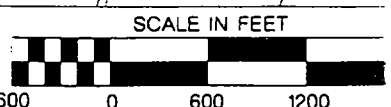

Glenville & Hatboro
Soils

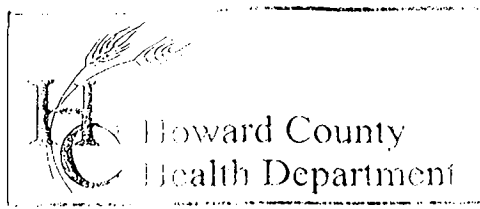

3525 H Ellicott Mills Drive, Ellicott City, MD 21043
(410) 313-2640 Fax (410) 313-2648
TDD (410) 313-2323 Toll Free 1-866-313-6300
website: www.hchealth.org

Penny E. Borenstein, M.D., M.P.H., Health Officer

January 6, 2003

RE: 15282 Roxbury Road
Map: 21 Parcel: 21

To Whom It May Concern:

Review of our records on the above property shows concerns regarding the present septic system as well as future repairs for the septic system. Our records indicate a repair has not been done on this property since the existence of the house built in 1900. Typically, septic systems are repaired approximately every 25-30 years. Because the soils are identified as wet season soils, it may be inferred that the current system is failing and possibly contaminating the water table. Any future permits for repairs for additions will not be signed until it is confirmed in the field that a suitable repair can be done. Because of high water tables on this property, a conventional trench repair may not be issued. Instead, a sand mound system may be an option or a drip system which may cost between \$20-30, 000.

Due to the age of the property and its existence prior to the creation of the Howard County Health Department, we have very few records on the property. Please note, however, that the property has a spring as a potable water source. Any future well drillings we need to be upslope of the septic system. If you have any further questions for this property, please call us at 410-313-1771.

Sincerely,

A handwritten signature in cursive script that reads 'Kacie Noonan'.

Kacie Noonan, Sanitarian
Well and Sewer Department

JONES WELL DRILLING, INC.
 3700 RUSH ROAD
 JARRETTSVILLE, MD 21084
 (410) 692-6981

Date Test Completed: 2-27-03

Page: 1

Well Depth: ?

Initials: AM

Permit No: NO TAG ON WELL

Subdivision:

Section: Lot:

Road: 15282 ROXBURY RD..

District:

	Time	Water Level Feet	Time to Fill 5-Gallon Bucket Seconds	Gallons Per Minute
1	10:15	40	40	7.50
2	10:30	40	40	7.50
3	10:45	38	40	7.50
4	11:00	38	40	7.50
5	11:15	35	40	7.50
6	11:30	34	40	7.50
7	11:45	31	40	7.50
8	12:00	31	40	7.50
9	12:15	31	40	7.50
10	12:30	31	40	7.50
11	12:45	31	40	7.50
12	1:00	31	40	7.50
13	1:15	31	40	7.50
14				
15				
16				
17				
18				
19				
20				
21				
22				
23				
24				
25				
26				
27				
28				

FUTURE PERFORMANCE MAY VARY FROM TESTED PERFORMANCE

3-5-03 Confirming existing well in house was tested.
 No new well drilled. (KN)