

# PERMIT

SEWAGE DISPOSAL SYSTEM

DEPARTMENT OF HEALTH AND MENTAL HYGIENE

P 512-861-A

A REPAIR

02-235366

DISTRICT \_\_\_\_\_

DATE 8/25/99

HOWARD COUNTY HEALTH DEPARTMENT

BUREAU OF ENVIRONMENTAL HEALTH

~~XXXXXX~~ 410-313-2640

DATE SYSTEM APPROVED \_\_\_\_\_

INSPECTOR \_\_\_\_\_

INDEXED

Jenkins Brothers IS PERMITTED TO INSTALL \_\_\_\_\_ ALTER \_\_\_\_\_

ADDRESS 7670 Smith's Private Road, Sykesville, MD 21784 PHONE 410-461-9282

SUBDIVISION \_\_\_\_\_ LOT \_\_\_\_\_ ROAD 4395 Montgomery Road

PROPERTY OWNER Shaw

ADDRESS 4395 Montgomery Road

SEPTIC TANK CAPACITY \_\_\_\_\_ GALLONS

NUMBER OF BEDROOMS 3

25 SQUARE FEET PER BEDROOM

LINEAR FEET OF TRENCH REQUIRED \_\_\_\_\_

REPAIR - PURPOSE - Existing septic system has failed. (8-24-99)  
Call for inspection when ground is opened so sanitarian can recommend repair.

PLANS APPROVED BY \_\_\_\_\_ DATE \_\_\_\_\_

COVER NO WORK UNTIL INSPECTED AND APPROVED

NEITHER THE HOWARD COUNTY COUNCIL NOR THE HEALTH DEPARTMENT IS RESPONSIBLE FOR THE SUCCESSFUL OPERATION OF ANY SYSTEM

NOTE: CLEANOUT REQUIRED EVERY 70 FEET OF SEWER LINE AND/OR AT 90° SWEEPS IN LINES FROM HOUSE TO DRAIN FIELDS, 90° ELBOWS NOT ACCEPTABLE.

NOTE: ALL PARTS OF SEPTIC SYSTEMS (I.E. TANK, DISTRIBUTION BOX TRENCHES) TO BE 100 FEET FROM WELL (UNLESS OTHERWISE SPECIFICALLY AUTHORIZED)

NOTE: IF DEEP TRENCH(ES) ARE USED CALL FOR INSPECTION BEFORE AND AFTER PLACING GRAVEL IN TRENCH(ES)

NOTE: NO DRY WELL SHALL EXCEED 15 FOOT IN DIAMETER NO ABSORPTION TRENCH TO EXCEED 100 FEET IN LENGTH

NOTE: ALL PIPE FROM HOUSE TO SEPTIC TANK MUST BE CAST IRON OR SCHEDULE 35/40 PVC OR ABS

PERMIT VOID AFTER TWO YEARS

NOTE: INSTALL STAND PIPE ON SEPTIC TANK AND DRY WELL STAND PIPES MUST BE 6 INCHES IN DIAMETER CAST IRON, CONCRETE OR TERRA COTTA OR PVA OR ABS ACCEPTED. IF TOP OF SEPTIC TANK IS DEEPER THAN 3 FEET, MANHOLE TO GRADE REQUIRED.

NOTE: DISTRIBUTION BOXES MUST HAVE BAFFLES

\*INSTALLER IS RESPONSIBLE FOR OBTAINING FINAL APPROVAL ON THIS PERMIT

P 512 861-A



SEE MAP 24B & 24C.

Post-It Fax Note	7671	Date	8/20/99	# of pages	2
To	MARIE EFKW	From	DIANA NASON		
Co. Dept.		Co.			
Phone #		Phone #			
Fax #	X 2648	Fax #			



9/23/99  
 AFTER CALLS  
 W/OWNER,  
 ENGINEERING  
 AND OFFICE  
 OF REAL ESTATE,  
 IT IS APPARENT  
 THAT  
 NO PUBLIC  
 SEWERAGE  
 ACCESS  
 EXISTS  
 FOR 4395 Mont. Rd  
 (MR)

7 99  
 MAR 99

2  
34  
36  
52  
121  
X8  
968

7/21/68  
After taking to town

40  
X8  
320  
2  
640

# PERMIT

SEWAGE DISPOSAL SYSTEM

MARYLAND STATE DEPARTMENT OF HEALTH

HOWARD COUNTY

ELLICOTT CITY

**INDEXED**

DISTRICT 3

DATE 10/27/67

Septic Tank IS PERMITTED TO INSTALL 2 ALTERNATE

ADDRESS 30 Astoria Hill Dr. PHONE 467-3849

A SEWAGE DISPOSAL SYSTEM LOCATED AT \_\_\_\_\_

SUBDIVISION "Map Ridge" ROAD Garrett Rd. LOT 14  
(add subdivision)

PROPERTY OWNER Mr. & Mrs. Raymond C. Seater, Sr.

ADDRESS 49 Montgomery Rd., Ellicott City, Md.

**SPECIFICATIONS**

DRAIN FIELD \_\_\_\_\_ DEPTH \_\_\_\_\_ FEET. BOTTOM AREA \_\_\_\_\_ SQ. FT.

SEEPAGE PITS \_\_\_\_\_ ABSORBENT SIDE-WALL AREA \_\_\_\_\_ SQ. FT.

SEPTIC TANK CAPACITY 750 GALLONS

FOR GARBAGE GRINDER, INCREASE DISPOSAL AREA 25% & TANK CAPACITY 50%

OTHER Dry Well - Dig pit 16 ft. square - set block and top for 12 ft. diam. and fill in rest of pit with gravel. Inlet pipe for dry well 4 ft. below original grade. Depth of dry well 9 ft. deep below inlet pipe. Max. depth permitted for dry well is 14 ft. below original grade. Place dry well 63 ft. from rear lot line and 15 ft. from left sideline as seen when facing lot from Garrett Rd.

PLANS APPROVED BY D. W. Houghan DATE 10/27/67

FILL SEPTIC TANK AND DISTRIBUTION BOX WITH WATER BEFORE CALLING FOR AN INSPECTION. COVER NO WORK UNTIL INSPECTED AND APPROVED.

NEITHER THE HOWARD COUNTY COMMISSIONERS NOR THE HEALTH DEPARTMENT IS RESPONSIBLE FOR THE SUCCESSFUL OPERATION OF ANY SYSTEM.

**NOTIFY THE HEALTH DEPARTMENT 48 HOURS BEFORE EXCAVATIONS ARE TO BE BACK FILLED.**

L 1382

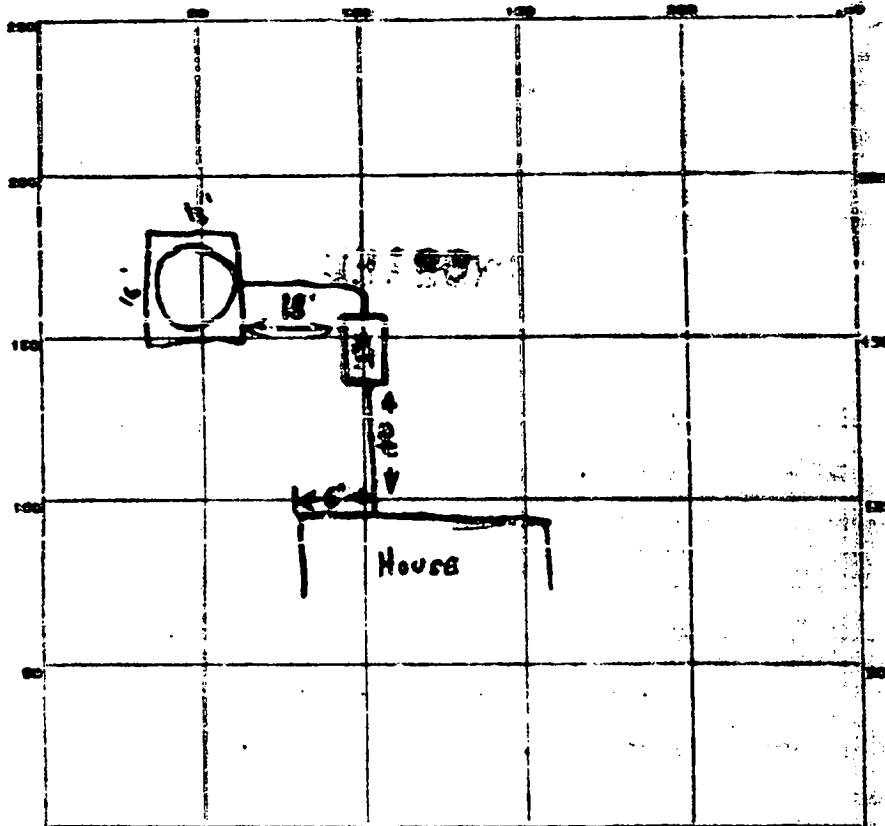

INDICATE NORTH BY AN ADJOINING ROADWAY AS BASE LINE.

*Carroll St.*

PERMIT CARD

SEPTIC TANK, LEVEL  CLEANOUTS

DISTRIBUTION BOX, LEVEL \_\_\_\_\_

TILE FIELD, DEPTH \_\_\_\_\_ FT. TRENCH WIDTH \_\_\_\_\_ FT.

GRAVEL DEPTH \_\_\_\_\_ IN. TOTAL LENGTH \_\_\_\_\_ FT.

NUMBER OF TRENCHES \_\_\_\_\_ TOTAL BOTTOM AREA \_\_\_\_\_

SEEPAGE PITS, ~~NUMBER~~ *16* SQ. FT. DEPTH BELOW INLET *9* FT.

ABSORBENT AREA \_\_\_\_\_ SQ. FT.

REMARKS \_\_\_\_\_  
 \_\_\_\_\_  
 \_\_\_\_\_  
 \_\_\_\_\_  
 \_\_\_\_\_

DATE SYSTEM APPROVED *2-20-68* INSPECTOR *P. F. Farnell*

# APPLICATION

A 1336  
P \_\_\_\_\_

SEWAGE DISPOSAL TESTING

MARYLAND STATE DEPARTMENT OF HEALTH

HOWARD COUNTY

ELICOTT CITY

DISTRICT 2

Septic Tank - 750 gal

DATE 10/4/67

Dry Well - Dry pit 4 ft square - 5 at block and top of pit with ground level  
for 18 ft diameter and pit in rest of pit with ground level. Length of dry well 9 ft dry  
pipe for dry well 4 ft below original grade. ~~Length of dry well 9 ft dry~~  
below water table. Max depth permitted for dry well is 13 ft below original  
grade.

16  
9 1/2  
Clear dry well 13 ft from rear to line and 15 ft from left  
side as now shown showing lot from Carroll Rd.

TO: THE COUNTY HEALTH OFFICER  
ELICOTT CITY, MARYLAND

I HEREBY APPLY FOR THE NECESSARY TESTS IN ORDER TO CONSTRUCT OR RECONSTRUCT A SEWAGE DISPOSAL SYSTEM.

PROPERTY OWNER Mr. & Mrs. Maynard C. Zentax, Sr.

ADDRESS 49 Montgomery Rd., Ellicott City, Md. PHONE HO 5-4674

PROPERTY LOCATION

SUBDIVISION "Mont Pidge" LOT NO. 134 (Old Sub division)

ROAD AND DESCRIPTION Carroll Road - off Montgomery Road - next to 49 Montgomery Road

OCCUPANT \_\_\_\_\_ PHONE \_\_\_\_\_

PERSON TO CONSTRUCT SYSTEM \_\_\_\_\_

ADDRESS \_\_\_\_\_ PHONE \_\_\_\_\_

SIZE OF LOT 100' x 200' TYPE BLDG. 3

IF NOT SINGLE RESIDENCE DESCRIBE \_\_\_\_\_ (Single Fmly. Dwlg.)

SIGNATURE OF APPLICANT Associated Home Builders Inc.

APPROVED BY Donald W. Morgan FOR Dry Well (no 2) DATE 10-27-67

REJECTED BY \_\_\_\_\_ FOR \_\_\_\_\_ DATE \_\_\_\_\_

HOLD PENDING FURTHER TESTS \_\_\_\_\_ DATE \_\_\_\_\_

REASONS FOR REJECTION OR HOLDING \_\_\_\_\_

## THIS IS NOT A PERMIT

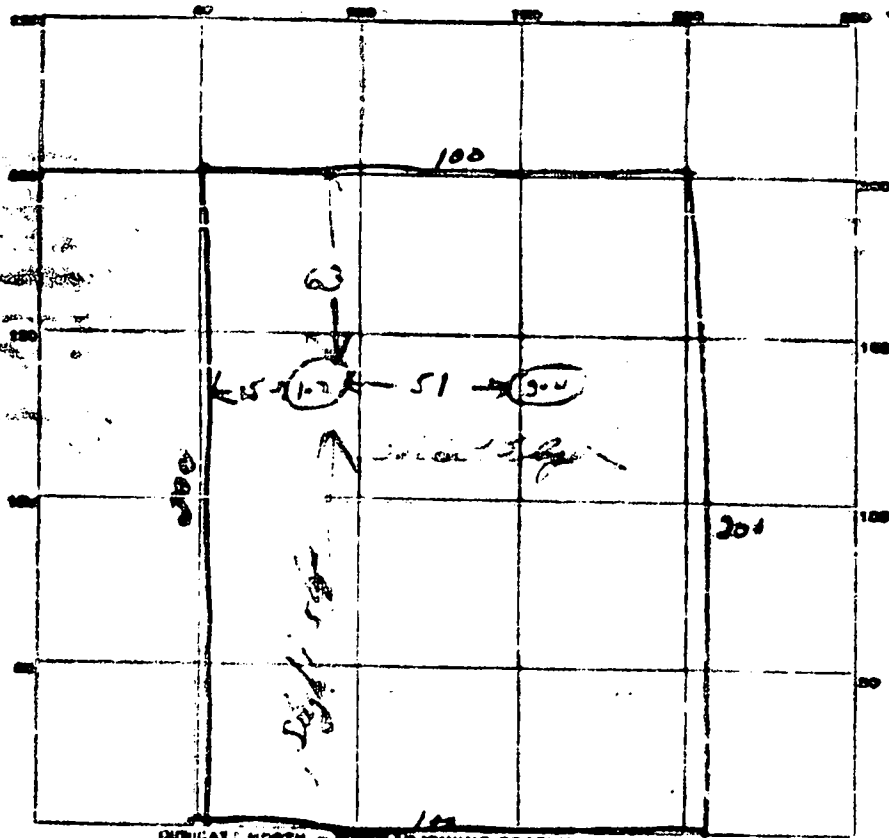

INDICATE NORTH. WHEN ADJOINING ROADWAY AS BASE LINE.

Carroll Rd.

DATE	TEST NO	DEPTH	PRE-WET		TEST - 1" DROP		TIME
			START	STOP	START	STOP	
10/27/52	1	9 ft	10 01	10 23	10 03	10 07	4 min
	2	4 ft	10 07	10 12	10 07	10 10	5 min
	3	9 ft	10 09	10 12	10 12	10 30	18 min
	4	5 ft	10 20	10 25	10 10	10 10	18 min
	2A	7 ft	10 45	10 50	10 50	11 04	14 min
	3A	13 ft	11 25	11 30	11 12	11 22	16 min

Some trash  
on lot 1-2  
Some trash  
on 3-4

SOIL AUGER FINDING: *light grey clay*

TESTED BY: *DW*

REMARKS: *lot 1-2 adjacent to 100' - no water*  
*no ground water to be seen*

A13136

CARROLL (150' W.) ROAD

700' [unclear] [unclear]

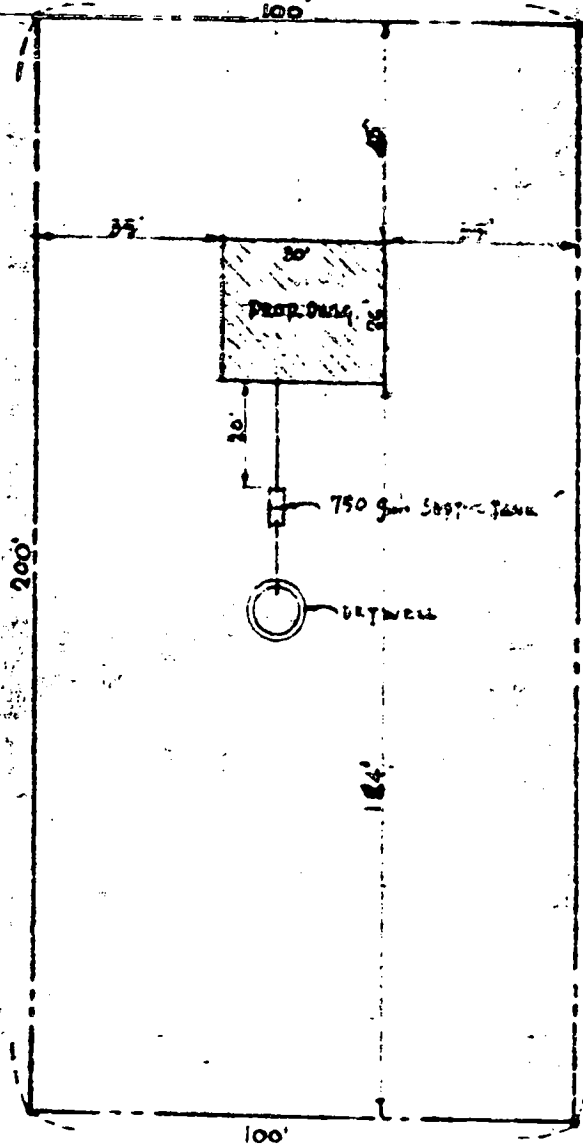

NOTE:  
 INDIVIDUAL SEWAGE DISPOSAL  
 SYSTEMS TO MEET LOCAL HEALTH  
 DEPT. REQ.

Tax Map 24  
 Parcel 924  
 D. Best

Plot Plan  
 SCALE 1" = 30'

10/2/14

PROPERTY OF  
 MR. & MRS. MAYNARD C. ZENTER, SR.  
 "MONT RIDGE"  
 LOT 14, HOWARD COUNTY, MARYLAND  
 LIBER 280, FOLIO 525