

# PERMIT

SEWAGE DISPOSAL SYSTEM

DEPARTMENT OF HEALTH AND MENTAL HYGIENE

P 511520

A REPAIR

DISTRICT \_\_\_\_\_

DATE 4-16-99

HOWARD COUNTY HEALTH DEPARTMENT

BUREAU OF ENVIRONMENTAL HEALTH

~~XXXXXXX~~ 410-313-2640

RPS# 363268

DATE SYSTEM APPROVED 4/19/99

INSPECTOR M. Rife

## INDEXED

Zepp Plumbing & Heating, Inc. IS PERMITTED TO INSTALL \_\_\_\_\_ ALTER X

ADDRESS 12447 Route 108, Clarksville, Maryland 21029 PHONE 410-531-6712

SUBDIVISION Simons Subd. LOT 3 ROAD 7071 Pindell School Road

PROPERTY OWNER Frances Kelly  
ADDRESS 7071 Pindell School Road  
Fulton, Maryland 21059

SEPTIC TANK CAPACITY existing 1000 GALLONS

NUMBER OF BEDROOMS 4

41-3 193  
cut 3

125 SQUARE FEET PER BEDROOM

Square sidewall  
LINEAR FEET OF TRENCH REQUIRED 500

REPAIR - PURPOSE - DRYWELL HAS FAILED.

Call for inspection when ground is opened so sanitarian can recommend repair. 04/08/1999

one dry well 500 sqft. Total Sidewalls, final dimension to be determined as installed, existing septic tanks OK.

R/R 4/9/99

PLANS APPROVED BY \_\_\_\_\_ DATE \_\_\_\_\_

COVER NO WORK UNTIL INSPECTED AND APPROVED

NEITHER THE HOWARD COUNTY COUNCIL NOR THE HEALTH DEPARTMENT IS RESPONSIBLE FOR THE SUCCESSFUL OPERATION OF ANY SYSTEM

NOTE: CLEANOUT REQUIRED EVERY 70 FEET OF SEWER LINE AND/OR AT 90° SWEEPS IN LINES FROM HOUSE TO DRAIN FIELDS. 90° ELBOWS NOT ACCEPTABLE.

NOTE: ALL PARTS OF SEPTIC SYSTEMS (I.E. TANK, DISTRIBUTION BOX TRENCHES) TO BE 100 FEET FROM WELL (UNLESS OTHERWISE SPECIFICALLY AUTHORIZED)

NOTE: IF DEEP TRENCH(ES) ARE USED CALL FOR INSPECTION BEFORE AND AFTER PLACING GRAVEL IN TRENCH(ES)

NOTE: NO DRY WELL SHALL EXCEED 15 FOOT IN DIAMETER NO ABSORPTION TRENCH TO EXCEED 100 FEET IN LENGTH

NOTE: ALL PIPE FROM HOUSE TO SEPTIC TANK MUST BE CAST IRON OR SCHEDULE 35/40 PVC OR ABS

PERMIT VOID AFTER TWO YEARS

NOTE: INSTALL STAND PIPE ON SEPTIC TANK AND DRY WELL STAND PIPES MUST BE 6 INCHES IN DIAMETER CAST IRON, CONCRETE OR TERRA COTTA OR PVA OR ABS ACCEPTED. IF TOP OF SEPTIC TANK IS DEEPER THAN 3 FEET, MANHOLE TO GRADE REQUIRED.

NOTE: DISTRIBUTION BOXES MUST HAVE BAFFLES

**\*INSTALLER IS RESPONSIBLE FOR OBTAINING FINAL APPROVAL ON THIS PERMIT**

511520

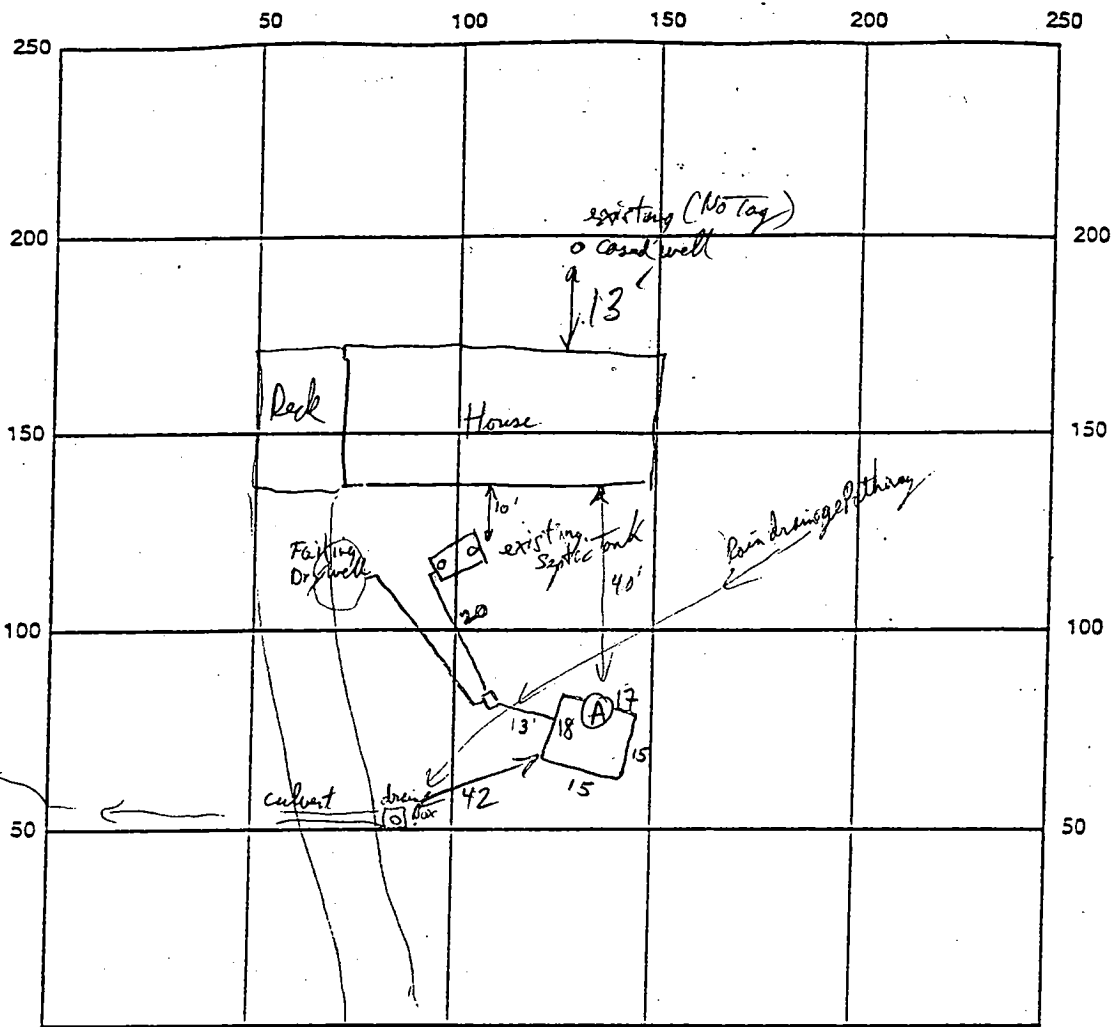

INDICATE NORTH - NAME ADJOINING ROADWAY AS BASE LINE

SEPTIC TANK LEVEL EX. 1000 GAL CLEANOUTS 2 @ S.T., NONE @ EX. D/W 1 @ NEW D/W

DISTRIBUTION BOX LEVEL OK - BAFFLE IN

DRAIN FIELD/TITLE DEPTH 12.0 FT. TRENCH WIDTH      FT. INLET DEPTH 5.0 FT.

EFFECTIVE GRAVEL DEPTH 7.0 FT. TOTAL LENGTH      FT.

NUMBER OF TRENCHES      ONE SIDEWALL/BOTTOM AREA      SQ. FT.

DRYWALL INSIDE <sup>PERIMETER</sup> DIAMETER 65 FT. EFFECTIVE DEPTH BELOW INLET 7.0 FT.

ABSORBENT AREA 455 SQ. FT.

REMARKS: 4/15/99 OK to cover house to distribution box OK to install cinder blocks (12' diameter) and stone du

4/19/99 OK TO FINISH & COVER (MR)

DATE SYSTEM APPROVED 4/19/99 INSPECTOR M. Ri Pkin

# PERMIT

Approved  
4/17/64  
RDF

P. 0307502

A. 07457

SEWAGE DISPOSAL SYSTEM

MARYLAND STATE DEPARTMENT OF HEALTH

HOWARD COUNTY

## INDEXED

ELLICOTT CITY

DISTRICT 5

DATE 9-30-63

Richard L. Peirce

IS PERMITTED TO INSTALL  ALTER

ADDRESS \_\_\_\_\_ PHONE \_\_\_\_\_

A SEWAGE DISPOSAL SYSTEM LOCATED AT \_\_\_\_\_

SUBDIVISION Summers Div. ROAD Paradise School Rd 3

PROPERTY OWNER Richard L. Peirce

ADDRESS \_\_\_\_\_

### SPECIFICATIONS

BLDG. PERMIT SIGNED  
AND RETURNED Walter  
Sumner # 07725  
2nd

DRAIN FIELD \_\_\_\_\_ DEPTH \_\_\_\_\_ FEET. BOTTOM AREA \_\_\_\_\_ SQ. FT.

SEEPAGE PITS  ABSORBENT SIDE-WALL AREA 800 SQ. FT. Below inlet

SEPTIC TANK CAPACITY 750 GALLONS

FOR GARBAGE GRINDER, INCREASE DISPOSAL AREA 22% & TANK CAPACITY 80%.

OTHER Place dry wells 70 to 120 ft from right lot line and

130 ft to left lot line as seen when facing lot from  
3/11/64. See utility plan for sewer

Paradise School Rd

PLANS APPROVED BY Raymond Hedges DATE 9-27-63

FILL SEPTIC TANK AND DISTRIBUTION BOX WITH WATER BEFORE CALLING FOR AN INSPECTION. COVER NO WORK UNTIL INSPECTED AND APPROVED.

NEITHER THE HOWARD COUNTY COMMISSIONERS NOR THE HEALTH DEPARTMENT IS RESPONSIBLE FOR THE SUCCESSFUL OPERATION OF ANY SYSTEM.

See attached sheet for specifications for leaching  
bed with dry well

07457

71.4  
 - 12  
 62.8  
 31.4  
 376.8  
 14  
 1507.2  
 368  
 6275.2

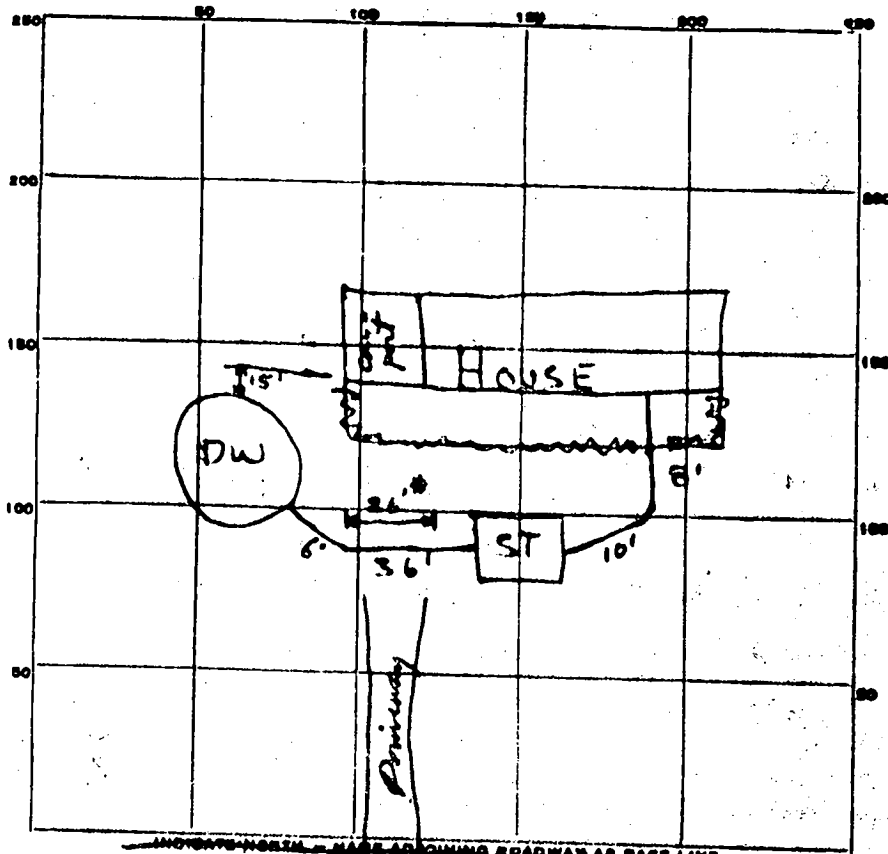

INDICATE NORTH - MAKE ADJOINING ROADWAY AS BASE LINE.  
 Pindell School Rd.

PERMIT CARD OK

SEPTIC TANK, LEVEL DK

CLEANOUTS OK

DISTRIBUTION BOX, LEVEL \_\_\_\_\_

TILE FIELD, DEPTH \_\_\_\_\_ FT. TRENCH WIDTH \_\_\_\_\_ FT.

GRAVEL DEPTH \_\_\_\_\_ IN. TOTAL LENGTH \_\_\_\_\_ FT.

NUMBER OF TRENCHES \_\_\_\_\_ TOTAL BOTTOM AREA \_\_\_\_\_

SEEPAGE PITS, INSIDE DIAMETER 12 FT. DEPTH BELOW INLET 10 FT.

ABSORBENT AREA 376 SQ. FT.

REMARKS Dist wall to dist wall diameter = 14 ft =  
12' x 14' = 527 sq ft absorbent sidewall area  
\* 26' cast iron pipe for driveway into compartment

DATE SYSTEM APPROVED 4/17/64

INSPECTOR R. D. Fletcher



