

12/23/98
Repair 10am
12/24/98
10-11

PERMIT

SEWAGE DISPOSAL SYSTEM

DEPARTMENT OF HEALTH AND MENTAL HYGIENE

P 511329

A REPAIR

DISTRICT _____

DATE 12/29/98

NO Record found

HOWARD COUNTY HEALTH DEPARTMENT

BUREAU OF ENVIRONMENTAL HEALTH

~~XXXXXXX~~ 410-313-2640

DATE SYSTEM APPROVED 12/29/98

INSPECTOR DKS

INDEXED

Jenkins Brothers IS PERMITTED TO INSTALL _____ ALTER X

ADDRESS 7670 Smith's Private Road Sykesville, Maryland 21784 PHONE (410) 461-9282

SUBDIVISION _____ LOT _____ ROAD 6166 Guilford Road

PROPERTY OWNER _____

ADDRESS 6166 Guilford Road

SEPTIC TANK CAPACITY 1500 GALLONS

NUMBER OF BEDROOMS 5 (to be)

180 SQUARE FEET PER BEDROOM

LINEAR FEET OF TRENCH REQUIRED 150

REPAIR - PURPOSE - SEPTIC SYSTEM HAS FAILED.

call for inspection when ground is open so sanitarian can recommend repair.

Existing septic tank and trench to be properly abandoned

Replacement trenches to be 2' wide, inlet 4', bottom 10',
stone 6'

PLANS APPROVED BY [Signature] DATE 12/23/98

COVER NO WORK UNTIL INSPECTED AND APPROVED

NEITHER THE HOWARD COUNTY COUNCIL NOR THE HEALTH DEPARTMENT IS RESPONSIBLE FOR THE SUCCESSFUL OPERATION OF ANY SYSTEM

NOTE: CLEANOUT REQUIRED EVERY 70 FEET OF SEWER LINE AND/OR AT 90° SWEEPS IN LINES FROM HOUSE TO DRAIN FIELDS. 90° ELBOWS NOT ACCEPTABLE.

NOTE: ALL PARTS OF SEPTIC SYSTEMS (I.E. TANK, DISTRIBUTION BOX TRENCHES) TO BE 100 FEET FROM WELL (UNLESS OTHERWISE SPECIFICALLY AUTHORIZED)

NOTE: IF DEEP TRENCH(ES) ARE USED CALL FOR INSPECTION BEFORE AND AFTER PLACING GRAVEL IN TRENCH(ES)

NOTE: NO DRY WELL SHALL EXCEED 15 FOOT IN DIAMETER NO ABSORPTION TRENCH TO EXCEED 100 FEET IN LENGTH

NOTE: ALL PIPE FROM HOUSE TO SEPTIC TANK MUST BE CAST IRON OR SCHEDULE 25/40 PVC OR ABS

PERMIT VOID AFTER TWO YEARS

NOTE: INSTALL STAND PIPE ON SEPTIC TANK AND DRY WELL STAND PIPES MUST BE 6 INCHES IN DIAMETER CAST IRON, CONCRETE OR TERRA COTTA OR PVA OR ABS ACCEPTED. IF TOP OF SEPTIC TANK IS DEEPER THAN 3 FEET, MANHOLE TO GRADE REQUIRED.

NOTE: DISTRIBUTION BOXES MUST HAVE BAFFLES

***INSTALLER IS RESPONSIBLE FOR OBTAINING FINAL APPROVAL ON THIS PERMIT**

***CALL 461-9933 FOR INSPECTION OF SEPTIC SYSTEM.**

511329

6166 Route 32 (Guilford Rd)

Both addresses found on Tax Map: 34 Block: 18

172135.8mN
405512.4mE

Parcels 97+88
504

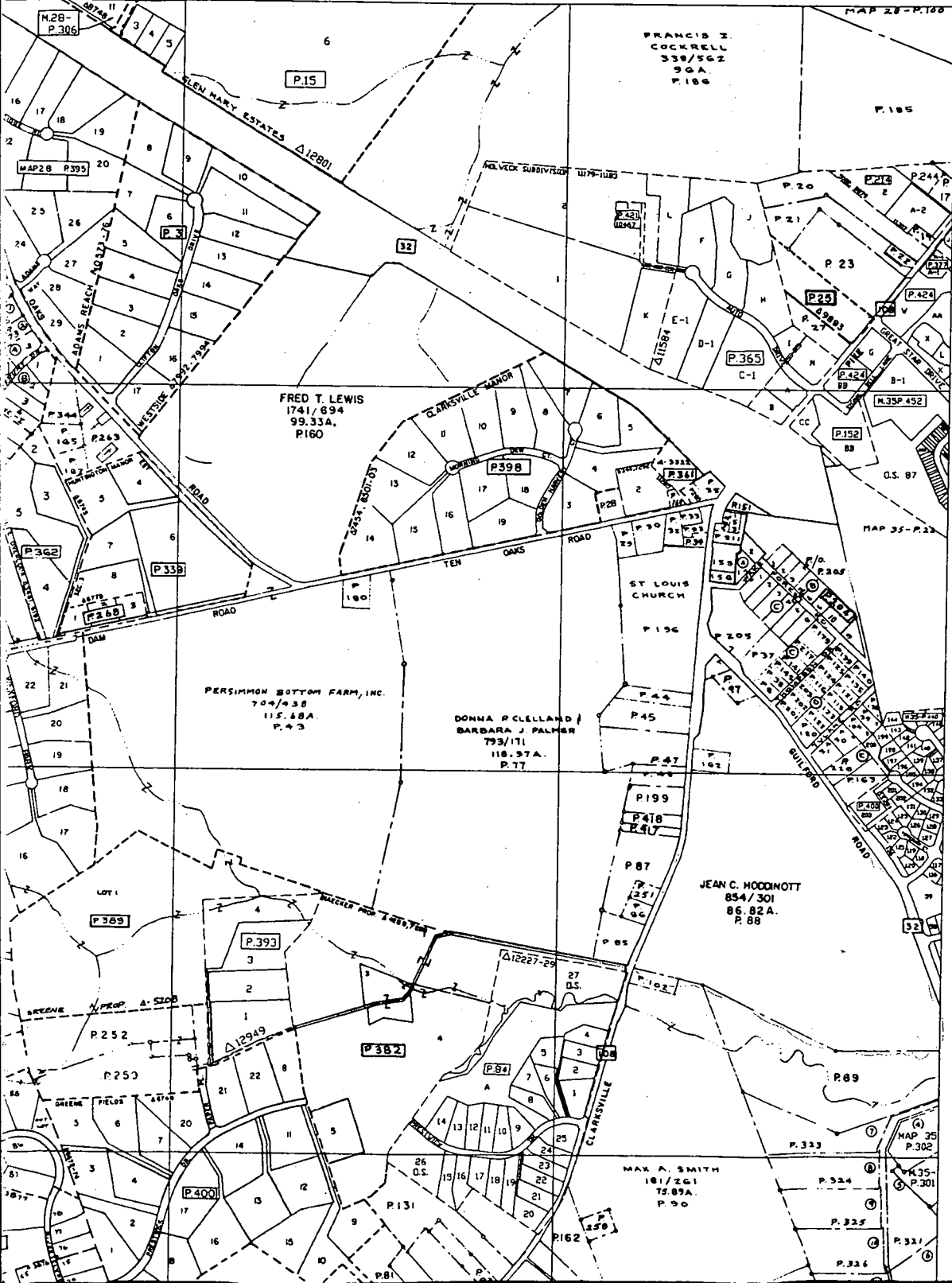

501

35 498

495