

10/23/98 S.M. TEST  
10:00

# PERMIT

## SEWAGE DISPOSAL SYSTEM

### DEPARTMENT OF HEALTH AND MENTAL HYGIENE

P 511022

A REPAIR

DISTRICT \_\_\_\_\_

DATE 10/5/98

DATE SYSTEM APPROVED 12/11/98

INSPECTOR CW

HOWARD COUNTY HEALTH DEPARTMENT  
BUREAU OF ENVIRONMENTAL HEALTH  
~~XXXXXXXX~~ 410-313-2640

**INDEXED**

04-320107

Arnold's Backhoe & Septic Services IS PERMITTED TO INSTALL \_\_\_\_\_ ALTER X

ADDRESS P. O. Box 15, Woodbine, Maryland 21797 PHONE 410-795-7873

Parcel: 84

SUBDIVISION \_\_\_\_\_ LOT Tax Map: 6 ROAD 18235 Penn Shop Road

PROPERTY OWNER \_\_\_\_\_ Prev. D. P. Johnson

ADDRESS 18235 Penn Shop Road

SEPTIC TANK CAPACITY \_\_\_\_\_ GALLONS

NUMBER OF BEDROOMS \_\_\_\_\_

\_\_\_\_\_ SQUARE FEET PER BEDROOM

LINEAR FEET OF TRENCH REQUIRED \_\_\_\_\_

REPAIR - PURPOSE - DRYWELL HAS FAILED.

Call for inspection when ground is opened so sanitarian can recommend repair. 9-23/98

PERC RATES EXCEED 30 MINUTES

APPLICANT NOT INTERESTED IN PURSUING MORE COMPLEX EVALUATION

AT THIS TIME - OBJECT IS TRANSFER OF OWNERSHIP.

INSTALL 1500 G. HOLDING TANK - RENEW DISPOSAL FIELD EVALUATION

AT LATER DATE AT NEW OWNERS DISCRETION.

PLANS APPROVED BY \_\_\_\_\_ MR/CW DATE \_\_\_\_\_

COVER NO WORK UNTIL INSPECTED AND APPROVED

NEITHER THE HOWARD COUNTY COUNCIL NOR THE HEALTH DEPARTMENT IS RESPONSIBLE FOR THE SUCCESSFUL OPERATION OF ANY SYSTEM

NOTE: CLEANOUT REQUIRED EVERY 70 FEET OF SEWER LINE AND/OR AT 90° SWEEPS IN LINES FROM HOUSE TO DRAIN FIELDS. 90° ELBOWS NOT ACCEPTABLE.

NOTE: ALL PARTS OF SEPTIC SYSTEMS (I.E. TANK, DISTRIBUTION BOX TRENCHES) TO BE 100 FEET FROM WELL (UNLESS OTHERWISE SPECIFICALLY AUTHORIZED)

NOTE: IF DEEP TRENCH(ES) ARE USED CALL FOR INSPECTION BEFORE AND AFTER PLACING GRAVEL IN TRENCH(ES)

NOTE: NO DRY WELL SHALL EXCEED 15 FOOT IN DIAMETER NO ABSORPTION TRENCH TO EXCEED 100 FEET IN LENGTH

NOTE: ALL PIPE FROM HOUSE TO SEPTIC TANK MUST BE CAST IRON OR SCHEDULE 35/40 PVC OR ABS

PERMIT VOID AFTER TWO YEARS

NOTE: INSTALL STAND PIPE ON SEPTIC TANK AND DRY WELL STAND PIPES MUST BE 8 INCHES IN DIAMETER CAST IRON, CONCRETE OR TERRA COTTA OR PVA OR ABS ACCEPTED. IF TOP OF SEPTIC TANK IS DEEPER THAN 3 FEET, MANHOLE TO GRADE REQUIRED.

NOTE: DISTRIBUTION BOXES MUST HAVE BAFFLES

**\*INSTALLER IS RESPONSIBLE FOR OBTAINING FINAL APPROVAL ON THIS PERMIT**

**\*CALL 461-9933 FOR INSPECTION OF SEPTIC SYSTEM.**

511022-1

10:21 10:38 11:12 11:58 12:58 12:50  
 10:38 11:12 11:58 12:58 12:50  
 8:19 11:35 12:05 12:50

① 2'3"  
 10:50 11:05  
 1/8"  
 ① 3'2"  
 11:13 11:31  
 1/8"  
 ① 14"  
 11:31 12:34  
 1/8"

③  
 12:40  
 1/8"  
 3' brn silt  
 5' silt  
 5' brn silty  
 1' 11" 30% frags  
 76' dump silty

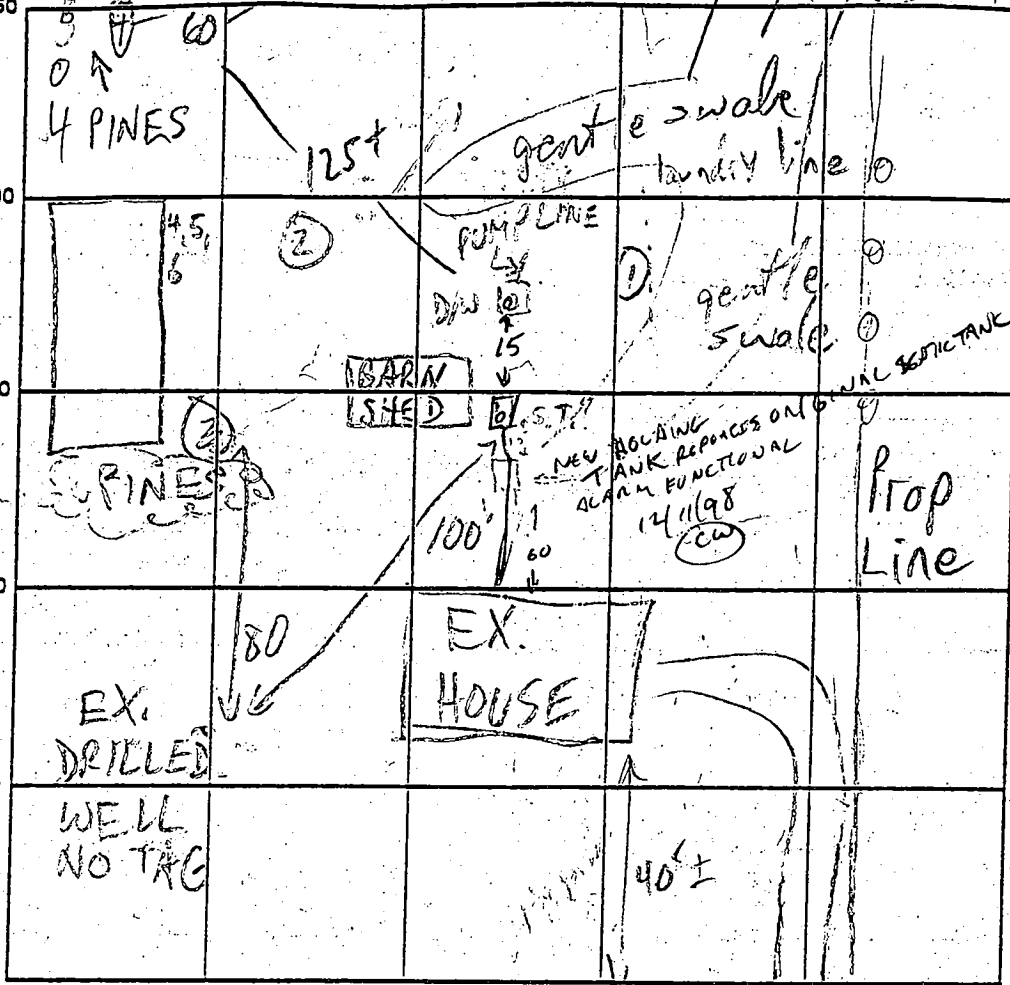

① + ②  
 6" brn topsoil  
 1 1/2" yel si cl. fm  
 1 1/2" gray stone 40%  
 brn si cl. fm  
 150'  
 72" brn damp gravelly fm  
 30-50% frags  
 100'  
 100'  
 50' portions of white extremely sticky creamy silt

INDICATE NORTH - NAME ADJOINING ROADWAY AS BASE LINE **PENN SHOP RD**

SEPTIC TANK LEVEL 1500 GAL. 7 CLEANOUTS MANHOLE 1

DISTRIBUTION BOX LEVEL HOLDING TANK

DRAIN FIELD/TITLE DEPTH \_\_\_\_\_ FT. TRENCH WIDTH \_\_\_\_\_ FT. INLET DEPTH \_\_\_\_\_ FT.

EFFECTIVE GRAVEL DEPTH \_\_\_\_\_ FT. TOTAL LENGTH \_\_\_\_\_ FT.

NUMBER OF TRENCHES \_\_\_\_\_ ONE SIDEWALL/BOTTOM AREA \_\_\_\_\_ SQ. FT.

DRYWALL INSIDE DIAMETER \_\_\_\_\_ FT. EFFECTIVE DEPTH BELOW INLET \_\_\_\_\_ FT.

ABSORBENT AREA \_\_\_\_\_ SQ. FT.

100  
 95  
 120 45  
 105 70  
 90

REMARKS: 10/5/98 PERCS NOT SUCCESSFUL - REVU w/OWNER'S AGENT (MR)  
10/23/98 ONE ADD'L CONVO. TEST ATTEMPT (#4-6) MR  
12/11/98 HOME-MADE SEPTIC TANK REPLACED WITH 1500 G HOLDING TANK.  
DRYWELL ABANDONED AND FILLED. AVAILABLE ALARM IN BASEMENT FUNCTIONAL.  
FENNEO CONNECTOR TO EXISTING ORANGE BUNG HOUSE SEWER LINE.

DATE SYSTEM APPROVED Cwellman INSPECTOR 12/11/98

10:00 a.m. 10/9

Howard County Health Department

To: FILE 18235-Penn

SITE EVAL: Shop Rd

SANDY MAT'L MAY BE

CLOSE TO 7', BUT

WH. STICKY LAYER

UNDERNEATH WOULD

⇒ PONDING ON TOP

NOT A LEGIT. OPTION  
FOR CONVENT'L

From:

MR/CW

REPAIR

Date:

10/5

HD-170

RECORDED  
11/6/99 SEE LAST PAGE (CW)

D R A F T

000100

CONSENT AGREEMENT FOR USE OF HOLDING TANKS  
TO CORRECT FAILING SEWAGE SYSTEMS

THIS AGREEMENT made this 1 day of December,  
19 98, by and between Estate of OSCAR P Johnson

HEREINAFTER REFERRED TO AS Owner, and the Howard County Bureau of  
Environmental Health, HEREINAFTER REFERRED TO AS the Bureau.

WHEREAS, Owner is seized and possessed of a tract of land at  
address 18235 Penn Shop Road Mt. Airy MD 21771,  
known as Tax Map 6 Grid 4 Parcel 84 Lot     , the  
deed to same being recorded among the land records of Howard  
County, Maryland, in Liber 290, Folio 12.

WHEREAS, the Howard County Bureau of Environmental Health has  
ordered the Owner to correct the on-site sewage disposal problems  
and all parties concerned recognize the only alternative available  
is a holding tank.

WHEREAS, Owner's land meets requirements of COMAR 26.04.02 and  
~~Policy Directive R.S. #7~~ for installation of a holding tank. NOW  
THEREFORE, the parties hereto agree as follows:

2'  
20'

MK  
RLK  
G.P.J.

LIBER 4572 FOLIO 0093

LIBER 4 5 7 2 FOLIO 0 9 4

- A. The Owner will install a holding tank consistent with the design approved and permitted by the Bureau and follow the provision of Policy Directive R.S. #7 issued May 20, 1987.
- B. Owner agrees to insure reasonable access to the property and system by the Bureau as well as to provide any information requested by the Bureau to assure proper operation and maintenance of the Holding Tank.
- C. Owner agrees that there shall be no liability on the part of the County or Bureau to Owner if the Holding Tank is not properly maintained.
- D. Owner acknowledges and agrees that neither the Bureau nor any of its agents or employees, either officially or individually underwrites the operation of the Holding Tank and it is understood that the Holding Tank is a last resort method to correct existing sewage disposal problems on the property.
- E. The Owner will devote such care and effort to the maintenance of the Holding Tank so that is shall not

*Mik  
RUC  
OPT*

the public health, safety or comfort or to issue any other orders or take any other action which is now or may hereafter be within its authority.

- L. Owner certifies that he has obtained a cost estimate and is financially capable of having the sewage removed from the Holding Tank by a permitted sewage waste hauler on a regular basis so that the Holding Tank never overflows. The Owner further agrees to enter into and maintain a written service contract which will be renewed annually with any permitted scavenger and will forward a copy to the Bureau prior to the approval of the permit for the Holding Tank installation and annually thereafter.
- M. If the Owner installs any new plumbing, he shall install only water conserving fixtures. (e.g. toilets installed will use no more than 1 1/2 gallons of water per flush).
- N. The Owner shall not perform any renovations or remodeling which enlarges the living space of the residence. Room additions necessary to provide bathroom facilities to

LBN 4 5 7 2 FILED 0 0 9 7

NYK  
ZLK  
OPT

LIBER 4 5 7 2 FOLD 0 0 9 8

accommodate installation of indoor plumbing are not prohibited.

O. The approval of a Holding Tank system provided for in this agreement is only for an interim period until public sewerage facilities become available, at which time the Owner shall connect the house to the public facilities and shall properly abandon and backfill the Holding Tank.

P. The Owner shall provide notice of continuous pumping of the tank by a licensed scavenger as evidenced by submitting copies of pumping receipts to the Bureau on a quarterly basis.

WITNESS, the hand and seal of the parties hereto.

DATE: 12/1/98

OWNER: Oscar Perry Johnson Jr. Per. Rep.

DATE: 12/23/98

OWNER: Nancy L Knight Robert Knight

DATE: 1/6/99

Mark E. Kiffin Sanitarian, Howard County Bureau of Environmental Health

DATE: 1-6-99

F. Paul Shinn Director, Howard County Bureau of Environmental Health

DATE:

RE/MAX Realty Plus  
Robert Zirkle  
1601 Shu F Feeville Rd.  
Mt. Airy Md. 21771

INF ADJUST  
RECORDING FEE 2.00  
TOTAL 20.00  
Rest HOGE 12.00  
MOR SLG Ref # 6370  
Jan. 06, 1999 Bk # 538 09:34 am

301 831 7722  
410 549 4911

OPT

REGION \_\_\_\_\_

AREA \_\_\_\_\_ RATING \_\_\_\_\_

ACKNOWLEDGMENT AND CONTROLS	DATE

Howard County Department of Health  
BUREAU OF ENVIRONMENTAL HEALTH

DISPOSITION	DATE

**RECORD OF INVESTIGATION**

LOCATION 18235 Penn Shop Road ZIP \_\_\_\_\_

OWNER  Mr. Knight ADDRESS 18235 Penn Shop Rd PHONE \_\_\_\_\_

OCCUPANT  \_\_\_\_\_ ADDRESS \_\_\_\_\_ PHONE \_\_\_\_\_

COMPLAINANT 18231 Penn Shop ADDRESS \_\_\_\_\_ PHONE \_\_\_\_\_

REASON FOR INVESTIGATION Holding tank on house beside 18231 being disconnected and the old system re-connected - old system is just a pipe to the neighbors property.

RECEIVED BY Amy McMillen DATE 6/28/99 ASSIGNED TO Kim See DATE 6/28/99

DATE OF INVESTIGATION 6/28/99 TIME 1:30pm WEATHER hot, humid ~90°

REPORT I arrived at the site and spoke w/ Mr. Knight - he explained that an excavator had just replace a line from septic tank to rest of system (?). He further explained that the holding (septic) tank plug for the outlet was removed. I advised him that the tank was the only septic system approved at this time and that he must disconnect the new pipe exiting the holding tank and replace the plug. I reminded him that wet season evaluation could be done in Spring 2000 to explore other options.

6/28/99 3:30 p.m. I arrived at site and found that the plug had been replaced and the new pipe had been disconnected.

DATE SUBMITTED 6/28/99 SANITARIAN [Signature]







---

## HOWARD COUNTY HEALTH DEPARTMENT

---

*Joyce M. Boyd, M.D., County Health Officer*

October 28, 1998

Mr. Robert Zirkle  
c/o Reimax Realty  
1601 Shaffersville Road  
Mt. Airy, MD 21771

RE: Septic System Repair Testing  
18235 Penn Shop Road

Dear Mr. Zirkle:

Repair percolation testing conducted October 5 and October 23, 1998 at the referenced property was inconclusive. A copy of the test results is enclosed.

Locations with test rates suited for conventional septic system repair displayed indications of seasonally elevated groundwater levels such that no determination could safely be reached without additional testing in the wet season (expected start date February 1, 1999).

Planned testing for non-conventional repair did not occur. However, the design and evaluation processes for non-conventional septic systems can be lengthy and there is no certainty of a positive outcome. Therefore, the need to eliminate the problem condition indicated by a septic system drywell installed in the water table becomes paramount. At this moment, it is necessary to pump and collapse the existing drywell and convert the existing septic tank to a holding tank while deliberations continue on the various repair options.

If you desire, an office conference can be scheduled to further explore these matters. Please call this office at (410) 313-2640 to schedule this meeting.

Very truly yours,  
*Mark E. Rifkin*  
Mark E. Rifkin, R.S.  
Water and Sewerage Program

MR  
cc: Arnold's Septic  
File