

10/10/62
incomplete

PERMIT

P 05688

A 05608

SEWAGE DISPOSAL SYSTEM

MARYLAND STATE DEPARTMENT OF HEALTH

HOWARD COUNTY

ELLICOTT CITY

INDEXED

INDEXED

DISTRICT h
DATE 8-27-62

Louis D. Hook and Son

IS PERMITTED TO INSTALL ALTER

ADDRESS 6425 Baltimore Nat. Pike PHONE _____

A SEWAGE DISPOSAL SYSTEM LOCATED AT Daisy Road about 2 9/10 miles from Rt. 114 on right
red flag on mailbox about 2/10 mi. past Daisy Church

SUBDIVISION _____ ROAD _____ LOT _____

PROPERTY OWNER Roy Davis

ADDRESS Daisy

SPECIFICATIONS

DRAIN FIELD _____ DEPTH _____ FEET, BOTTOM AREA _____ SQ. FT.

SEEPAGE PITS ABSORBENT SIDE-WALL AREA _____ SQ. FT.

SEPTIC TANK CAPACITY 750 GALLONS

FOR GARBAGE GRINDER, INCREASE DISPOSAL AREA 22% & TANK CAPACITY 50%.

OTHER Dry Well - One Dry Well 10 ft. diameter and 10 ft. deep below the inlet
pipe. Inlet pipe to be 3 ft. below original grade. Place dry well in area that
passed percolation test.

PLANS APPROVED BY Donald W. Monaghan DATE 8-14-62

FILL SEPTIC TANK AND DISTRIBUTION BOX WITH WATER BEFORE CALLING FOR AN INSPECTION. COVER NO WORK UNTIL INSPECTED AND APPROVED.

NEITHER THE HOWARD COUNTY COMMISSIONERS NOR THE HEALTH DEPARTMENT IS RESPONSIBLE FOR THE SUCCESSFUL OPERATION OF ANY SYSTEM.

A05608

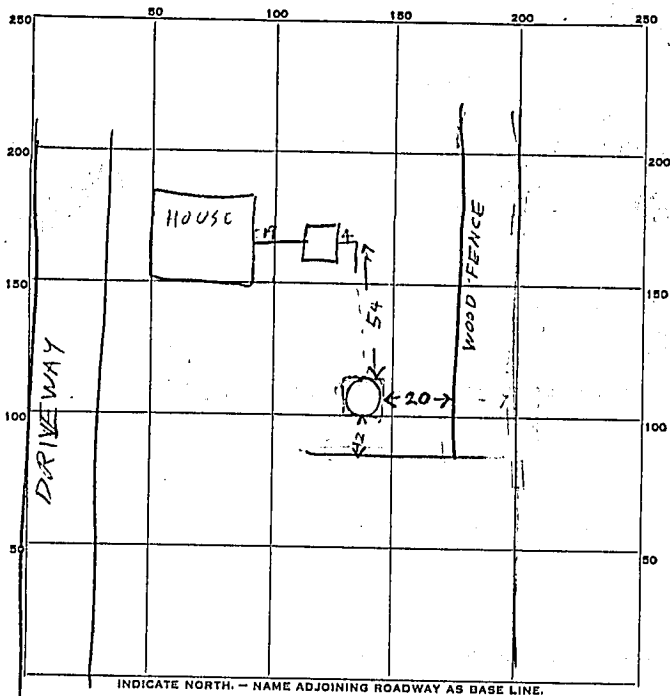

PERMIT CARD _____

SEPTIC TANK, LEVEL OK Top is 2 ft. below grade

CLEANOUTS OK

DISTRIBUTION BOX, LEVEL _____

TILE FIELD, DEPTH _____ FT. TRENCH WIDTH _____ FT.

GRAVEL DEPTH _____ IN. TOTAL LENGTH _____ FT.

NUMBER OF TRENCHES _____ TOTAL BOTTOM AREA _____

SEEPAGE PITS, INSIDE DIAMETER 11 FT. DEPTH BELOW INLET _____ FT.

ABSORBENT AREA _____ SQ. FT.

REMARKS Dry Well: 10' deep below top. Inlet pipe not installed. Top not finished. More stone needed between dirt wall & under block. System will be OK if these things are finished. Tank can be covered.

5/27/63. owner states this system was completed & is satisfied except for cleanout pipe not being installed. DWY

DATE SYSTEM APPROVED _____

INSPECTOR _____