

4/29/65

# PERMIT

Approved  
4/29/65  
R.F.

SEWAGE DISPOSAL SYSTEM

P. 09734

47

A. 3/9/65

089

MARYLAND STATE DEPARTMENT OF HEALTH

HOWARD COUNTY

## INDEXED

ELLICOTT CITY

DISTRICT 4

DATE 3/9/65

Howard Triplett IS PERMITTED TO INSTALL  ALTER

ADDRESS Rt. 3, Mt. Airy, Md. PHONE HU 9-4535

A SEWAGE DISPOSAL SYSTEM LOCATED AT Daisy Rd.

SUBDIVISION River Farms Estates ROAD Daisy Rd. LOT \_\_\_\_\_

PROPERTY OWNER Scott Smith

ADDRESS Daisy Rd., River Farms Estates

### SPECIFICATIONS

DRAIN FIELD \_\_\_\_\_ DEPTH \_\_\_\_\_ FEET, BOTTOM AREA \_\_\_\_\_ SQ. FT.

SEEPAGE PITS \_\_\_\_\_ ABSORBENT SIDE-WALL AREA \_\_\_\_\_ SQ. FT.

SEPTIC TANK CAPACITY 1,000 GALLONS

FOR GARBAGE GRINDER, INCREASE DISPOSAL AREA 22% & TANK CAPACITY 50%.

OTHER Dry Well 120 sq. ft. sidewall area below the inlet per bedroom. Inlet

pipe must be 4 ft. below grade. Place Dry Well about 442 ft. from wooded area on

rear of lot and about 586 ft. from wooded area on left sideline as seen when facing

lot from Daisy Rd.

*12 ft diameter with 6" gravel  
2 ft deep below inlet  
600 sq. ft. dry well - June 9/1/65*

PLANS APPROVED BY D. W. Monaghan DATE 9/29/64

FILL SEPTIC TANK AND DISTRIBUTION BOX WITH WATER BEFORE CALLING FOR AN INSPECTION. COVER NO WORK UNTIL INSPECTED AND APPROVED.

NEITHER THE HOWARD COUNTY COMMISSIONERS NOR THE HEALTH DEPARTMENT IS RESPONSIBLE FOR THE SUCCESSFUL OPERATION OF ANY SYSTEM.

4480  
6449

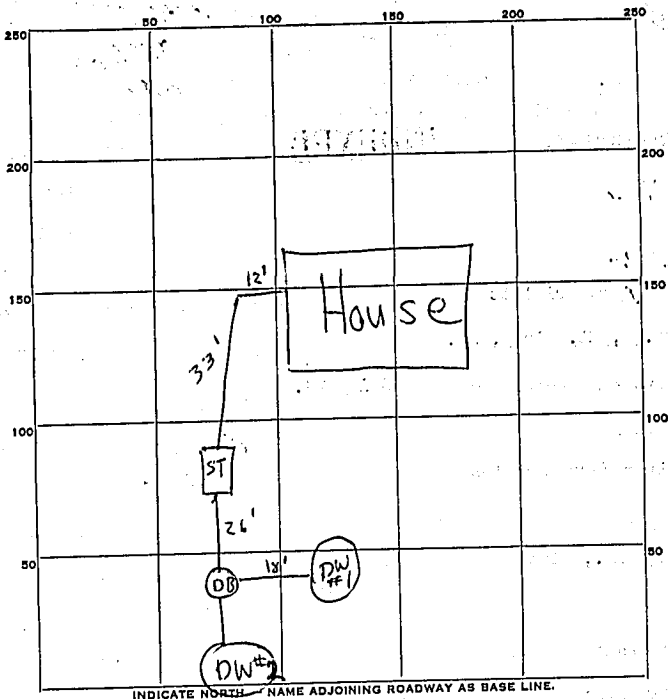

PERMIT CARD OK

SEPTIC TANK, LEVEL OK CLEANOUTS OK

DISTRIBUTION BOX, LEVEL OK

TILE FIELD, DEPTH \_\_\_\_\_ FT. TRENCH WIDTH \_\_\_\_\_ FT.

GRAVEL DEPTH \_\_\_\_\_ IN. TOTAL LENGTH \_\_\_\_\_ FT.

NUMBER OF TRENCHES \_\_\_\_\_ TOTAL BOTTOM AREA \_\_\_\_\_

SEEPAGE PITS, INSIDE DIAMETER \_\_\_\_\_ FT. DEPTH BELOW INLET \_\_\_\_\_ FT.

ABSORBENT AREA \_\_\_\_\_ SQ. FT.

REMARKS Drywell #1 - 7 1/2 ft. below inlet by 12 1/2' top = 301 sq ft.  
" #2 - 7 1/2 ft " " " " = 301 " "  
602

DATE SYSTEM APPROVED 4/28/65 INSPECTOR R. J. [Signature]