

Am  
7-30-98 (Cancelled)  
8-4-98  
ASAP C.O.

# PERMIT

## SEWAGE DISPOSAL SYSTEM

### DEPARTMENT OF HEALTH AND MENTAL HYGIENE INDEXED

P 510593B

A REPAIR

DISTRICT \_\_\_\_\_

DATE 7-30-98

DATE SYSTEM APPROVED 8-4-98

INSPECTOR KM

HOWARD COUNTY HEALTH DEPARTMENT  
BUREAU OF ENVIRONMENTAL HEALTH  
~~XXXXXXXX~~ 410-313-2640

05-345871

Jack Fyock Septic Services IS PERMITTED TO INSTALL \_\_\_\_\_ ALTER

ADDRESS P.O. Box 89, Glenelg, MD 21737 PHONE 410-988-9270

SUBDIVISION Green Hill Manor LOT 17, Blk A ROAD 6726 Mink Hollow Road

PROPERTY OWNER Radas

ADDRESS 6726 Mink Hollow Road, Highland, MD 20777

SEPTIC TANK CAPACITY 1250 GALLONS

NUMBER OF BEDROOMS 4

125 SQUARE FEET PER BEDROOM

LINEAR FEET OF TRENCH REQUIRED 55 (all that can be installed in this area) without losing future repair area (KM)

REPAIR - PURPOSE - SEPTIC SYSTEM HAS FAILED.

Call for an inspection when the ground is opened so a sanitarian can recommend repairs. 7-30-98.

Bottom at 10.0', Inlet at 4.0, 6' of stone, trench to be 3' wide

PLANS APPROVED BY Kim Maisto

DATE 8-4-98

COVER NO WORK UNTIL INSPECTED AND APPROVED

NEITHER THE HOWARD COUNTY COUNCIL NOR THE HEALTH DEPARTMENT IS RESPONSIBLE FOR THE SUCCESSFUL OPERATION OF ANY SYSTEM

NOTE: CLEANOUT REQUIRED EVERY 70 FEET OF SEWER LINE AND/OR AT 90° SWEEPS IN LINES FROM HOUSE TO DRAIN FIELDS, 90° ELBOWS NOT ACCEPTABLE.

NOTE: ALL PARTS OF SEPTIC SYSTEMS (I.E. TANK, DISTRIBUTION BOX TRENCHES) TO BE 100 FEET FROM WELL (UNLESS OTHERWISE SPECIFICALLY AUTHORIZED)

NOTE: IF DEEP TRENCH(ES) ARE USED CALL FOR INSPECTION BEFORE AND AFTER PLACING GRAVEL IN TRENCH(ES)

NOTE: NO DRY WELL SHALL EXCEED 15 FOOT IN DIAMETER NO ABSORPTION TRENCH TO EXCEED 100 FEET IN LENGTH

NOTE: ALL PIPE FROM HOUSE TO SEPTIC TANK MUST BE CAST IRON OR SCHEDULE 35/40 PVC OR ABS

PERMIT VOID AFTER TWO YEARS

NOTE: INSTALL STAND PIPE ON SEPTIC TANK AND DRY WELL STAND PIPES MUST BE 6 INCHES IN DIAMETER CAST IRON, CONCRETE OR TERRA COTTA OR PVA OR ABS ACCEPTED. IF TOP OF SEPTIC TANK IS DEEPER THAN 3 FEET, MANHOLE TO GRADE REQUIRED.

NOTE: DISTRIBUTION BOXES MUST HAVE BAFFLES

\*INSTALLER IS RESPONSIBLE FOR OBTAINING FINAL APPROVAL ON THIS PERMIT

P510593B

A  
 orange/red c/lm 3'  
 pink/tan silty clay lm 100% shale 13'  
 3.5'  
 10:10<sub>10</sub> → 10:11<sub>30</sub>  
 10:11<sub>30</sub> → 10:13<sub>30</sub>  
 2 minutes

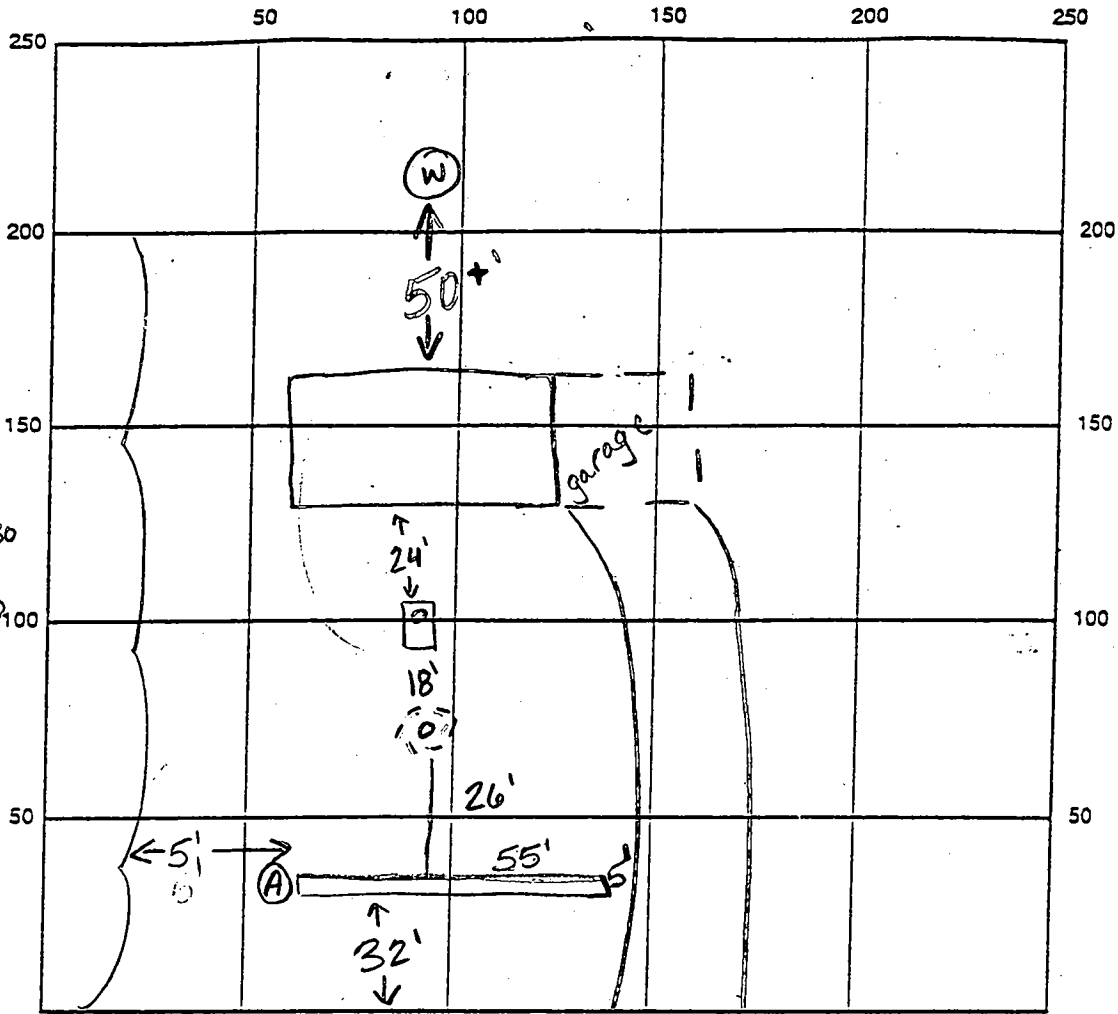

INDICATE NORTH - NAME ADJOINING ROADWAY AS BASE LINE

Mink Hollow

SEPTIC TANK LEVEL 1250 (existing)

CLEANOUTS 1 on tank, 1 on drywell

DISTRIBUTION BOX LEVEL \_\_\_\_\_

DRAIN FIELD/TITLE DEPTH 10.0 FT.

TRENCH WIDTH 3.0 FT.

INLET DEPTH 4.0 FT.

EFFECTIVE GRAVEL DEPTH 6.00 FT.

TOTAL LENGTH 155 FT. → 55

NUMBER OF TRENCHES 1

ONE SIDEWALL/BOTTOM AREA 330 SQ. FT.

DRYWALL INSIDE DIAMETER existing FT.

EFFECTIVE DEPTH BELOW INLET 4' FT.

ABSORBENT AREA 527 SQ. FT.

REMARKS: 8.4.98 pumped drywell and tank, OK to cover all work (km)

DATE SYSTEM APPROVED 8.4.98

INSPECTOR Kim Morato

APP Complete No. 8-15-74

8/15/74

# PERMIT

P. ~~20403~~ 20403

A. ~~10338~~ 10338

SEWAGE DISPOSAL SYSTEM

MARYLAND STATE DEPARTMENT OF HEALTH

HOWARD COUNTY

ELLICOTT CITY

## INDEXED

DISTRICT 3

DATE 8/15/74 7/29/74

By A. Lowe IS PERMITTED TO INSTALL A ALTERNATE

ADDRESS 9220 Quiffish Road, Catonsville, Maryland PHONE \_\_\_\_\_

A SEWAGE DISPOSAL SYSTEM LOCATED AT \_\_\_\_\_

SUBDIVISION Green Hill Manor ROAD High Hollow Rd. LOT 17, Blk. A

PROPERTY OWNER Orlando & Teresa Green Robert & Angela Bruce

ADDRESS \_\_\_\_\_

SPECIFICATIONS - ~~3 bedroom~~ 4 BEDROOM S

DRAIN FIELD \_\_\_\_\_ DEPTH \_\_\_\_\_ FEET, BOTTOM AREA \_\_\_\_\_ SQ. FT.

SEEPAGE PITS \_\_\_\_\_ ABSORBENT SIDE-WALL AREA \_\_\_\_\_ SQ. FT.

SEPTIC TANK CAPACITY 1250 ~~2000~~ GALLONS

FOR GARBAGE GRINDER, INCREASE DISPOSAL AREA 25% & TANK CAPACITY 50%.

OTHER 480 Dry well - 300 sq. ft. sidewall area below the inlet. Dry well inlet no longer than 4 ft. and bottom of dry well no deeper than 12 ft. Place the dry well 25 ft. from the front lot line and 25 ft. from the left side of the lot as seen when facing the lot from High Hollow Road.

NOTE: ALL PIPE FROM HOUSE TO DRY WELL MUST BE CAST IRON.

PERMIT VOID AFTER THREE YEARS.

NOTE: INSTALL STEEL PIPE ON SEPTIC TANK AND DRY WELL.

PLANS APPROVED BY A. Lowe DATE 8/17/74

FILL SEPTIC TANK AND DISTRIBUTION BOX WITH WATER BEFORE CALLING FOR AN INSPECTION. COVER NO WORK UNTIL INSPECTED AND APPROVED.

NEITHER THE HOWARD COUNTY COMMISSIONERS NOR THE HEALTH DEPARTMENT IS RESPONSIBLE FOR THE SUCCESSFUL OPERATION OF ANY SYSTEM.

THIS PERMIT ISSUED AND RETURNED 8/15/74  
Lowe # 73387  
PLH

10338

Pool A 10338

7/65 tests near D.W. all in, at 489 ft. JIL

15  
15  
30  
16  
32  
30  
62  
496  
31  
527  
14  
8 1/2

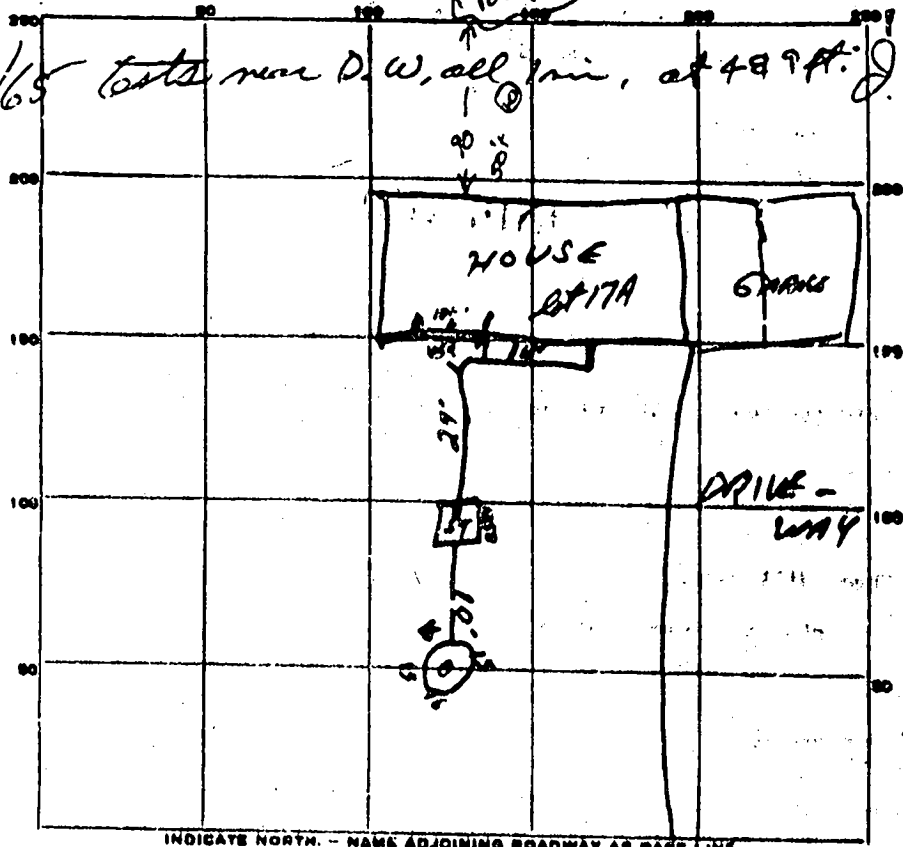

Location  
toped  
OK

INDICATE NORTH. - NAME ADJOINING ROADWAY AS BASE LINE.

PERMIT CARD PRESENT ✓ Mink Hollow RD

SEPTIC TANK, LEVEL OK CLEANOUTS OK ✓

DISTRIBUTION BOX, LEVEL N/A

TILE FIELD, DEPTH N/A FT. TRENCH WIDTH N/A FT.

GRAVEL DEPTH N/A IN. TOTAL LENGTH N/A FT.

NUMBER OF TRENCHES 0 TOTAL BOTTOM AREA N/A

TEPAGE PITS, OUTSIDE PERIMETER DIAMETER 62 FT. DEPTH BELOW INLET 8 1/2 FT.

ABSORBENT AREA 527 SQ. FT.

REMARKS

---



---



---



---



---

DATE SYSTEM APPROVED 8-15-74 INSPECTOR R J Zbor