

6-16-98
7-28-98
10:00 Repair

PERMIT

SEWAGE DISPOSAL SYSTEM

DEPARTMENT OF HEALTH AND MENTAL HYGIENE

INDEXED

P 510587

A REPAIR

DISTRICT _____

DATE 7.28.98

DATE SYSTEM APPROVED 7.28.98

INSPECTOR KM

HOWARD COUNTY HEALTH DEPARTMENT

BUREAU OF ENVIRONMENTAL HEALTH

~~XXXXXXXX~~ 410-313-2640

02-204835

Jenkins Brothers IS PERMITTED TO INSTALL _____ ALTER

ADDRESS 7670 Smith's Private Road, Sykesville, MD 21784 PHONE 410-461-9282

SUBDIVISION _____ LOT _____ ROAD 3611 Church Road

PROPERTY OWNER Devine, Nancy

ADDRESS 3611 Church Rd, Ellicott City, MD 21043

SEPTIC TANK CAPACITY 1000 GALLONS

NUMBER OF BEDROOMS 2

180 SQUARE FEET PER BEDROOM

LINEAR FEET OF TRENCH REQUIRED 72'

REPAIR - PURPOSE - SEPTIC SYSTEM HAS FAILED.

Call for an inspection when the ground is opened so a sanitarian can recommend repairs. 6/10/98.

Inlet at 2', bottom at 7', 5' of stone, trench to be 2' wide

PLANS APPROVED BY Kim Maisto DATE 7.28.98

COVER NO WORK UNTIL INSPECTED AND APPROVED

NEITHER THE HOWARD COUNTY COUNCIL NOR THE HEALTH DEPARTMENT IS RESPONSIBLE FOR THE SUCCESSFUL OPERATION OF ANY SYSTEM

NOTE: CLEANOUT REQUIRED EVERY 70 FEET OF SEWER LINE AND/OR AT 90° SWEEPS IN LINES FROM HOUSE TO DRAIN FIELDS. 90° ELBOWS NOT ACCEPTABLE.

NOTE: ALL PARTS OF SEPTIC SYSTEMS (I.E. TANK, DISTRIBUTION BOX TRENCHES) TO BE 100 FEET FROM WELL (UNLESS OTHERWISE SPECIFICALLY AUTHORIZED)

NOTE: IF DEEP TRENCH(ES) ARE USED CALL FOR INSPECTION BEFORE AND AFTER PLACING GRAVEL IN TRENCH(ES)

NOTE: NO DRY WELL SHALL EXCEED 15 FOOT IN DIAMETER NO ABSORPTION TRENCH TO EXCEED 100 FEET IN LENGTH

NOTE: ALL PIPE FROM HOUSE TO SEPTIC TANK MUST BE CAST IRON OR SCHEDULE 35/40 PVC OR ABS

PERMIT VOID AFTER TWO YEARS

NOTE: INSTALL STAND PIPE ON SEPTIC TANK AND DRY WELL STAND PIPES MUST BE 6 INCHES IN DIAMETER CAST IRON. CONCRETE OR TERRA COTTA OR PVA OR ABS ACCEPTED. IF TOP OF SEPTIC TANK IS DEEPER THAN 3 FEET. MANHOLE TO GRADE REQUIRED.

NOTE: DISTRIBUTION BOXES MUST HAVE BAFFLES

***INSTALLER IS RESPONSIBLE FOR OBTAINING FINAL APPROVAL ON THIS PERMIT**

P510587

A

tan
brown
Siclm
50%
rock
boulders
HARD
BOTTOM

7.0'

B

topsoil
orange
brown
clay lm
brown
Siclm
30%
boulders

6"
1.5'
11.5'

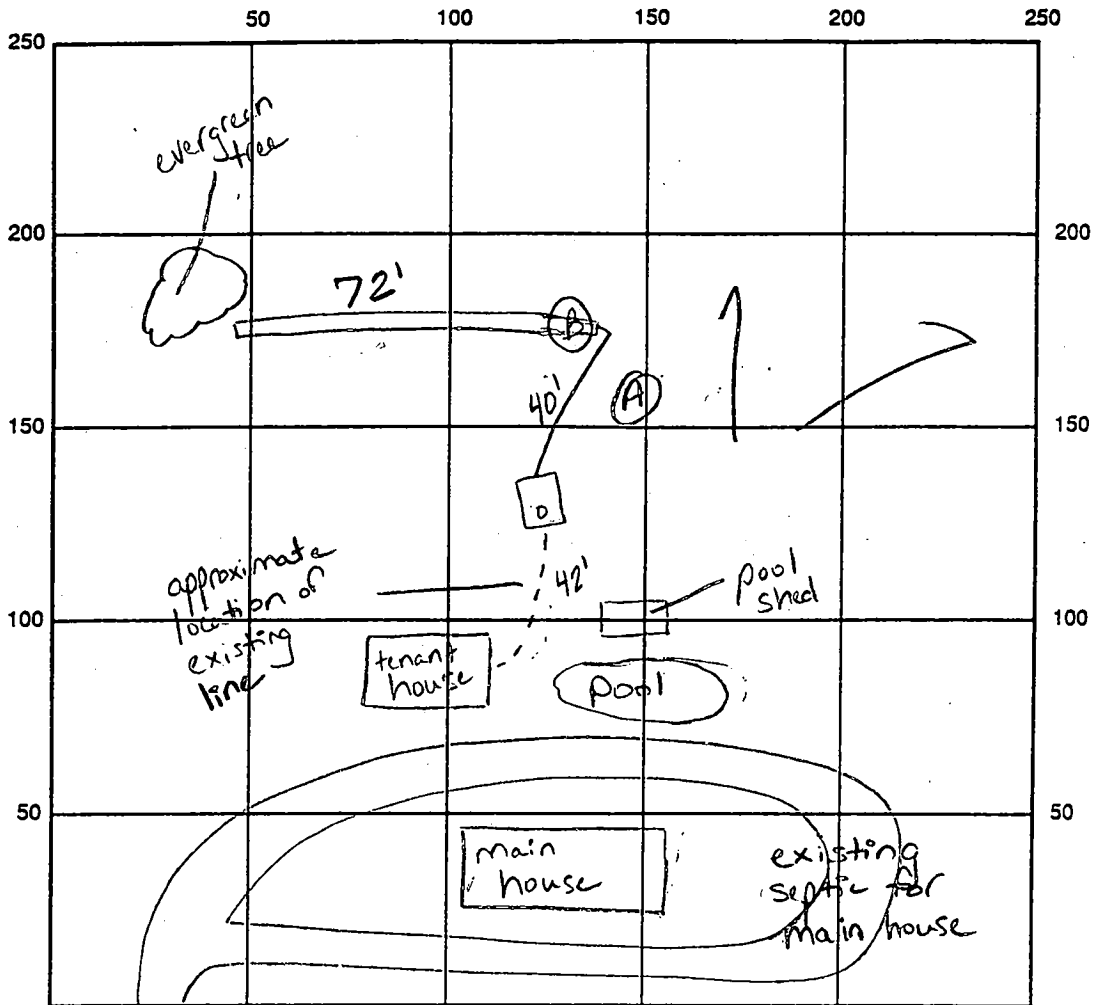

2.0'
10:32:30 → 10:33:50
10:33:50 → 10:36
2 minutes

5.0'
10:22 → 10:23
10:23 → 10:25 2 minutes

INDICATE NORTH - NAME ADJOINING ROADWAY AS BASE LINE

Church Rd.

SEPTIC TANK LEVEL 1000 gallons

CLEANOUTS 1 on tank (manhole)

DISTRIBUTION BOX LEVEL

DRAIN FIELD/TITLE DEPTH 7.0 FT. TRENCH WIDTH 2.0 FT. INLET DEPTH 2.0 FT.

EFFECTIVE GRAVEL DEPTH 5.0 FT. TOTAL LENGTH 1 x 72 FT. → 72'

NUMBER OF TRENCHES 1 ONE SIDEWALL/BOTTOM AREA 360 SQ. FT.

DRYWALL INSIDE DIAMETER FT. EFFECTIVE DEPTH BELOW INLET FT.

ABSORBENT AREA SQ. FT.

REMARKS: 7.28.98 - Property served by public water, existing septic for main house under driveway, OK to cover all work (RM)

DATE SYSTEM APPROVED 7.28.98

INSPECTOR Kim Maisto

MD

P. 4

P. 319

P. 5

DRIVE

PARK

P. 3

18

CHURCH ROAD

P. 13

P. 20

P. 265

P. 14

P. 15

P. 272

P. 247

P. 206

P. 255

P. 209

P. 16

P. 241

P. 76

P. 55

P. 125

P. 283

DRIVE

P. 161

P. 207

P. 126

P. 213

P. 242

P. 19

P. 159

P. 246

P. 43

P. 208

P. 243

LANE

P. 212

SYLVAN

P. 245

PELLE

P. 83

PARKING LOT

P. 297

SEE MAP 25 A

MAIN

ELLICOTT CITY

PIKE

ST

COLUMBIA

P. 232

BALTIMORE

P. 39

P. 44

P. 284