

6/26/98
C.O. 1200

125

PERMIT

SEWAGE DISPOSAL SYSTEM

DEPARTMENT OF HEALTH AND MENTAL HYGIENE

P 510224-C

A REPAIR

DISTRICT _____

DATE 08/24/98

HOWARD COUNTY HEALTH DEPARTMENT

BUREAU OF ENVIRONMENTAL HEALTH

~~XXXXXX~~ 410-313-2640

DATE SYSTEM APPROVED 6.26.98

INSPECTOR [Signature]

INDEXED

05-381908

Jack Fyock Septic Service

IS PERMITTED TO INSTALL _____ ALTER X

ADDRESS P.O. Box 89, Triadelphia Road, Glenelg, Maryland 21737 PHONE 410-988-9270

SUBDIVISION _____ LOT 6 ROAD 7392 Minter Lane

PROPERTY OWNER Fitzgibbons

ADDRESS 7392 Minter Lane
Columbia, Maryland 21044

SEPTIC TANK CAPACITY 1500 GALLONS

NUMBER OF BEDROOMS 5

125 SQUARE FEET PER BEDROOM

LINEAR FEET OF TRENCH REQUIRED 160

REPAIR - PURPOSE - SEPTIC SYSTEM HAS FAILED.

Call for inspection when ground is opened so sanitarian can recommend repair.
6/24/98

6/25/98 Inlet at 6', Bottom at 10'

PLANS APPROVED BY _____ DATE _____

COVER NO WORK UNTIL INSPECTED AND APPROVED

NEITHER THE HOWARD COUNTY COUNCIL NOR THE HEALTH DEPARTMENT IS RESPONSIBLE FOR THE SUCCESSFUL OPERATION OF ANY SYSTEM

NOTE: CLEANOUT REQUIRED EVERY 70 FEET OF SEWER LINE AND/OR AT 90° SWEEPS IN LINES FROM HOUSE TO DRAIN FIELDS. 90° ELBOWS NOT ACCEPTABLE.

NOTE: ALL PARTS OF SEPTIC SYSTEMS (I.E. TANK, DISTRIBUTION BOX TRENCHES) TO BE 100 FEET FROM WELL (UNLESS OTHERWISE SPECIFICALLY AUTHORIZED)

NOTE: IF DEEP TRENCH(ES) ARE USED CALL FOR INSPECTION BEFORE AND AFTER PLACING GRAVEL IN TRENCH(ES)

NOTE: NO DRY WELL SHALL EXCEED 15 FOOT IN DIAMETER NO ABSORPTION TRENCH TO EXCEED 100 FEET IN LENGTH

NOTE: ALL PIPE FROM HOUSE TO SEPTIC TANK MUST BE CAST IRON OR SCHEDULE 35/40 PVC OR ABS

PERMIT VOID AFTER TWO YEARS

NOTE: INSTALL STAND PIPE ON SEPTIC TANK AND DRY WELL STAND PIPES MUST BE 6 INCHES IN DIAMETER CAST IRON. CONCRETE OR TERRA COTTA OR PVA OR ABS ACCEPTED. IF TOP OF SEPTIC TANK IS DEEPER THAN 3 FEET. MANHOLE TO GRADE REQUIRED.

NOTE: DISTRIBUTION BOXES MUST HAVE BAFFLES

***INSTALLER IS RESPONSIBLE FOR OBTAINING FINAL APPROVAL ON THIS PERMIT**

R510224-C

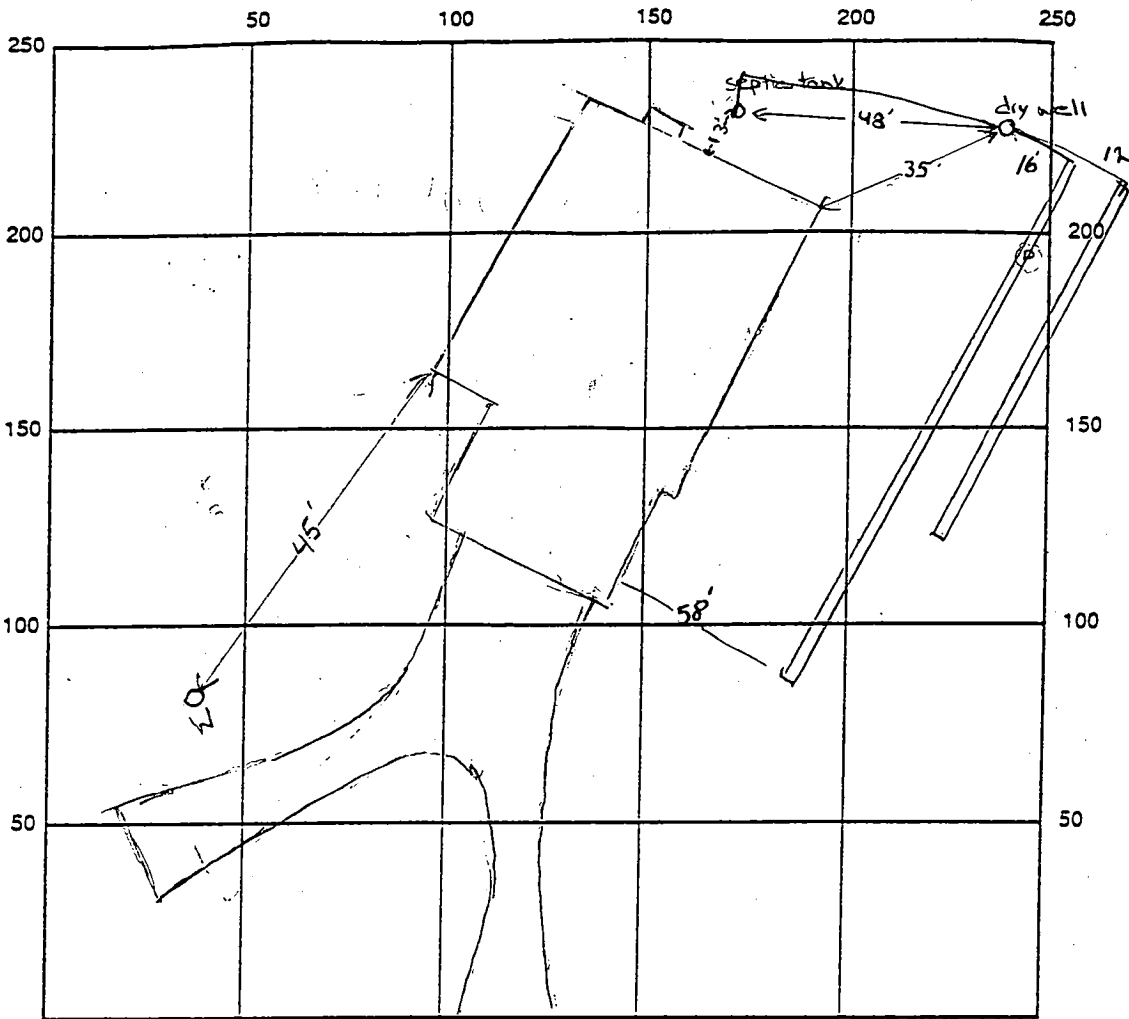

INDICATE NORTH - NAME ADJOINING ROADWAY AS BASE LINE
7392 Minter Ln

SEPTIC TANK LEVEL NA CLEANOUTS NA

DISTRIBUTION BOX LEVEL OK - P6LY Box

DRAIN FIELD/TITLE DEPTH 10 FT. TRENCH WIDTH 2 FT. INLET DEPTH 6 FT.

EFFECTIVE GRAVEL DEPTH 4 FT. TOTAL LENGTH $\frac{1}{2}$ 90/70 FT. = 160

NUMBER OF TRENCHES 2 ONE SIDEWALL/BOTTOM AREA 640 SQ. FT.

DRYWELL INSIDE DIAMETER ✓ FT. EFFECTIVE DEPTH BELOW INLET ✓ FT.

ABSORBENT AREA ✓ SQ. FT.

REMARKS: 6.26.98 FINAL - COVER ALL WORK. JST

DATE SYSTEM APPROVED 6.26.98 INSPECTOR [Signature]