

4/3/98 2:00
4-3-98
2:00
3/24/98 3:00
3/25/98 2:00

PERMIT

SEWAGE DISPOSAL SYSTEM

DEPARTMENT OF HEALTH AND MENTAL HYGIENE

04-309987

P 59871-A

A REPAIR

DISTRICT _____

DATE 3-16-98

HOWARD COUNTY HEALTH DEPARTMENT

BUREAU OF ENVIRONMENTAL HEALTH

~~XXXXXX~~

410-313-2640

INDEXED

DATE SYSTEM APPROVED 6-30-98

INSPECTOR [Signature]

Arnold's Backhoe and Septic IS PERMITTED TO INSTALL ALTER

ADDRESS P.O. Box 15 Woodbine, Maryland 21797 PHONE (410) 795-7873

SUBDIVISION _____ LOT _____ ROAD 16529 Blooms Lane

PROPERTY OWNER _____ Kevin Bloom STACY 301-662-7500 x249 work
16529 Blooms Lane

ADDRESS _____ Mt. Airy, Maryland 21771

SEPTIC TANK CAPACITY _____ GALLONS

NUMBER OF BEDROOMS 2

_____ SQUARE FEET PER BEDROOM

LINEAR FEET OF TRENCH REQUIRED _____

REPAIR - PURPOSE - SEPTIC SYSTEM HAS FAILED.

Call for inspection when ground is opened so sanitarian can recommend repair.
03/02/98

3/11/98 1500 gallon top sealed holding tank recommended
extreme site limitations - steep slope, proximity to stream, greater
than 50% shale in soil

PLANS APPROVED BY Kimberly Maisto DATE 3/11/98

COVER NO WORK UNTIL INSPECTED AND APPROVED

NEITHER THE HOWARD COUNTY COUNCIL NOR THE HEALTH DEPARTMENT IS RESPONSIBLE FOR THE SUCCESSFUL OPERATION OF ANY SYSTEM

NOTE: CLEANOUT REQUIRED EVERY 70 FEET OF SEWER LINE AND/OR AT 90° SWEEPS IN LINES FROM HOUSE TO DRAIN FIELDS, 90° ELBOWS NOT ACCEPTABLE.

NOTE: ALL PARTS OF SEPTIC SYSTEMS (I.E. TANK, DISTRIBUTION BOX TRENCHES) TO BE 100 FEET FROM WELL (UNLESS OTHERWISE SPECIFICALLY AUTHORIZED)

NOTE: IF DEEP TRENCH(ES) ARE USED CALL FOR INSPECTION BEFORE AND AFTER PLACING GRAVEL IN TRENCH(ES)

NOTE: NO DRY WELL SHALL EXCEED 15 FOOT IN DIAMETER NO ABSORPTION TRENCH TO EXCEED 100 FEET IN LENGTH

NOTE: ALL PIPE FROM HOUSE TO SEPTIC TANK MUST BE CAST IRON OR SCHEDULE 35/40 PVC OR ABS

PERMIT VOID AFTER TWO YEARS

NOTE: INSTALL STAND PIPE ON SEPTIC TANK AND DRY WELL STAND PIPES MUST BE 6 INCHES IN DIAMETER CAST IRON, CONCRETE OR TERRA COTTA OR PVA OR ABS ACCEPTED. IF TOP OF SEPTIC TANK IS DEEPER THAN 3 FEET, MANHOLE TO GRADE REQUIRED.

NOTE: DISTRIBUTION BOXES MUST HAVE BAFFLES

***INSTALLER IS RESPONSIBLE FOR OBTAINING FINAL APPROVAL ON THIS PERMIT**

*CALL 461-9933 FOR INSPECTION OF SEPTIC SYSTEM.

P 59871-A

Stacy Bloom
 410-489-4107 (home) (work) 301-662-7500 x249

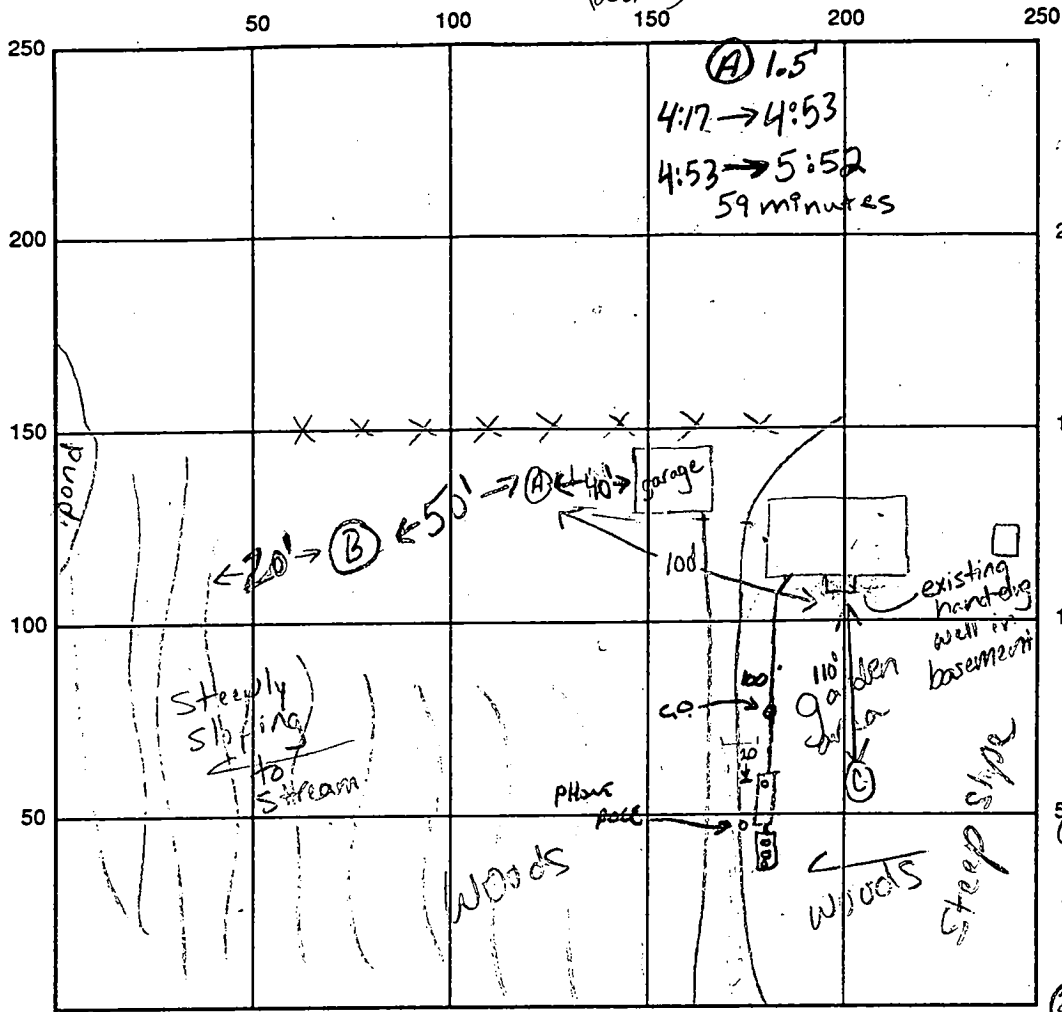

(A)
 or/br yellow clay sand
 fine with gravel
 50% shale at 4.0'
 9.0'

(B)
 same as hole # A
 5.0'

(C)
 brown moist loam sticky
 2.0'
 or/ yellow silty m. 5% small gravel
 30% shale at 4.0'
 greater than 50% shale at 5.0'
 9.0'

(C) 1.5'
 3:3640 → 3:4640
 3:4640 → 4:0640
 20 minutes
 (2) 4:08 → 4:39
 21 minutes
 Not yet to prep

INDICATE NORTH - NAME ADJOINING ROADWAY AS BASE LINE

SEPTIC TANK LEVEL OK 1500 GAL TOP SEAM x2 CLEANOUTS TO BE INSTALLED

DISTRIBUTION BOX LEVEL NA

DRAIN FIELD/TITLE DEPTH _____ FT. TRENCH WIDTH _____ FT. INLET DEPTH _____ FT.

EFFECTIVE GRAVEL DEPTH _____ FT. TOTAL LENGTH _____ FT.

NUMBER OF TRENCHES _____ ONE SIDEWALL/BOTTOM AREA _____ SQ. FT.

DRYWALL INSIDE DIAMETER _____ FT. EFFECTIVE DEPTH BELOW INLET _____ FT.

ABSORBENT AREA _____ SQ. FT.

REMARKS: 3/11/98 site inspection and perc hole dug to evaluate site for repair, best option was found to be holding tanks installed where test holes were dug (RM)

4/3/98 HOLDING TANK INSTALLATION, CLEANOUTS TO BE INSTALLED ON BOTH TANKS

MANHOLE TO BE INSTALLED ON 2ND TANK FOR FUTURE PUMP CHAMBER.

ALARM TO BE INSTALLED 6-30-98 T.C. WIKENNY @ ARNOLD'S SEPTIC,

ALARM INSTALLED, SYSTEM FINISHED. RM

DATE SYSTEM APPROVED 6.30.98 INSPECTOR [Signature]

CONSENT AGREEMENT FOR USE OF HOLDING TANKS
TO CORRECT FAILING SEWAGE SYSTEM

THIS AGREEMENT made this 8th day of April, 1998,
by and between Kevin and Stacie Bloom **HEREINAFTER REFERRED
TO AS Owner**, and the Howard County Bureau of Environmental Health, **HEREINAFTER
REFERRED TO AS the Bureau**.

WHEREAS, Owner is seized and possessed of a tract of land at 16529 Blooms Lane, Mt. Airy, MD 21771, Parcel 47, Block ---, the deed to same being recorded among the land records of Howard County, Maryland in Liber 3452, Folio 454.

WHEREAS, the Howard County Bureau of Environmental Health has advised the Owner of the need to correct ht on-site sewage disposal problems and all parties concerned recognize the only alternative available is a holding tank system.

WHEREAS, Owner's land meets requirements of COMAR 26.04.02 for installation of a holding tank. **NOW THEREFORE**, the parties hereto agree as follows:

- A. The Owner will install a holding tank(s) consistent with the design approved and permitted by the Bureau and follow the relevant provisions of COMAR 26.04.02 in regards to holding tank operation.
- B. Owner agrees to insure reasonable access to the property and system by the Bureau as well as to provide any information requested by the Bureau to assure proper operation and maintenance of the holding tank(s).
- C. Owner agrees that there shall be no liability on the part of the County or Bureau to Owner if the holding tank(s) is not properly maintained.
- D. Owner acknowledges and agrees that neither the Bureau nor any of its agents or employees, either officially or individually underwrites the operation of the holding tank(s) and it is understood that the holding tank(s) is a last resort method to correct existing sewage disposal problems on the property.
- E. The Owner will devote such care and effort to the maintenance of the holding tank(s) so that it shall not malfunction and cause pollution at the ground surface, the waters of the state, or create a nuisance.
- F. The Owner agrees that he shall not alter or tamper with the holding tank(s) in any way that would cause it to malfunction or change it from it's extended purpose of sewage storage with the sewage disposal being accomplished by a scavenger.

20,00
2,100

(Kevin Bloom
16529 Blooms La.
Mt. Airy, MD.
21771)

- G. The Owner agrees that, should the holding tank(s) be determined to pose a threat to the public health, safety or comfort, the Bureau may order any necessary changes or corrections for which the Owner agrees to pay. System modification may include requirements for additional tanks and/or more frequent pumping of the holding tank(s).
- H. The Owner understands that if violations occur from failure to maintain the holding tank(s) properly, the Bureau may take legal action to insure compliance.
- I. The Owner shall contact the Howard County Bureau of Environmental Health at least 24 hours prior to system completion so that the Bureau may inspect the system in the field with the installer. The Owner further agrees that this system will be installed according to the plans and specifications approved by the Bureau and any changes determined to be necessary by the Bureau as a result of reviewing the field conditions.
- J. This agreement shall run with the land and binds the Owner, his heirs, successors or assigns to the provision of the agreement as long as the property is in existence. Owner further agrees that he/she shall inform any purchaser or lessee of the property of the holding tank(s) and all conditions in association with it.
- K. Owner agrees to record this agreement in the land records of Howard County and assure that it becomes part of the Deed for the subject property in order that prospective buyers may be made aware of the special conditions affecting this property. This agreement shall not be construed to limit any authority of the Bureau to protect the public health, safety or comfort or to issue any other orders or take any other action which is now or may hereinafter be within its authority.
- L. The Owner further agrees to contact a licensed scavenger when necessary to have the holding tank(s) pumped.
- M. If the Owner installs any new plumbing, he/she shall install only water conserving fixtures (e.g. toilets installed will use no more than 1.6 gallons of water per flush).
- N. The Owner shall not perform any renovations or remodeling which enlarges the retail area to result in any change of use which could lead to a potential increase in wastewater discharge.
- O. The approval of a holding tank system provided for in this agreement is only for an interim period until public sewerage facilities become available, at which time the Owner shall connect all buildings to the public facilities and shall properly abandon and back fill the holding tank(s).

208 000 035

P. The Owner shall provide necessary pumping of the tank(s) by a licensed scavenger as evidenced by maintaining a record of pumping receipts.

WITNESS, the hand and seal of the parties hereto.

DATE: 4-8-98

OWNER: Karen L. Bloom

DATE: 4-8-98

OWNER: Jacie R. Bloom

DATE: _____

OWNER: _____

DATE: 4-8-98

Craig Williams per J.S.
Sanitarian, Howard County
Bureau of Environmental Health

DATE: 4-8-98

Frank Sherrer
Director, Howard County
Bureau of Environmental Health

Sworn and Subscribed to before me this 8th Day of April, 1998.

Martie Harner
Martie Harner
Notary Public
My Commission Expires 2/1/01

**PAYMENT OF TAXES
NOT NECESSARY**

Dale Neubert
DIRECTOR OF FINANCE OF HOWARD COUNTY

4/13/98

HP FIDELITY \$ 2.00
RECORDING FEE 20.00
TOTAL \$ 22.00
Rec'd HARB 4/13/98
KCP 1 + 5126
BLK + 3207
09:38 am

3/19/98

16529 BLOOMS LANE

T.C. W/ POTENTIAL BUYER CHRISTOPHER GILLES
800-477-1227 EXT. 1472; HE WAS INQUIRING ABOUT
THE EXISTING CONDITIONS ON SITE (FAILING SEPTIC VIOLATION)
~~AND~~ TESTS DONE (STANDARD PERC FOR REPAIR)
AND REPAIR OPTIONS (FURTHER EVALUATION FOR
I+A, INSTALL HOLDING TANK NOW)

SIMILAR DISCUSSION W/ MARK _____ ON 3/17 W/CW
MARK WAS INQUIRING ABOUT COMPOSTING TOILETS

~~JK~~

3-24-98

meeting with owner's of property and Craig Williams and
myself to discuss feasibility of installing septic system rather
than utilize holding tanks. Decision was made that more test
holes will be dug on 3-25-98, time not yet determined, to evaluate
soil and site conditions for more options.

Kim Maiste

end of Bloomline (Kevin Blom Property)
1/26/98

At-grade bed system

A possible alternative septic system design, to be offered as an optional add-on to a holding tank system

- roughed Soil Surface
- overlaid by 6" deep gravel bed
- 40' Long x 15' wide
- with 1-1/2" distribution pipe (3 lines should be OK, 5' center)
- 2" gravel cover over dist pipes
- geotextile fabric over gravel
- 6'-10" topsoil over fabric
- earth can run at 3:1 slope or
- at least 8'-10' down slope of lower edge of gravel bed.

Applying 3/29/98

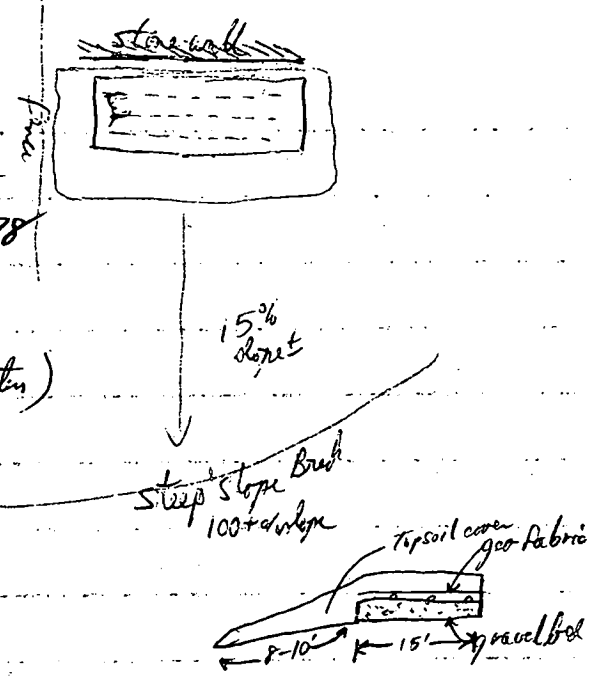

Use Topsoiled Septic tank (2 chambers, 2nd chamber as pump chamber)
 pressure distribution = all 3 pipes level in bed
 5/16" perforations (hole spacing to be determined later)

4:23 min
 4:17 — 4:53 (4:59 min)
 Time: Start (4:47 = 4:53 or 4:59 with) = 36 min
 2nd trench @ = 59 min

4-7-98

TO: FILE 16529 BLOOMS LANE

RE: HOLDING TANK AGREEMENT

DISCUSSED WITH STACY BLOOM ON 4/6 AND 4/7,
SHE IS PREPARING THE AGREEMENT FROM
THE EXAMPLE PROVIDED BY THIS OFFICE (SEE FILE)
SLIGHT LANGUAGE MODIFICATIONS TO FIT THEIR
SITUATION ARE ACCEPTABLE. THE ITEMS
DISCUSSED ARE AS FOLLOWS:

L. OWNER WILL CERTIFY THAT THEY ARE FINANCIALLY
CAPABLE OF ... AND THAT THEY HAVE
MADE ARRANGEMENTS WITH ARNOLD SEATIC
TO HAVE THE INSTALLED (3000 GAL TOTAL) TANKS
PUMPED. THE OWNER INTENDS TO ARRANGE PUMPING
SCHEDULE AS NEEDED, DUE TO LARGE CAPACITY
OF TANKS

P. THE OWNER WILL MAINTAIN RECORDS OF
CONTINUAL PUMPING BY A LICENSED SCUMBER.

ONCE THE AGREEMENT IS READY, THEY WILL
HAVE THEIR SIGNATURES NOTARIZED, & MAKE
ARRANGEMENTS FOR OUR SIGNATURE & RECORD
AGREEMENT WITH THE DEED.

[Signature] OVER →

6.30.98 FILE FOLLOW UP,

TC W/ STACY BLOOM, SHE SAID THAT
A HOLDING TANK AGREEMENT WAS SIGNED BY
HER AND CRAIG WILLIAMS AT THE PROPERTY.

THE AGREEMENT WAS RECORDED WITH THE DEED.
SUBSEQUENTLY THE PROPERTY HAS BEEN SOLD.

HW