

*Read directions where to meet.*

# APPLICATION

A. 14527

P. \_\_\_\_\_

SEWAGE DISPOSAL TESTING

MARYLAND STATE DEPARTMENT OF HEALTH

HOWARD COUNTY 750 Gallon Tank

ELLICOTT CITY

DISTRICT 2

DATE 5/21/69

*Dry Well - 450 sq ft sidewall area below the top 5 FT of Clay with maximum depth of 16 FT below grade. Place the dry well the dry well between 95 FT and 115 FT from the edge of College Ave and between 45 FT and 65 FT from the small stone wall located near the Staff #2 house by Staff #1 House*

*Received 6/3/69 9:30 - Lou Gregor  
4/10/69 7/3/69  
Reached 1/9/69 9:30*

TO: THE COUNTY HEALTH OFFICER **SPECIFICATION FOR EXISTING STAFF #1 TENANT HOUSE ARE ON COMPLAINT SHEET**  
ELLICOTT CITY, MARYLAND

I, HEREBY, APPLY FOR THE NECESSARY TESTS IN ORDER TO CONSTRUCT (OR RECONSTRUCT) A SEWAGE DISPOSAL SYSTEM.

PROPERTY OWNER Taylor Manor Hospital

ADDRESS College Avenue, Ellicott City, Md. PHONE \_\_\_\_\_

PROPERTY LOCATION:

SUBDIVISION \_\_\_\_\_ LOT NO. \_\_\_\_\_

ROAD AND DESCRIPTION College Avenue

OCCUPANT \_\_\_\_\_ PHONE \_\_\_\_\_

PERSON TO CONSTRUCT SYSTEM \_\_\_\_\_

ADDRESS \_\_\_\_\_ PHONE \_\_\_\_\_

SIZE OF LOT 57.895 acres TYPE BLDG. 3

NUMBER OF BEDROOMS  
(Single Fmly. Dwllg.)

IF NOT SINGLE RESIDENCE DESCRIBE \_\_\_\_\_

SIGNATURE OF APPLICANT /s/ Charles M. Johnson, Associated Home Builders, Inc.

APPROVED BY Raymond Hodges FOR Dry Well DATE 7/9/69  
(KIND OF SYSTEM)

REJECTED BY \_\_\_\_\_ FOR \_\_\_\_\_ DATE \_\_\_\_\_  
(KIND OF SYSTEM)

HOLD PENDING FURTHER TESTS RH B/H DATE 4 June 69 5 June 69

REASONS FOR REJECTION OR HOLDING 4 June 69 - Little pipe 5 June 69 B/H  
Hold for 10 days - 8 June 69 - Wind decided  
further tests needed 8 June 69 Told Fisher to do hole today

# THIS IS NOT A PERMIT

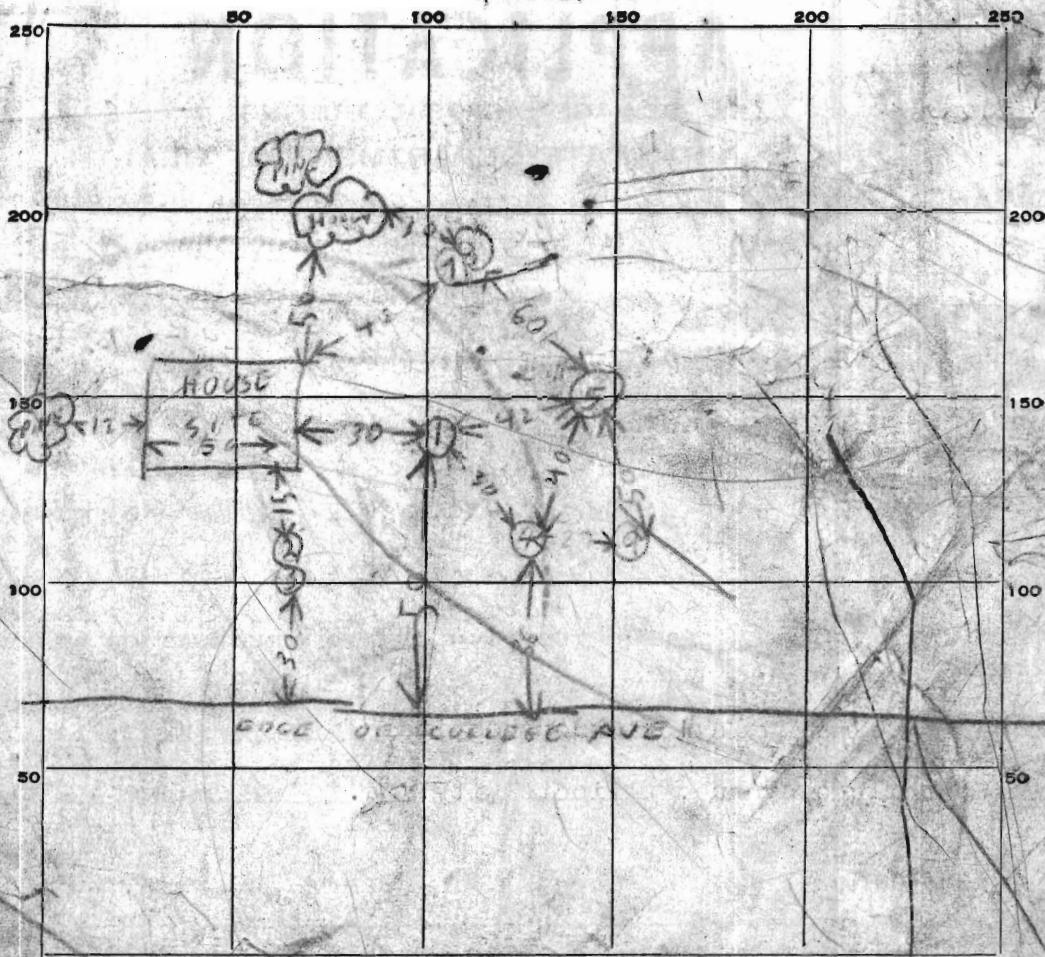

DATE	TEST NO.	DEPTH	PRE-WET		TEST - 1" DROP		TIME
			START	STOP	START	STOP	
4/16	1	4 1/2	NOT AT	TEST 4 1/2 FT	170	SOLID ROCK	
	2	9	1107	207		1 inch 4 min	
	3	3 1/2	1108	207		1 inch 6 min	
	4	9	1134	208		little per	
4/17	5	9	2533	32		little per	
	6		254	335		1 inch 4 min	
	7	9 1/2	3082	44		little per	
	8	4 1/2	333				
	9	10	NOT 1 FT	ROCK		NOT TESTED	

SOIL AUGER FINDING \_\_\_\_\_

TESTED BY R. Hodges

REMARK 89 = TREE

# APPLICATION

A 14527

SEWAGE DISPOSAL TESTING

P \_\_\_\_\_

MARYLAND STATE DEPARTMENT OF HEALTH

HOWARD COUNTY

ELLICOTT CITY

DISTRICT 2

DATE 5/21/69

TO: THE COUNTY HEALTH OFFICER  
ELLICOTT CITY, MARYLAND

I, HEREBY, APPLY FOR THE NECESSARY TESTS IN ORDER TO CONSTRUCT (OR RECONSTRUCT) A SEWAGE DISPOSAL SYSTEM.

PROPERTY OWNER Taylor Manor Hospital

ADDRESS College Avenue, Ellicott City, Md. PHONE \_\_\_\_\_

PROPERTY LOCATION: \_\_\_\_\_

SUBDIVISION \_\_\_\_\_ LOT NO. \_\_\_\_\_

ROAD AND DESCRIPTION College Avenue

OCCUPANT \_\_\_\_\_ PHONE \_\_\_\_\_

PERSON TO CONSTRUCT SYSTEM \_\_\_\_\_

ADDRESS \_\_\_\_\_ PHONE \_\_\_\_\_

SIZE OF LOT 57.895 acres TYPE BLDG \_\_\_\_\_

NUMBER OF BEDROOMS

3  
(Single Fmly. Dwllg.)

IF NOT SINGLE RESIDENCE DESCRIBE \_\_\_\_\_

SIGNATURE OF APPLICANT /s/ Charles M. Johnson, Associated Home Builders, Inc.

APPROVED BY \_\_\_\_\_ FOR \_\_\_\_\_ DATE \_\_\_\_\_

(KIND OF SYSTEM)

REJECTED BY \_\_\_\_\_ FOR \_\_\_\_\_ DATE \_\_\_\_\_

(KIND OF SYSTEM)

HOLD PENDING FURTHER TESTS NA DATE 4 June 69

REASONS FOR REJECTION OR HOLDING 4 June 69 Littlejohn

# THIS IS NOT A PERMIT

130  
520  
80

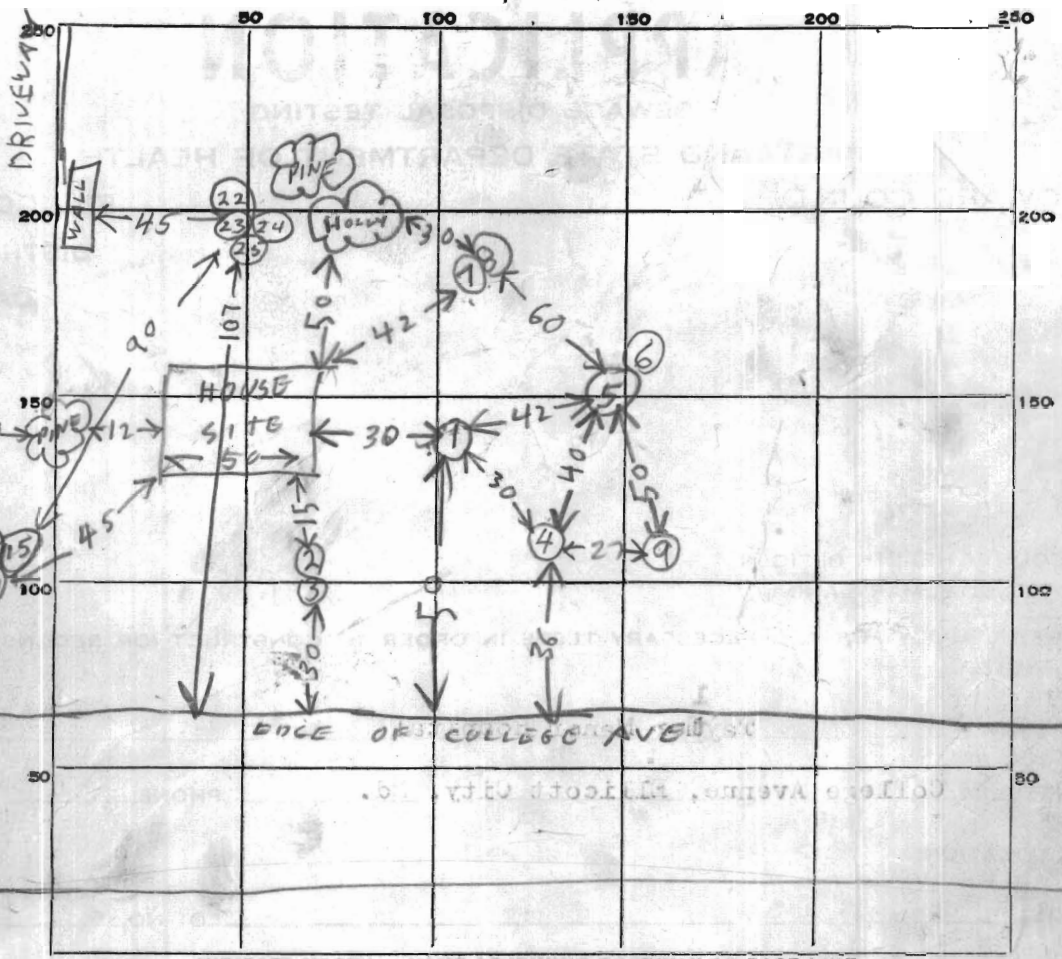

INDICATE NORTH. - NAME ADJOINING ROADWAY AS BASE LINE.

DATE	TEST NO.	DEPTH	PRE-WET		TEST - 1" DROP		TIME
			START	STOP	START	STOP	
6/4/69	1	4 1/2	NOT AT	TESTED 4 1/2 FT	SOLID ROCK		
	2	9	1107	1207	1st inch 60 min		
	3	3 1/2	1108	1207	1st inch 61 min		
	4	8 1/2	1134	1208	little pine		
6/4/69	5	9	253	332	little pine		
	6	5	254	335	1st inch 41 min		
	7	9 1/2	308	344	little pine		
	8	4 1/2	332	402	little pine		
	9	10	TOP 9 FT CLAY BOT 1 FT ROCK		NOT TESTED		

SOIL AUGER FINDING

TESTED BY

B. Hodges

REMARKS

89 = TREE

8.1.1 Man

PROPERTY OWNER TAYLOR MANOR HOSPITAL  
COLLEGE AVE ELLICOTT CITY  
3 BEDROOM

ar 950

14

6/5/69	10	9 1/2	1024	1033	1053	20
6/5/69	11	5	1035	1100	little piece	
6/5/69	12	17 1/2	1112	1205	1st inch	53 min
6/5/69	13	10 1/2	1158	1240	little piece	
6/5/69	14	5 1/2	1215	1240	little piece	
6/5/69	15	12 1/2	243	300	320	20
6/5/69	16	5 1/2	321	404		} TOP 7' CLAY ISH
6/5/69	17	10 1/2	322	330?	350	
6/5/69	18	9 1/2	357	430	little piece	about 3/4 - 7/8 in 33 min
6/5/69	19	5	406	430	little piece	3/4 - 7/8 in 24 min

see attached plat for location of Holes #  
①⑥ ①⑦ ①⑧ ①⑨

60  
9  
20  
0  
4  
6/3

---

60  
9  
7

# APPLICATION

SEWAGE DISPOSAL TESTING

MARYLAND STATE DEPARTMENT OF HEALTH

HOWARD COUNTY

ELLICOTT CITY

DISTRICT \_\_\_\_\_

DATE \_\_\_\_\_

*Page 2*

TO: THE COUNTY HEALTH OFFICER  
ELLICOTT CITY, MARYLAND

I, HEREBY, APPLY FOR THE NECESSARY TESTS IN ORDER TO CONSTRUCT (OR RECONSTRUCT) A SEWAGE DISPOSAL SYSTEM.

PROPERTY OWNER Taylor Manor Hospital College Ave EC  
ADDRESS \_\_\_\_\_ PHONE \_\_\_\_\_

PROPERTY LOCATION:

SUBDIVISION \_\_\_\_\_ LOT NO. \_\_\_\_\_

ROAD AND DESCRIPTION College Ave

OCCUPANT \_\_\_\_\_ PHONE \_\_\_\_\_

PERSON TO CONSTRUCT SYSTEM \_\_\_\_\_

ADDRESS \_\_\_\_\_ PHONE \_\_\_\_\_

SIZE OF LOT 57.095 acres TYPE BLDG. \_\_\_\_\_ NUMBER OF BED ROOMS \_\_\_\_\_

IF NOT SINGLE RESIDENCE DESCRIBE \_\_\_\_\_

SIGNATURE OF APPLICANT \_\_\_\_\_

APPROVED BY \_\_\_\_\_ FOR \_\_\_\_\_ (KIND OF SYSTEM) DATE \_\_\_\_\_

REJECTED BY \_\_\_\_\_ FOR \_\_\_\_\_ (KIND OF SYSTEM) DATE \_\_\_\_\_

HOLD PENDING FURTHER TESTS \_\_\_\_\_ DATE \_\_\_\_\_

REASONS FOR REJECTION OR HOLDING \_\_\_\_\_

# THIS IS NOT A PERMIT

20  
30  
37  
107

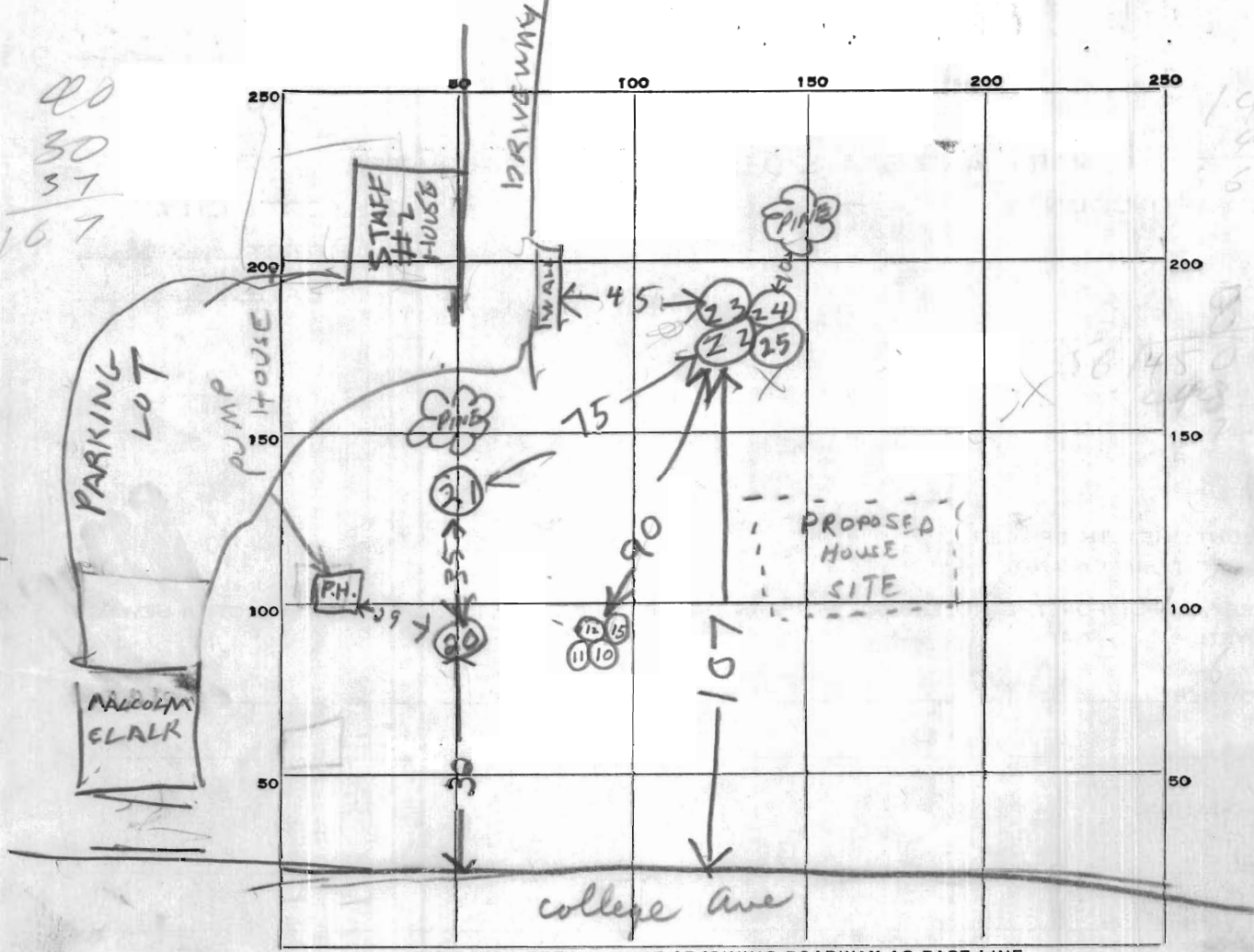

INDICATE NORTH. - NAME ADJOINING ROADWAY AS BASE LINE.

DATE	TEST NO.	DEPTH	PRE-WET		TEST - 1" DROP		TIME	
			START	STOP	START	STOP		
7/3/69	20	2 1/2 ft.	Hitting Rock - Broke Back - hole					
SAME PLACE AS 20	7/9/69	20A	NOT TESTED SHELF CLAY ROCK					
	7/9/69	21	1157	1220	Well per			
		22	217	228	228	239	11	
		23	220	300	stuck 40 min			
		24	307	322	322	347	25	
		25	SAME PLACE AS 22 23 24					
			TOP 5 FT NON POROUS NOT TEST POROUS					

37  
11  
148  
29  
40  
25  
75  
37

SOIL AUGER FINDING \_\_\_\_\_  
 TESTED BY \_\_\_\_\_  
 REMARKS \_\_\_\_\_