

6/24/97
1.00 C.O.

PERMIT

SEWAGE DISPOSAL SYSTEM

DEPARTMENT OF HEALTH AND MENTAL HYGIENE

P 58535-A

A REPAIR

HOWARD COUNTY HEALTH DEPARTMENT
BUREAU OF ENVIRONMENTAL HEALTH
461-9933

#339355

INDEXED

DISTRICT _____

DATE 6/23/97

DATE SYSTEM APPROVED 6/24/97

INSPECTOR *[Signature]*

Jack Fyock Septic Service _____ IS PERMITTED TO INSTALL _____ ALTER

ADDRESS 13775 Triadelphia Road, Glenelg, MD 21737 _____ PHONE 988-9270

SUBDIVISION _____ LOT _____ ROAD 3327 Hipsley Mill Road

PROPERTY OWNER Robert & Lynda Jefferson

ADDRESS _____

SEPTIC TANK CAPACITY NA GALLONS

NUMBER OF BEDROOMS 3

125 SQUARE FEET PER BEDROOM

LINEAR FEET OF TRENCH REQUIRED 63

REPAIR - PURPOSE - SEPTIC SYSTEM HAS FAILED.

Call for inspection when ground is opened so sanitarian can recommend repair.

INLET 3' BOTTOM 9'

6 STONE BELOW DIST PIPE

PLANS APPROVED BY _____ DATE _____

COVER NO WORK UNTIL INSPECTED AND APPROVED

NEITHER THE HOWARD COUNTY COUNCIL NOR THE HEALTH DEPARTMENT IS RESPONSIBLE FOR THE SUCCESSFUL OPERATION OF ANY SYSTEM

NOTE: CLEANOUT REQUIRED EVERY 70 FEET OF SEWER LINE AND/OR AT 90° SWEEPS IN LINES FROM HOUSE TO DRAIN FIELDS, 90° ELBOWS NOT ACCEPTABLE.

NOTE: ALL PARTS OF SEPTIC SYSTEMS (I.E. TANK, DISTRIBUTION BOX TRENCHES) TO BE 100 FEET FROM WELL (UNLESS OTHERWISE SPECIFICALLY AUTHORIZED)

NOTE: IF DEEP TRENCH(ES) ARE USED CALL FOR INSPECTION BEFORE AND AFTER PLACING GRAVEL IN TRENCH(ES)

NOTE: NO DRY WELL SHALL EXCEED 15 FOOT IN DIAMETER NO ABSORPTION TRENCH TO EXCEED 100 FEET IN LENGTH

NOTE: ALL PIPE FROM HOUSE TO SEPTIC TANK MUST BE CAST IRON OR SCHEDULE 35/40 PVC OR ABS

PERMIT VOID AFTER TWO YEARS

NOTE: INSTALL STAND PIPE ON SEPTIC TANK AND DRY WELL STAND PIPES MUST BE 6 INCHES IN DIAMETER CAST IRON, CONCRETE OR TERRA COTTA OR PVA OR ABS ACCEPTED. IF TOP OF SEPTIC TANK IS DEEPER THAN 3 FEET. MANHOLE TO GRADE REQUIRED.

NOTE: DISTRIBUTION BOXES MUST HAVE BAFFLES

***INSTALLER IS RESPONSIBLE FOR OBTAINING FINAL APPROVAL ON THIS PERMIT**

P 58535-A

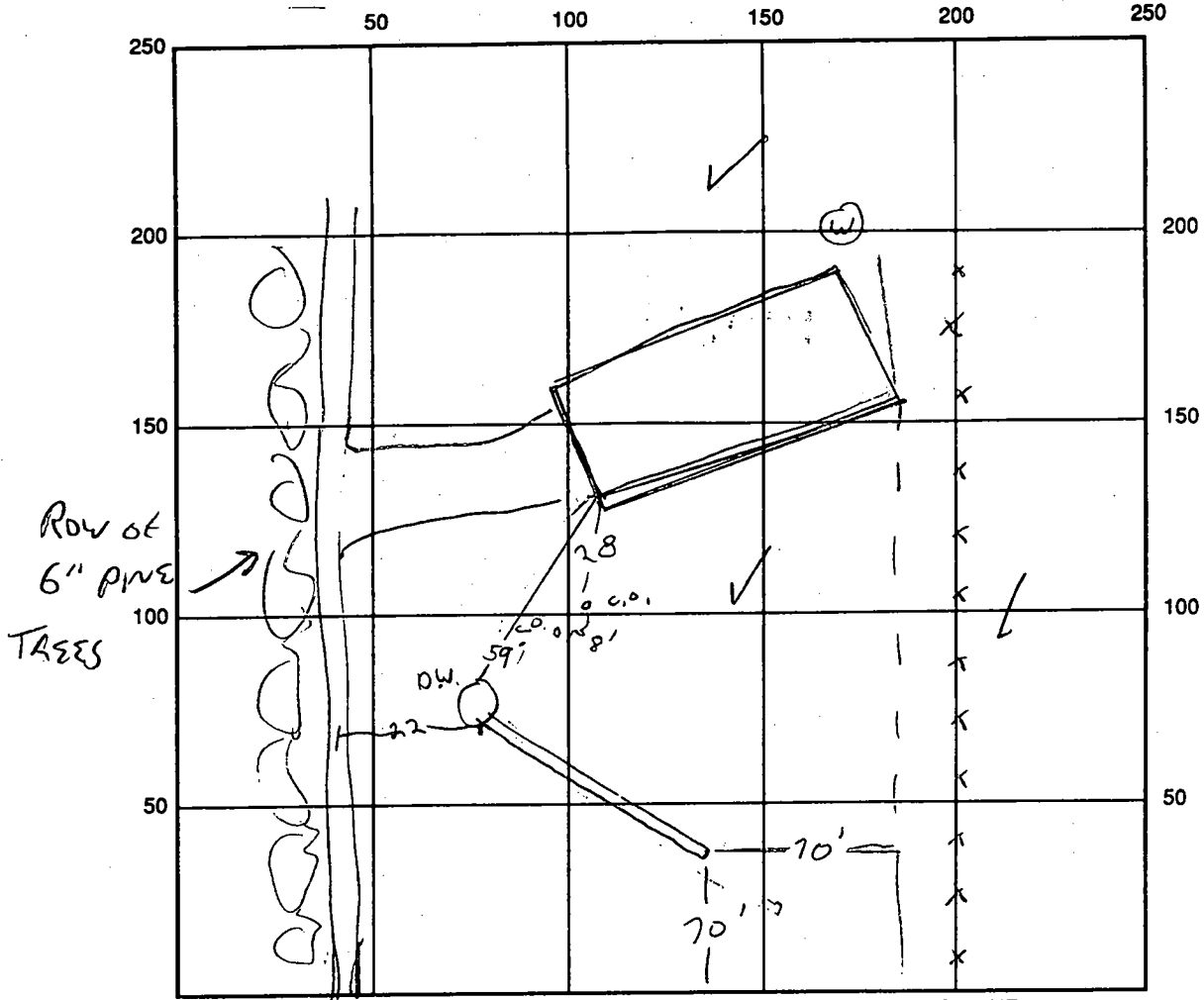

INDICATE NORTH - NAME ADJOINING ROADWAY AS BASE LINE
 HIPSEY RD ROAD

SEPTIC TANK LEVEL NA CLEANOUTS OK
 DISTRIBUTION BOX LEVEL NA
 DRAIN FIELD/TITLE DEPTH 9 FT. TRENCH WIDTH 2 FT. INLET DEPTH 3 FT.
 EFFECTIVE GRAVEL DEPTH 6 FT. TOTAL LENGTH 66 FT.
 NUMBER OF TRENCHES 1 ONE SIDEWALL/BOTTOM AREA 396 SQ. FT.
 DRYWALL INSIDE DIAMETER — FT. EFFECTIVE DEPTH BELOW INLET — FT.
 ABSORBENT AREA — SQ. FT.

REMARKS: 6/24/97 ok to complete, ok to cover, &

DATE SYSTEM APPROVED 6/24/97 INSPECTOR [Signature]