

5/15/97
tank replacement
12:30pm
5/16/97 2:00
~~CANCELLED~~

PERMIT # 295427

P-58464

SEWAGE DISPOSAL SYSTEM

DEPARTMENT OF HEALTH AND MENTAL HYGIENE

A Repair

DISTRICT 3rd

DATE 3-19-97

\$2500 PAID 5-16-97
CHECK # 3021

HOWARD COUNTY HEALTH DEPARTMENT
BUREAU OF ENVIRONMENTAL HEALTH
461-9933

DATE SYSTEM APPROVED

INSPECTOR

INDEXED

Fogle's Septic Clean, Inc. IS PERMITTED TO INSTALL ALTER

ADDRESS 558 Obrecht Road Sykesville, Maryland 21784 PHONE 795-5674

SUBDIVISION LOT ROAD 3020 Pfefferkorn Road Glenelg, MD

PROPERTY OWNER Bernard Schulze

ADDRESS

SEPTIC TANK CAPACITY 1500 GALLONS TOP SEAM

NUMBER OF BEDROOMS

SQUARE FEET PER BEDROOM

LINEAR FEET OF TRENCH REQUIRED

REPLACE FAILING STEEL SEPTIC TANK

PLANS APPROVED BY DATE

COVER NO WORK UNTIL INSPECTED AND APPROVED

NEITHER THE HOWARD COUNTY COUNCIL NOR THE HEALTH DEPARTMENT IS RESPONSIBLE FOR THE SUCCESSFUL OPERATION OF ANY SYSTEM

NOTE: CLEANOUT REQUIRED EVERY 70 FEET OF SEWER LINE AND/OR AT 90° SWEEPS IN LINES FROM HOUSE TO DRAIN FIELDS, 90° ELBOWS NOT ACCEPTABLE.

NOTE: ALL PARTS OF SEPTIC SYSTEMS (I.E. TANK, DISTRIBUTION BOX TRENCHES) TO BE 100 FEET FROM WELL (UNLESS OTHERWISE SPECIFICALLY AUTHORIZED)

NOTE: IF DEEP TRENCH(ES) ARE USED CALL FOR INSPECTION BEFORE AND AFTER PLACING GRAVEL IN TRENCH(ES)

NOTE: NO DRY WELL SHALL EXCEED 15 FOOT IN DIAMETER NO ABSORPTION TRENCH TO EXCEED 100 FEET IN LENGTH

NOTE: ALL PIPE FROM HOUSE TO SEPTIC TANK MUST BE CAST IRON OR SCHEDULE 35/40 PVC OR ABS

PERMIT VOID AFTER TWO YEARS

NOTE: INSTALL STAND PIPE ON SEPTIC TANK AND DRY WELL STAND PIPES MUST BE 6 INCHES IN DIAMETER CAST IRON. CONCRETE OR TERRA COTTA OR PVA OR ABS ACCEPTED. IF TOP OF SEPTIC TANK IS DEEPER THAN 3 FEET. MANHOLE TO GRADE REQUIRED.

NOTE: DISTRIBUTION BOXES MUST HAVE BAFFLES

***INSTALLER IS RESPONSIBLE FOR OBTAINING FINAL APPROVAL ON THIS PERMIT**

P 58464

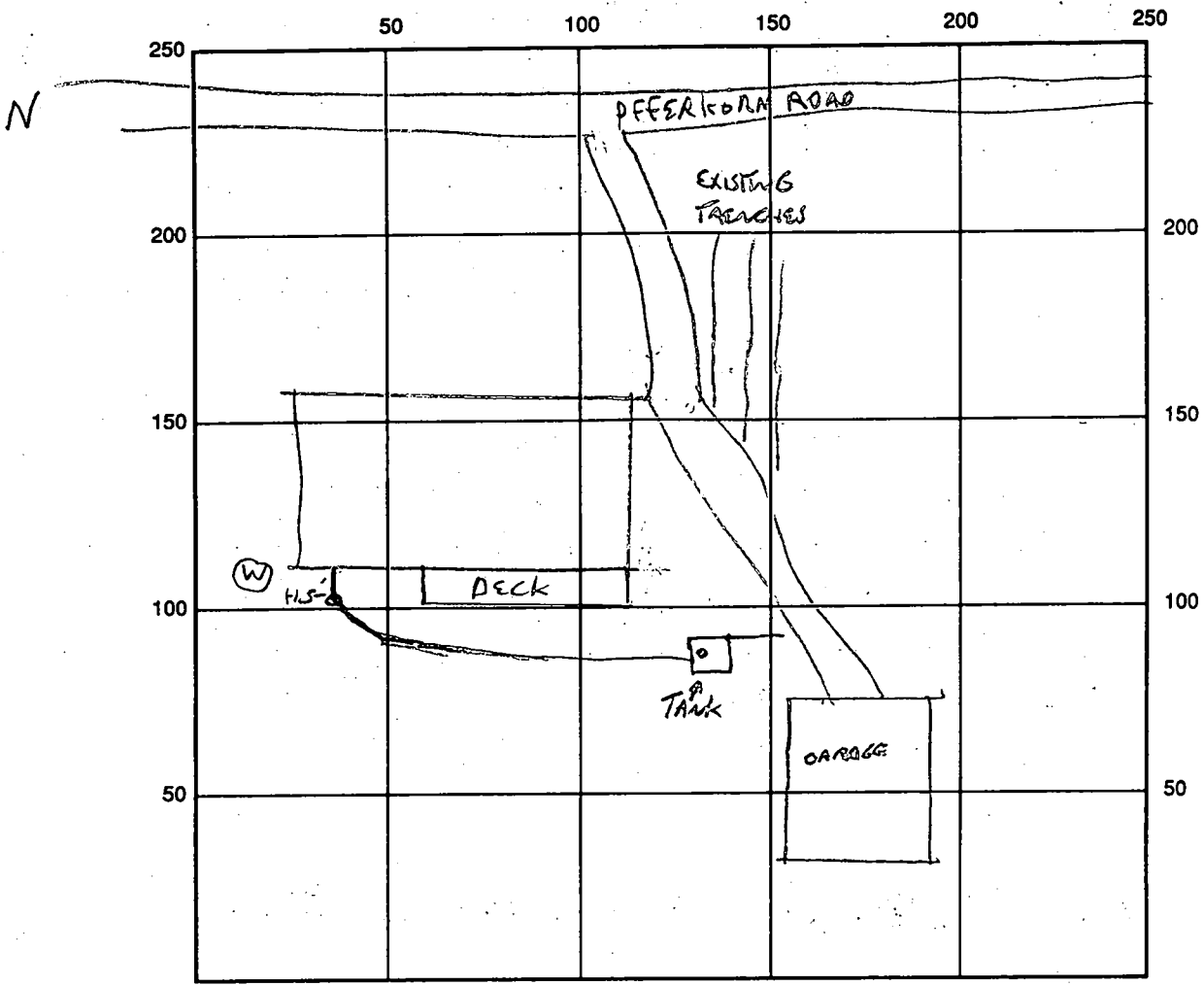

SEPTIC TANK LEVEL TOP SCAM 1500 GAL CLEANOUTS _____

DISTRIBUTION BOX LEVEL _____

DRAIN FIELD/TITLE DEPTH _____ FT. TRENCH WIDTH _____ FT. INLET DEPTH _____ FT.

EFFECTIVE GRAVEL DEPTH _____ FT. TOTAL LENGTH _____ FT.

NUMBER OF TRENCHES _____ ONE SIDEWALL/BOTTOM AREA _____ SQ. FT.

DRYWALL INSIDE DIAMETER _____ FT. EFFECTIVE DEPTH BELOW INLET _____ FT.

ABSORBENT AREA _____ SQ. FT.

REMARKS: 5-16-97 TANK REPLACEMENT, EXISTING TANK PERMANENT, DISCHARGE
LINE CAST IRON, SET W/ STONE FILLED TRENCH 1.5'-3.5' DEEP BACK FROM
TRENCH FILLED TANK HOLE 1/2, SYSTEM MAY BE FAILING, LATE INSP,
TANK + INLET LINE 01-75 COVER. CONTRACTOR WILL CALL W/NOVA W/ DETAILS
DIST BOX TO BE SET + CONNECTED SAT.
12/10/99 No inspection done - file indexed but syst. not approved

DATE SYSTEM APPROVED _____ INSPECTOR _____

PERMIT

fibok 11-20-75 HV
P. 22490

SEWAGE DISPOSAL SYSTEM

A _____

11/20/75 *Randy*

HOWARD COUNTY

MARYLAND STATE DEPARTMENT OF HEALTH

INDEXED

Ok to Release building permit HV 11-20-75

ELLICOTT CITY

DISTRICT 4

DATE 11/17/75

Herman Sirk

IS PERMITTED TO INSTALL ALTER X

ADDRESS Jennings Chapel Road, Woodbine, Md.

PHONE 489-4724

A SEWAGE DISPOSAL SYSTEM LOCATED AT _____

SUBDIVISION _____

ROAD 3020 Pfefferkorn Road LOT _____
Glenely, Md.

PROPERTY OWNER Bernard W. Schulze

ADDRESS _____

SPECIFICATIONS

DRAIN FIELD _____ DEPTH _____ FEET. BOTTOM AREA _____ SQ. FT.

SEEPAGE PITS _____ ABSORBENT SIDE WALL AREA _____ SQ. FT.

SEPTIC TANK CAPACITY _____ GALLONS

TOP GARAGE GRINDER INCREASE DISPOSAL AREA 25% & TANK CAPACITY 50%

OTHER REPAIR - Trench - 35 ft. long - 4 ft. wide with 4 ft. of gravel - 6 ft. deep.

Put Y in line instead of distribution box.

PLANS APPROVED BY T&E

DATE 11/17/75

FILL SEPTIC TANK AND DISTRIBUTION BOX WITH WATER BEFORE CALLING FOR AN INSPECTION. COVER AND REPAIR UNTIL INSPECTED AND APPROVED.

NEITHER THE HOWARD COUNTY COMMISSIONERS NOR THE HEALTH DEPARTMENT IS RESPONSIBLE FOR THE SUCCESSFUL OPERATION OF ANY SYSTEM.

P2490

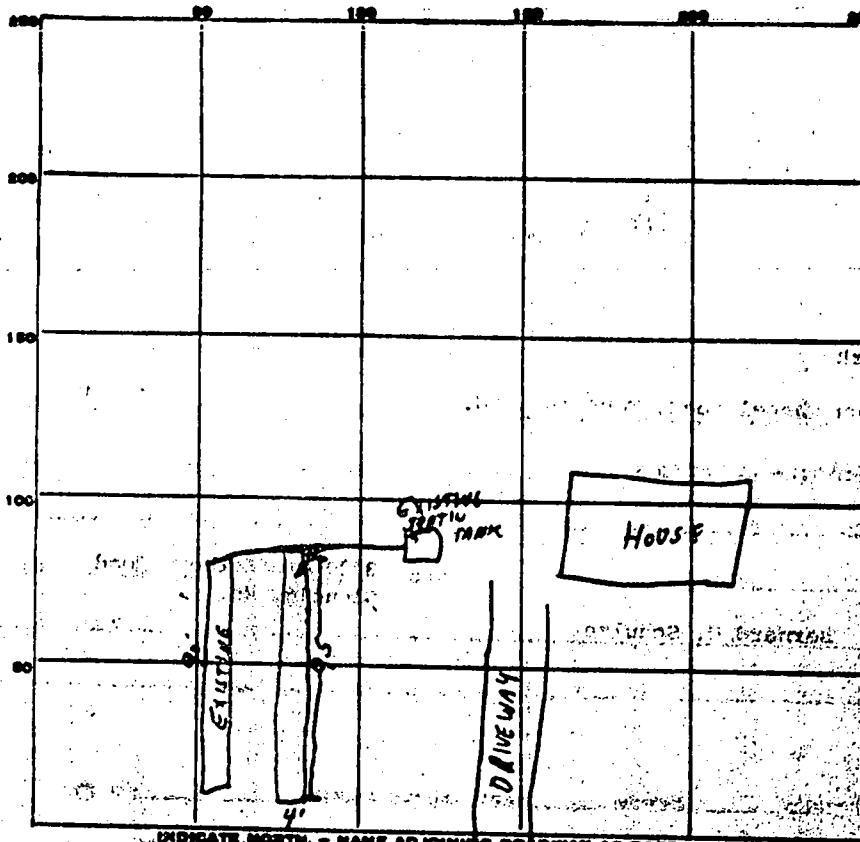

INDICATE NORTH - NAME ADJOINING ROADWAY AS BASE LINE
 PAPER NO. 4010

295
 4
 370

PERMIT CARD OK

SEPTIC TANK, LEVEL EXISTING CLEANOUTS N/A

DISTRIBUTION BOX, LEVEL N/A 4" PIPE

TILE FIELD, DEPTH 4' FT. TRENCH WIDTH 4' FT.

GRAVEL DEPTH 2 FT TOTAL LENGTH 95 FT.

NUMBER OF TRENCHES 1 TOTAL BOTTOM AREA 380

SEEPAGE PITS, INSIDE DIAMETER N/A FT. DEPTH BELOW INLET N/A FT.

ABSORBENT AREA 380 SQ. FT.

REMARKS OK TO CON - 11/20/75

DATE SYSTEM APPROVED 11-20-75 INSPECTOR M. J. Gas