

4/29/97
10:00 C.O.

PERMIT

SEWAGE DISPOSAL SYSTEM

DEPARTMENT OF HEALTH AND MENTAL HYGIENE

03-291596

P 58113-N

A REPAIR

HOWARD COUNTY HEALTH DEPARTMENT
BUREAU OF ENVIRONMENTAL HEALTH

~~XX 461-9933~~ 313-2640

INDEXED

DISTRICT 3RD

DATE 4/28/97

DATE SYSTEM APPROVED 4/29/97

INSPECTOR M. Ripkin

Jack Fyock Septic Service _____ IS PERMITTED TO INSTALL _____ ALTER X

ADDRESS 13775 Triadelphia Road, Glenelg, Maryland 21737 PHONE 988-9270

SUBDIVISION Evergreen Valley Estates LOT 34, Section 6 ROAD 3207 Evergreen Way

PROPERTY OWNER _____ Sutter

ADDRESS _____

SEPTIC TANK CAPACITY EX. 1000 GALLONS

NUMBER OF BEDROOMS 3

125 SQUARE FEET PER BEDROOM

LINEAR FEET OF TRENCH REQUIRED 70

REPAIR - PURPOSE - SEPTIC SYSTEM HAS FAILED.
Call for inspection when ground is opened so sanitarian can recommend repair.
04/17/97

ENV 2 1/2 BAT 8', 55' STONE

PLANS APPROVED BY _____ DATE _____

COVER NO WORK UNTIL INSPECTED AND APPROVED

NEITHER THE HOWARD COUNTY COUNCIL NOR THE HEALTH DEPARTMENT IS RESPONSIBLE FOR THE SUCCESSFUL OPERATION OF ANY SYSTEM

NOTE: CLEANOUT REQUIRED EVERY 70 FEET OF SEWER LINE AND/OR AT 90° SWEEPS IN LINES FROM HOUSE TO DRAIN FIELDS, 90° ELBOWS NOT ACCEPTABLE.

NOTE: ALL PARTS OF SEPTIC SYSTEMS (I.E. TANK, DISTRIBUTION BOX TRENCHES) TO BE 100 FEET FROM WELL (UNLESS OTHERWISE SPECIFICALLY AUTHORIZED)

NOTE: IF DEEP TRENCH(ES) ARE USED CALL FOR INSPECTION BEFORE AND AFTER PLACING GRAVEL IN TRENCH(ES)

NOTE: NO DRY WELL SHALL EXCEED 15 FOOT IN DIAMETER NO ABSORPTION TRENCH TO EXCEED 100 FEET IN LENGTH

NOTE: ALL PIPE FROM HOUSE TO SEPTIC TANK MUST BE CAST IRON OR SCHEDULE 35/40 PVC OR ABS

PERMIT VOID AFTER TWO YEARS

NOTE: INSTALL STAND PIPE ON SEPTIC TANK AND DRY WELL STAND PIPES MUST BE 6 INCHES IN DIAMETER CAST IRON. CONCRETE OR TERRA COTTA OR PVA OR ABS ACCEPTED. IF TOP OF SEPTIC TANK IS DEEPER THAN 3 FEET. MANHOLE TO GRADE REQUIRED.

NOTE: DISTRIBUTION BOXES MUST HAVE BAFFLES

***INSTALLER IS RESPONSIBLE FOR OBTAINING FINAL APPROVAL ON THIS PERMIT**

P 58113-N

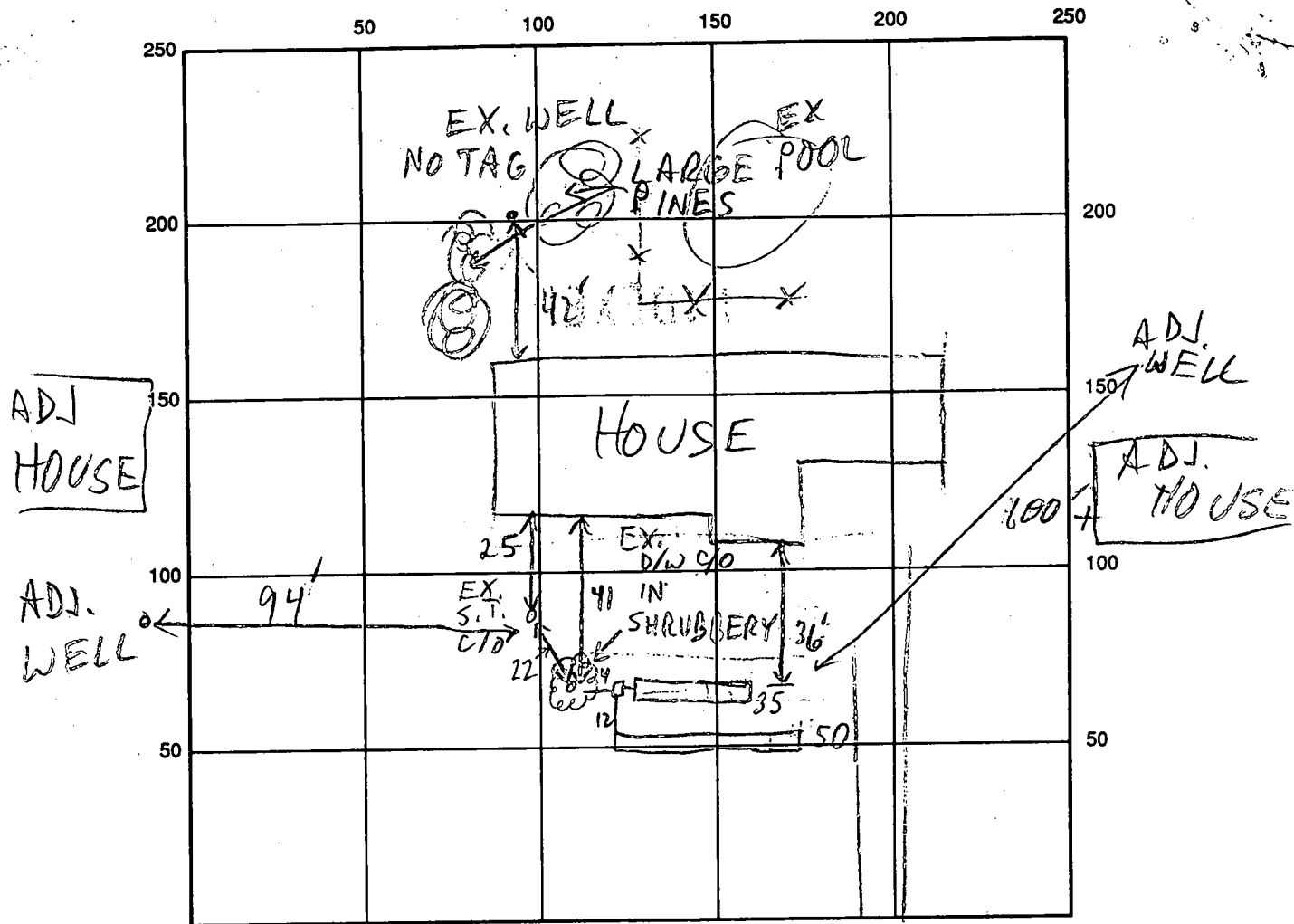

EVERGREEN WAY INDICATE NORTH - NAME ADJOINING ROADWAY AS BASE LINE

SEPTIC TANK LEVEL EX 1000 GAL - OK CLEANOUTS EX - OK

DISTRIBUTION BOX LEVEL OK - BAFFLE IN

DRAIN FIELD/TITLE DEPTH $\frac{112}{818}$ FT. TRENCH WIDTH 2 FT. INLET DEPTH $\frac{112}{25/2.5}$ FT.

EFFECTIVE GRAVEL DEPTH $\frac{112}{5.5/5.5}$ FT. TOTAL LENGTH $\frac{112}{\textcircled{1}35 \textcircled{2}50}$ FT.

NUMBER OF TRENCHES 2 ONE SIDEWALL BOTTOM AREA $\frac{112}{\textcircled{1}96 \pm \textcircled{2}275}$ SQ. FT.

DRYWALL INSIDE DIAMETER FT. EFFECTIVE DEPTH BELOW INLET FT.

ABSORBENT AREA 465 SQ. FT.

REMARKS: 4/29/97 OK TO FINISH + COVER MR

DATE SYSTEM APPROVED 4/29/97 INSPECTOR M. Ritkin

PERMIT

SEWAGE DISPOSAL SYSTEM

MARYLAND STATE DEPARTMENT OF HEALTH

HOWARD COUNTY

INDEXED

ELLICOTT CITY

DISTRICT ⁰⁰ 3

DATE 6/12/70

7/12/70
Serial # 17143
R. Tank 10257

Paterson Jones *File*

IS PERMITTED TO INSTALL ALTER

ADDRESS 3210 SYDENHAM WAY, ELLICOTT CITY, MD. PHONE 286-2610 or 286-2644

A SEWAGE DISPOSAL SYSTEM LOCATED AT _____

SUBDIVISION FRANKFORD VALLEY ESTATES ROAD 3217 SYDENHAM WAY LOT 21, SEC. 6

PROPERTY OWNER FRANKFORD ESTATES *George H. Sater*

ADDRESS _____

SPECIFICATIONS - 3 bedrooms

DRAIN FIELD _____ DEPTH _____ FEET. BOTTOM AREA _____ SQ. FT.

SEEPAGE PITS _____ ABSORBENT SIDE-WALL AREA _____ SQ. FT.

SEPTIC TANK CAPACITY 1,800 GALLONS

FOR GARBAGE GRINDER, INCREASE DISPOSAL AREA 25% & TANK CAPACITY 50%.

OTHER dry well - 100 sq. ft. checkered sidewalk area for below to basin below the

inlet. Maximum depth permitted for dry well is 9 ft. below original grade. locate dry

well

120 ft. off right side line and 60 ft. off front property line at 3217 Sydenham

Way.

NOTE: ALL PIPE FROM HOUSE TO SEPTIC TANK MUST BE CAST IRON.

PERMIT VOID AFTER THREE YEARS

NOTE: INSTALL STAND PIPE ON SEPTIC TANK AND DRY WELL.

PLANS APPROVED BY Robert V. Torzo DATE 6/10/70

FILL SEPTIC TANK AND DISTRIBUTION BOX WITH WATER BEFORE CALLING FOR AN INSPECTION. COVER NO WORK UNTIL INSPECTED AND APPROVED.

NEITHER THE HOWARD COUNTY COMMISSIONERS NOR THE HEALTH DEPARTMENT IS RESPONSIBLE FOR THE SUCCESSFUL OPERATION OF ANY SYSTEM.

BLDG. PERMIT SIGNED AND RETURNED

3/6/79
Serial # 47467
Addition

14229

1922

PERMIT

MARYLAND STATE DEPARTMENT OF HEALTH
SEWAGE DISPOSAL SYSTEM

BELLCOTT CITY

HOWARD COUNTY

INDEXED

DISTRICT
DATE

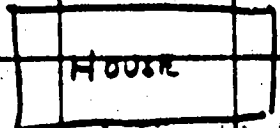

100

100

100

100

00

00

INDICATE NORTH. - NAME ADJOINING ROADWAY AS BASE LINE.

12/25/72
3824/0

PERMIT CARD signed

SEPTIC TANK. LEVEL 10000d CLEANOUTS 1 2 3

DISTRIBUTION BOX. LEVEL _____

TILE FIELD. DEPTH _____ FT. TRENCH WIDTH _____ FT.

GRAVEL DEPTH _____ IN. TOTAL LENGTH _____ FT.

NUMBER OF TRENCHES _____ TOTAL BOTTOM AREA _____

SEEPAge PITS. INSIDE DIAMETER outside perimeter 14x14 FT. DEPTH BELOW INLET 2 FT.

ABSORBENT AREA 420 SQ. FT.

REMARKS _____

DATE SYSTEM APPROVED 7/27/72

INSPECTOR R. Tove

APPLICATION

A 14227
P _____

SEWAGE DISPOSAL TESTING

MARYLAND STATE DEPARTMENT OF HEALTH

HOWARD COUNTY Septic Tank - 3 bedrooms - 1000 sq ft ELLICOTT CITY

4 " 1280 sq ft DISTRICT 3

DATE 1/17/69

Dry Well - 100 sq ft absorbent area per bedroom to begin below the sealed. Maximum depth permitted for dry well is 9 ft. below original grade. Locate dry well 120 ft off right side line and 60 ft off front property line as shown from Evergreen Way

TO: THE COUNTY HEALTH OFFICER
ELLICOTT CITY, MARYLAND

I, HEREBY, APPLY FOR THE NECESSARY TESTS IN ORDER TO CONSTRUCT (OR RECONSTRUCT) A SEWAGE DISPOSAL SYSTEM.

PROPERTY OWNER Hudson Construction Co., Inc.
ADDRESS 363 Chapel Avenue, Ellicott City, Md. PHONE HO 5-2205

PROPERTY LOCATION:

SUBDIVISION Evergreen Valley Estates LOT NO. 34, Sec. 6

ROAD AND DESCRIPTION Evergreen Way

OCCUPANT _____ PHONE _____

PERSON TO CONSTRUCT SYSTEM _____ PHONE _____

ADDRESS _____ PHONE _____

SIZE OF LOT 230' x 340' x 125' x 140' x 160' TYPE BLDG. 3 of 4
NUMBER OF BEDROOMS

IF NOT SINGLE RESIDENCE DESCRIBE _____

SIGNATURE OF APPLICANT /s/ Madeline Leonard

✓ APPROVED BY Robert V. Fine FOR Dry Well DATE 6/10/70
(KIND OF SYSTEM)

REJECTED BY _____ FOR _____ DATE _____
(KIND OF SYSTEM)

HOLD PENDING FURTHER TESTS _____ DATE _____

REASONS FOR REJECTION OR HOLDING _____

THIS IS NOT A PERMIT

APPLICATION

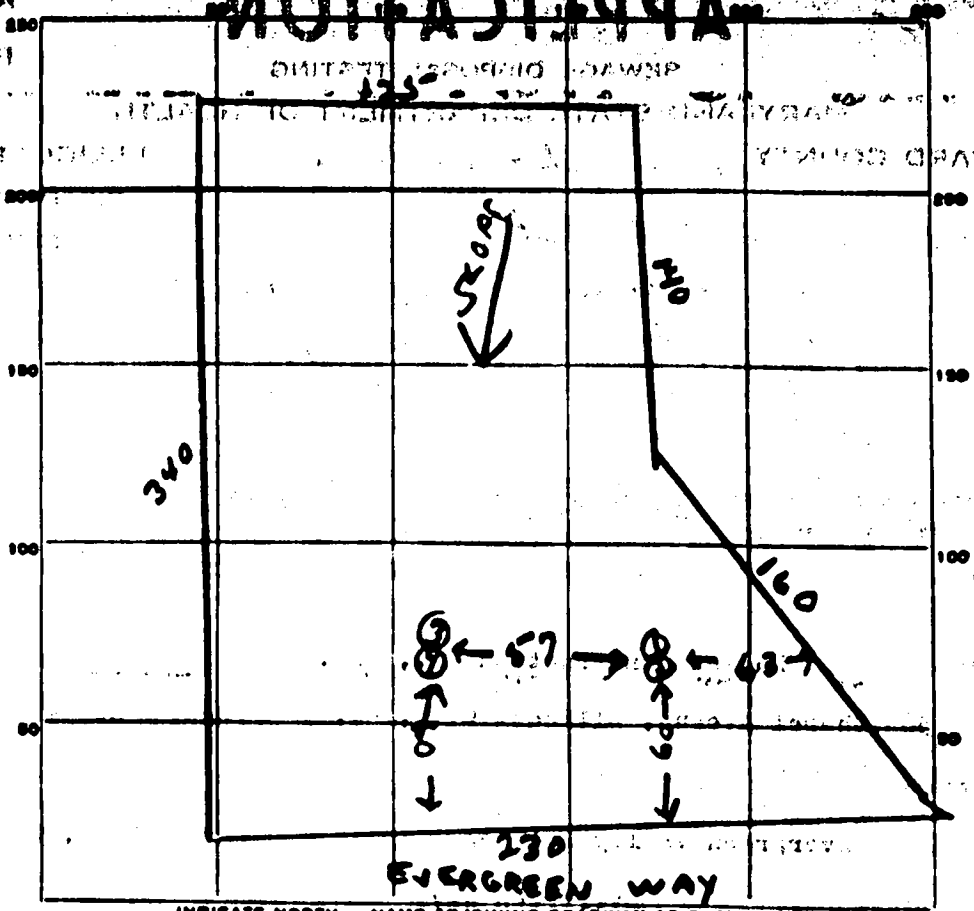

INDICATE NORTH. - NAME ADJOINING ROADWAY AS BASE LINE.

DATE	TEST NO.	DEPTH	PRE-WET		TEST - 1" DROP		TIME
			START	STOP	START	STOP	
	1	9 ft	10 45	10 47	10 47	10 50	3 min
	2	4 ft	10 46	10 47	10 47	10 50	3 min
	3	9 ft	10 58	11 01	11 01	11 08	7 min
	4	9 ft	10 59	11 01	11 01	11 06	5 min

SOIL AUGER FINDING _____

TESTED BY RTme

REMARKS _____

DATE WELL COMPLETED: July 11, 1972

DEPTH OF WELL: 110.0

OWNER: Rafaela Roman

STREET OR RFD: 3210 E. ... POST OFFICE: ...

STATE THE KIND OF FORMATIONS PENETRATED, THEIR COLOR, DEPTH, THICKNESS AND IF WATER BEARING

DESCRIPTION (USE APPROPRIATE)	DEPTH FROM	TO	THICKNESS
Top Soil	0	7	
Sandstone	3	10	
Shale	10	100	

WELL LOG

WELL TYPE: C 1

TYPE OF MATERIAL: CONCRETE

NO. OF CASINGS: 7

GALLONS OF WATER: 10

DEPTH OF GROUT SEAL TO NEAREST FOOT: FROM 0 TO 22

WATER CLOSURE

WATER CLOSURE CODE: 5 T 6

MAIN CASING TYPE: 5 T 6

DIAMETER: 6

DEPTH: 20

OTHER CASINGS

SCREEN TYPE: SCREEN

SCREEN CODE: C 2

DEPTH (NEAREST FEET)

1. 0 - 7

2. 7 - 10

3. 10 - 100

DIAMETER OF SCREEN: 6

GRAVEL PACK: 0 - 0

WATER LEVEL: 20

TYPE OF PUMPS USED: ELECTRIC

PUMP INSTALLED: YES

LOCATION OF WELL ON LOT: view at 33 ft House

CIRCLE APPROPRIATE BOXES

A WELL HAS ABANDONED AND SEALED WHEN THIS

B ELECTRIC LOG OBTAINED

C TEST WELL CONVERTED TO PRODUCTION WELL

I HEREBY CERTIFY THAT I HAVE COMPLIED WITH ALL CONDITIONS STATED ON THE ABOVE-CAPTIONED "ORDER TO DRILL WELL", AND THAT INFORMATION CONTAINED IN THIS REPORT IS TRUE, ACCURATE, AND COMPLETE TO THE BEST OF MY KNOWLEDGE, INFORMATION AND BELIEF.

DRILLER'S NAME: ...

DATE: July 11, 1972

SIGNATURE: ...

TELESCOPE CASING: YES

LOG INDICATOR: YES

OTHER DATA AVAILABLE: YES

