

51197
10:00:00

PERMIT

SEWAGE DISPOSAL SYSTEM

DEPARTMENT OF HEALTH AND MENTAL HYGIENE

05 - 367255

P 58113-C

A REPAIR

DISTRICT _____

DATE 04/28/97

HOWARD COUNTY HEALTH DEPARTMENT

BUREAU OF ENVIRONMENTAL HEALTH

~~XXXXXXXX~~ 313-2640

DATE SYSTEM APPROVED 5-1-97

INSPECTOR KM

INDEXED

Jack Fyock Septic Service _____ IS PERMITTED TO INSTALL _____ ALTER X

ADDRESS 13775 Triadelphia Road, Dayton, Maryland PHONE 988-9270

SUBDIVISION _____ LOT _____ ROAD 6941 Brooks Road

PROPERTY OWNER _____ Kammerer

ADDRESS _____ 6941 Brooks Road
Highland, Maryland 20777

SEPTIC TANK CAPACITY 1000 GALLONS

NUMBER OF BEDROOMS 3

125 SQUARE FEET PER BEDROOM

LINEAR FEET OF TRENCH REQUIRED 54±

REPAIR - PURPOSE - SEPTIC SYSTEM HAS FAILED.

Call for inspection when ground is opened so sanitarian can recommend repair.
04/28/97

Install trench off existing driveway
Trenches to be 2' wide, inlet at 3', bottom at 10', stone 7'

PLANS APPROVED BY Kim Maisto DATE 5/1/97

COVER NO WORK UNTIL INSPECTED AND APPROVED

NEITHER THE HOWARD COUNTY COUNCIL NOR THE HEALTH DEPARTMENT IS RESPONSIBLE FOR THE SUCCESSFUL OPERATION OF ANY SYSTEM

NOTE: CLEANOUT REQUIRED EVERY 70 FEET OF SEWER LINE AND/OR AT 90° SWEEPS IN LINES FROM HOUSE TO DRAIN FIELDS, 90° ELBOWS NOT ACCEPTABLE.

NOTE: ALL PARTS OF SEPTIC SYSTEMS (I.E. TANK, DISTRIBUTION BOX TRENCHES) TO BE 100 FEET FROM WELL (UNLESS OTHERWISE SPECIFICALLY AUTHORIZED)

NOTE: IF DEEP TRENCH(ES) ARE USED CALL FOR INSPECTION BEFORE AND AFTER PLACING GRAVEL IN TRENCH(ES)

NOTE: NO DRY WELL SHALL EXCEED 15 FOOT IN DIAMETER NO ABSORPTION TRENCH TO EXCEED 100 FEET IN LENGTH

NOTE: ALL PIPE FROM HOUSE TO SEPTIC TANK MUST BE CAST IRON OR SCHEDULE 35/40 PVC OR ABS

PERMIT VOID AFTER TWO YEARS

NOTE: INSTALL STAND PIPE ON SEPTIC TANK AND DRY WELL STAND PIPES MUST BE 6 INCHES IN DIAMETER CAST IRON. CONCRETE OR TERRA COTTA OR PVA OR ABS ACCEPTED. IF TOP OF SEPTIC TANK IS DEEPER THAN 3 FEET. MANHOLE TO GRADE REQUIRED.

NOTE: DISTRIBUTION BOXES MUST HAVE BAFFLES

***INSTALLER IS RESPONSIBLE FOR OBTAINING FINAL APPROVAL ON THIS PERMIT**

A
58113-C

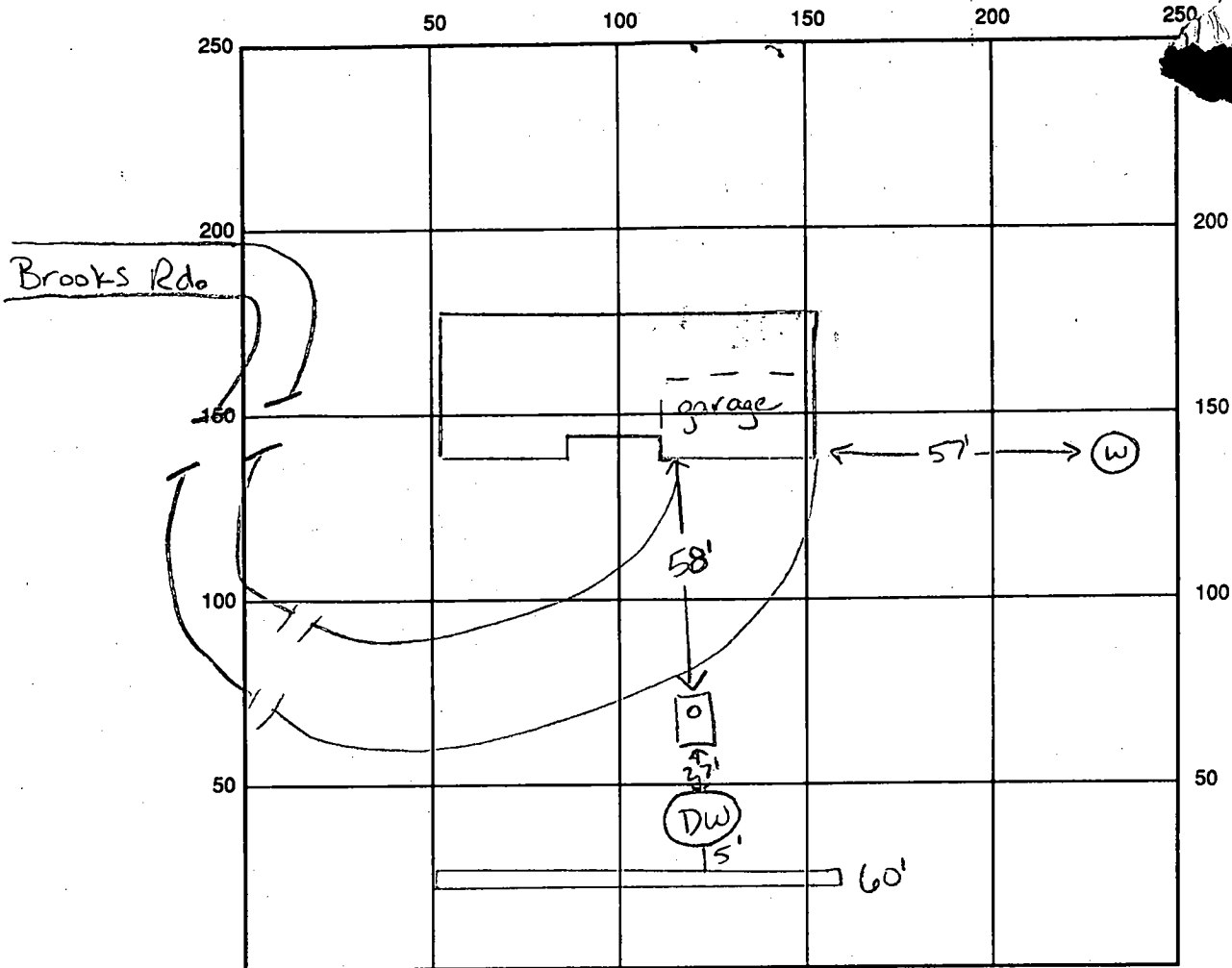

INDICATE NORTH - NAME ADJOINING ROADWAY AS BASE LINE

SEPTIC TANK LEVEL existing CLEANOUTS 1 on tank, 1 on drywell
 DISTRIBUTION BOX LEVEL N/A
 DRAIN FIELD/TITLE DEPTH 10 FT. TRENCH WIDTH 2 FT. INLET DEPTH 3 FT.
 EFFECTIVE GRAVEL DEPTH 7 FT. TOTAL LENGTH 1 x 60 FT. → 60
 NUMBER OF TRENCHES 1 ONE SIDEWALL/BOTTOM AREA 420 SQ. FT.
 DRYWALL INSIDE DIAMETER existing FT. EFFECTIVE DEPTH BELOW INLET — FT.
 ABSORBENT AREA 420 SQ. FT. + existing
 REMARKS: 5-1-97 ok to cover all work KM

DATE SYSTEM APPROVED 5-1-97 INSPECTOR Kim Mawle

PERMIT

P 25612

SEWAGE DISPOSAL SYSTEM

A 23388

MARYLAND STATE DEPARTMENT OF HEALTH

HOWARD COUNTY

ELLICOTT CITY

DISTRICT 5th

INDEXED

DATE 4/11/77

Carlton Kammerer IS PERMITTED TO INSTALL ALTER

Route 216, Highland, Md. 20777 PHONE 596-5472

SEWAGE DISPOSAL SYSTEM LOCATED AT

DIVISION ROAD 5941 Brooks Road LOT

PROPERTY OWNER Carlton Kammerer

ADDRESS Route 216, Highland, Md. 20777

REQUIREMENTS 3 bedrooms

DRAIN FIELD DEPTH FEET, BOTTOM AREA SQ. FT.

SEPTIC TANK ABSORBENT SIDE-WALL AREA SQ. FT.

SEPTIC TANK CAPACITY 1000 GALLONS

FOR GARBAGE GRINDER, INCREASE DISPOSAL AREA 25% & TANK CAPACITY 50%.

OTHER DRY WELL - To have 125 sq. ft. effective sidewall absorption area per bedroom below the first 3 ft. of non-porous soil. Maximum depth permitted for dry well is 11 ft. below original grade. Place the dry well 160 ft. from the left (871.19 ft. long) side line and 95 ft. from the rear (323.98 ft. long) lot line, in perc hole 7, 7A, as soon when facing the property from the right of way that is Brooks Road extended.

NOTE: IN NO CASE IS ANY DRY WELL TO EXCEED 15 FOOT IN DIAMETER.

NOTE: ALL PIPE FROM HOUSE TO DISPOSAL AREA MUST BE CAST IRON. PERMIT VOID AFTER THREE YEARS. NOTE: INSTALL STAND PIPE ON SEPTIC TANK AND DRY WELL. STAND PIPES MUST BE 6 INCHES IN DIAMETER. CAST IRON, CONCRETE OR TERRA COTTA ACCEPTED.

APPROVED BY Frank Skinner DATE 8/2/76

SEPTIC TANK AND DISTRIBUTION BOX WITH WATER BEFORE CALLING FOR AN INSPECTION. COVER NO WORK UNINSPECTED AND APPROVED.

NEITHER THE HOWARD COUNTY COMMISSIONERS NOR THE HEALTH DEPARTMENT IS RESPONSIBLE FOR THE SUCCESSFUL OPERATION OF ANY SYSTEM.

A 23388

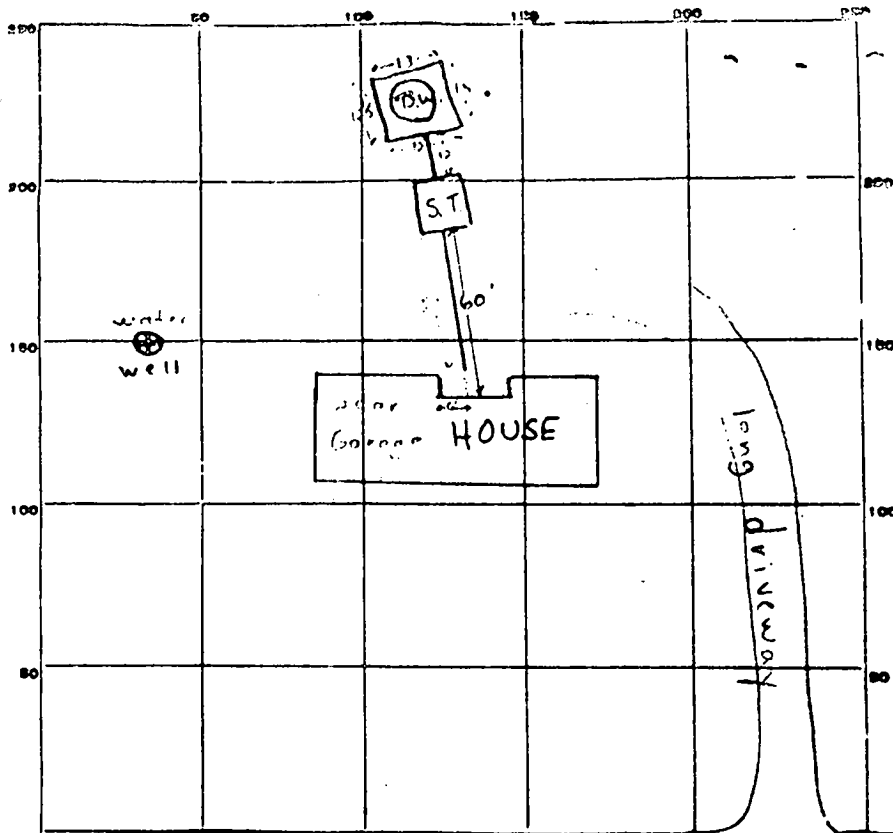

INDICATE NORTH. - NAME ADJOINING ROADWAY AS BASE LINE.

R/W

Brooks Road

R11109

PERMIT CARD #2477 signed W.S.C. F.S.

S.T. D.W.

SEPTIC TANK, LEVEL _____

CLEANOUTS O.K. O.K.

DISTRIBUTION BOX, LEVEL N.A.

TILE FIELD, DEPTH _____ FT. TRENCH WIDTH _____ FT.

GRAVEL DEPTH _____ IN. TOTAL LENGTH _____ FT.

NUMBER OF TRENCHES _____ TOTAL BOTTOM AREA _____

SEEPAGE PITS, INSIDE DIAMETER 50.5 FT. DEPTH BELOW INLET 7.5-8 FT.

ABSORBENT AREA 1378 SQ. FT.

REMARKS 4/26/77 Call for final inspection when system is connected to house O.K. to cover everything except first 4' of pipe coming out from house F.S.

DATE SYSTEM APPROVED _____ INSPECTOR _____

Make \$20.00 check payable to
Howard County Sanitation

APPLICATION

SEWAGE DISPOSAL TESTING

STATE OF MARYLAND - DEPARTMENT OF HEALTH AND MENTAL HYGIENE

HOWARD COUNTY HEALTH DEPARTMENT
ENVIRONMENTAL HEALTH SERVICES

DISTRICT 1-5

P. O. BOX 476, ELLICOTT CITY, MARYLAND 21043
TELEPHONE: 465-5000, EXT. 356

DATE June 1

Retest

7/11/76
9:30

3 B.R. 1000 gal. septic tank | 4 B.R. 1250 gal. septic tank

Draywell to have 125 sq. ft. effective sidewall absorption area per bedroom below the first 3 ft. of non-porous soil. Maximum depth permitted for drywell is 11 ft. below original grade. Place the drywell 160 ft. from the left (87.19 ft. long) side line and 95 ft. from the rear (323.98 ft. long) lot line, in perc. to 7-7A, as seen when facing the property from the right of way that is Brooks Road extended.

TO: THE COUNTY HEALTH OFFICER
ELLICOTT CITY, MARYLAND

I, HEREBY, APPLY FOR THE NECESSARY TEST IN ORDER TO CONSTRUCT (OR RECONSTRUCT) A SEWAGE DISPOSAL SYSTEM.

PROPERTY OWNER Mr + Mrs Carlton Hammerer

ADDRESS Rt 216 Highland Md 20777 PHONE 596-5472

PROPERTY LOCATION:

SUBDIVISION Wm Fred Singer's Land 6941 Brooks Road LOT NO.

ROAD AND DESCRIPTION direction Brooks Rd off Rt 108 Highland 1/4 mile off Rt 108 on Brooks Rd - go across stream 1st 600' on Rt 108 property.

SIZE OF LOT 15 acres (6.488 acres) TYPE BLDG. 3
NUMBER OF BEDROOMS

IF NOT SINGLE RESIDENCE DESCRIBE _____

THE SYSTEM INSTALLED UNDER THIS APPLICATION IS ACCEPTABLE ONLY UNTIL PUBLIC FACILITIES BECOME AVAILABLE.

SIGNATURE OF APPLICANT Mrs C C Hammerer BLDG. PERMIT, SIGNED AND RETURNED 8/28/76

APPROVED BY Frank Skinner FOR Draywell DATE 8/2/76
(KIND OF SYSTEM)

REJECTED BY _____ FOR _____ DATE _____
(KIND OF SYSTEM)

HOLD PENDING FURTHER TESTS _____ DATE _____

REASONS FOR REJECTION OR HOLDING _____

THIS IS NOT A PERMIT

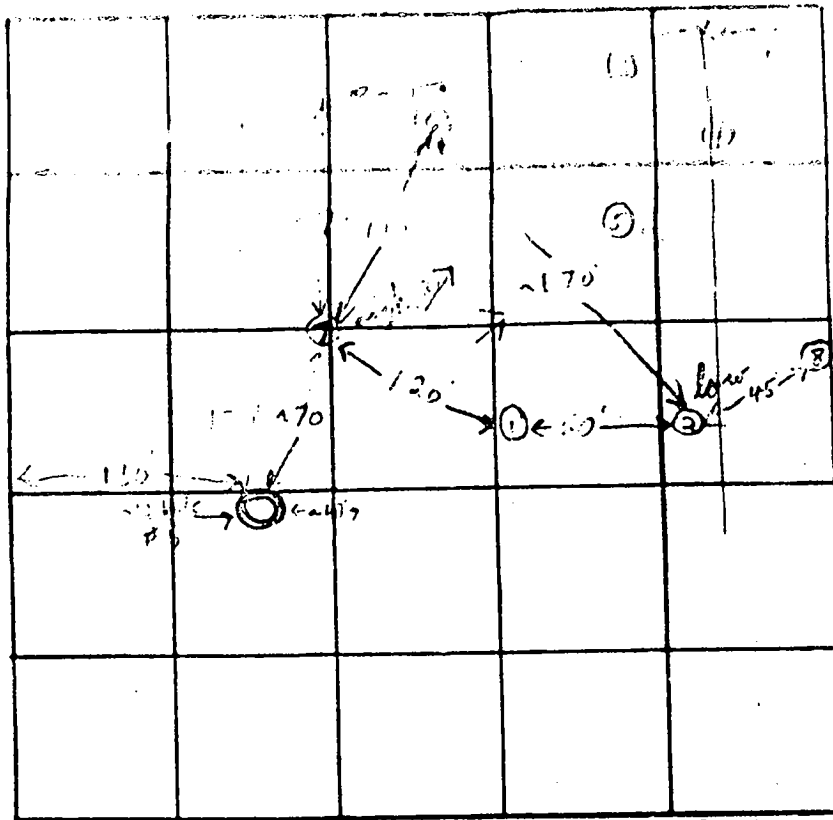

INDICATE NORTH. NAME ADJOINING ROADWAY AS BASE LINE.

R/W

- Brooks

DATE	TEST NO.	DEPTH	PRE-WET		TEST : 1" DROP		TIME	
			START	STOP	START	STOP		
11/14/70	1	5'	10:00	10:02	10:02	10:06	4 min	
	1A	13 1/2'	10:00	10:04	10:04	10:08	2 min	
	2	4'	10:21	10:28	10:29	10:32	4 min	
	2A	13'	10:25	10:33	10:28	10:33	5 min	
	3	8'	clayey to 2 silty mica brown and Rock at 8'					
	4	9 1/2'	Mica schist rock at 9'					
	5	10'	clayey to 4 1/2' sandy mica brown some mica - black bed.					
	5	12 1/2'	clayey to 5' hard mica brown some mica - black bed.					
	7 high	4'	12:24	12:27	12:27	12:35	8 min	
	7A	12'	12:24	12:30	12:30	12:42	12 min	
	8	10'	clayey to 3' sandy mica brown to 10' hard at 10'					

REMARKS 2 1/2" diameter in some points

TYPE OF SOIL clayey to 5-4' sandy mica brown some mica - black bed.

TESTED BY F.S. ALSO PRESENT: Fyacks crew