

PERMIT

SEWAGE DISPOSAL SYSTEM

DEPARTMENT OF HEALTH AND MENTAL HYGIENE

P 5 8053A

A REPAIR

3/24/97
ASAP C.O.

HOWARD COUNTY HEALTH DEPARTMENT

BUREAU OF ENVIRONMENTAL HEALTH

~~XXXXXXXX~~ 313-2640

348714

DISTRICT _____

DATE 3/28/97

DATE SYSTEM APPROVED 3/24/97

INSPECTOR DKS

INDEXED

Jack fyock Septic Service _____ IS PERMITTED TO INSTALL _____ ALTER X

ADDRESS 13775 Triadelphia Road, Glenelg, Maryland 21737 PHONE 988-9270

SUBDIVISION Greenwood Farms LOT 37 ROAD 7613 Green Dell Lane

PROPERTY OWNER Craig Auletta

ADDRESS _____

SEPTIC TANK CAPACITY 1000 GALLONS

NUMBER OF BEDROOMS 3

125 SQUARE FEET PER BEDROOM

LINEAR FEET OF TRENCH REQUIRED 85±

REPAIR - PURPOSE - SEPTIC SYSTEM HAS FAILED..

Call for inspection when ground is opened so sanitarian can recommend repair.
03/20/97

Install trench (and dist. box) off existing septic tank.

Trench to be 2' wide, inlet 3.0', bottom 7.5', slope 4.5'

PLANS APPROVED BY [Signature] DATE 3/24/97

COVER NO WORK UNTIL INSPECTED AND APPROVED

NEITHER THE HOWARD COUNTY COUNCIL NOR THE HEALTH DEPARTMENT IS RESPONSIBLE FOR THE SUCCESSFUL OPERATION OF ANY SYSTEM

NOTE: CLEANOUT REQUIRED EVERY 70 FEET OF SEWER LINE AND/OR AT 90° SWEEPS IN LINES FROM HOUSE TO DRAIN FIELDS, 90° ELBOWS NOT ACCEPTABLE.

NOTE: ALL PARTS OF SEPTIC SYSTEMS (I.E. TANK, DISTRIBUTION BOX TRENCHES) TO BE 100 FEET FROM WELL (UNLESS OTHERWISE SPECIFICALLY AUTHORIZED)

NOTE: IF DEEP TRENCH(ES) ARE USED CALL FOR INSPECTION BEFORE AND AFTER PLACING GRAVEL IN TRENCH(ES)

NOTE: NO DRY WELL SHALL EXCEED 15 FOOT IN DIAMETER NO ABSORPTION TRENCH TO EXCEED 100 FEET IN LENGTH

NOTE: ALL PIPE FROM HOUSE TO SEPTIC TANK MUST BE CAST IRON OR SCHEDULE 35/40 PVC OR ABS

PERMIT VOID AFTER TWO YEARS

NOTE: INSTALL STAND PIPE ON SEPTIC TANK AND DRY WELL STAND PIPES MUST BE 6 INCHES IN DIAMETER CAST IRON. CONCRETE OR TERRA COTTA OR PVA OR ABS ACCEPTED. IF TOP OF SEPTIC TANK IS DEEPER THAN 3 FEET. MANHOLE TO GRADE REQUIRED.

NOTE: DISTRIBUTION BOXES MUST HAVE BAFFLES

***INSTALLER IS RESPONSIBLE FOR OBTAINING FINAL APPROVAL ON THIS PERMIT**

Garage/studio w/
BATT ROOM
B00104292

A 58053A

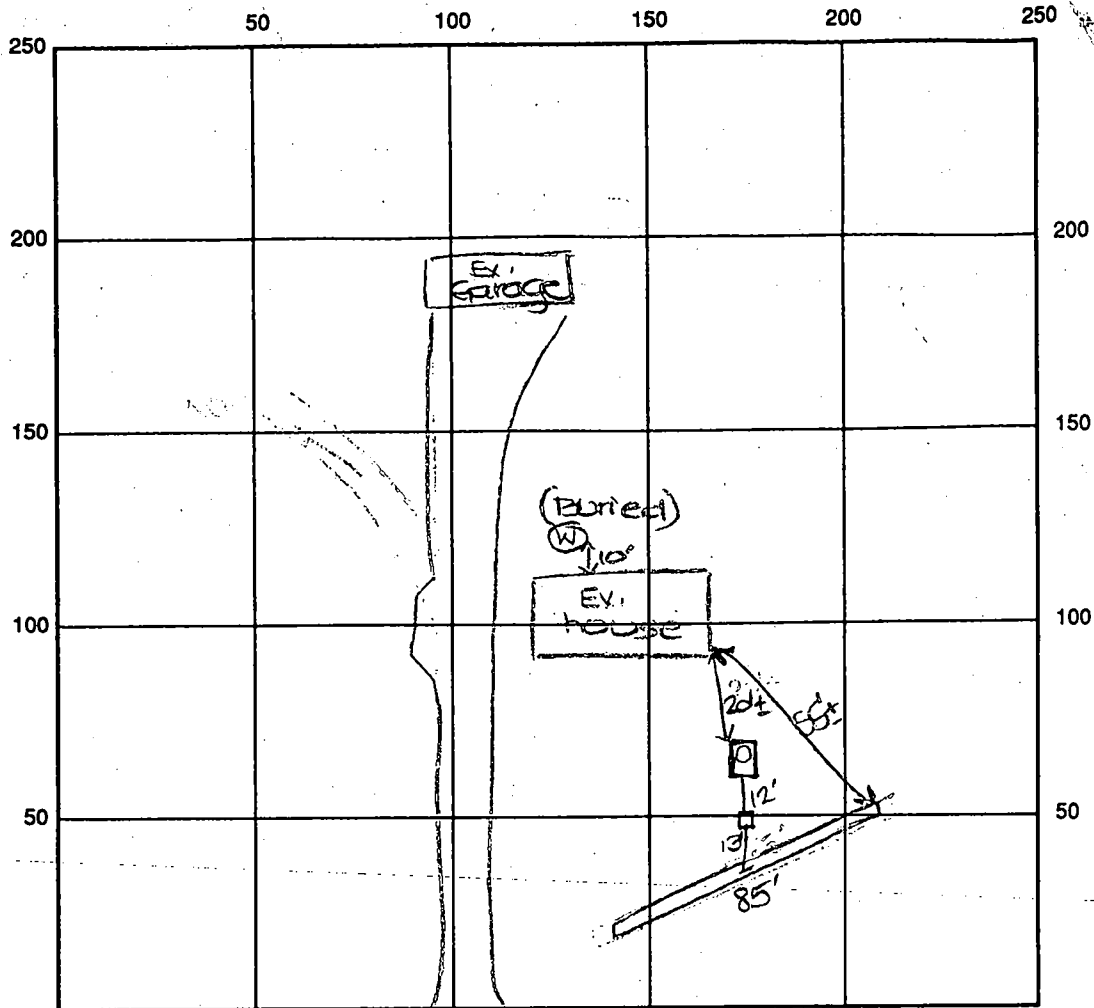

INDICATE NORTH - NAME ADJOINING ROADWAY AS BASE LINE

Green Dell Lane

SEPTIC TANK LEVEL Existing CLEANOUTS manhole on sit.

DISTRIBUTION BOX LEVEL OK

DRAIN FIELD/TITLE DEPTH 7.5 FT. TRENCH WIDTH 2 FT. INLET DEPTH 3.0 FT.

EFFECTIVE GRAVEL DEPTH 4.5 FT. TOTAL LENGTH 85 FT.

NUMBER OF TRENCHES 1 ONE SIDEWALL/BOTTOM AREA _____ SQ. FT.

DRYWALL INSIDE DIAMETER _____ FT. EFFECTIVE DEPTH BELOW INLET _____ FT.

ABSORBENT AREA _____ SQ. FT.

REMARKS: 3/24/97 A.M. OK to continue work. DKS

3/24/97 P.M. FINAL - OK to cover all work. DKS

DATE SYSTEM APPROVED 3/24/97

INSPECTOR Donna J. Lee

Better directions?
9/4/68

PERMIT

SEWAGE DISPOSAL SYSTEM

MARYLAND STATE DEPARTMENT OF HEALTH

HOWARD COUNTY

INDEXED

ELLICOTT CITY

DISTRICT 5

DATE 8/22/68

P 13858
A _____

Raymond Driver IS PERMITTED TO INSTALL ALTER X
ADDRESS Green Dell Lane, Highland, Md. PHONE _____

A SEWAGE DISPOSAL SYSTEM LOCATED AT _____

SUBDIVISION Greenwood Farms ⁷⁶¹³ ROAD Green Dell Lane LOT _____

PROPERTY OWNER same as above

ADDRESS _____

SPECIFICATIONS

DRAIN FIELD _____ DEPTH _____ FEET, BOTTOM AREA _____ SQ. FT.

SEEPAGE PITS _____ ABSORBENT SIDE-WALL AREA _____ SQ. FT.

SEPTIC TANK CAPACITY _____ GALLONS

FOR GARBAGE GRINDER, INCREASE DISPOSAL AREA 22% & TANK CAPACITY 60%.

OTHER REPAIR - Drain field 12' deep with 9' of gravel and 30' to 40'
long - about 10' away and parallel to the existing fields.

Call for inspection before trench is filled with gravel.

PLANS APPROVED BY F. Frommelt DATE 8/20/68

FILL SEPTIC TANK AND DISTRIBUTION BOX WITH WATER BEFORE CALLING FOR AN INSPECTION. COVER NO WORK UNTIL INSPECTED AND APPROVED.

NEITHER THE HOWARD COUNTY COMMISSIONERS NOR THE HEALTH DEPARTMENT IS RESPONSIBLE FOR THE SUCCESSFUL OPERATION OF ANY SYSTEM.

NOTIFY THE HEALTH DEPARTMENT 48 HOURS BEFORE EXCAVATIONS ARE TO BE BACK FILLED.

13858

PERMIT

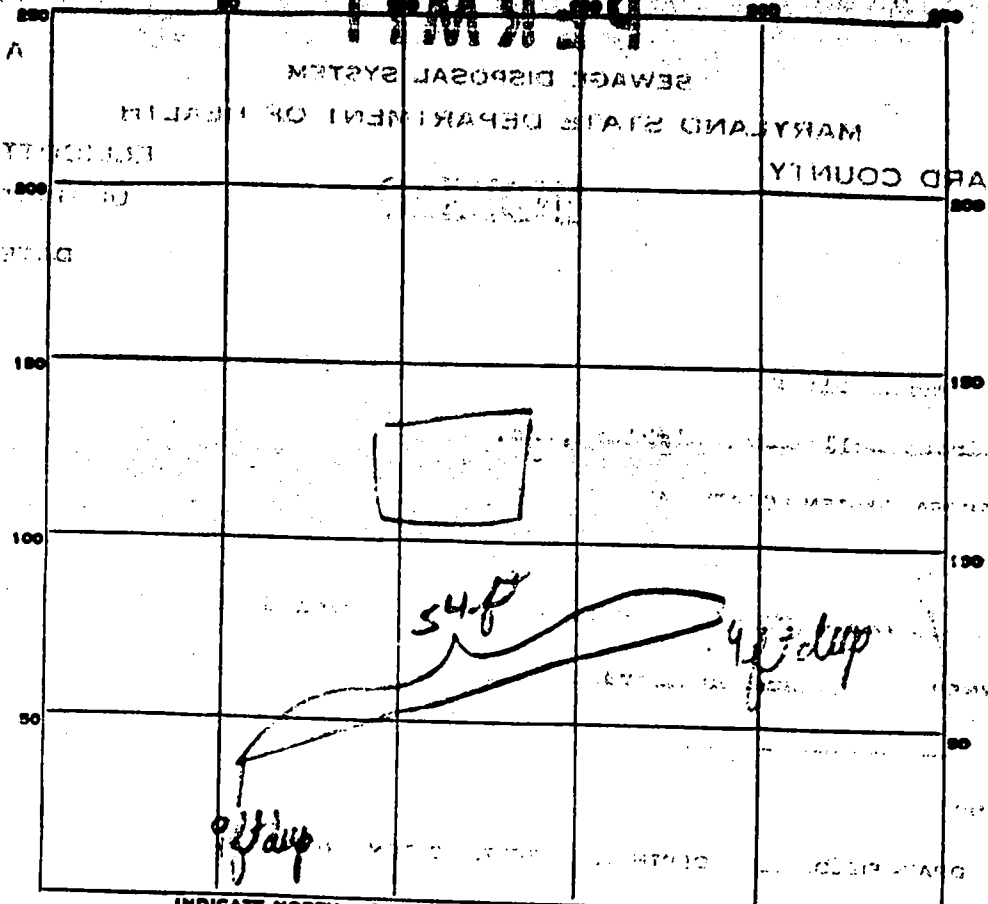

INDICATE NORTH - NAME ADJOINING ROADWAY, AS BASE LINE.

PERMIT CARD _____
 SEPTIC TANK, LEVEL _____ CLEANOUTS _____
 DISTRIBUTION BOX, LEVEL _____
 TILE FIELD, DEPTH _____ FT. TRENCH WIDTH _____ FT.
 GRAVEL DEPTH _____ IN. TOTAL LENGTH _____ FT.
 NUMBER OF TRENCHES _____ TOTAL BOTTOM AREA _____
 SEEPAGE PITS, INSIDE DIAMETER _____ FT. DEPTH BELOW INLET _____ FT.
 ABSORBENT AREA _____ SQ. FT.

REMARKS *2/1/68 - trench 4 ft deep, instead of 12 ft - ground
 clear at 4 ft - length 54 ft, instead of 40 ft - 6 in. of gravel
 gravel in trench - must be 15 ft of gravel*

DATE SYSTEM APPROVED _____ INSPECTOR _____