

4/7/85
Per 1:30 P.M.
of date

APPLICATION

A 35376
P _____

SEWAGE DISPOSAL TESTING
STATE OF MARYLAND - DEPARTMENT OF HEALTH AND MENTAL HYGIENE

HOWARD COUNTY HEALTH DEPARTMENT
ENVIRONMENTAL HEALTH SERVICES
P. O. BOX 476 ELLICOTT CITY, MARYLAND 21043
TELEPHONE: 992-2330

DISTRICT _____
DATE 5/27/85

TO: THE COUNTY HEALTH OFFICER
ELLICOTT CITY, MARYLAND

I, HEREBY, APPLY FOR THE NECESSARY TEST IN ORDER TO CONSTRUCT (OR RECONSTRUCT) A SEWAGE DISPOSAL SYSTEM.

PROPERTY OWNER HERB HARRIDAY

ADDRESS 1963 DAISY RD PHONE 489-4897

PROPERTY LOCATION: 21797 WOODBINE MI7

SUBDIVISION TAX MAP 8 PARCEL 47 LOT NO. _____

ROAD AND DESCRIPTION ADJACENT TO 1963 DAISY RD (HARRIDAY) 2 MILES SOUTH OF 144

SIZE OF LOT .7 ACRES TYPE BLDG. 3 BR NO GARBAGE GRINDER
(RESIDENCE) (NUMBER OF BEDROOMS)

THE SYSTEM INSTALLED UNDER THIS APPLICATION IS ACCEPTABLE ONLY UNTIL PUBLIC FACILITIES BECOME AVAILABLE. I FULLY UNDERSTAND THE FEE CONNECTED WITH THE FILING OF THIS PERC TEST APPLICATION IS NON-REFUNDABLE UNDER ANY CIRCUMSTANCES. I ALSO AGREE TO COMPLY WITH ALL M.O.S.H.A. REQUIREMENTS IN TESTING THIS LOT.

Herbert H. HarriDay
(SIGNATURE OF APPLICANT)

APPROVED BY C. Williams PLST NOT REQ'D FOR TRENCHES DATE 1/10/86

REJECTED BY _____ FOR _____ DATE _____

HOLD PENDING FURTHER TESTS _____ DATE _____

REASONS FOR REJECTION OR HOLDING 6/7/85 PERC OK HOLD FOR WELL SITE
PLANS & SEPTIC PLANS LOT IS
RECORDED MUST WRITE LETTER

THIS IS NOT A PERMIT

SOIL PROFILE

① ② ③

4

BROWN CLAY

BROWN SAND LOAM & FEW ROCKS

12

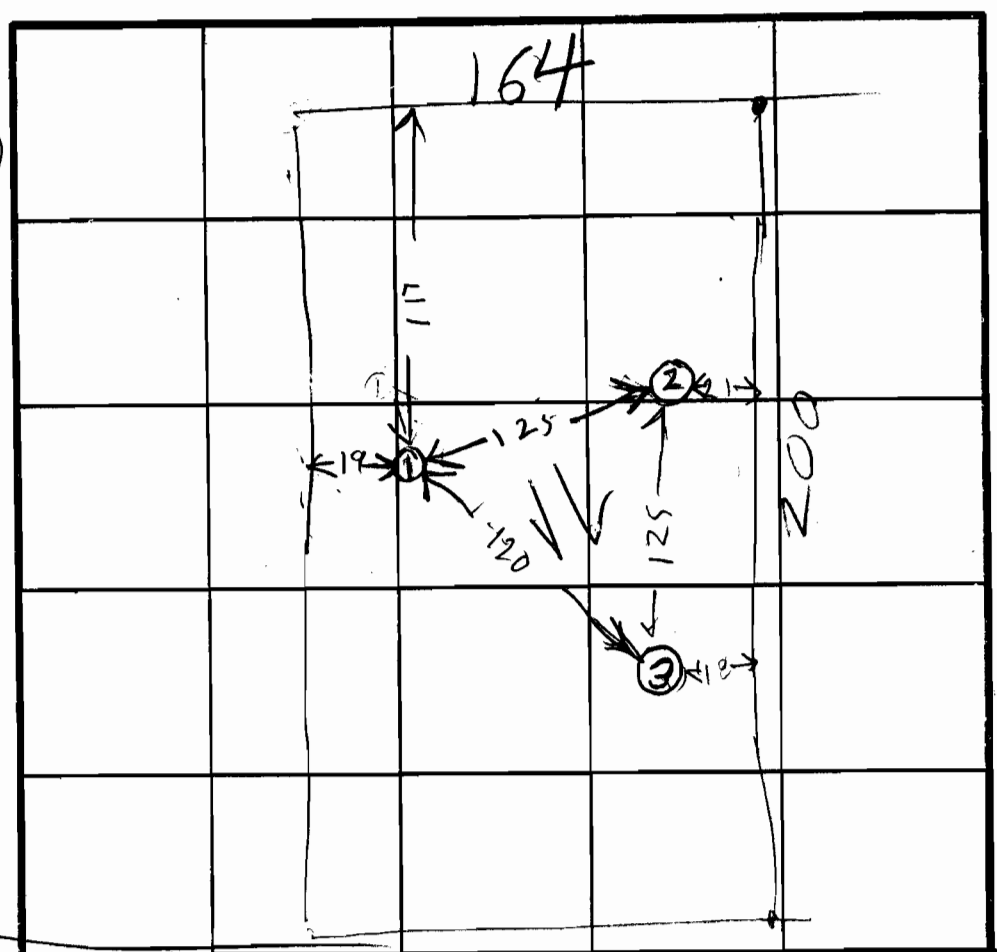

HOLE ELEVATION

① ② = HIGH

③ = LOW

DRIVEWAY INDICATE NORTH - NAME ADJOINING ROADWAY AS BASE LINE.

DATE	TEST NO.	DEPTH	PRE-WET		TEST - 1" DROP		TIME
			START	STOP	START	STOP	
6/7/85	1S	4.5	203	209	209	214	5
	1P	18	203	214	214	228	14
6/7/85	1V	12	LOOKS		OK		
	2S	5	216	229	229	240	11
	2D	10	215	221	221	229	0
+	2V	13	LOOKS		OK		
	3S	4	230	237	237	254	17
	3V	12	LOOKS		OK		

EH-12-1079

REMARKS _____

TYPE OF SOIL _____

TESTED BY B. HODGES

ALSO PRESENT HERMAN SIRKSON

5/19/84
①

HARRIDAY PROPERTY
MAP 8 Q19 P47
DAISY ROAD

A 35386

SUBDIVISION:

LOT NUMBER:

DRY WELL OR DRY WELL AND TRENCH

	<u>Septic Tank</u>	<u>Minimum Total Square Feet</u>
3 bedroom	1000 gallon	_____ sq. ft./bedroom
4 bedroom	1250 gallon	_____
5 bedroom	1500 gallon	_____

Inlet _____ feet below original grade.
Bottom maximum depth _____ feet below original grade.
Effective area begins at _____ feet below original grade.

NOTE: If trench is used to make up absorbent area, run the trench on level ground and leave a 5-foot earth buffer between dry well and trench. No trench is to exceed 100 feet in length. Trench inlet to be same as dry well, with _____ feet of stone below distribution pipe.

TRENCHES

194 sq. ft./bedroom

Trench to be 2 wide.
Inlet 3 1/2 feet below original grade.
Bottom maximum depth 7 1/2 feet below original grade.
Effective area begins at 3 1/2 feet below original grade.
4 feet of stone below distribution pipe.

- NOTE:
- (1) No trench to exceed 100 feet in length.
 - (2) If more than one trench used, a distribution box is required.
 - (3) Trenches to be installed on level ground.
 - (4) Call for inspection of trench before gravel is installed.
 - (5) Provide 6" - 8" diameter cleanout and cap to grade or above on septic tank and drywell.
 - (6) If a garbage disposal is used, increase septic tank capacity by 50% and increase absorbent sidewall area by 22%.

LOCATION: BEGINNING FROM THE LEFT REAR LOT CORNER
PLACE 1ST TRENCH 120' DOWN THE LEFT LOT LINE AND
20' OFF THE LINE AS SEEN WHEN FACING PROPERTY
FROM COMMON DRIVEWAY. RUN TRENCHES ALONG CONTOUR
TOWARDS THE RIGHT LOT LINE.
MAINTAIN MINIMUM 100' DISTANCE FROM WELL TO
SEPTIC.

HARRIDAY

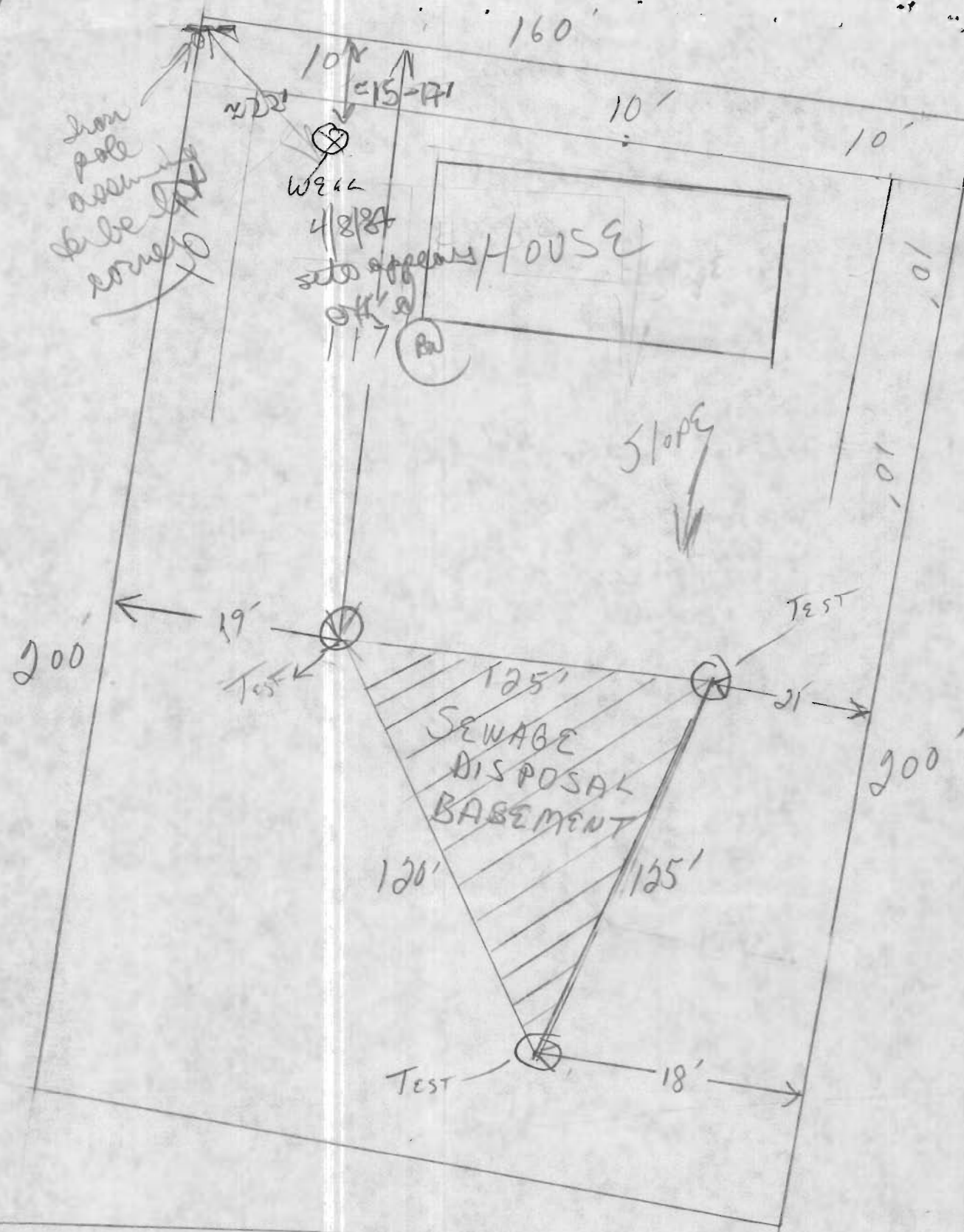

DRIVEWAY 164

PARCEL #47

176.32 A.
P.5

RICHARD W. TALLEY
493/140
131.10A.
P.34

D.L. BURKE
462/608
6.27A.
P.200

R.W. BONIFANT
592/433
6.15A.
P.196

R. INGELS
643/642
5.00A.
P.201

WM. D. REGA
643/203
5.00A.
P.288

P.285
P.321
P.286
P.277
P.270
P.279
P.251

DAISEY ROAD

JOHN A. BANGS
776/640
11.60A.
P.42

MAP 7-P-203

SEC-2
2
3
LISSON MEADOWS
P.222

L.L. MOORE & W.F.
471/368
5.00A.
P.210

H.S. CAIN, JR. & W.F.
P/O
P.184

H. JOHN-SON
4.52
P.223

JAMES W. WARD, JR., ETAL.
1151/212;
1151/220
86.00A.
P.51

MAP 7-P-140

MAP 7-P-493
44085
P.361

J. A. PEARRE
402/752
22.87A.
P.43

W.F. FULLER
491/318
6.45A.
P.185

E.B. CAHILL & W.F.
526/229
6.19A.
P.218

ARAM NAZARIAN
500/613
7.72A.
P.186

EARL D. O'DELL
443/158
10.00A.
P.192

EUGENE BROTHERTON
445/118
10.00A.
P.193

CO. COMM. OF HO. CO.
330/181
20.07A.
P.49

DAVID DEBERNARDO
456/268
126.29A.
P.202

MAP 7-P-338
Daisy Meadows
7
6
5
4
3
2
1

PEARRE PROPERTY
P.363

LEO J. MALINOWSKI
894/81
10.00A.
P.194

J.B. COLE, JR.
451/618
5.88A.
P.195

MAP 7-P-141

MAP 14-P-160

MAP 14-P-211

COPYRIGHT-MAP DIVISION-1967
MD. DEPT. OF ASSESS. & TAX.

782

785

20 47

176.32 A
P.5

RICHARD W.
TALLEY
493/140
131.10A.
P.34

D.L. BURKE
462/608
6.27A.
P.200

D. REGA
643/203
5.00A.
P.288

R.W. BONIFANT
592/433
6.15A.
P.196

R. INGELS
643/642
5.00A.
R.201

P.286
P.277
P.270
P.279
P.251

DAISEY ROAD

MILL ROAD

JOHN A. BANGS
776/640
11.60A.
P.42

MAP 7-P-203

SEC. 2
2
P.152
P.127
P.175
P.222
L. J. SPIN
L. HEARD

H.S. CAIN, JR.
& W.F.
P/O
P.184

L.L. MOORE & W.P.
471/358
5.00A.
P.210

JAMES W. WARD, JR., ET AL.
1151/212;
1151/220
86.00A.
P.51

PAR. A.

96

MAP 7-P-140

MAP 7-P-493
44085
P.361

J. A. PEARRE
402/752
22.87A.
P.43

W.F. FULLER
491/318
6.45A.
P.185

E.B. CAHILL & W.P.
526/229
6.19A.
P.218

ARAM NAZARIAN
500/613
7.72A.
P.186

EARL D. O'DELL
443/158
10.00A.
P.192

DAVID DEBERNARDO
456/268
126.29A.
P.202

MAP 7-P-33
Daisy Meadows
7
6
5
4
3

P.231

PEARRE PROPERTY

P.363

EUGENE BROTHERTON
445/118
10.00A.
P.193

CO. COMM. OF HO. CO.
330/181
20.07A.
P.49

P.45
P.46
P.47
P.48

LEO J. MALINOWSKI
894/81
10.00A.
P.194

J.B. COLE, JR.
451/615
5.88A.
P.195

P.199

MAP 14-P.160

MAP 14-P.211

MAP 14

COPYRIGHT-MAP DIVISION-1967
MD. DEPT. OF ASSESS. & TAX.

Herbert F. Harri-day
1205 Reaton St.
Silver Springs Md.
20903

301-434-3535

~~1963~~ 1963 Daisy Rd. (Father)
Woodbine, Md.
489-4897