

P 11032
A 5856-A
A 10924

INDEXED

?

10/25/65

Mt. Airy Builders & Contractors, Inc. IS PERMITTED TO INSTALL X ALTER

ADDRESS Mt. Airy, Maryland PHONE 442-2229

A SEWAGE DISPOSAL SYSTEM LOCATED AT _____

SUBDIVISION _____ ROAD Dorsey Hill Rd. LO. _____

PROPERTY OWNER Ivan M. Abendroth

ADDRESS _____

SPECIFICATIONS - 4 bedrooms

DRAIN FIELD _____ DEPTH _____ FEET, BOTTOM AREA _____ SQ. FT.

SEEPAGE PITS _____ ABSORBENT SIDE-WALL AREA _____ SQ. FT.

SEPTIC TANK CAPACITY 1000 GALLONS

FOR GARBAGE GRINDER, INCREASE DISPOSAL AREA 25% & TANK CAPACITY 50%.

OTHER Tile field - 400 sq. ft. bottom area installed no deeper than 3 ft.
Place the tile field 90 ft. to 120 ft. from the right side of the house as
seen when standing inside of the house and facing the front of the house.
Run the trenches along the side of the hill. Place the water well at least
250 ft. from the tile field and at a higher elevation than the tile field.

PLANS APPROVED BY Raymond Hodges DATE 9/24/65

FILL SEPTIC TANK AND DISTRIBUTION BOX WITH WATER BEFORE CALLING FOR AN INSPECTION. COVER NO WORK UNTIL INSPECTED AND APPROVED.

NEITHER THE HOWARD COUNTY COMMISSIONERS NOR THE HEALTH DEPARTMENT IS RESPONSIBLE FOR THE SUCCESSFUL OPERATION OF ANY SYSTEM.

A 10924

A 5856-A

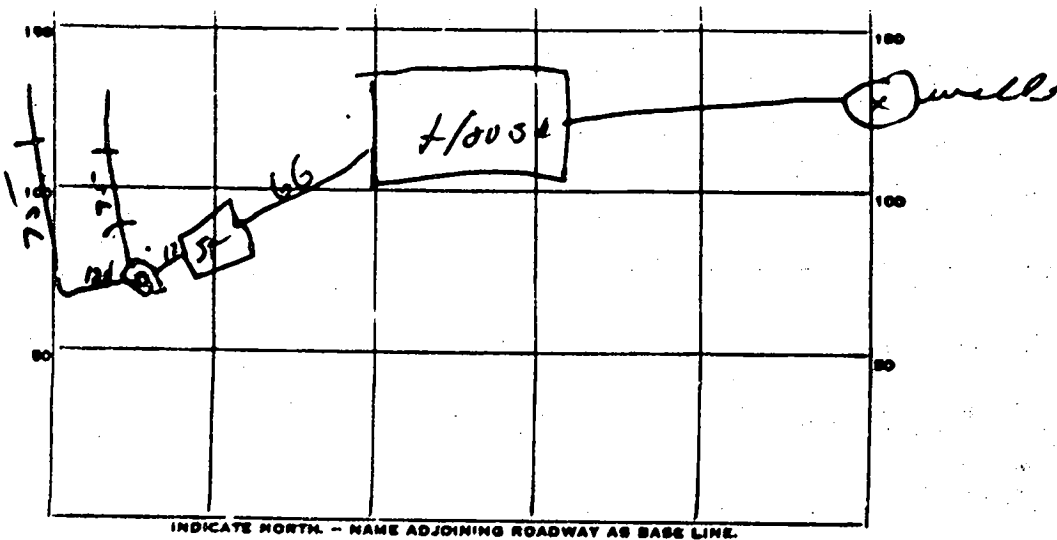

PERMIT CARD OK

SEPTIC TANK LEVEL 0.4

CLEANOUTS man hole

DISTRIBUTION BOX LEVEL 0.12

TILE FIELD DEPTH 2 FT. TRENCH WIDTH 3 FT.

GRAVEL DEPTH 12 IN. TOTAL LENGTH 150 FT.

NUMBER OF TRENCHES 2 TOTAL BOTTOM AREA 450 sq ft

SEEPAGE PITS, INSIDE DIAMETER _____ FT. DEPTH BELOW INLET _____ FT.

ABSORBENT AREA _____ SQ. FT.

REMARKS 11/23/15 - tiles too close together - should be 1/2 to 1/4" gaps
tile joints between not stopped along

*the right side of the house as seen when standing
south of the house and facing the front of the
house. Run 12 1/2' - 13' along the side of the house*

TO: THE COUNTY HEALTH OFFICER *Place the Water Well at least 250*
ELLICOTT CITY, MARYLAND *ft from the site. Elevation higher*
I, HEREBY, APPLY FOR THE NECESSARY TESTS IN ORDER TO CONSTRUCT OR RECONSTRUCT A SEWAGE
DISPOSAL SYSTEM. *Elevation 120' - 125' - 130'*

PROPERTY OWNER Lyrr W. Barth

ADDRESS Rt 3 - Box 745 - Mt. Airy, Md. PHONE U. S. 654

PROPERTY LOCATION: M. A. Builders' Contractors - 8291770

SUBDIVISION _____ LOT NO. _____

ROAD AND DESCRIPTION Dorsey Hill Rd - 6/10 mile east of Rt. #97

OCCUPANT _____ PHONE _____

PERSON TO CONSTRUCT SYSTEM _____

ADDRESS _____ PHONE _____

SIZE OF LOT 2 1/2 acres TYPE BLDG. 4
NUMBER OF BEDROOMS

IF NOT SINGLE RESIDENCE DESCRIBE _____

SIGNATURE OF APPLICANT _____

APPROVED BY Theresa [Signature] FOR T. [Signature] DATE 24 Sept 65
NAME OF OFFICER

REJECTED BY _____ FOR _____ DATE _____
NAME OF SYSTEM

HOLD PENDING FURTHER TESTS _____ DATE _____

REASONS FOR REJECTION OR HOLDING _____

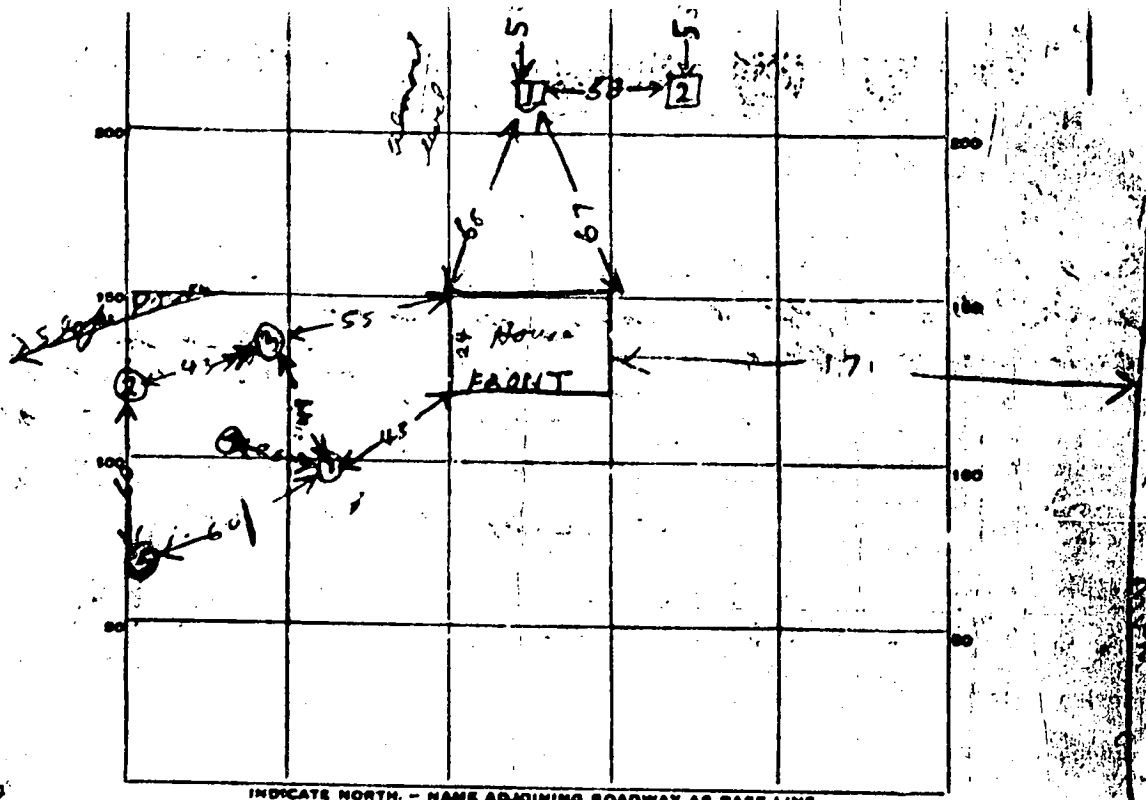

INDICATE NORTH - NAME ADJOINING ROADWAY AS BASE LINE.

DATE	TEST NO.	DEPTH	PRE-WET		TEST - 1" DROP		TIME
			START	STOP	START	STOP	
9/23/68	1	4	949	950	950	953	3
9/23/68	2	4	955	957	957	1001	4
9/23/68	3	4	1009	1009 1/2	1009 1/2	1010	1/2
9/23/68	4	9	1017	1017 1/2	1017 1/2	1020	2 1/2
9/23/68	5	4	1019	1021	1021	1023	2

20 seconds - felt 7 inches in 20

4.36 min

3270

SEQUENCE NO. (OEP USE ONLY)

STATE OF MARYLAND PERMIT TO DRILL WELL

please print or type

OEP PERMIT NUMBER

HO-81-0865

PERMIT NUMBER IS TO BE PUNCHED IN COLUMNS 3-6 ON ALL CARDS

Date Received

8/15/85

OWNER INFORMATION

ABERNICK, M.L. 14679 DORSEY MILL RD CLARKSDOWN MD 21877

DRILLER INFORMATION

Driller's Name: Donald H. Wagner, License No. 238, Firm Name: Wagner Drilling, Address: 5512 Ridge Rd. Mt. Airy, Md., Signature: Donald H. Wagner, Date: 2/14/85

WELL INFORMATION

APPROX. PUMPING RATE (GAL. PER MIN.): 5, AVERAGE DAILY QUANTITY NEEDED (GAL. PER DAY): 500

USE FOR WATER (CIRCLE APPROPRIATE BOX)

- HOME (SINGLE OR DOUBLE HOUSEHOLD UNIT ONLY), FARMING (LIVESTOCK WATERING & AGRICULTURAL IRRIGATION), INDUSTRIAL, COMMERCIAL, STATE AND FEDERAL GOV. OTHER (REQUIRES APPROPRIATION PERMIT), PUBLIC OR PRIVATE WATER COMPANY (REQUIRES APPROPRIATION PERMIT AND STATE HEALTH DEPARTMENT APPROVAL), TEST, OBSERVATION, MONITORING (MAY REQUIRE APPROPRIATION PERMIT)

APPROXIMATE DEPTH OF WELL: 100 FEET

APPROXIMATE DIAMETER OF WELL: 6 INCH

METHOD OF DRILLING (circle one)

BORED (or Augered), JETTED, Jetted & DRIVEN, AIR-ROTary, AIR-PERcussion, ROTARY (Hydraulic Rotary), CABLE, REVerse-ROTary, Drive-POINT

REPLACEMENT OR DEEPEMED WELLS (CIRCLE APPROPRIATE BOX)

N THIS WELL WILL NOT REPLACE AN EXISTING WELL, Y THIS WELL WILL REPLACE A WELL THAT WILL BE ABANDONED AND SEALED, S THIS WELL WILL REPLACE A WELL THAT WILL BE USED AS A STANDBY, D THIS WELL WILL DEEPEMED AN EXISTING WELL, PERMIT NUMBER OF WELL TO BE REPLACED OR DEEPEMED (IF AVAILABLE):

Not to be filled in by driller (OEP USE ONLY)

APPROP. PERMIT NUMBER: GAP

FORCE: US, PERMIT NO.: HO-81-0865

SPECIAL CONDITIONS

LOCATION OF WELL

HOWARD COUNTY, SUBDIVISION, SECTION 44, LOT 48, 52 NEAREST TOWN: GLENWOOD, MILES FROM TOWN: 2 3/4 MI

DIRECTION OF WELL FROM TOWN (CIRCLE BOX)

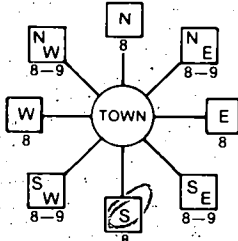

14179 Dorsey Mill Road, NEAR WHAT ROAD

ON WHICH SIDE OF ROAD (CIRCLE APPROPRIATE BOX)

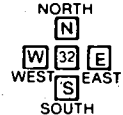

DISTANCE FROM ROAD: 350 FT

NOT TO BE FILLED IN BY DRILLER HEALTH DEPARTMENT APPROVAL

COUNTY NAME: HOWARD, COUNTY NO., OEP SIGNATURE: J. Stamen, DATE ISSUED: 8/15/85, NORTH GRID: 520000, EAST GRID: 0775000

SHOW MAJOR FEATURES OF BOX & LOCATE WELL WITH AN X

SOURCES OF DRILLING WATER: 1. WELL

WRITE THE BOX NUMBER FROM THE MAP HERE

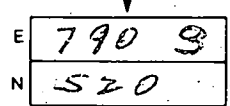

DRAW A SKETCH BELOW SHOWING LOCATION OF WELL IN RELATION TO NEARBY TOWNS AND ROADS AND GIVE DISTANCE FROM WELL TO NEAREST ROAD JUNCTION

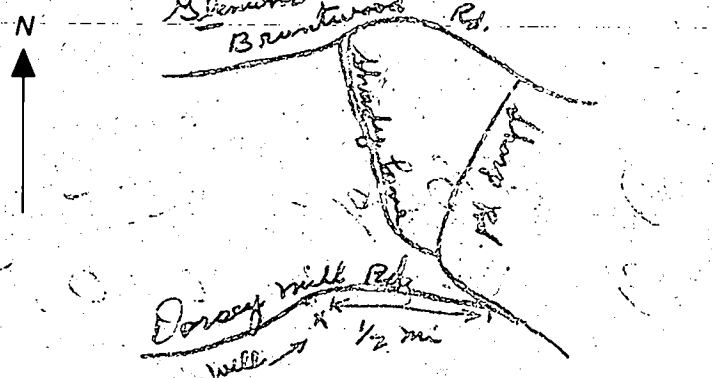

21185 WELL OK SEE OTHER SIDE R. Hodge Replacement Well

HOUSE

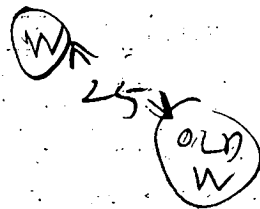

DORSEY MILL RD

- ① 22 FT CASING
- ② 22 FT OPEN HOLE MEASURED WITH A STRING
- ③ THIS IS A REPLACEMENT WELL
OLD WELL WENT DRY
- ④ SEPTIC SYSTEM NOT NEAR WELL
- ⑤ JOE MAYM SAID HE WILL ABANDON
& SEAL OLD WELL LATER AFTER
PUMP IS REMOVED & PLACED IN NEW WELL
- ⑥ 6 Bags
- ⑦ WELC OJ

B. Hodges

W E L L P U M P I N S P E C T I O N

Owner's Name: Lynn Abendroth
14679 Dorsey Mill Road
Address: Glenwood, Maryland 21738

Location of Property: 14679 Dorsey Mill Road

Well Tag Number; HD-81-0865

Plumber or Certified Pump Installer: Zepp Plumbing & Heating, Inc.
12447 Route 108
Clarksville, Maryland 21029

Phone Number: 531-6712

License Number: 1782

Receipt Number: 35105

Date: 3/8/85

Comments: OK TO PROCEED WITH INSTALLATION 3/8/85 CWJ

Inspection:

Date Well Pump Inspection was approved:

Inspector: