

12/16/96 10:00

# PERMIT

## SEWAGE DISPOSAL SYSTEM

### DEPARTMENT OF HEALTH AND MENTAL HYGIENE

04-328507

P 57567B

A REPAIR

DISTRICT \_\_\_\_\_

DATE 11/21/96

DATE SYSTEM APPROVED 12/16/96

INSPECTOR M. Ripkin

HOWARD COUNTY HEALTH DEPARTMENT  
BUREAU OF ENVIRONMENTAL HEALTH  
~~XXXXXXX~~

# INDEXED

Olen Ketterman

IS PERMITTED TO INSTALL \_\_\_\_\_ ALTER X

ADDRESS 14960 Route 144, Woodbine, Maryland 21797 PHONE 442-1336

SUBDIVISION Lisbon Meadows LOT 2 ROAD 15817 Bellis Drive

PROPERTY OWNER Christopher Renken

ADDRESS 15817 Bellis Drive  
Woodbine, Maryland 21797

SEPTIC TANK CAPACITY 1000 GALLONS

NUMBER OF BEDROOMS 3

180 SQUARE FEET PER BEDROOM (REQ. BY OWNER)

LINEAR FEET OF TRENCH REQUIRED 68±

REPAIR - PURPOSE - Septic System Has Failed

Call for inspection when ground is opened so sanitarian can recommend repair.  
11/21/96

INLET 4' BOT 12', 8' STONE

PLANS APPROVED BY \_\_\_\_\_ DATE \_\_\_\_\_

COVER NO WORK UNTIL INSPECTED AND APPROVED

NEITHER THE HOWARD COUNTY COUNCIL NOR THE HEALTH DEPARTMENT IS RESPONSIBLE FOR THE SUCCESSFUL OPERATION OF ANY SYSTEM

NOTE: CLEANOUT REQUIRED EVERY 70 FEET OF SEWER LINE AND/OR AT 90° SWEEPS IN LINES FROM HOUSE TO DRAIN FIELDS, 90° ELBOWS NOT ACCEPTABLE.

NOTE: ALL PARTS OF SEPTIC SYSTEMS (I.E. TANK, DISTRIBUTION BOX TRENCHES) TO BE 100 FEET FROM WELL (UNLESS OTHERWISE SPECIFICALLY AUTHORIZED)

NOTE: IF DEEP TRENCH(ES) ARE USED CALL FOR INSPECTION BEFORE AND AFTER PLACING GRAVEL IN TRENCH(ES)

NOTE: NO DRY WELL SHALL EXCEED 15 FOOT IN DIAMETER NO ABSORPTION TRENCH TO EXCEED 100 FEET IN LENGTH

NOTE: ALL PIPE FROM HOUSE TO SEPTIC TANK MUST BE CAST IRON OR SCHEDULE 35/40 PVC OR ABS

PERMIT VOID AFTER TWO YEARS

NOTE: INSTALL STAND PIPE ON SEPTIC TANK AND DRY WELL STAND PIPES MUST BE 6 INCHES IN DIAMETER CAST IRON, CONCRETE OR TERRA COTTA OR PVA OR ABS ACCEPTED. IF TOP OF SEPTIC TANK IS DEEPER THAN 3 FEET, MANHOLE TO GRADE REQUIRED.

NOTE: DISTRIBUTION BOXES MUST HAVE BAFFLES

**\*INSTALLER IS RESPONSIBLE FOR OBTAINING FINAL APPROVAL ON THIS PERMIT**

P 57567B

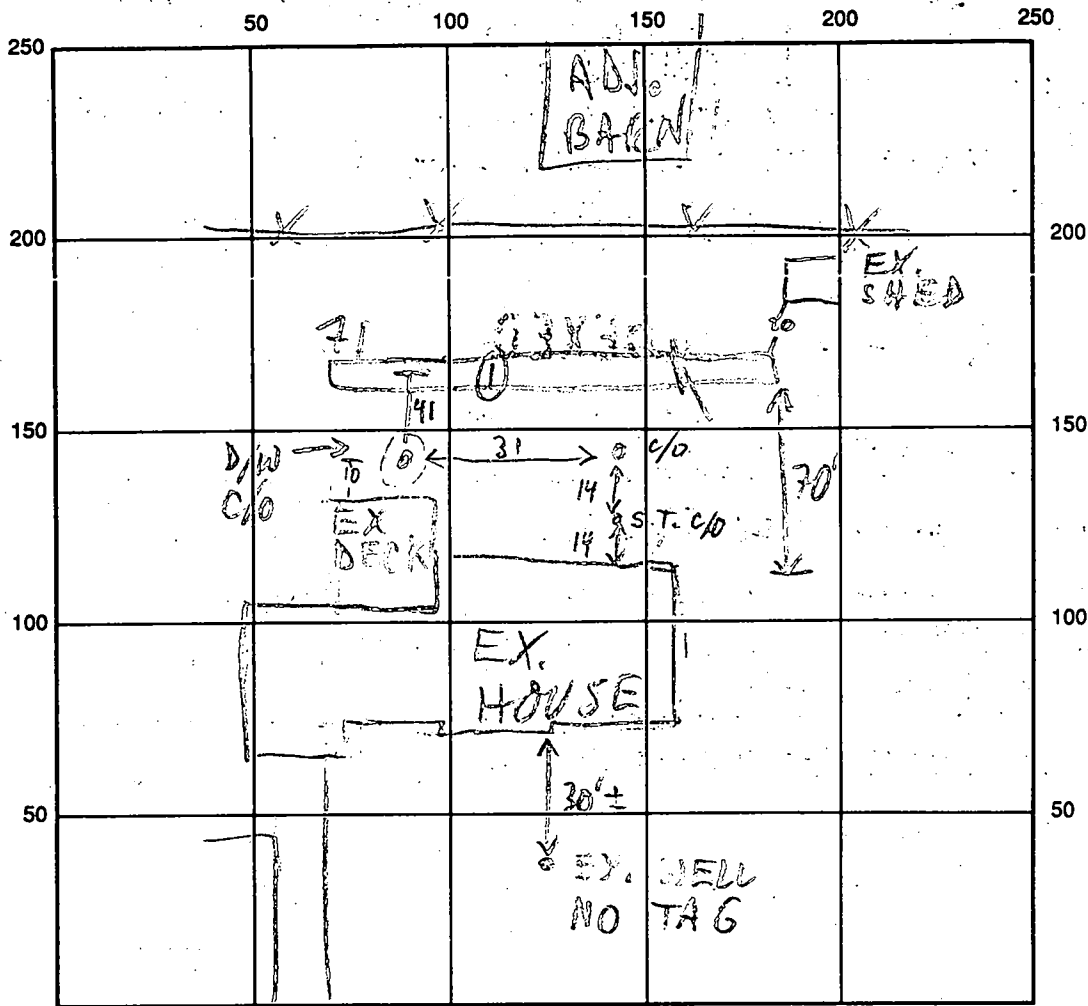

INDICATE NORTH - NAME ADJOINING ROADWAY AS BASE LINE

SEPTIC TANK LEVEL 1000 GAL? CLEANOUTS ALL OK

DISTRIBUTION BOX LEVEL     

DRAIN FIELD/TITLE DEPTH 11 1/2 FT. TRENCH WIDTH 2 FT. INLET DEPTH 4 FT.

EFFECTIVE GRAVEL DEPTH 7 1/2 FT. TOTAL LENGTH 71 FT.

NUMBER OF TRENCHES 1 ONE SIDEWALL/BOTTOM AREA 525± SQ. FT.

DRYWALL INSIDE DIAMETER      FT. EFFECTIVE DEPTH BELOW INLET      FT.

ABSORBENT AREA 525± SQ. FT.

REMARKS: 12/16/96 #1 OK TO START MR

12/16/96 #2 OK TO FINISH & COVER MR

DATE SYSTEM APPROVED 12/16/96 INSPECTOR M. Ripkin

④  
 0992  
 pink  
 si  
 el m  
 4m  
 sa m  
 20%  
 shale  
 frags

# PERMIT

SEWAGE DISPOSAL SYSTEM

MARYLAND STATE DEPARTMENT OF HEALTH

HOWARD COUNTY

## INDEXED

ELLICOTT CITY

DISTRICT 1st

DATE 9/10/73

*11/21/73  
around 2:30 P.M.  
if possible*

*11-21-73*  
18957

~~Milke Brothers, Inc.~~

ADDRESS Old Washington Rd., Box 6, Ellicott City, Md. PHONE 541-5759

A SEWAGE DISPOSAL SYSTEM LOCATED AT \_\_\_\_\_

SUBDIVISION Lisbon Meadows ROAD Belle Drive LOT 2, Blk. A, Sec. 8

PROPERTY OWNER Stephen B. Springer

ADDRESS 4029 Old Columbia Pike, Ellicott City, Md.

SPECIFICATIONS 3 bedrooms

DRAIN FIELD \_\_\_\_\_ DEPTH \_\_\_\_\_ FEET. BOTTOM AREA \_\_\_\_\_ SQ. FT.

SEEPAGE PITS \_\_\_\_\_ ABSORBENT SIDE-WALL AREA \_\_\_\_\_ SQ. FT.

SEPTIC TANK CAPACITY 1000 GALLONS

FOR GARBAGE GRINDER, INCREASE DISPOSAL AREA 25% & TANK CAPACITY 50%

OTHER DRY WELL - Dry well to be 120 sq. ft. of absorbent sidewall area below the inlet pipe per bedroom. Inlet pipe to begin 5 ft. below original grade. Maximum depth of dry well to be 12 ft. below original grade. Place dry well 125 ft. from the front lot line and 125 ft. from the right side of the lot as seen when facing the lot from Belle Drive.

NOTE: ALL PIPE FROM HOUSE TO DRY WELL MUST BE CAST IRON.  
PERMIT VOID AFTER THREE YEARS.

NOTE: INSTALL STAND PIPE ON SEPTIC TANK AND DRY WELL.

PLANS APPROVED BY James T. Wright & Raymond Hodges DATE 4/21/71 & 8/14/72

FILL SEPTIC TANK AND DISTRIBUTION BOX WITH WATER BEFORE CALLING FOR AN INSPECTION. COVER NO WORK UNTIL INSPECTED AND APPROVED.

NEITHER THE HOWARD COUNTY COMMISSIONERS NOR THE HEALTH DEPARTMENT IS RESPONSIBLE FOR THE SUCCESSFUL OPERATION OF ANY SYSTEM.

*18957*

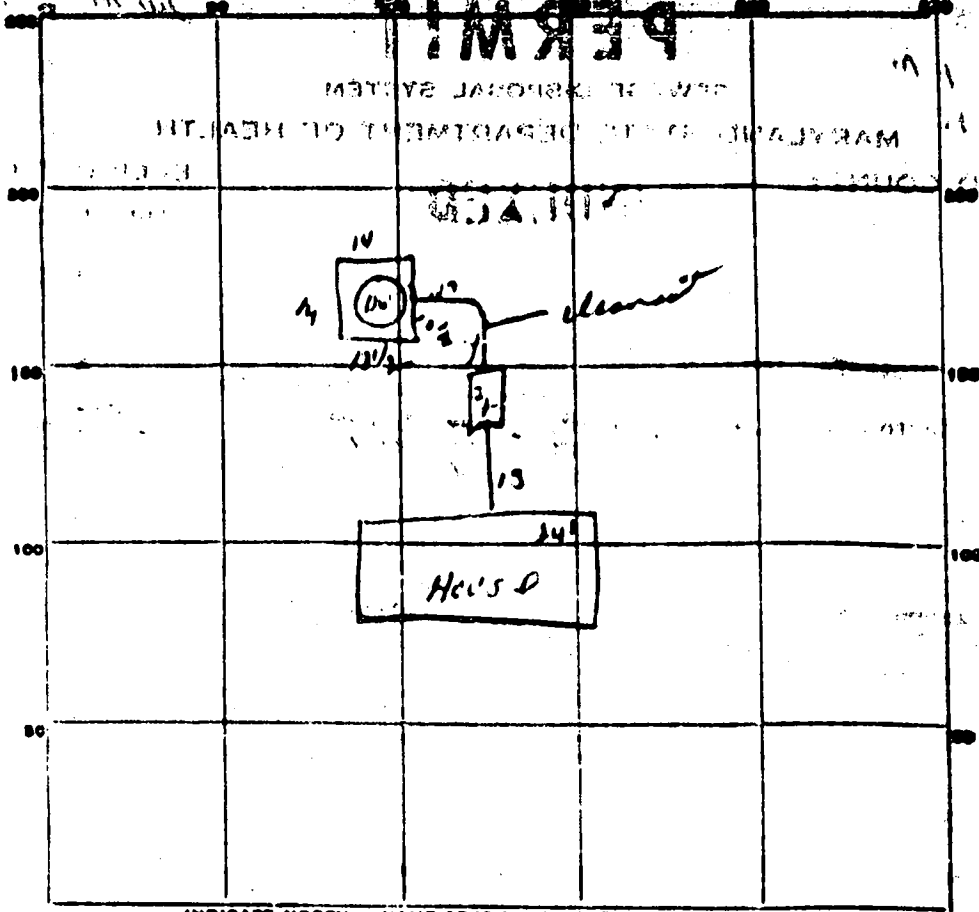

INDICATE NORTH. - NAME ADJOINING ROADWAY AS BASE LINE.

*P. Miller*

PERMIT CARD 112

SEPTIC TANK, LEVEL C.K. CLEANOUTS C. 12

DISTRIBUTION BOX, LEVEL \_\_\_\_\_

TILE FIELDS, DEPTH \_\_\_\_\_ FT. TRENCH WIDTH \_\_\_\_\_ FT.

GRAVEL DEPTH \_\_\_\_\_ IN. TOTAL LENGTH \_\_\_\_\_ FT.

NUMBER OF TRENCHES \_\_\_\_\_ TOTAL BOTTOM AREA \_\_\_\_\_

SEEPAGE PITS, <sup>Permit</sup> INSIDE DIAMETER 54 FT. DEPTH BELOW INLET 7 FT.

ABSORBENT AREA 378 SQ. FT.

REMARKS \_\_\_\_\_  
 \_\_\_\_\_  
 \_\_\_\_\_  
 \_\_\_\_\_  
 \_\_\_\_\_

DATE SYSTEM APPROVED 11/21/73 INSPECTOR J.W. Morgan

# APPLICATION

SEWAGE DISPOSAL TESTING

A 14947

F \_\_\_\_\_

MARYLAND STATE DEPARTMENT OF HEALTH

HOWARD COUNTY

ELLICOTT CITY

DISTRICT A

DATE 11/7/69

TO: THE COUNTY HEALTH OFFICER  
ELLICOTT CITY, MARYLAND

I, HEREBY, APPLY FOR THE NECESSARY TESTS IN ORDER TO CONSTRUCT (OR RECONSTRUCT) A SEWAGE DISPOSAL SYSTEM.

PROPERTY OWNER Fred B. & Ann L. Ables

ADDRESS Rt. 1, Woodbine, Maryland 21797

PHONE Mr. Podolak  
848-2229

PROPERTY LOCATION:

SUBDIVISION Labor Meadows

LOT NO. 2A sect 2

ROAD AND DESCRIPTION Glenn Drive

OCCUPANT \_\_\_\_\_

PHONE \_\_\_\_\_

PERSON TO CONSTRUCT SYSTEM \_\_\_\_\_

ADDRESS \_\_\_\_\_

PHONE \_\_\_\_\_

SIZE OF LOT 42,500 sq. ft.

TYPE BLDG. 3 of 4

NUMBER OF STORIES

IF NOT SINGLE RESIDENCE DESCRIBE \_\_\_\_\_

SIGNATURE OF APPLICANT /s/ Leon Podolak

APPROVED BY \_\_\_\_\_

FOR \_\_\_\_\_

DATE \_\_\_\_\_

(KIND OF SYSTEM)

REJECTED BY \_\_\_\_\_

FOR \_\_\_\_\_

DATE \_\_\_\_\_

(KIND OF SYSTEM)

HOLD PENDING FURTHER TESTS \_\_\_\_\_

DATE \_\_\_\_\_

REASONS FOR REJECTION OR HOLDING \_\_\_\_\_

## THIS IS NOT A PERMIT

# APPLICATION

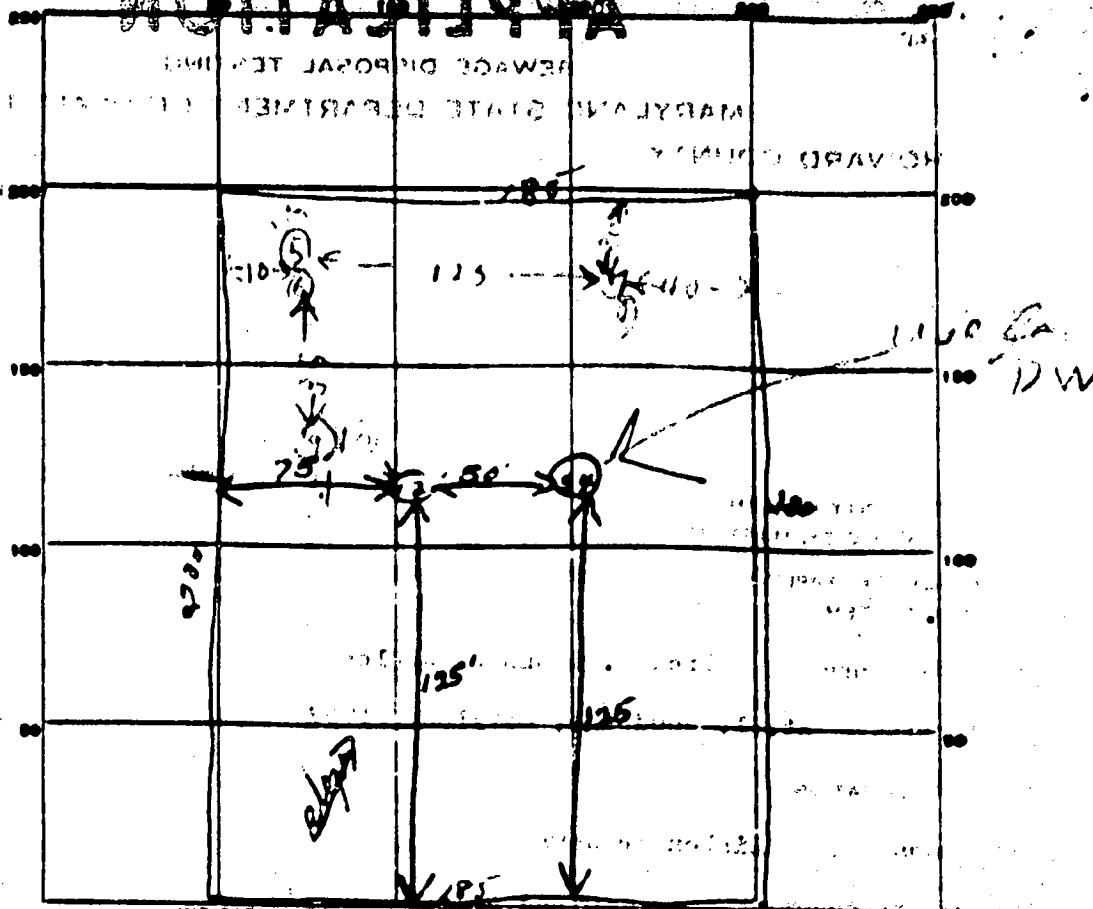

INDICATE NORTH - NAME ADJOINING ROADWAY AS CASE LINE

*O. Land Area*

DATE	TEST NO.	DEPTH	PRE-WET		TEST - 1" DROP		TIME
			START	STOP	START	STOP	
<i>11/10/49</i>	1	12'	11:58	11:02	11:02	11:10	8 min
	2	5'	11:52	11:11	11:11	11:21	10 min
	3	12'	11:15	11:20	11:20	11:26	6 min
	4	5'	11:17	11:20	11:20	11:23	3 min
<i>11/10/49</i>	5	12 1/2'	10:21	10:47	10:47	11:02	15 min
	6	6 1/2'	10:33	10:44	10:44	10:57	13 min
	7	5'	10:51	10:55	10:55	10:58	3 min
	8	5'	10:57	10:58	10:58	11:00	2 min
	9	12'	11:02	11:12	11:12	11:27	15 min
	10	5'	11:12	11:13	11:13	11:19	6 min

*out  
27*

SOIL ANGLES FINDING

TESTED BY

REMARKS

*[Handwritten signatures and notes in the bottom section]*

0291

STATE OF MARYLAND  
WATER RESOURCES ADMINISTRATION  
TAVES STATE OFFICE BLDG., ANNAPOLIS, MD. 21401  
WELL COMPLETION REPORT

THIS REPORT MUST BE SUBMITTED WITHIN 15 DAYS AFTER WELL COMPLETION

FILL IN THIS FORM COMPLETELY

COUNTY NUMBER

DATE RECEIVED  
0-13

DATE WELL COMPLETED  
05/10-73

DEPTH OF WELL  
100 (TO NEAREST FOOT)

PERMIT NO. FROM "PERMIT TO DRILL WELLS"  
40-73-2170

DRILLER IDENTIFICATION NO. 217

OWNER  
Springer  
1403 9th Columbia

POST OFFICE  
Baltimore City Md

WELL LOG  
STATE THE KIND OF FORMATIONS PENETRATED, THEIR COLOR, GRAIN, THICKNESS AND IF WATER-BEARING

GRouting RECORD

WELL HAS BEEN GRouted (CHECK APPROPRIATE BOX)  
TYPE OF GRouting MATERIAL (CHECK ONE)  
CEMENT  GENTLE SLAY   
NO. OF BAGS 4 NO. OF POUNDS 376  
GALLONS OF WATER 24  
DEPTH OF GROUT SEAL (TO NEAREST FOOT)  
FROM 2 FT. TO 19 FT.  
ENTERED IF FROM SURFACE

CASING RECORD  
Casing Type (INSERT APPROPRIATE CODE BELOW)  
STEEL  CO CONCRETE   
PL PLASTIC  OT OTHER   
MAIN CASING TYPE  ST  
NOMINAL DIAMETER TOP IMMEDIATELY (NEAREST INCH) 6  
TOTAL DEPTH OF MAIN CASING (NEAREST FOOT) 21

OTHER CASING (IF USED)  
DIAMETER (INCH) DEPTH (FEET)  
SCREEN TYPE (CHECK ONE)  
STEEL  BR BRASS  HO HOPE   
PL PLASTIC  OT OTHER

SCREEN RECORD  
SCREEN TYPE (CHECK ONE)  
STEEL  BR BRASS  HO HOPE   
PL PLASTIC  OT OTHER

DEPTH (NEAREST WHOLE FOOT)  
1 2 3 4 5 6 7 8 9 10 11 12 13 14 15 16 17 18 19 20 21 22 23 24 25 26 27 28 29 30 31 32 33 34 35 36 37 38 39 40 41 42 43 44 45 46 47 48 49 50 51 52 53 54 55 56 57 58 59 60 61 62 63 64 65 66 67 68 69 70 71 72 73 74 75 76 77 78 79 80 81 82 83 84 85 86 87 88 89 90 91 92 93 94 95 96 97 98 99 100

DIAMETER OF SCREEN (NEAREST INCH)

GRAVEL PACK

IF WELL DRILLED WAS A FLOWING WELL CIRCLE BOX

FOR USE ONLY (NOT TO BE FILLED IN BY DRILLER)  
TELESCOPE CASING LOG INDICATOR OTHER DATA AVAILABLE

PUMPING TEST

WATER PUMPED (TO NEAREST GALLON) 2  
PUMPING RATE (GALLONS PER MINUTE TO NEAREST GALLON) 20  
METHOD USED TO MEASURE PUMPING RATE ROTARY  
WATER LEVEL (DISTANCE FROM LAND SURFACE) BEFORE PUMPING 30 (NEAREST FOOT)  
WHEN PUMPING 90 (NEAREST FOOT)  
TYPE OF PUMP USED (CHECK ONE)  
A AIR LIFT  B PISTON  T TURBINE   
C CENTRIFUGAL  R ROTARY  O OTHER (SPECIFY BELOW)   
J JET  S SUBMERSIBLE

PUMP INSTALLED

TYPE OF PUMP (INSERT APPROPRIATE LETTER IN BOX - SEE ABOVE: A, C, J, P, R, S, T, O)  
DRILLER WILL INSTALL PUMP (CHECK APPROPRIATE BOX)  
CAPACITY: GALLONS PER MINUTE (TO NEAREST GALLON)  
PUMP HORSE POWER

CASING HEIGHT (CHECK APPROPRIATE BOX AND ENTER CASING HEIGHT)  
A ABOVE LAND SURFACE  
B BELOW LAND SURFACE

LOCATION OF WELL ON LOT  
SHOW PERMANENT STRUCTURE SUCH AS BUILDINGS, SEPTIC TANKS, AND/OR OTHER LAND MARKS AND INDICATE NOT LESS THAN TWO DISTANCES (MEASUREMENTS TO WELL).

BROWN SAND STONE 3 100

well logs

M.D. 144  
Baltimore  
Dr. Springer

CIRCLE APPROPRIATE BOXES  
I HAVE READ AND APPROVED AND SEALED WHEN THIS WELL WAS COMPLETED  
TELEPHONE NO. OBTAINED  
WELL WILL BE CONVERTED TO PRODUCTION WELL  
I HEREBY CERTIFY THAT I HAVE COMPLIED WITH ALL REQUIREMENTS OF THE ABOVE-CAPTIONED "PERMIT TO DRILL WELLS" AND THAT INFORMATION CONTAINED HEREIN IS TRUE, ACCURATE, AND COMPLETE TO THE BEST OF MY KNOWLEDGE, INFORMATION AND BELIEF.

G. P. M. WELLS & SON  
2400 Commercial St  
Baltimore, Md.

# BELLIS DRIVE

185'

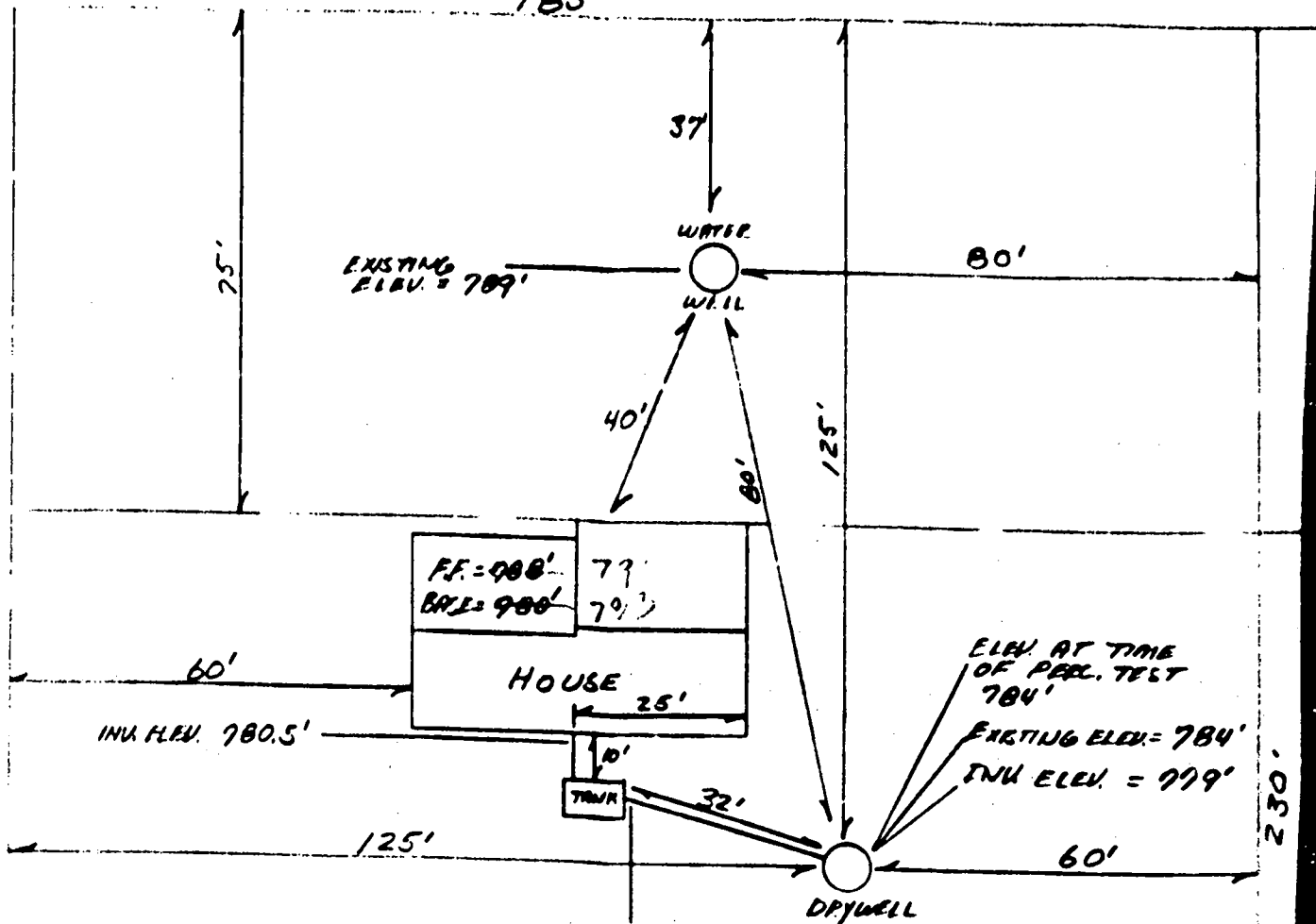

INW. ELEV. 780.5'

F.F. = 988'  
BASE = 980'

HOUSE

10'

TANK

DRYWELL

INW. ELEV. = 779.7'  
EXISTING ELEV. = 784'

ELEV. AT TIME  
OF PERC. TEST  
784'  
EXISTING ELEV. = 784'  
INW. ELEV. = 779.7'



LISBON MEADOWS SECTION 2  
BLOCK A LOT #2

185'