

8/19/96 2:30
3:30

PERMIT

SEWAGE DISPOSAL SYSTEM

DEPARTMENT OF HEALTH AND MENTAL HYGIENE

02-232065

P 57079

A REPAIR

DISTRICT _____

DATE 8-19-96

DATE SYSTEM APPROVED 8-19-96

INSPECTOR DKS

HOWARD COUNTY HEALTH DEPARTMENT

BUREAU OF ENVIRONMENTAL HEALTH

~~XXXXXXXX~~ 313-2640

INDEXED

Charles Jenkins IS PERMITTED TO INSTALL _____ ALTER X

ADDRESS 7670 Smith's Private Road Sykesville, MD 21784 PHONE 465-6646

SUBDIVISION _____ LOT _____ ROAD 8599 Old Frederick Road

PROPERTY OWNER Fischer
ADDRESS 8599 Old Frederick Road

SEPTIC TANK CAPACITY 1000 GALLONS

NUMBER OF BEDROOMS 3

N/A SQUARE FEET PER BEDROOM

LINEAR FEET OF TRENCH REQUIRED N/A

REPAIR - PURPOSE - REPLACE COLLAPSED METAL TANK.

Call for inspection when ground is opened so sanitarian can approve size and location of tank.

PLANS APPROVED BY Donna K Soe DATE 8/19/96

COVER NO WORK UNTIL INSPECTED AND APPROVED

NEITHER THE HOWARD COUNTY COUNCIL NOR THE HEALTH DEPARTMENT IS RESPONSIBLE FOR THE SUCCESSFUL OPERATION OF ANY SYSTEM

NOTE: CLEANOUT REQUIRED EVERY 70 FEET OF SEWER LINE AND/OR AT 90° SWEEPS IN LINES FROM HOUSE TO DRAIN FIELDS, 90° ELBOWS NOT ACCEPTABLE.

NOTE: ALL PARTS OF SEPTIC SYSTEMS (I.E. TANK, DISTRIBUTION BOX TRENCHES) TO BE 100 FEET FROM WELL (UNLESS OTHERWISE SPECIFICALLY AUTHORIZED)

NOTE: IF DEEP TRENCH(ES) ARE USED CALL FOR INSPECTION BEFORE AND AFTER PLACING GRAVEL IN TRENCH(ES)

NOTE: NO DRY WELL SHALL EXCEED 15 FOOT IN DIAMETER NO ABSORPTION TRENCH TO EXCEED 100 FEET IN LENGTH

NOTE: ALL PIPE FROM HOUSE TO SEPTIC TANK MUST BE CAST IRON OR SCHEDULE 35/40 PVC OR ABS

PERMIT VOID AFTER TWO YEARS

NOTE: INSTALL STAND PIPE ON SEPTIC TANK AND DRY WELL STAND PIPES MUST BE 6 INCHES IN DIAMETER CAST IRON. CONCRETE OR TERRA COTTA OR PVA OR ABS ACCEPTED. IF TOP OF SEPTIC TANK IS DEEPER THAN 3 FEET. MANHOLE TO GRADE REQUIRED.

NOTE: DISTRIBUTION BOXES MUST HAVE BAFFLES

EDG. PERMIT SIGNED

AND RETURNED 5-7-99

Serial # 230117742

detached garage

***INSTALLER IS RESPONSIBLE FOR OBTAINING FINAL APPROVAL ON THIS PERMIT**

57079

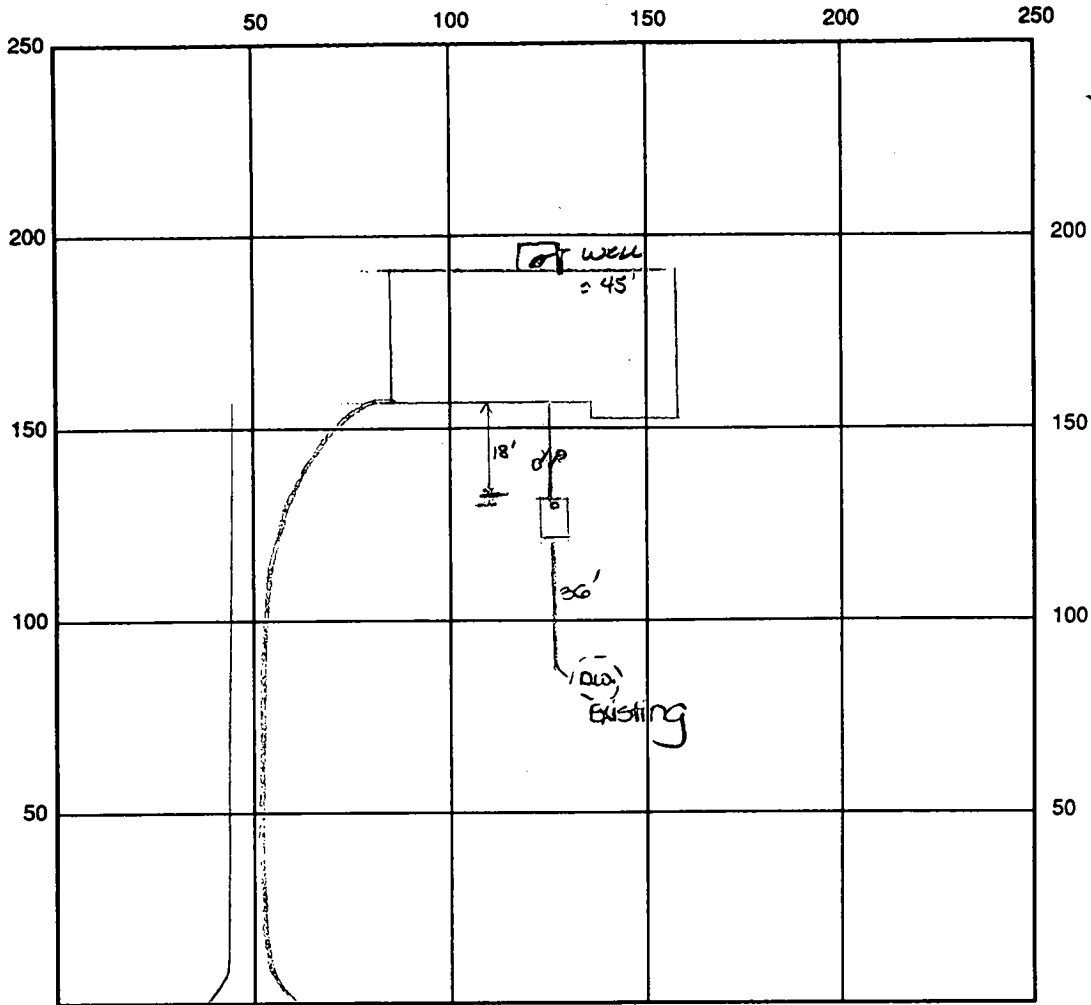

INDICATE NORTH - NAME ADJOINING ROADWAY AS BASE LINE

Old Frederick Rd.

SEPTIC TANK LEVEL OK - 1000 gal CLEANOUTS two at house, one on s.t.

DISTRIBUTION BOX LEVEL _____

DRAIN FIELD/TITLE DEPTH _____ FT. TRENCH WIDTH _____ FT. INLET DEPTH _____ FT.

EFFECTIVE GRAVEL DEPTH _____ FT. TOTAL LENGTH _____ FT.

NUMBER OF TRENCHES _____ ONE SIDEWALL/BOTTOM AREA _____ SQ. FT.

DRYWALL INSIDE DIAMETER _____ FT. EFFECTIVE DEPTH BELOW INLET _____ FT.

ABSORBENT AREA _____ SQ. FT.

REMARKS: 8/19/96 FINAL - OK to cover septic tank and
line. Existing drywell OK, no sign of failure at this
time. DKS

DATE SYSTEM APPROVED 8/19/96 INSPECTOR Donna G. See

2/20/69

PERMIT

SEWAGE DISPOSAL SYSTEM

MARYLAND STATE DEPARTMENT OF HEALTH

HOWARD COUNTY

ELLICOTT CITY

DISTRICT 2

DATE 10/20/69

INDEXED

Carvey Plumbing & Heating IS PERMITTED TO INSTALL ALTER X

ADDRESS 2918 Center Drive, Ellicott City, Md. PHONE 465-2388

SEWAGE DISPOSAL SYSTEM LOCATED AT _____

DIVISION _____ ROAD 6599 Old Frederick Rd. CT _____

PROPERTY OWNER Mr. H. G. Lynn Morris, Sr.

ADDRESS _____

REQUIREMENTS

DRAIN FIELD _____ DEPTH _____ FEET. BOTTOM AREA _____ SQ. FT.

SEEPAGE PITS _____ ABSORBENT SIDE-WALL AREA _____ SQ. FT.

SEPTIC TANK CAPACITY _____ GALLONS

FOR GARBAGE GRINDER, INCREASE DISPOSAL AREA 25% & TANK CAPACITY 50%.

OTHER REPAIR - Deep trench - 11 ft. deep - 50 ft. long with 6 ft. of gravel
below pipe 2 to 3 ft. wide. locate trench 51 ft. from front property line and
21 ft. from driveway.

CALL FOR INSPECTION OF DITCH WHEN EXCAVATED BEFORE ANY GRAVEL IS DUMPED.

PLANS APPROVED BY James T. Wright DATE 10/16/69

FILL SEPTIC TANK AND DISTRIBUTION BOX WITH WATER BEFORE CALLING FOR AN INSPECTION. COVER NO WORK UNTIL INSPECTED AND APPROVED.

NEITHER THE HOWARD COUNTY COMMISSIONERS NOR THE HEALTH DEPARTMENT IS RESPONSIBLE FOR THE SUCCESSFUL OPERATION OF ANY SYSTEM.

NOTIFY THE HEALTH DEPARTMENT 48 HOURS BEFORE EXCAVATIONS ARE TO BE BACK FILLED.

J. Wright

DATE EXPIRES: _____

APPLICATION

SEWAGE DISPOSAL TESTING

MARYLAND STATE DEPARTMENT OF HEALTH

HOWARD COUNTY

ELLICOTT CITY

DISTRICT 0

DATE 10/15/69

Deep trench: 11 feet deep 50 ft long with 6 feet of gravel below pipe. 2 to 3 feet wide. Locate trench 51 feet from front property line and 21 feet from driveway

THE COUNTY HEALTH OFFICER
ELLICOTT CITY, MARYLAND

I, HEREBY, APPLY FOR THE NECESSARY TESTS IN ORDER TO CONSTRUCT OR RECONSTRUCT A SEWAGE DISPOSAL SYSTEM.

PROPERTY OWNER DR H G LYNN MORRIS SR

ADDRESS 8599 OLD PONDWICK RD PHONE 465-3392

PROPERTY LOCATION:

SUBDIVISION _____ LOT NO. _____

ROAD AND DESCRIPTION Route 99

OCCUPANT SAME PHONE _____

PERSON TO CONSTRUCT SYSTEM BARRY RUDOLPH & ASSOCIATES

ADDRESS 2112 CLINE DR PHONE 465-2398

SIZE OF LOT OVER 1 ACRE TYPE BLDG. 3
NUMBER OF BEDROOMS

IF NOT SINGLE RESIDENCE DESCRIBE _____

SIGNATURE OF APPLICANT *C. Young*

APPROVED BY *James T. Wright* FOR Deep trench DATE 10/16/69
KIND OF SYSTEM

REJECTED BY _____ FOR _____ DATE _____
KIND OF SYSTEM

HOLD PENDING FURTHER TESTS _____ DATE _____

REASONS FOR REJECTION OR HOLDING _____

THIS IS NOT A PERMIT

APPLICATION

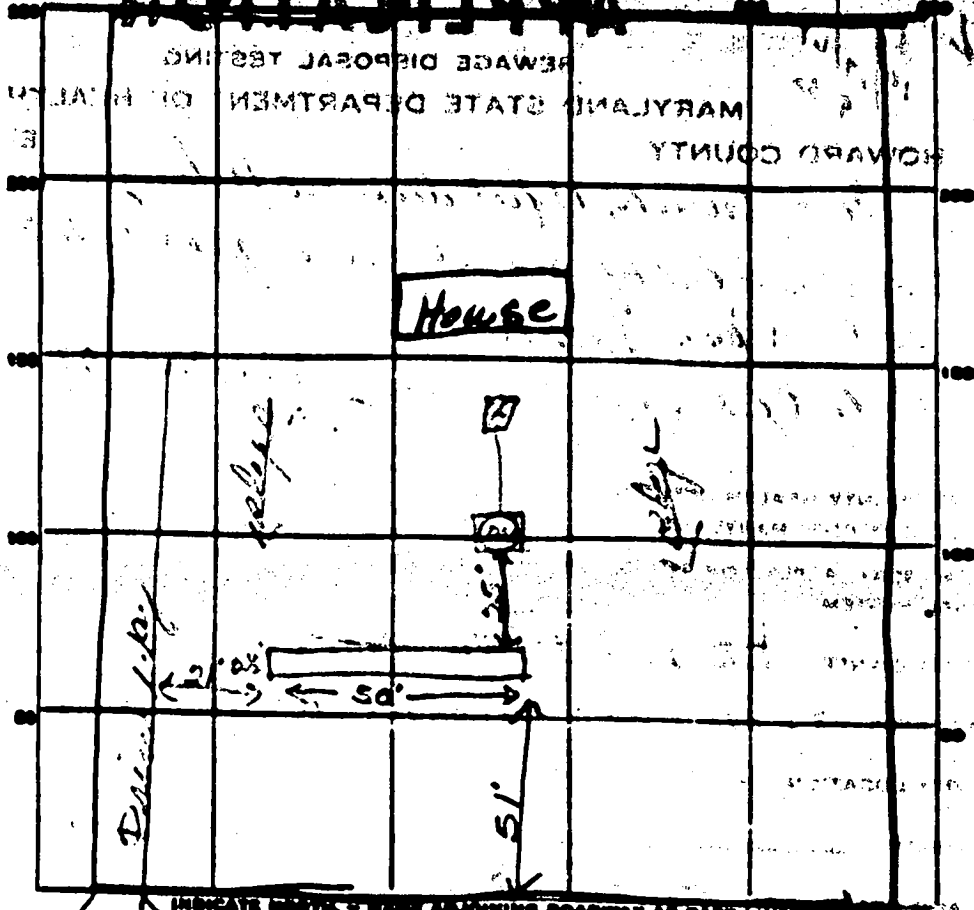

Old Fredrick Rd

DATE	TEST NO.	DEPTH	PRE-WET		TEST - 1" DROP		TIME
			START	STOP	START	STOP	
10/17/60	1	3'	10 ⁴⁶	Slow			
	2	S					
	3						
	4						
	5						
	6		12'	10 ⁵⁸	10 ⁰²	10 ⁰²	10"

SOIL AUGER FINDING _____

TESTED BY [Signature] _____

REMARKS _____

THIS IS NOT A TOW 21 ZHT

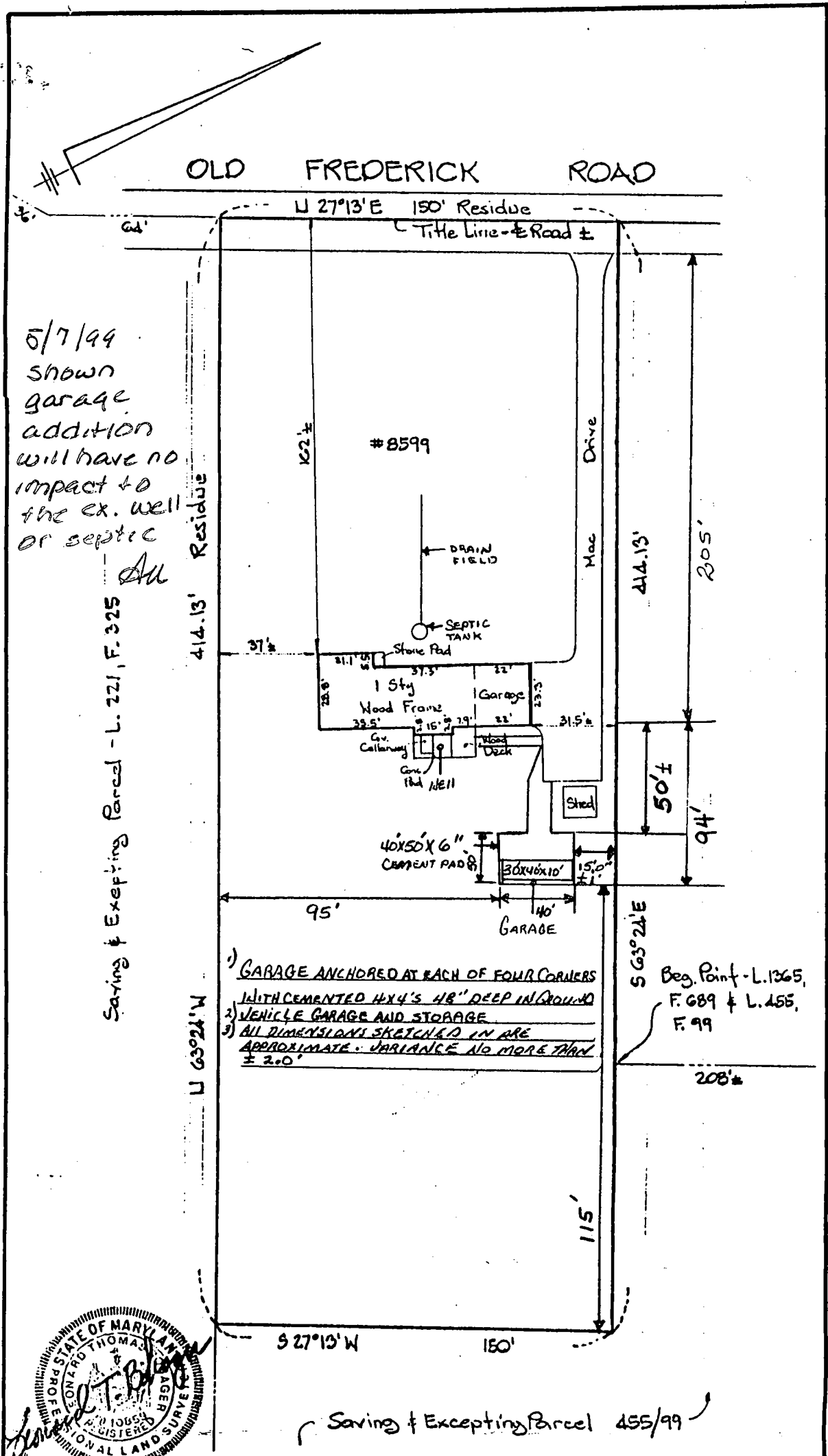

5/7/99
 shown
 garage
 addition
 will have no
 impact to
 the ex. well
 or septic

Saving & Excepting Parcel - L. 221, F. 325

414.13' Residue

U 63°24'W

- 1) GARAGE ANCHORED AT EACH OF FOUR CORNERS WITH CEMENTED HX4'S 48" DEEP IN GROUND
- 2) VEHICLE GARAGE AND STORAGE
- 3) ALL DIMENSIONS SKETCHED IN ARE APPROXIMATE. VARIANCE NO MORE THAN ± 2.0'

Reg. Point - L. 1365, F. 689 & L. 455, F. 99

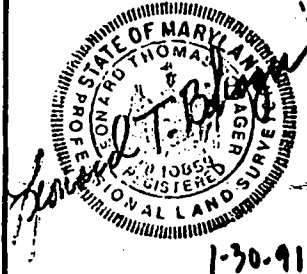

Saving & Excepting Parcel 455/99

THIS IS TO CERTIFY That The Improvements Indicated Hereon Are Located As Shown. This Is Not A Property Line Survey And Should Not Be Used As Such.

THIS IS TO CERTIFY THAT THE PROPERTY SHOWN HEREON IS NOT IN A FLOOD PLAIN.

HICKS ENGINEERING COMPANY, INC. ENGINEERS • SURVEYORS • PLANNERS 200 EAST JOPPA ROAD - SUITE 402 TOWSON, MARYLAND 21204 TELEPHONE: 301/494-0001	LOCATION CERTIFICATION # 8599 OLD FREDERICK ROAD; L. 1365, F. 689 SAVING & EXCEPTING L. 221, F. 325 & L. 455, F. 99; HOWARD Co., MD.		
	DATE: 1/29/91	SCALE: 1"=40'	FILE: /0572