

off 210-69
Lum 69

PERMIT

SEWAGE DISPOSAL SYSTEM

MARYLAND STATE DEPARTMENT OF HEALTH

P 14110

A 13905

2/10/69

HOWARD COUNTY

ELLICOTT CITY

DISTRICT 4

INDEXED

DATE 11/18/68

Robert Dubin Co.

IS PERMITTED TO INSTALL ALTER

ADDRESS Haviland Mill Road, Clarksville, Md. PHONE 286-3432

A SEWAGE DISPOSAL SYSTEM LOCATED AT

SUBDIVISION ROAD ¹⁵²⁵ Daisy Rd. off Rt. 144 LOT $\frac{1}{2}$ mile in on left

PROPERTY OWNER Richard Talley

ADDRESS

SPECIFICATIONS - 4 bedrooms

DRAIN FIELD DEPTH FEET, BOTTOM AREA SQ. FT.

SEEPAGE PITS ABSORBENT SIDE-WALL AREA SQ. FT.

SEPTIC TANK CAPACITY 1,000 GALLONS

FOR GARBAGE GRINDER, INCREASE DISPOSAL AREA 22% & TANK CAPACITY 50%.

OTHER Dry well - 448 sq. ft. absorbent sidewall area to begin below inlet

pipe. Inlet pipe to be 4 to 5 ft. below original grade. Max. depth permitted

for dry well below original grade is 15 ft.

Place dry well at point 132 ft. to left of the beginning of cleared area and 30 ft.

toward Daisy Road - due to rocky ground all pipe must be cast iron.

PERMIT VOID AFTER THREE YEARS.

PLANS APPROVED BY D. W. Monaghan DATE 9/26/68

FILL SEPTIC TANK AND DISTRIBUTION BOX WITH WATER BEFORE CALLING FOR AN INSPECTION. COVER NO WORK UNTIL INSPECTED AND APPROVED.

NEITHER THE HOWARD COUNTY COMMISSIONERS NOR THE HEALTH DEPARTMENT IS RESPONSIBLE FOR THE SUCCESSFUL OPERATION OF ANY SYSTEM.

BLDG. PERMIT SIGNED

AND RETURNED

9/27/68
Serial # 13693
Metcalf & Eddy

NOTIFY THE HEALTH DEPARTMENT 48 HOURS BEFORE EXCAVATIONS ARE TO BE BACK FILLED.

13905

3.14
 226
 0.72

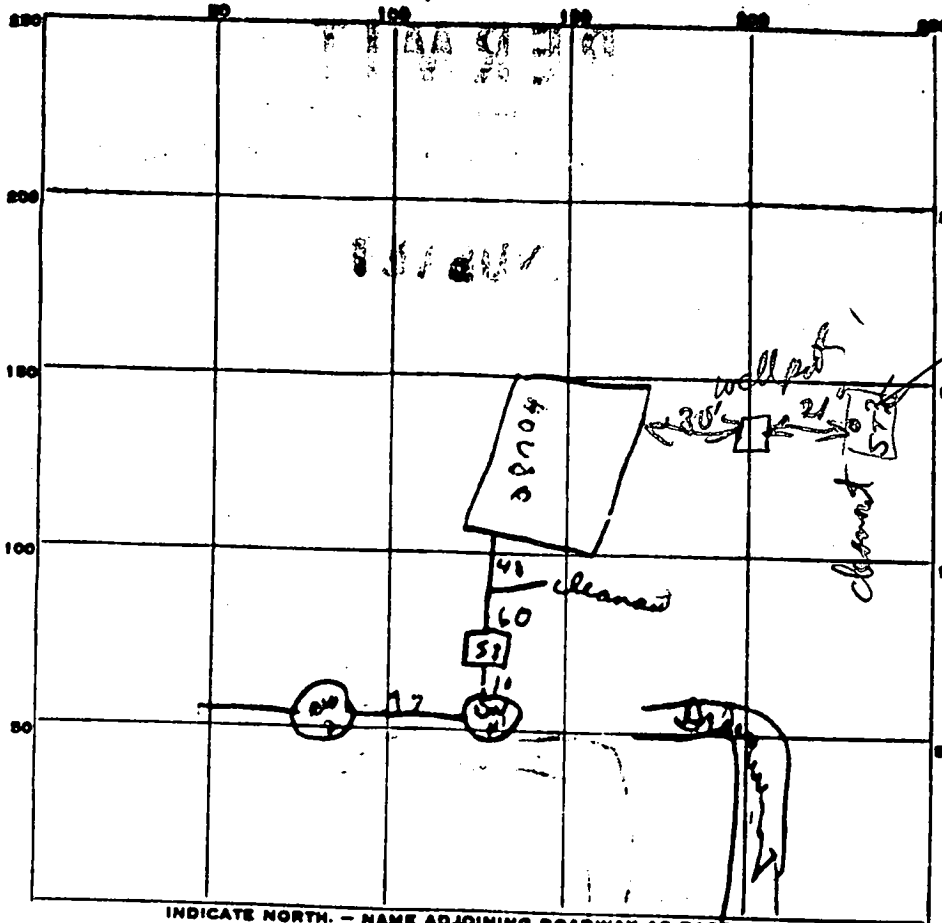

old del
 old slotted pipe
 trench (14' long)

old system
 location @ 1525
 does not
 match this
 drawing

R. P. O'Neil
 5/15/00

INDICATE NORTH - NAME ADJOINING ROADWAY AS BASE LINE.
 Dairy Rd

PERMIT CARD OK

SEPTIC TANK, LEVEL OK

CLEANOUTS 014 (manhole)

DISTRIBUTION BOX, LEVEL _____

TILE FIELD, DEPTH _____ FT. TRENCH WIDTH _____ FT.

GRAVEL DEPTH _____ IN. TOTAL LENGTH _____ FT.

NUMBER OF TRENCHES _____ TOTAL BOTTOM AREA _____

SEEPAGE PITS, INSIDE DIAMETER _____ FT. DEPTH BELOW INLET _____ FT.

ABSORBENT AREA _____ SQ. FT.

REMARKS all 11 x 2 hole 9ft diameter x 5ft deep below inlet = 450
450 x 1 = 450

DATE SYSTEM APPROVED 3/16/69

INSPECTOR W. Monaghan