

5/3/96
5/6/96

PERMIT

SEWAGE DISPOSAL SYSTEM

DEPARTMENT OF HEALTH AND MENTAL HYGIENE

P 56598

A REPAIR

DISTRICT _____

DATE 5-3-96

04-1318803

DATE SYSTEM APPROVED 5-4-96

INSPECTOR AM

HOWARD COUNTY HEALTH DEPARTMENT
BUREAU OF ENVIRONMENTAL HEALTH

313-2640

INDEXED

Herman Sirk

IS PERMITTED TO INSTALL _____ ALTER X

ADDRESS 2555 Jennings Chapel Road, Woodbine, MD 21797 PHONE 489-4724

SUBDIVISION _____ LOT _____ ROAD 16400 Fredrick Road

PROPERTY OWNER Martin Hamilton

ADDRESS 16400 Frederick Road
Woodbine, MD

SEPTIC TANK CAPACITY _____ GALLONS

NUMBER OF BEDROOMS 3

180 SQUARE FEET PER BEDROOM

LINEAR FEET OF TRENCH REQUIRED 108

*2
180
540
108
51540*

REPAIR - PURPOSE - SEPTIC SYSTEM HAS FAILED.

Call for inspection when ground is opened so sanitarian can recommend repairs.

5/3/96
Inlet 4.0, bottom at 9.0 Run trench on contour toward
the right property line when facing lot from Rt. 144 due

5/3/96

PLANS APPROVED BY _____ DATE _____

COVER NO WORK UNTIL INSPECTED AND APPROVED

NEITHER THE HOWARD COUNTY COUNCIL NOR THE HEALTH DEPARTMENT IS RESPONSIBLE FOR THE SUCCESSFUL OPERATION OF ANY SYSTEM

NOTE: CLEANOUT REQUIRED EVERY 70 FEET OF SEWER LINE AND/OR AT 90° SWEEPS IN LINES FROM HOUSE TO DRAIN FIELDS, 90° ELBOWS NOT ACCEPTABLE.

NOTE: ALL PARTS OF SEPTIC SYSTEMS (I.E. TANK, DISTRIBUTION BOX TRENCHES) TO BE 100 FEET FROM WELL (UNLESS OTHERWISE SPECIFICALLY AUTHORIZED)

NOTE: IF DEEP TRENCH(ES) ARE USED CALL FOR INSPECTION BEFORE AND AFTER PLACING GRAVEL IN TRENCH(ES)

NOTE: NO DRY WELL SHALL EXCEED 15 FOOT IN DIAMETER NO ABSORPTION TRENCH TO EXCEED 100 FEET IN LENGTH

NOTE: ALL PIPE FROM HOUSE TO SEPTIC TANK MUST BE CAST IRON OR SCHEDULE 35/40 PVC OR ABS

PERMIT VOID AFTER TWO YEARS

NOTE: INSTALL STAND PIPE ON SEPTIC TANK AND DRY WELL STAND PIPES MUST BE 6 INCHES IN DIAMETER CAST IRON. CONCRETE OR TERRA COTTA OR PVA OR ABS ACCEPTED. IF TOP OF SEPTIC TANK IS DEEPER THAN 3 FEET. MANHOLE TO GRADE REQUIRED.

NOTE: DISTRIBUTION BOXES MUST HAVE BAFFLES

***INSTALLER IS RESPONSIBLE FOR OBTAINING FINAL APPROVAL ON THIS PERMIT**

HD-260(6-90)

*CALL 461-9933 FOR INSPECTION OF SEPTIC SYSTEM.

P 56598

A

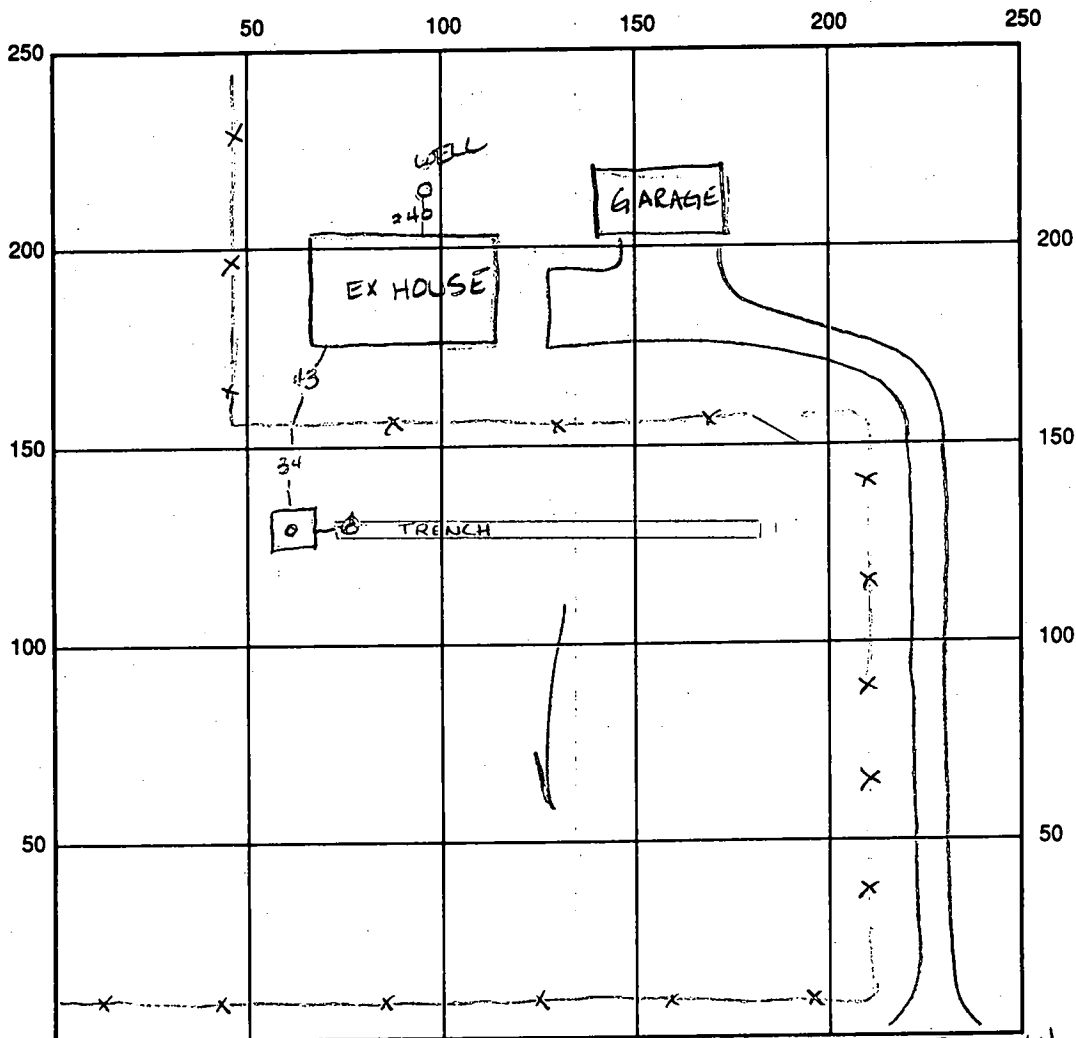

INDICATE NORTH - NAME ADJOINING ROADWAY AS BASE LINE Rt. 144

SEPTIC TANK LEVEL _____ CLEANOUTS _____

DISTRIBUTION BOX LEVEL _____

DRAIN FIELD/TITLE DEPTH 9.0 FT. TRENCH WIDTH 20 FT. INLET DEPTH 4.0 FT.

EFFECTIVE GRAVEL DEPTH 5.0 FT. TOTAL LENGTH 110' FT.

NUMBER OF TRENCHES 1 ONE SIDEWALL/BOTTOM AREA 550 SQ. FT. $\frac{110}{2} = 55$

DRYWALL INSIDE DIAMETER — FT. EFFECTIVE DEPTH BELOW INLET — FT.

ABSORBENT AREA — SQ. FT.

REMARKS: 5/3/96 Test hole dug - see above Auw 5/4/96 OK to cover
all work final Auw

* No tag on well Auw

DATE SYSTEM APPROVED 5/4/96 INSPECTOR Amy McMillen