

PERMIT

SEWAGE DISPOSAL SYSTEM

DEPARTMENT OF HEALTH AND MENTAL HYGIENE

P 56588 A

A REPAIR

DISTRICT _____

DATE 4-30-96

02-247763

HOWARD COUNTY HEALTH DEPARTMENT

BUREAU OF ENVIRONMENTAL HEALTH

313-2640

DATE SYSTEM APPROVED 5/1/96

INSPECTOR DKS

INDEXED

Jack Fyock Septic Service IS PERMITTED TO INSTALL _____ ALTER X

ADDRESS 13775 Triadelphia Road, Glenelg, Maryland 21737 PHONE 988-9270

SUBDIVISION _____ LOT _____ ROAD 2327 Daniels Road

PROPERTY OWNER Michael Will (Tax map 18, Gd 7, P. 7)

ADDRESS 2327 Daniels Road
Ellicott City, Maryland 21043

SEPTIC TANK CAPACITY Existing GALLONS *Per Jean Reed - the property is on private well & septic.

NUMBER OF BEDROOMS 5

125 SQUARE FEET PER BEDROOM

LINEAR FEET OF TRENCH REQUIRED 90'±

REPAIR - PURPOSE - SEPTIC SYSTEM HAS FAILED.

Call for inspection when ground is opened so sanitarian can recommend repair.

Install trench(es) off existing drywell

Trench(es) to be 2' wide, inlet 3.0', bottom 10.0', stone 7'.

VI/
PLANS APPROVED BY Donna K. Sore DATE 5/1/96

COVER NO WORK UNTIL INSPECTED AND APPROVED

NEITHER THE HOWARD COUNTY COUNCIL NOR THE HEALTH DEPARTMENT IS RESPONSIBLE FOR THE SUCCESSFUL OPERATION OF ANY SYSTEM

NOTE: CLEANOUT REQUIRED EVERY 70 FEET OF SEWER LINE AND/OR AT 90° SWEEPS IN LINES FROM HOUSE TO DRAIN FIELDS, 90° ELBOWS NOT ACCEPTABLE.

NOTE: ALL PARTS OF SEPTIC SYSTEMS (I.E. TANK, DISTRIBUTION BOX TRENCHES) TO BE 100 FEET FROM WELL (UNLESS OTHERWISE SPECIFICALLY AUTHORIZED)

NOTE: IF DEEP TRENCH(ES) ARE USED CALL FOR INSPECTION BEFORE AND AFTER PLACING GRAVEL IN TRENCH(ES)

NOTE: NO DRY WELL SHALL EXCEED 15 FOOT IN DIAMETER NO ABSORPTION TRENCH TO EXCEED 100 FEET IN LENGTH

NOTE: ALL PIPE FROM HOUSE TO SEPTIC TANK MUST BE CAST IRON OR SCHEDULE 35/40 PVC OR ABS

PERMIT VOID AFTER TWO YEARS

NOTE: INSTALL STAND PIPE ON SEPTIC TANK AND DRY WELL STAND PIPES MUST BE 6 INCHES IN DIAMETER CAST IRON. CONCRETE OR TERRA COTTA OR PVA OR ABS ACCEPTED. IF TOP OF SEPTIC TANK IS DEEPER THAN 3 FEET. MANHOLE TO GRADE REQUIRED.

NOTE: DISTRIBUTION BOXES MUST HAVE BAFFLES

***INSTALLER IS RESPONSIBLE FOR OBTAINING FINAL APPROVAL ON THIS PERMIT**

P 56588A

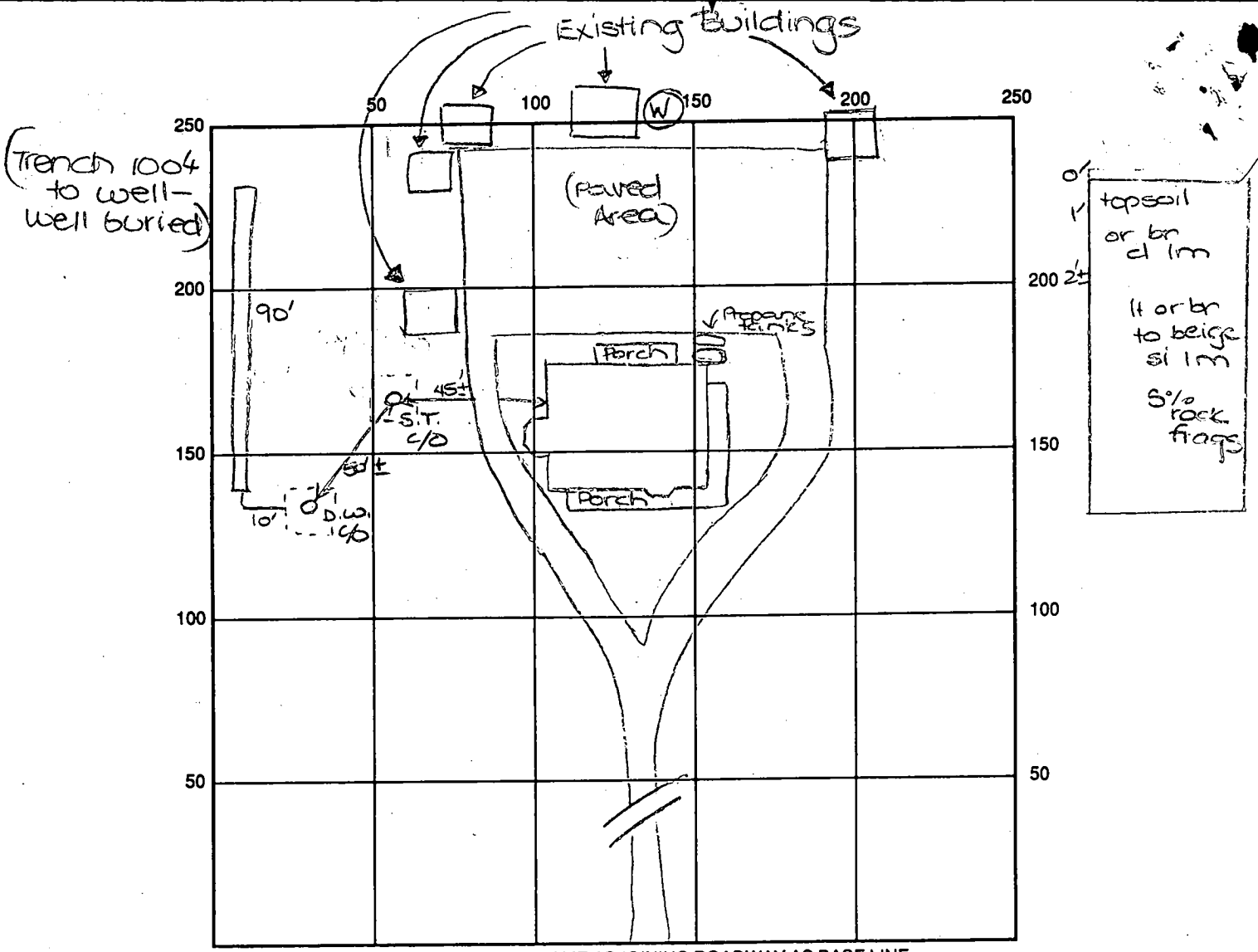

INDICATE NORTH - NAME ADJOINING ROADWAY AS BASE LINE
 Daniels Road

SEPTIC TANK LEVEL Existing CLEANOUTS one on d.w., one on s.t.

DISTRIBUTION BOX LEVEL N/A

DRAIN FIELD/TITLE DEPTH 10.0 FT. TRENCH WIDTH 2' FT. INLET DEPTH 3.0 FT.

EFFECTIVE GRAVEL DEPTH 7 FT. TOTAL LENGTH 90 FT.

NUMBER OF TRENCHES 1 ONE SIDEWALL ~~BOX~~ AREA 630 SQ. FT.

DRYWALL INSIDE DIAMETER Existing FT. EFFECTIVE DEPTH BELOW INLET Existing FT.

ABSORBENT AREA 630 SQ. FT. + Existing

REMARKS: 5/1/96 A.M. OK to continue trench and stone. DKS
5/1/96 P.M. FINAL OK to cover all work. DKS

DATE SYSTEM APPROVED 5/1/96

INSPECTOR [Signature]

Potomac Healthcare Foundation, Ltd.

3800 Frederick Road • Baltimore, Maryland 21229 • 410-233-1400 •

April 7, 1997

Craig Williams
Bureau of Environmental Health
3525 - H Ellicott Mills Dr.
Ellicott City, Md. 21043

Dear Mr. Williams,

This is in response to my telephone conversation with Frank Skinner this date, regarding property located at 2327 Daniels Road, Ellicott City.

Potomac Healthcare Foundation, Ltd., is proposing to lease the property for use as a group home for the Steppingstone Women and Children's Program, which is a contract with Howard County Health Department. The six bedroom, three and one half bath house will be home for up to eight women and their children. All children will be under age 10, and the maximum number of people (women and children together) would be 20.

We are requesting an opinion as to the feasibility of the above occupancy with the existing septic system. In the event that the system would not serve the number of persons in our contract; please give a number of occupants that you believe the system would support, and what it would take to bring the system up to a level that would support our maximum capacity.

Please respond to me at 14703 Avery Road, Rockville, Md., 20853. My phone number is 301-762-5613 if you need to contact me for additional information.

Sincerely,



David Ennis
Project Director

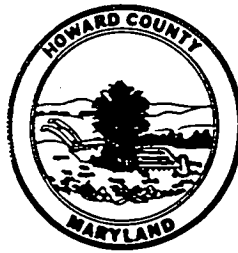

HOWARD COUNTY HEALTH DEPARTMENT

Joyce M. Boyd

Post-it® Fax Note	7671	Date	5/19/97	# of pages	1
To	CHARLENE	From			
Co./Dept.		Co.	Craig Williams		
Phone #		Phone #	X 2640		
Fax #		Fax #			

Mr. Frank McGloin, Addiction Serv
Howard County Health Department
7101 Riverwood Drive
Columbia, MD. 21046

RE: Daniels Road Site Review

Dear Frank:

A preliminary site evaluation of 2327 Daniels Road to examine well and septic capacity, as well as, potential lead paint concerns was performed on April 22, 1997. The following comments summarize those observations, plus provide recommendations believed necessary to fit the proposed use for this property.

There is a record of a recent septic system repair for a five (5) bedroom home, sufficient for a maximum of ten (10) persons. Certification of adequate septic capacity for as many as twenty (20) residents would require enlargement of onsite septic capacity. Percolation testing would be necessary to confirm that this can be accomplished on this site. A preliminary assessment of site conditions seemed promising in this regard.

The well water supply appears ample based upon visual inspection only. Should additional capacity prove to be needed, the supply could readily be augmented by deepening the existing well to establish additional storage reservoir, or by drilling a second well to provide additional yield.

Several dust wipe samples and paint scrapings were collected to help evaluate the presence/absence of lead paint on both the interior and exterior of the home. This preliminary assessment showed that lead dust was present at elevated levels in both window wells sampled, plus lead paint was found on the exterior front porch window frame. Other samples were below detection level. Consequently, a more thorough evaluation of all window surfaces on the first floor, as well as all interior window surfaces on the upper floors should be done. An XRF (X-ray Fluorescence) survey of these surfaces plus any necessary sampling, should suffice. To the extent surveyed, the paint (on all interior surfaces) appeared in good condition. It would seem that regular damp wiping of these surfaces (particularly the window wells), using a trisodium phosphate type cleaner, should keep any residual lead dust to low manageable levels without the need for any abatement.

If questions remain regarding the well and septic issues, contact Craig Williams at (410) 313-2640. Questions concerning the lead paint issues can be directed to Bert Nixon at (410) 313-2644.

Sincerely,



Bert Nixon, Director
Community Env. Health Program

CW/BN/bn

cc: Mr. David Ennis, Potomic Health Care
Mr. Craig Williams, Water & Sewerage Program