

# APPLICATION

SEWAGE DISPOSAL TESTING

34  
15  
50  
A 17508  
P \_\_\_\_\_

MARYLAND STATE DEPARTMENT OF HEALTH

HOWARD COUNTY 1250 Gal Tank

ELLICOTT CITY

DISTRICT 5th

DATE AUG 1972

*Dry Well #2 8.5 ft sidewalk area below the inlet with the inlet. 3 ft deep and the bottom of the dry well 12 ft deep. Place the dry well 154 FT from the lot line which is 5362.29 FT long and 255 ft from the lot line which is 573.00 FT long*

TO: THE COUNTY HEALTH OFFICER  
ELLICOTT CITY, MARYLAND

I, HEREBY, APPLY FOR THE NECESSARY TESTS IN ORDER TO CONSTRUCT (OR RECONSTRUCT) A SEWAGE DISPOSAL SYSTEM.

PROPERTY OWNER Phase One, Ltd.

ADDRESS Urban Life Center, Columbia, Md PHONE 730-8200

PROPERTY LOCATION CLARKSVILLE Parcel C

SUBDIVISION Adjacent to Clarksville Ridge LOT NO. 10

ROAD AND DESCRIPTION Intersection Rt. 32 & Whitegate Lane

OCCUPANT \_\_\_\_\_ PHONE \_\_\_\_\_

PERSON TO CONSTRUCT SYSTEM \_\_\_\_\_

ADDRESS \_\_\_\_\_ PHONE \_\_\_\_\_

SIZE OF LOT 3 acres + TYPE BLDG. 4 Bedroom Res.  
NUMBER OF BEDROOMS

IF NOT SINGLE RESIDENCE DESCRIBE \_\_\_\_\_

SIGNATURE OF APPLICANT Alan C. Borg

APPROVED BY Raymond Hodge FOR Dry Well DATE 6/24/74  
(KIND OF SYSTEM)

REJECTED BY \_\_\_\_\_ FOR \_\_\_\_\_ DATE \_\_\_\_\_  
(KIND OF SYSTEM)

HOLD PENDING FURTHER TESTS \_\_\_\_\_ DATE \_\_\_\_\_

REASONS FOR REJECTION OR HOLDING \_\_\_\_\_

## THIS IS NOT A PERMIT

①  
 Red clay  
 - 1'  
 - 5"  
 sand  
 - 11

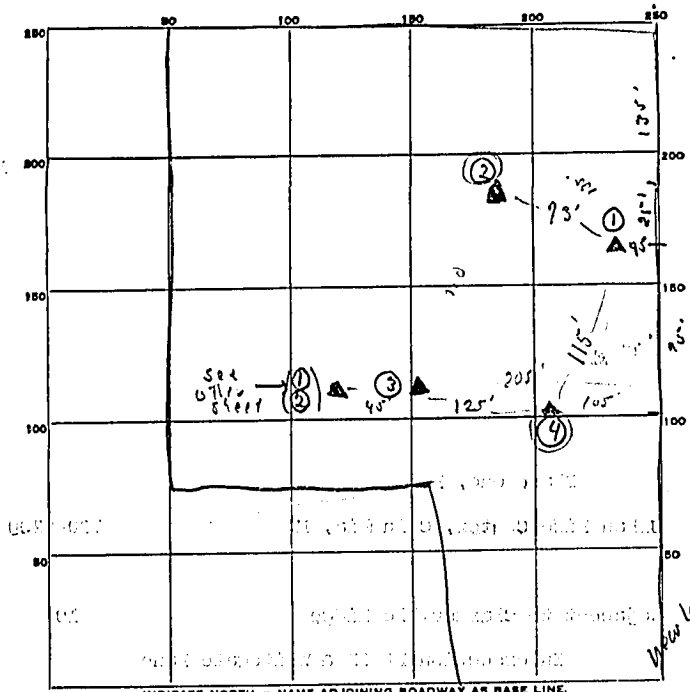

INDICATE NORTH - NAME ADJOINING ROADWAY AS BASE LINE.

Gows Nest

DATE	TEST NO.	DEPTH	PRE-WET		TEST - 1" DROP		TIME
			START	STOP	START	STOP	
4/12/58	(45)	4'	2:25	2:35	2:35	2:45	
"	4A	12 1/2'	2:28	2:35	2:35	2:45	10
	(43)	5 1/2'	2:35	2:50	3:00	3:10	
	1	11' Signal					
	(2)	4'	2:52	3:04	3:04	3:15	
	(23)	12'	3:07	3:28	3:28	3:40	

SOIL AUGER FINDING \_\_\_\_\_

TESTED BY D. J. O'Neill + R. Jones

REMARKS Size of lot increased since original peak